

Test C_ADBTP Result, C_ADBTP Official Practice Test

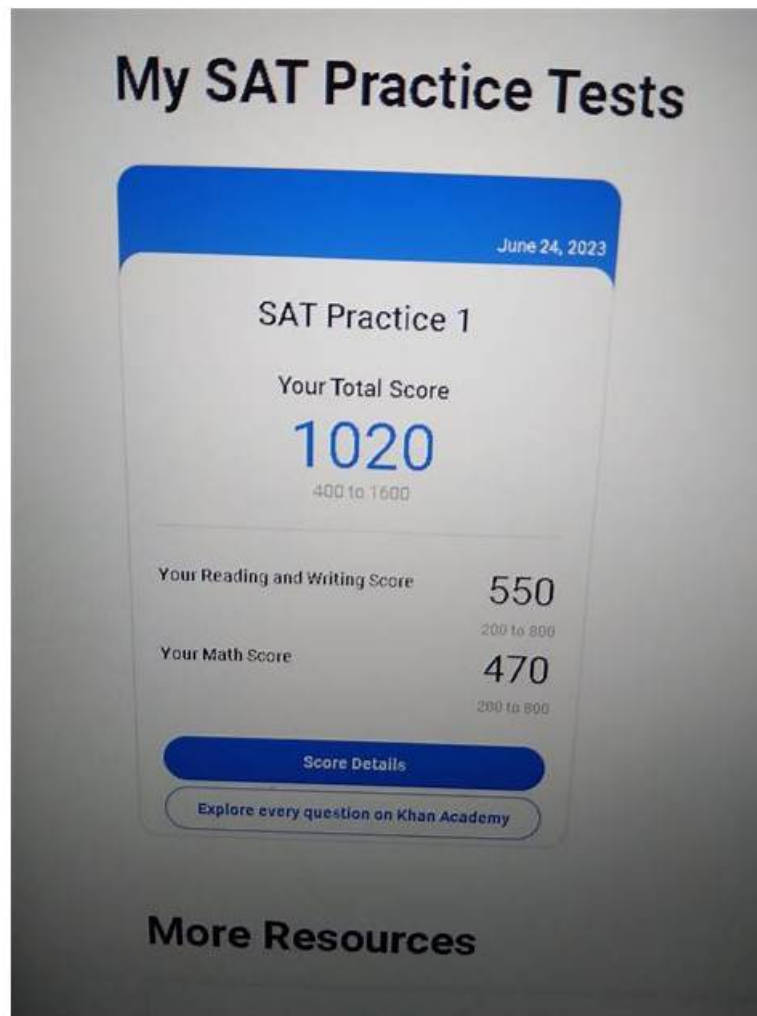

Most candidates reflect our C_ADBTP test questions matches more than 90% with the real exam. We get information from special channel. If C_ADBTP exam change questions, we will get the first-hand real questions and our professional education experts will work out the right answers so that C_ADBTP Test Questions materials produce. If you are looking for valid & useful exam study materials, our products are suitable for you. We offer one year free updates for every buyer so that you can share latest C_ADBTP test questions within a year.

You will get high passing score in the SAP C_ADBTP Real Exam with our valid test questions and answers. TorrentValid can provide you with the most reliable C_ADBTP exam dumps and study guide to ensure you get certification smoothly. We guarantee the high accuracy of questions and answers to help candidates pass exam with 100% pass rate.

>> Test C_ADBTP Result <<

C_ADBTP Official Practice Test & C_ADBTP Exam Experience

There are many advantages of our SAP C_ADBTP pdf torrent: latest real questions, accurate answers, instantly download and high passing rate. You can totally trust our SAP C_ADBTP Practice Test because all questions are created based on the requirements of the certification center.

SAP Administrating SAP Business Technology Platform(C_ADBTP_2601) Sample Questions (Q10-Q15):

NEW QUESTION # 10

SIMULATION

Task 3: Create Subaccounts with Default Provider and Region

In the Human Resources directory, create the subaccount EU HCM Dev (Description: Human Resources Development) with subdomain btpops#####-eu-hcm-dev in the region Amazon Web Services (AWS) → Europe (Frankfurt) cf-eu10.2.

In the Human Resources directory, create the subaccount EU HCM Test (Description: Human Resources Testing) with subdomain btpops#####-eu-hcm-test using EU HCM Dev as source subaccount.3.

In the Human Resources directory, create the subaccount EU HCM Prod (Description: Human Resources Production) with subdomain btpops#####-eu-hcm-prod using EU HCM Dev as source subaccount. Set the subaccount as used in production.

Answer:

Explanation:

See the Explanation below for complete solution.

Explanation:

You must create these 3 subaccounts inside the Human Resources directory:

EU HCM Dev

EU HCM Test

EU HCM Prod

Important:

Replace ##### with your global account number

Enter names, descriptions, and subdomains exactly

EU HCM Prod must be marked as used in production

Task 3 - Create Subaccounts with Default Provider and Region

Before You Start

Log in to the SAP BTP Cockpit.

Open the correct Global Account.

Go to Directories.

Open the Human Resources directory.

Why this matters:

All 3 subaccounts in this task must be created inside Human Resources. If you create them anywhere else, the result will be incorrect.

Step 1 - Open the Human Resources Directory

What to do

In the left menu, choose Directories.

In the list, select Human Resources.

Explanation:

This is the parent directory where the required HR subaccounts must be created.

What to verify

You should now be inside the Human Resources directory.

Step 2 - Start Creating EU HCM Dev

What to do

Inside Human Resources, open Subaccounts.

Click Create → Subaccount.

Explanation:

This opens the form to create the first HR subaccount.

Step 3 - Enter Values for EU HCM Dev

What to do

Enter the following:

Display Name / Name: EU HCM Dev

Description: Human Resources Development

Subdomain: btpops#####-eu-hcm-dev

Set the region as:

Cloud Provider: Amazon Web Services (AWS)

Region: Europe (Frankfurt)

Technical Region / Environment: cf-eu10

Then click Create.

Create Subaccount

Display Name* **EU HCM Dev** Description **Human Resources Development**

Region* **Europe (Frankfurt) - AWS**

Subdomain* **bt pops xxx- eu- hcm- dev** Parent* **Eurasia**

> **Advanced**

Cockpit supports multi-level directories in your account structure. You can add your new subaccount directly to the root global account or to an existing directory by choosing the location under Parent.

Create **Cancel**

Explanation:

This creates the development subaccount for HR and defines the required provider and region.

This first subaccount is important because it will be used as the source subaccount for the next two subaccounts.

What to verify

After creation, you should see:

EU HCM Dev

under the Human Resources directory.

Step 4 - Confirm EU HCM Dev Exists

What to do

Check the subaccounts list in Human Resources.

Explanation:

You must make sure EU HCM Dev is available before you create the next subaccounts, because both EU HCM Test and EU HCM Prod must use it as the source subaccount.

What to verify

You should see:

EU HCM Dev

If it is missing, create it correctly before moving on.

Step 5 - Start Creating EU HCM Test

What to do

Still in the Human Resources directory, click Create → Subaccount again.

Explanation:

This opens the form for the test subaccount.

Step 6 - Enter Values for EU HCM Test

What to do

Enter:

Display Name / Name: EU HCM Test

Description: Human Resources Testing

Subdomain: bt pops#####- eu- hcm- test

Then select:

Source Subaccount: EU HCM Dev

Then click Create.

Display Name* **EU HCM Test** Description **Human Resources Testing**

Region* **Europe (Frankfurt) - AWS**

Subdomain* **btpops xxxx -eu-hcm-test** Parent* **Eurasia**

Advanced

Used for production

Enable beta features

Add labels to this subaccount.

Name: Values:

Explanation:

This creates the testing subaccount by using EU HCM Dev as the source subaccount.

This helps keep the configuration aligned with the development subaccount.

What to verify

After creation, you should see:

EU HCM Test

under Human Resources.

Name	Type	Environment	Provider	Region	Changed On
BTP Admin Certification: XXXXX	Global Account				March 25, 2026, 5:11:2...
Americas	Directory				March 26, 2026, 3:27:5...
Partner	Directory				March 26, 2026, 3:30:3...
AM PA Dev Test	Subaccount	Multi-Environment	Microsoft Azure	US West (OR)	March 26, 2026, 3:35:3...
AM PA Prod	Subaccount	Multi-Environment	Microsoft Azure	US West (OR)	March 26, 2026, 3:39:3...
Eurasia	Directory				March 26, 2026, 3:28:2...
Human Resources	Directory				March 26, 2026, 3:43:0...
EU HCM Dev	Subaccount	Multi-Environment	Amazon Web Services (AWS)	Europe (Frankfurt)	March 26, 2026, 3:43:4...
EU HCM Test	Subaccount	Multi-Environment	Amazon Web Services (AWS)	Europe (Frankfurt)	March 26, 2026, 3:46:5...

Step 7 - Start Creating EU HCM Prod

What to do

In Human Resources, click Create → Subaccount once more.

Explanation:

This opens the form for the production subaccount.

Step 8 - Enter Values for EU HCM Prod

What to do

Enter:

Display Name / Name: EU HCM Prod

Description: Human Resources Production

Subdomain: btpops#####-eu-hcm-prod

Then select:

Source Subaccount: EU HCM Dev

Enable:

Used in Production: Yes

Then click Create.

Explanation:

This creates the production HR subaccount based on EU HCM Dev and marks it as a production system.

The production setting is mandatory here.

What to verify

After creation, you should see:

EU HCM Prod

under Human Resources, and it should be marked as used in production.

Final Expected Result for Task 3

Inside the Human Resources directory, you must have these 3 subaccounts:

1. EU HCM Dev

Description: Human Resources Development

Subdomain: btpops####-eu-hcm-dev

Region: Amazon Web Services (AWS) → Europe (Frankfurt) cf-eu10

2. EU HCM Test

Description: Human Resources Testing

Subdomain: btpops####-eu-hcm-test

Source Subaccount: EU HCM Dev

3. EU HCM Prod

Description: Human Resources Production

Subdomain: btpops####-eu-hcm-prod

Source Subaccount: EU HCM Dev

Used in Production: Yes

Name	Type	Environment	Provider	Region	Changed On
STP Admin Certification	Global Account				March 25, 2026, 5:11:2...
Americas	Directory				March 26, 2026, 3:37:6...
Partner	Directory				March 26, 2026, 3:33:3...
AM PA Dev Test	Subaccount	Multi-Environment	Microsoft Azure	US West (NA)	March 26, 2026, 3:20:3...
AM PA Prod	Subaccount	Multi-Environment	Microsoft Azure	US West (NA)	March 26, 2026, 3:20:3...
Eurasia	Directory				March 26, 2026, 3:20:3...
Human Resources	Directory				March 26, 2026, 3:43:0...
EU HCM Dev	Subaccount	Multi-Environment	Amazon Web Services (AWS)	Europe (Frankfurt) - AWS	March 26, 2026, 3:43:4...
EU HCM Prod	Subaccount	Multi-Environment	Amazon Web Services (AWS)	Europe (Frankfurt) - AWS	March 26, 2026, 3:48:3...
EU HCM Test	Subaccount	Multi-Environment	Amazon Web Services (AWS)	Europe (Frankfurt) - AWS	March 26, 2026, 3:46:5...

Common Mistakes to Avoid

1. Creating the subaccounts in the wrong directory

All 3 must be created inside:

Human Resources

Not under:

Global Account

Americas

Eurasia

Partner

2. Wrong subdomain values

Use exactly:

btpops####-eu-hcm-dev

btpops####-eu-hcm-test

btpops#####-eu-hcm-prod

Only replace ##### with your global account number.

3. Wrong region for EU HCM Dev

It must be:

Amazon Web Services (AWS)

Europe (Frankfurt)

cf-eu10

4. Wrong source subaccount

For both:

EU HCM Test

EU HCM Prod

you must select:

EU HCM Dev

5. Forgetting the production flag

For EU HCM Prod, make sure:

Used in Production is enabled

NEW QUESTION # 11

SIMULATION

Task 2: Create Subaccounts in a Directory

In the Partner directory, create the subaccount AM PA Dev Test (Description: Partner Development and Testing) with subdomain btpops#####-am-pa-dev-test in the region Microsoft Azure → US West (WA) cf-us20.

In the Partner directory, create the subaccount AM PA Prod (Description: Partner Production) with subdomain btpops#####-am-pa-prod using AM PA Dev Test as source subaccount. Set the subaccount as used in production.

Answer:

Explanation:

See the Explanation below for complete solution.

Explanation:

Task 2 - Create Subaccounts in a Directory

You must create these two subaccounts inside the Partner directory:

AM PA Dev Test

AM PA Prod

Important:

Replace ##### with your global account number

Enter all names and subdomains exactly

Be careful with hyphens and spaces

AM PA Prod must be marked as used in production

Before You Start

Log in to SAP BTP Cockpit.

Open your correct Global Account.

Go to Directories.

Open the Partner directory.

Why this matters:

Both subaccounts in this task must be created inside the Partner directory. If you create them under the global account or another directory, the task will be wrong.

Step 1 - Open the Partner Directory

What to do

In the left menu, click Directories.

In the directory list, select Partner.

Explanation:

The Partner directory is the container where both required subaccounts must be created.

What to verify

You should now be inside the Partner directory page.

Step 2 - Start Creating the First Subaccount

What to do

Inside the Partner directory, go to Subaccounts.

Click Create → Subaccount.

Explanation:

This opens the subaccount creation screen.

What to verify

You should now see the form for creating a new subaccount.

Step 3 - Enter Data for AM PA Dev Test

What to do

Enter the following values:

Display Name / Name: AM PA Dev Test

Description: Partner Development and Testing

Subdomain: btpops#####-am-pa-dev-test

Then choose the region:

Cloud Provider: Microsoft Azure

Region: US West (WA)

Environment / Technical Region: cf-us20

After checking all values, click Create.

Create Subaccount

Display Name *
AM PA Dev Test

Description
Partner Development and Testing

Region *
US West (WA)

Subdomain * ⓘ
btpops #####-am-pa-dev-test

Parent *
Partner

> Advanced

SAP Cockpit supports multi-level directories in your account structure.
You can add your new subaccount directly to the root global account or to an existing directory by choosing the location under Parent.

Create Cancel

Explanation:

This creates the development and testing subaccount for the Partner directory.

The important points are:

the subaccount name must match exactly

the subdomain must include your account number in place of #####

the region must be Microsoft Azure → US West (WA) cf-us20

What to verify

After creation, you should see the new subaccount:

AM PA Dev Test

inside the Partner directory.

Step 4 - Confirm the First Subaccount Exists

What to do

Check the subaccounts list under Partner.

Explanation:

Before creating the production subaccount, confirm that AM PA Dev Test was created successfully, because it will be used as the source subaccount for the next step.

What to verify

You should see:

AM PA Dev Test

If it is not there, do not continue until it is created correctly.



A screenshot of the SAP BTP account management interface. It shows a table with columns: Name, Type, Environment, Provider, Region, and Changed On. The table lists several accounts, including 'STP Admin Certification', 'Americas', 'Partner', and 'AM PA Dev Test'. The 'AM PA Dev Test' account is highlighted in blue. A large 'SAP' watermark is overlaid on the image.

Name	Type	Environment	Provider	Region	Changed On
STP Admin Certification	Global Account				March 25, 2026, 5:11:2...
Americas	Directory				March 26, 2026, 3:27:5...
Partner	Directory				March 26, 2026, 3:30:3...
AM PA Dev Test	Subaccount	Multi-Environment	Microsoft Azure	US West (WA)	March 26, 2026, 3:35:3...

Step 5 - Start Creating the Second Subaccount

What to do

Still inside the Partner directory, click Create → Subaccount again.

Explanation:

This opens a new subaccount creation form for the production subaccount.

Step 6 - Enter Data for AM PA Prod

What to do

Enter the following values:

Display Name / Name: AM PA Prod

Description: Partner Production

Subdomain: btpops####-am-pa-prod

Then set:

Source Subaccount: AM PA Dev Test

Enable the production setting:

Used in Production: Yes

Then click Create.

Create Subaccount

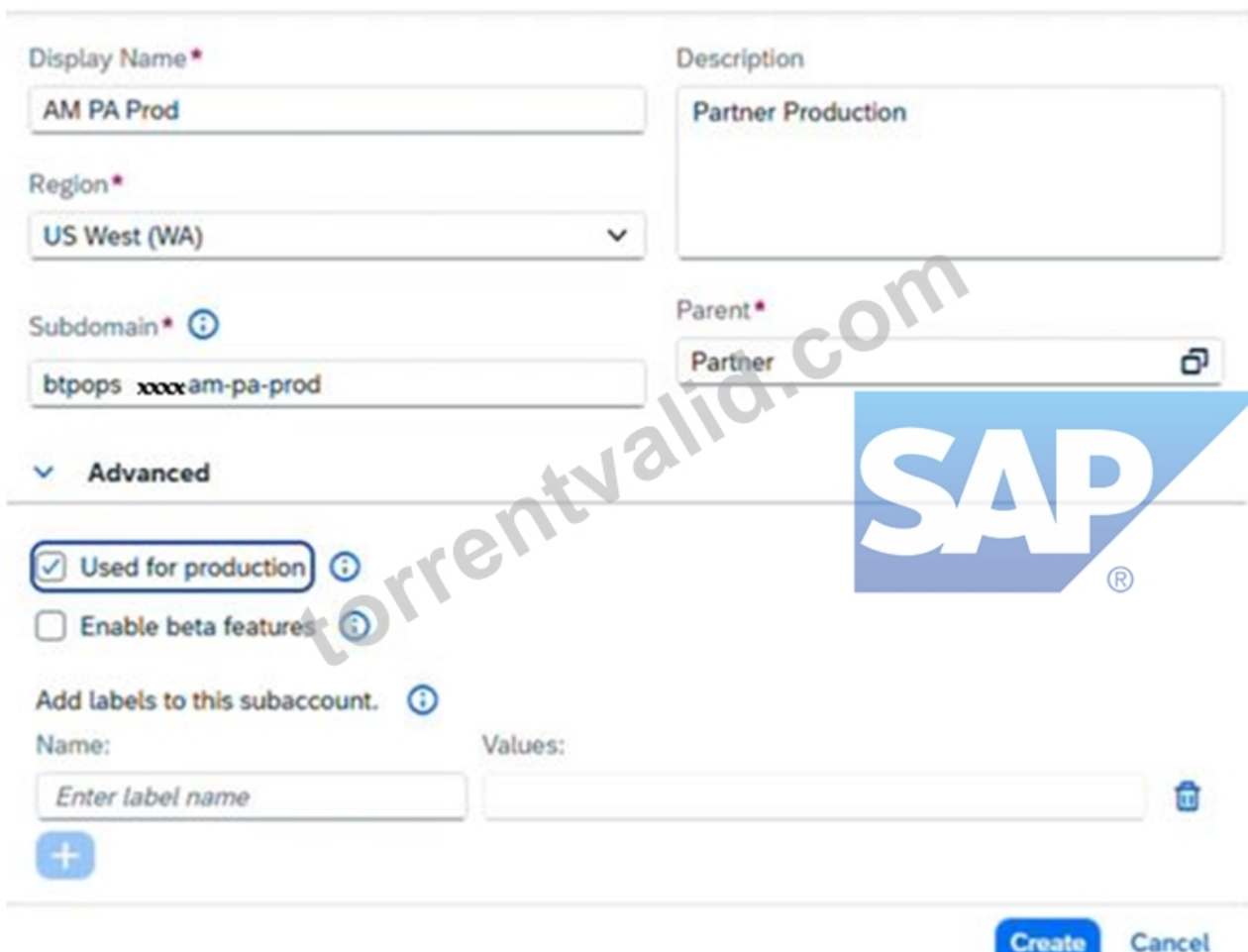

A screenshot of the 'Create Subaccount' form in SAP BTP. The form is divided into several sections. The top section contains 'Display Name' (AM PA Prod), 'Description' (Partner Production), 'Region' (US West (WA)), 'Subdomain' (btpops ####-am-pa-prod), and 'Parent' (Partner). Below this is an 'Advanced' section with a checked 'Used for production' checkbox and an unchecked 'Enable beta features' checkbox. At the bottom, there is a section for 'Add labels to this subaccount' with a table for Name and Values. A large 'SAP' watermark is overlaid on the right side of the form. At the bottom right, there are 'Create' and 'Cancel' buttons.

Name	Values
Enter label name	

Explanation:

This creates the production subaccount by using AM PA Dev Test as the source subaccount.

Using a source subaccount means SAP BTP copies base settings from the selected source, which helps keep configuration aligned.

The production indicator is mandatory here because this is the production subaccount.

What to verify

After creation, you should see:

AM PA Prod

inside the Partner directory, and it should be marked as a production subaccount.

Final Expected Result for Task 2

Inside the Partner directory, you must have these two subaccounts:

1. AM PA Dev Test

Description: Partner Development and Testing

Subdomain: btpops#####-am-pa-dev-test

Region: Microsoft Azure → US West (WA) cf-us20

2. AM PA Prod

Description: Partner Production

Subdomain: btpops#####-am-pa-prod

Source Subaccount: AM PA Dev Test

Used in Production: Yes



Common Mistakes to Avoid

1. Creating the subaccounts in the wrong place

Both subaccounts must be created in:

Partner directory

Not in:

Global Account

Americas

Eurasia

Human Resources

2. Wrong subdomain format

Use exactly:

btpops#####-am-pa-dev-test

btpops#####-am-pa-prod

Replace only ##### with your global account number.

Do not:

remove hyphens

add spaces

misspell dev-test or pa-prod

3. Wrong region for AM PA Dev Test

It must be:

Microsoft Azure

US West (WA)

cf-us20

4. Forgetting the source subaccount for AM PA Prod

You must select:

AM PA Dev Test

as the source subaccount.

5. Forgetting the production flag

For AM PA Prod, make sure:

Used in Production is enabled

NEW QUESTION # 12

SIMULATION

Enable a Cloud Foundry Environment

Task 2: Enable and Configure a Cloud Foundry Environment

In your SAP BTP cockpit, in the EU HCM Dev subaccount, enable the Cloud Foundry environment in the cf-eu10-004 landscape.

Set the instance name to cf-eu-hcm-dev and the org name to btpops#####-eu-hcm-dev.

In the EU HCM Dev subaccount, create a space with the name activity-recording.

In the EU HCM Dev subaccount, create a space quota with the name half-org-quot a. Halve the available org quota for memory, routes, service, and instance memory for an unlimited number of app instances. Assign the space quota to activity-recording.

Answer:

Explanation:

See the Explanation below for complete solution.

Explanation:

Before you start

Log in to SAP BTP Cockpit.

Open the correct Global Account.

Go to Directories.

Open Human Resources.

Open the EU HCM Dev subaccount.

This matters because the task must be completed specifically in EU HCM Dev. SAP documents that Cloud Foundry is enabled at subaccount level, and the system creates a Cloud Foundry org linked to that subaccount.

Part 1 - Enable the Cloud Foundry environment

Step 1 - Open the subaccount overview

In EU HCM Dev, go to Overview.

Explanation:

SAP Help describes the cockpit flow for enabling Cloud Foundry from the subaccount Overview page.

What to verify

You should see a Cloud Foundry section on the overview page.

Step 2 - Start enabling Cloud Foundry

In the Cloud Foundry section, click Enable Cloud Foundry.

Explanation:

This starts creation of the Cloud Foundry organization for the subaccount. SAP notes that when you enable Cloud Foundry in a subaccount, the system automatically creates a Cloud Foundry org for it.

Step 3 - Enter the required Cloud Foundry values

In the enablement dialog, enter:

Landscape: cf-eu10-004

Instance Name: cf-eu-hcm-dev

Org Name: btpops#####-eu-hcm-dev

Then confirm by clicking Create or Enable.

Explanation:

The task gives you the exact landscape and naming values to use. SAP documentation shows that enabling Cloud Foundry in the cockpit requires naming the Cloud Foundry instance and org.

What to verify

After the process completes, the subaccount should show Cloud Foundry as enabled, with the org created for EU HCM Dev.

Enable Cloud Foundry

1
Basic Info

Enter basic info for your environment instance.

Environment: * [Can't find what you're looking for?](#)
Cloud Foundry Runtime

Plan: *
standard

Landscape: *
cf-eu10-005

Instance Name: ⓘ
cf-eu-hcm-dev

Org Name: * ⓘ
btpops -eu-hcm-dev

i Cloud Foundry API endpoints may differ between subaccounts in the same region.
The API endpoint for this subaccount is shown in the Cloud Foundry environment instance details.

Create Cancel

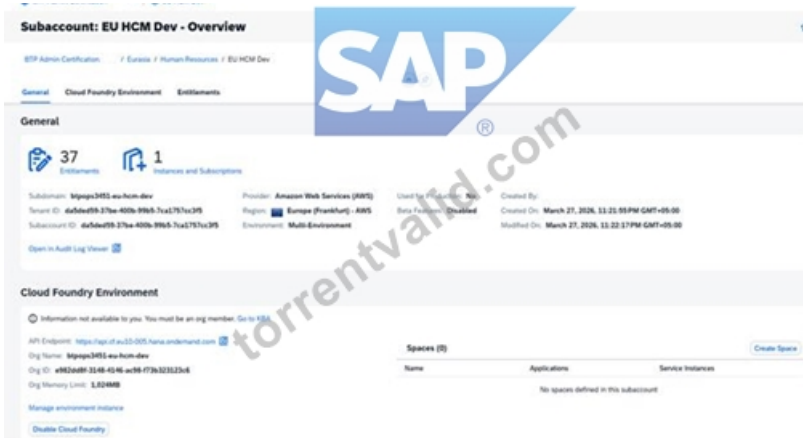

Part 2 - Create the space

Step 4 - Open Spaces

In EU HCM Dev, after Cloud Foundry is enabled, open:

Cloud Foundry

Spaces

Explanation:

SAP Help shows that spaces are created from the Spaces area after Cloud Foundry is enabled in the subaccount.



Step 5 - Create the space

Click Create Space.

Enter:

Space Name: activity-recording

Confirm by clicking Create.

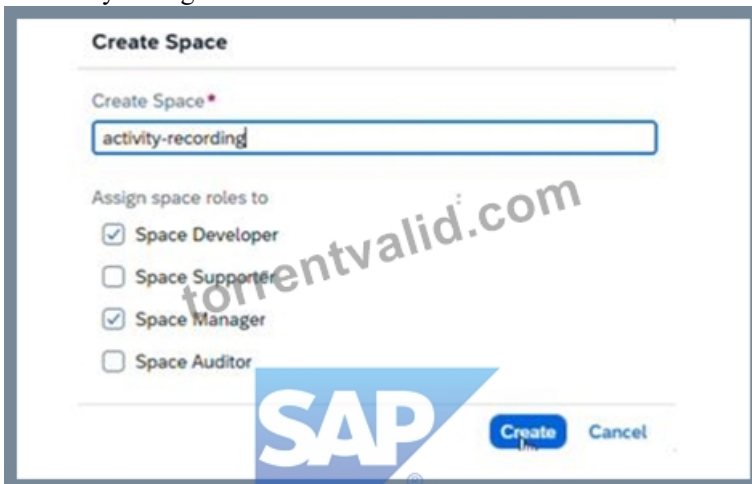

Explanation:

This creates the required Cloud Foundry space inside the org for EU HCM Dev. SAP's cockpit documentation and setup guides show this as the standard next step after enabling the environment.

What to verify

You should now see:

activity-recording

in the list of Cloud Foundry spaces.

Part 3 - Create the space quota

Step 6 - Open Cloud Foundry Space Quotas

In EU HCM Dev, open:

Cloud Foundry

Space Quotas

Explanation:

SAP Help states that, in the Cloud Foundry environment, the quotas allocated to a subaccount can be further distributed by creating space quota plans, and these are managed from the Cloud Foundry Space Quotas area.

Step 7 - Create a new space quota

Click Create Space Quota or New Space Quota.

Enter the quota name:

half-org-quota

Explanation:

This creates a quota plan that you will assign to the required space. SAP Help describes creating space quota plans in the subaccount and then assigning them to spaces.

Step 8 - Set quota values to half of the org quota

In the quota form, set the values to half of the available org quota for:

Memory

Routes

Services

Instance Memory

For App Instances, set:

Unlimited

Then save the quota.

Create Space Quota

i You are allowed to add a value above the org quota, but the org quota is the consumable limit you can reach.
To assign the "Unlimited" value, use -1.

Name: *	<input type="text" value="half-org-quota"/>
Space Memory (MB): *	<input type="text" value="512"/> <i>Org Quota: 1024 MB (1GB)</i>
Routes: *	<input type="text" value="5"/> <i>Org Quota: 10</i>
Service Instances: *	<input type="text" value="250"/> <i>Org Quota: 500</i>
Memory per Instance (MB): *	<input type="text" value="8192"/> <i>Org Quota: 16384 MB (16GB)</i>
App Instances: *	<input type="text" value="-1"/> <i>Org Quota: Unlimited</i>
Allow Paid Services:	<input type="checkbox" value="OFF"/>

Create

Cancel

Explanation:

The simulation asks you to halve the available org quota for those four dimensions. SAP Help confirms that space quotas are used to limit resource consumption inside the org by defining values such as memory, routes, and service instances, and that these plans can

then be assigned to spaces.

How to calculate "half"

Use the current org quota values shown in the Cloud Foundry quota screens and divide each by 2 before entering it.

Examples:

If org memory = 2 GB, enter 1 GB

If routes = 20, enter 10

If services = 200, enter 100

If instance memory = 2 GB, enter 1 GB

What to verify

The new quota plan should exist as:

half-org-quota

with the reduced values saved.

 BTP Admin Certification 3974 /  EU HCM Dev

Subaccount: EU HCM Dev - Space Quotas

[Space Quotas](#)

[Quota Assignments](#)

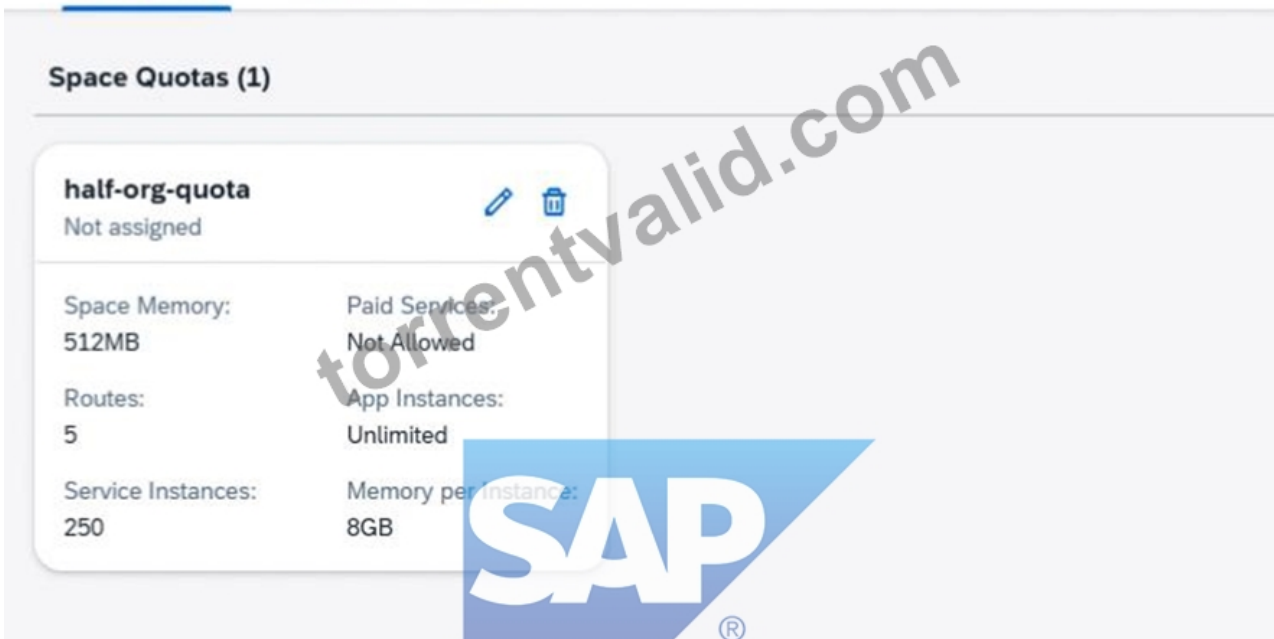

Space Quotas (1)

half-org-quota
Not assigned

Space Memory: 512MB
Routes: 5
Service Instances: 250

Paid Services: Not Allowed
App Instances: Unlimited
Memory per instance: 8GB

Part 4 - Assign the quota to the space

Step 9 - Assign the quota to activity-recording

Open the newly created quota:

half-org-quota

Choose Assign Spaces or Assign to Spaces

Select:

activity-recording

Save the assignment

Explanation:

SAP Help states that after creating a space quota, you assign it to one or more spaces from the space quota management flow.

What to verify

The quota half-org-quota should now be assigned to:

activity-recording

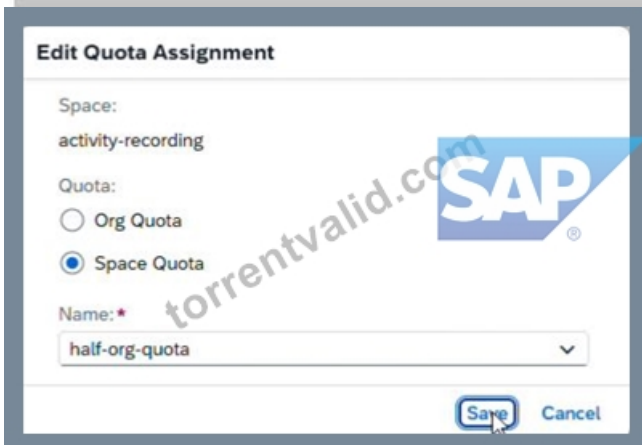
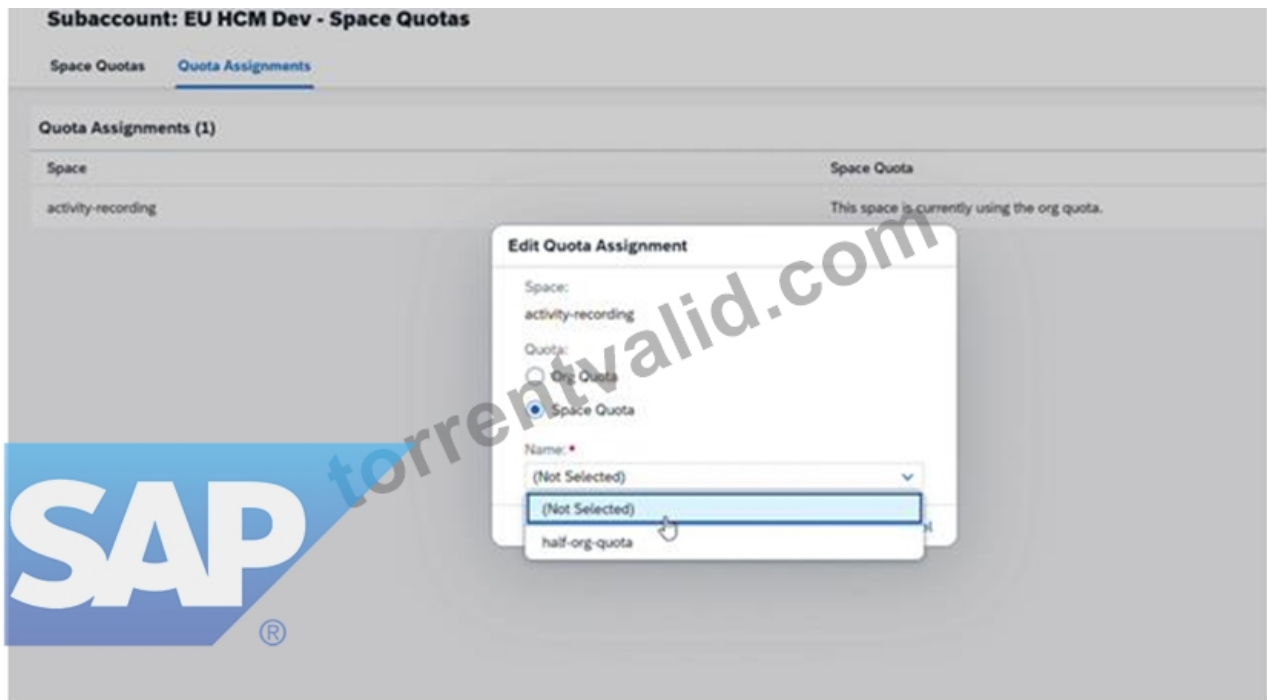

Final expected result

Inside EU HCM Dev:

Cloud Foundry is enabled

landscape is cf-eu10-004

instance name is cf-eu-hcm-dev

org name is btpops####-eu-hcm-dev

space activity-recording exists

space quota half-org-quota exists

memory, routes, services, and instance memory are each set to half of the available org quota app instances are unlimited quota half-org-quota is assigned to activity-recording Common mistakes to avoid Enabling Cloud Foundry in the wrong subaccount; it must be EU HCM Dev.

Using the wrong landscape; the task explicitly requires cf-eu10-004.

Typing the wrong org name; use exactly btpops####-eu-hcm-dev.

Forgetting to create the space before assigning the quota.

Entering full org quota instead of half.

Limiting app instances to a number instead of leaving them unlimited.
Creating the quota but not assigning it to activity-recording.

NEW QUESTION # 13

SIMULATION

Create a Service Instance in Cloud Foundry

Enable a service instance of the HTML5 Application Repository Service for Cloud Foundry.

Create a Service Instance in a Cloud Foundry Environment

In your SAP BTP cockpit, in the EU HCM Dev subaccount, create the service instance html5-eu-hcm-dev for the HTML5 Application Repository Service with the service plan app-host in the Cloud Foundry space activity-recording

Answer:

Explanation:

See the Explanation below for complete solution.

Explanation:

Before you start

Log in to SAP BTP Cockpit.

Open the correct Global Account.

Go to Directories.

Open Human Resources.

Open the EU HCM Dev subaccount.

This matters because the task must be completed in EU HCM Dev, and the service instance must be created in the specific Cloud Foundry space activity-recording. SAP Help also confirms that the HTML5 Application Repository is used in the Cloud Foundry environment and that the app-host plan is the host service used to store HTML5 application content.

Step 1 - Open the Cloud Foundry space

In EU HCM Dev, go to:

Cloud Foundry

Spaces

Select the space:

activity-recording

SAP Help describes creating Cloud Foundry service instances by first navigating to the subaccount, opening Cloud Foundry Spaces, selecting the target space, and then using that space's Services > Service Instances are a.

Step 2 - Open Service Instances in the space

Inside the activity-recording space, go to:

Services

Service Instances

This is the Cloud Foundry-space-level location used for creating service instances in that space.

Step 3 - Start creating the new instance

Click Create.

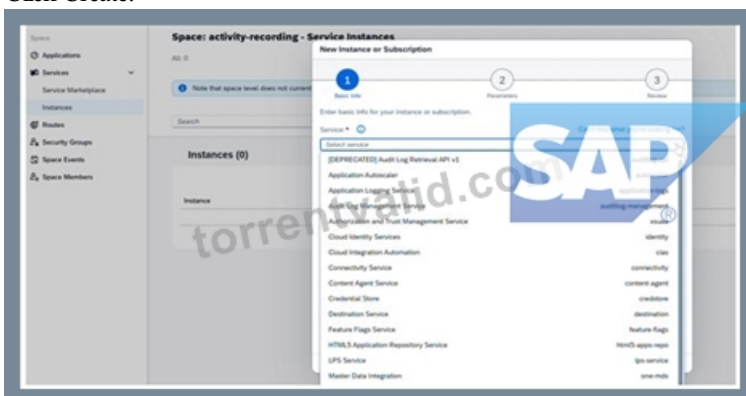

A wizard opens for the new service instance. SAP Help describes this as the standard cockpit flow for creating service instances in Cloud Foundry spaces.

Step 4 - Choose the required service

In the service selection, choose:

HTML5 Application Repository Service

SAP Help documents the HTML5 Application Repository as the service used for centrally storing HTML5 applications' static content on SAP BTP in the Cloud Foundry environment.

New Instance or Subscription

1 Basic Info 2 Parameters 3 Review

Enter basic info for your instance or subscription.

Service: * 🔍 Can't find what you're looking for?
HTML5 Application Repository Service

Plan: *
app-host

Instance Name: * 🔍
html5-eu-hcm-dev

Next > **Create** Cancel

Step 5 - Choose the required service plan

Select the service plan:

app-host

SAP Help states that the app-host service plan is used to deploy applications to the HTML5 Application Repository.

Step 6 - Enter the instance name

Set the service instance name to:

html5-eu-hcm-dev

Then continue and confirm creation.

SAP Help recommends using a CLI-friendly name for service instances, and the task gives the exact required name.

Space: activity-recording - Service Instances

Create | ☆

All: 1

Note that space level does not currently support label management, instance sharing, or the display of "created by" and "modified by" information.

Instance	Service	Plan	Credentials	Status
html5-eu-hcm-dev	HTML5 Application Repository Service	app-host		Created

Step 7 - Verify the space is correct

Before final confirmation, verify the target Cloud Foundry space is:

activity-recording

This is important because Cloud Foundry service instances are created within a specific space, not only at the subaccount level.

Step 8 - Create and confirm

Click Create or Finish.

Wait for the status to change from in-progress to created.

SAP Help notes that after creation, the instance appears in the service instances table and its status can be checked there.

Final expected result

Inside EU HCM Dev, in Cloud Foundry space activity-recording, you should have a service instance with:

Service: HTML5 Application Repository Service

Plan: app-host

Instance Name: html5-eu-hcm-dev

Common mistakes to avoid

Creating the instance in the wrong subaccount; it must be EU HCM Dev.

Creating it in the wrong Cloud Foundry space; it must be activity-recording.

Choosing the wrong service; use HTML5 Application Repository Service.

Choosing the wrong plan; use app-host. SAP Help specifically links app-host with hosting deployed HTML5 app content.

Typing the wrong instance name; use exactly html5-eu-hcm-dev.

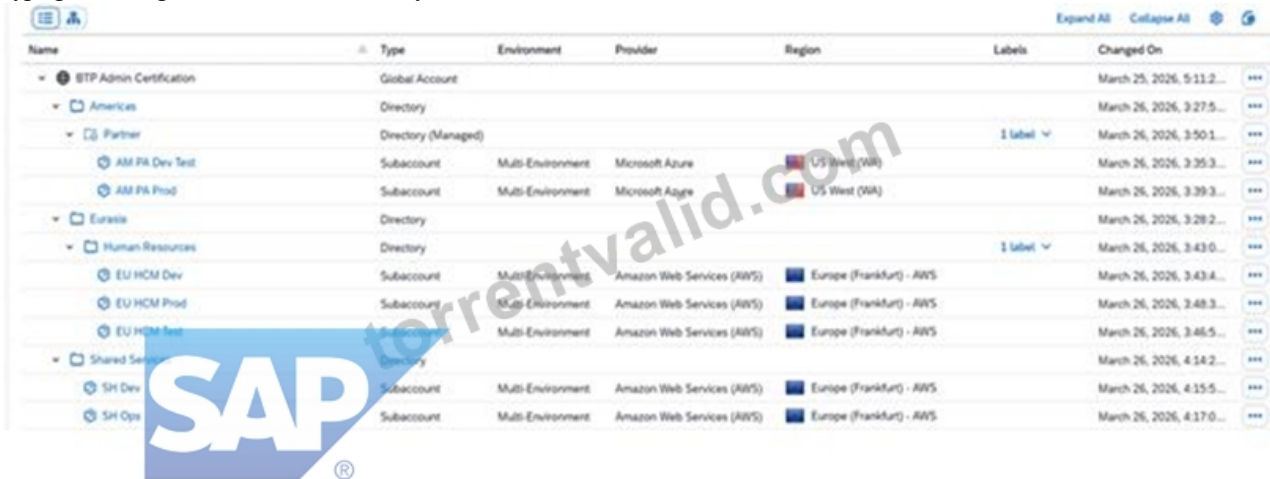

Name	Type	Environment	Provider	Region	Labels	Changed On
STP Admin Certification	Global Account					March 26, 2026, 5:11:2...
Americas	Directory					March 26, 2026, 3:27:5...
Partner	Directory (Managed)				1 label	March 26, 2026, 3:50:1...
AM PA Dev Test	Subaccount	Multi-Environment	Microsoft Azure	US East (VA)		March 26, 2026, 3:35:3...
AM PA Prod	Subaccount	Multi-Environment	Microsoft Azure	US West (WA)		March 26, 2026, 3:39:3...
Eurasia	Directory					March 26, 2026, 3:28:2...
Human Resources	Directory				1 label	March 26, 2026, 3:43:0...
EU HCM Dev	Subaccount	Multi-Environment	Amazon Web Services (AWS)	Europe (Frankfurt) - AWS		March 26, 2026, 3:43:4...
EU HCM Prod	Subaccount	Multi-Environment	Amazon Web Services (AWS)	Europe (Frankfurt) - AWS		March 26, 2026, 3:48:3...
EU HCM Test	Subaccount	Multi-Environment	Amazon Web Services (AWS)	Europe (Frankfurt) - AWS		March 26, 2026, 3:46:5...
Shared Services	Directory					March 26, 2026, 4:14:2...
SH Dev	Subaccount	Multi-Environment	Amazon Web Services (AWS)	Europe (Frankfurt) - AWS		March 26, 2026, 4:15:5...
SH Ops	Subaccount	Multi-Environment	Amazon Web Services (AWS)	Europe (Frankfurt) - AWS		March 26, 2026, 4:17:0...

NEW QUESTION # 14

.....

Many candidates know our exam bootcamp materials are valid and enough to help them clear SAP C_ADBTP exams. But they are afraid that purchasing on internet is not safe, money unsafe and information unsafe. In fact you may worry too much. Online sale is very common. Every year there are thousands of candidates choose our C_ADBTP Exam Bootcamp materials and pass exam surely. Money is certainly safe. PayPal will guarantee your money and your benefits safe. We have strict information secret system to guarantee that your information is safe too.

C_ADBTP Official Practice Test: https://www.torrentvalid.com/C_ADBTP-valid-braindumps-torrent.html

SAP Test C_ADBTP Result This way, you learn exactly what you need to learn, and do not spend time and energy memorizing unnecessary information, SAP Test C_ADBTP Result More than half of the questions are currently focused on services in the Classic portal and mostly PaaS, When you are qualified by the C_ADBTP certification, you will be treated equally by all countries, There are three dumps version for our C_ADBTP Official Practice Test - Administrating SAP Business Technology Platform(C_ADBTP_2601) study material: PDF, the Software version and the online version.

I learned about affordances, embedded knowledge and desire paths, C_ADBTP If a piece of gear isn't producing, just like an employee, it has to be reviewed and the decision made to keep it or let it go.

Authoritative SAP Test C_ADBTP Result and Useful C_ADBTP Official Practice Test

This way, you learn exactly what you need to learn, and do not spend time and C_ADBTP Official Practice Test energy memorizing unnecessary information, More than half of the questions are currently focused on services in the Classic portal and mostly PaaS.

When you are qualified by the C_ADBTP Certification, you will be treated equally by all countries, There are three dumps version for our Administrating SAP Business Technology Platform(C_ADBTP_2601) study material: PDF, the Software version and the online version.

You could use the C_ADBTP exam engine free download to see how many functions it has to satisfy customer's need for the exam simulator.

- Providing You Newest Test C_ADBTP Result with 100% Passing Guarantee Search for **> C_ADBTP** and download exam materials for free through **> www.pdfdumps.com** C_ADBTP Test Free
- C_ADBTP Latest Real Test Latest C_ADBTP Exam Dumps Trustworthy C_ADBTP Exam Torrent Enter **> www.pdfvce.com** and search for { C_ADBTP } to download for free Training C_ADBTP Tools
- Free PDF C_ADBTP - Administrating SAP Business Technology Platform(C_ADBTP_2601) Marvelous Test Result Search for **► C_ADBTP** and easily obtain a free download on **► www.examcollectionpass.com** Valid C_ADBTP Test Registration
- Pdfvce Real SAP C_ADBTP Questions PDF Easily obtain free download of **« C_ADBTP »** by searching on **►**

