

AB-900 Latest Test Bootcamp & Valid AB-900 Study Materials



There are a lot of excellent experts and professors in our company. The high quality of the AB-900 study materials from our company resulted from their constant practice, hard work and their strong team spirit. After a long period of research and development, our AB-900 study materials have been the leader study materials in the field. We have taken our customers' suggestions of the AB-900 Study Materials seriously, and according to these useful suggestions, we have tried our best to perfect the AB-900 study materials from our company just in order to meet the need of these customers well.

Microsoft AB-900 Exam Syllabus Topics:

Topic	Details
Topic 1	<ul style="list-style-type: none">Perform basic administrative tasks for Copilot and agents: This domain focuses on managing Copilot and agents, including licensing, feature controls, and usage monitoring. It also covers creating agents, managing prompts, configuring user access, and monitoring agent activity through admin centers.
Topic 2	<ul style="list-style-type: none">Understand data protection and governance tasks for Microsoft 365 and Copilot: This domain explains how Microsoft Purview protects and governs organizational data through classification, sensitivity labels, retention, and compliance tools. It also covers how Copilot accesses data, follows permissions, and how administrators monitor risks, alerts, and oversharing.
Topic 3	<ul style="list-style-type: none">Identify the core features and objects of Microsoft 365 services: This domain covers the main Microsoft 365 objects such as users, groups, licenses, mailboxes, SharePoint sites, and Teams. It also focuses on managing organization settings, roles, authentication, authorization, and core security features using Microsoft Entra and Microsoft Defender.

>> **AB-900 Latest Test Bootcamp** <<

Valid Microsoft AB-900 Study Materials & Latest AB-900 Version

If you are troubled with AB-900 exam, you can consider down our free demo. You will find that our latest AB-900 exam torrent are perfect paragon in this industry full of elucidating content for exam candidates of various degree to use. Our results of latest AB-900 exam torrent are startlingly amazing, which is more than 98 percent of exam candidates achieved their goal successfully. The latest AB-900 Exam Torrent covers all the qualification exam simulation questions in recent years, including the corresponding matching materials at the same time.

Microsoft 365 Copilot & Agent Administration Fundamentals Sample Questions (Q30-Q35):

NEW QUESTION # 30

Your organization has a Microsoft 365 subscription that contains a user named User1. User1 plans to leave your company in two weeks. You need to capture the activity of User1 to identify whether the user is exfiltrating data. Which Microsoft Purview solution should you use?

- A. Data Security Posture Management
- **B. Insider Risk Management**
- C. Data Lifecycle Management
- D. Communication Compliance

Answer: B

Explanation:

The correct answer is C. Insider Risk Management . Microsoft documents that Microsoft Purview Insider Risk Management helps organizations detect, investigate, and act on potentially risky internal activities, including data theft and data leakage . Microsoft specifically provides policy templates for departing users

, describing scenarios where users who are leaving an organization might download files, print files, or copy data to personal cloud storage or messaging services near their resignation or end date. That matches this question exactly, where User1 is leaving in two weeks and you need to determine whether the user is exfiltrating data.

The other options do not fit. Communication Compliance is for reviewing risky communications, Data Security Posture Management focuses on broader data exposure posture, and Data Lifecycle Management is for retention and deletion. None of those is the Microsoft Purview solution specifically built to monitor suspicious user activity and data exfiltration risk for departing employees. Microsoft positions Insider Risk Management as the correct tool for this scenario.

NEW QUESTION # 31

You have a Microsoft SharePoint site named Site1 and a security group named Group1.

You need to prevent all users that currently have access to Site1 from accessing the site content unless the user is also a member of Group1.

Which settings should you configure? To answer, select the appropriate settings in the answer area.

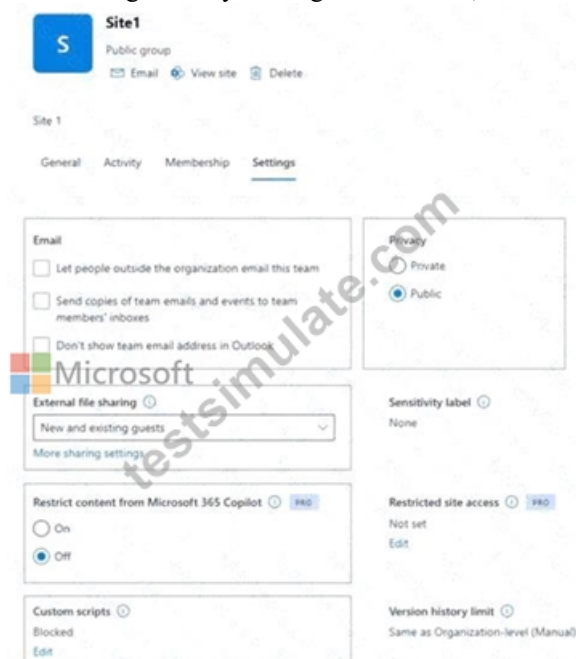

Answer:

Explanation:

Site1
Public group
Email View site Delete

Site 1

General Activity Membership Settings

Email

- Let people outside the organization email this team
- Send copies of team emails and events to team members' inboxes
- Don't show team email address in Outlook

Privacy

- Private
- Public

External file sharing

New and existing guests

Sensitivity label

None

Restrict content from Microsoft 365 Copilot

- On
- Off

Restricted site access

Not set

Edit

Custom scripts

Blocked

Edit

Version history limit

Same as Organization-level (Manual)

The correct setting is Restricted site access configured with Group1 . Microsoft Learn states that you can restrict access to a SharePoint site by specifying Microsoft Entra security groups or Microsoft 365 groups as the Restricted Access Control group . Microsoft also states that, after the policy is applied, a user can access the site content only if the user both already has permission to the site or content and is a member of the specified restricted access group. This exactly matches the requirement: users who currently have access to Site1 must also be members of Group1 to continue accessing the content.

The Restrict content from Microsoft 365 Copilot setting is unrelated to direct user access to the SharePoint site. That control limits whether Copilot can use site content, but it does not block users from opening the site themselves. Microsoft separately explains that Restricted SharePoint Search and Copilot restrictions are not the same as changing actual SharePoint permissions or access boundaries. So for this scenario, keep the Copilot restriction Off and configure Restricted site access with Group1 .

NEW QUESTION # 32

Hotspot Question

For each of the following statements, select Yes if the statement is true. Otherwise, select No.

NOTE: Each correct selection is worth one point.

Answer Area		
Statements	Yes	No
Microsoft Defender for Office 365 provides protection from phishing and malware attacks.	<input type="radio"/>	<input type="radio"/>
Microsoft Defender for Identity monitors identities in Active Directory domains.	<input type="radio"/>	<input type="radio"/>
Microsoft Defender Vulnerability Management provides protection for software as a service (SaaS) applications.	<input type="radio"/>	<input type="radio"/>

Answer:

Explanation:

Answer Area		
Statements	Yes	No
Microsoft Defender for Office 365 provides protection from phishing and malware attacks.	<input checked="" type="radio"/>	<input type="radio"/>
Microsoft Defender for Identity monitors identities in Active Directory domains.	<input checked="" type="radio"/>	<input type="radio"/>
Microsoft Defender Vulnerability Management provides protection for software as a service (SaaS) applications.	<input type="radio"/>	<input checked="" type="radio"/>

NEW QUESTION # 33

Your organization has a Microsoft 365 E5 subscription.

You need to prevent users from sharing corporate financial data to external users. What should you use?

- A. data loss prevention (DLP) policies
- B. role groups
- C. insider risk management policies
- D. retention labels

Answer: A

Explanation:

The correct answer is B. data loss prevention (DLP) policies . Microsoft Learn states that Microsoft Purview Data Loss Prevention helps organizations identify, monitor, and automatically protect sensitive information across Microsoft 365 locations such as Exchange, SharePoint, OneDrive, Teams, and devices .

Microsoft specifically documents scenarios for preventing sensitive items from being shared with external users in SharePoint and OneDrive, and DLP policies can also block or restrict sharing based on sensitive information types, labels, or policy conditions. This is exactly the control used when the requirement is to stop users from sharing corporate financial data outside the organization.

Option A is incorrect because retention labels manage how long content is kept or deleted, not whether it can be shared externally.

Option C is incorrect because role groups are used for permissions and administrative access delegation, not content-sharing prevention.

Option D is incorrect because Insider Risk Management is designed to detect and investigate risky user behavior, not to directly block external sharing transactions in the way DLP policies do. For proactive enforcement of external-sharing restrictions on sensitive financial information, Microsoft's documented solution is DLP policies .

NEW QUESTION # 34

Your company uses Microsoft 365 Copilot pay-as-you-go billing.

The company wants greater visibility into Copilot usage costs and the ability to forecast departmental spending.

You need to ensure that you can see Copilot costs by department.

What should you use? To answer, select the appropriate options in the answer area.

NOTE: Each correct selection is worth one point.

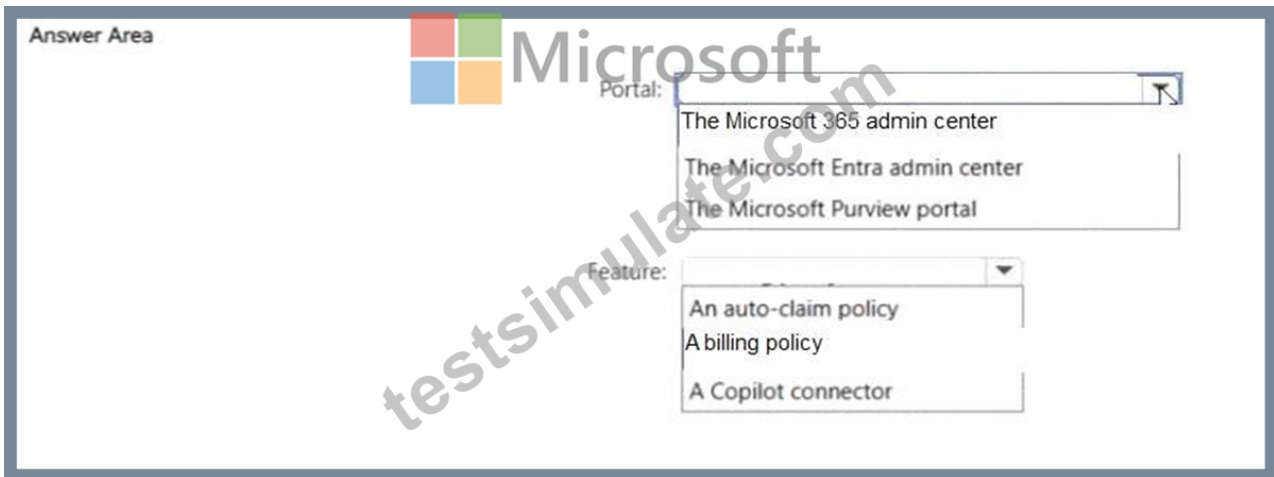

Answer:

Explanation:
Answer Area

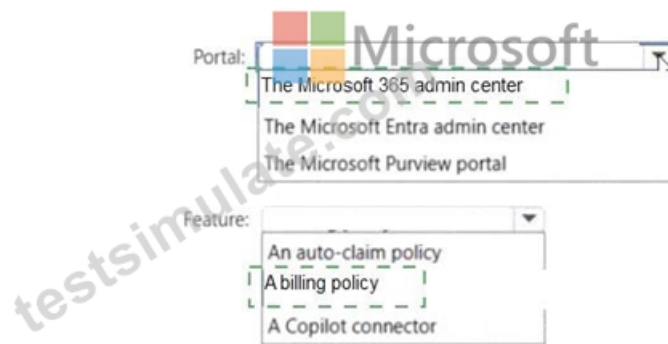

Explanation:

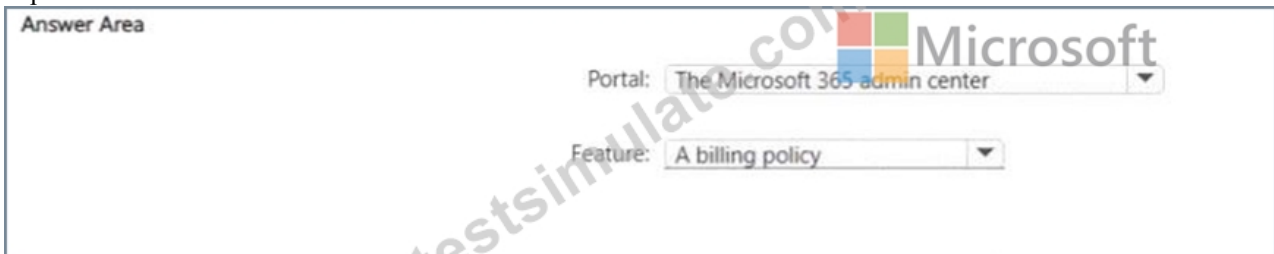

The correct selections are The Microsoft 365 admin center and A billing policy . Microsoft documents that Microsoft 365 Copilot pay-as-you-go is administered in the Microsoft 365 admin center , specifically under Copilot > Billing & usage , where admins create and manage billing policies . Microsoft explains that a billing policy defines the billing infrastructure for pay-as-you-go, including the Azure subscription and the set of users covered by that policy. That user scoping is what allows organizations to separate usage and spending by groups such as departments. Microsoft also documents that billing policies support budgets , spending views , and monitoring current expenses for services linked to the policy. This supports the requirement for greater visibility into Copilot usage costs and forecasting departmental spending. By assigning different departments to different billing policies, the organization can track Copilot costs by department. The other listed features do not fit: auto- claim policy is unrelated to cost tracking, and Copilot connector is for external data grounding, not billing segmentation.

NEW QUESTION # 35

.....

For candidates who prefer a more flexible and convenient option, Microsoft provides the AB-900 PDF file, which can be easily printed and studied at any time. The PDF file contains the latest real Microsoft 365 Copilot & Agent Administration Fundamentals (AB-900) questions, and AB-900 ensures that the file is regularly updated to keep up with any changes in the exam's content.

Valid AB-900 Study Materials: <https://www.testsimulate.com/AB-900-study-materials.html>

- AB-900 Valid Test Pass4sure AB-900 Reliable Exam Blueprint AB-900 Valid Braindumps Pdf Download

- AB-900 ☐☐☐ for free by simply searching on 「 www.pdf.dumps.com 」 ☐AB-900 Test Discount Voucher
- Exam AB-900 Materials ☐ AB-900 Reliable Braindumps Questions ☐ AB-900 Valid Study Questions ☐ The page for free download of (AB-900) on ➔ www.pdfvce.com ☐ will open immediately ☐Valid Exam AB-900 Practice
 - AB-900 Valid Exam Topics ☐ AB-900 Valid Test Experience ☐ AB-900 Valid Exam Topics ☐ Go to website ⇒ www.prepawayete.com ⇐ open and search for ✨ AB-900 ☐:🌟☐ to download for free ☐AB-900 Valid Test Experience
 - AB-900 Latest Test Bootcamp - First-grade Microsoft Valid AB-900 Study Materials ☐ ▷ www.pdfvce.com ◁ is best website to obtain ▶ AB-900 ◀ for free download ☐AB-900 Test Papers
 - Authoritative AB-900 Latest Test Bootcamp - Find Shortcut to Pass AB-900 Exam ☐ Search for ➔ AB-900 ☐ and easily obtain a free download on ⇒ www.verifiedumps.com ⇐ ☐Exam AB-900 Bible
 - Authoritative AB-900 Latest Test Bootcamp - Find Shortcut to Pass AB-900 Exam ☐ Immediately open ☐ www.pdfvce.com ☐ and search for ➔ AB-900 ☐ to obtain a free download ☐Testking AB-900 Exam Questions
 - AB-900 Latest Test Bootcamp - Pass Guaranteed AB-900 - Microsoft 365 Copilot & Agent Administration Fundamentals First-grade Valid Study Materials ☐ Easily obtain [AB-900] for free download through ☐ www.testkingpass.com ☐ ☐ ☐AB-900 Detailed Answers
 - 2026 Fantastic Microsoft AB-900 Latest Test Bootcamp ☐ Simply search for ✨ AB-900 ☐:🌟☐ for free download on 「 www.pdfvce.com 」 ☐Real AB-900 Questions
 - Latest AB-900 Exam Dumps Question Updated Constantly - www.vceengine.com ☐ Search for { AB-900 } and easily obtain a free download on ▷ www.vceengine.com ◁ ☐AB-900 Valid Study Questions
 - Microsoft AB-900 Latest Test Bootcamp - Precise Valid AB-900 Study Materials and Fast-download Latest Microsoft 365 Copilot & Agent Administration Fundamentals Version ☐ Open ▶ www.pdfvce.com ◀ enter ➔ AB-900 ☐ and obtain a free download ☐AB-900 Standard Answers
 - 2026 Microsoft High Hit-Rate AB-900 Latest Test Bootcamp ☐ Simply search for ▷ AB-900 ◁ for free download on ➔ www.examcollectionpass.com ☐ ☐AB-900 Reliable Exam Blueprint
 - 210list.com, matheazhc442743.nizarblog.com, nicolasxyvx571997.eveowiki.com, bookmarkhard.com, peterbonadieacademy.org, henricjy447063.idblogmaker.com, jimmgdy451372.blogars.com, lexievcje586866.wikiworldstock.com, www.stes.tyc.edu.tw, bookmarkshome.com, Disposable vapes