

Quiz Efficient AZ-104 - Microsoft Azure Administrator Reliable Exam Preparation



BONUS!!! Download part of Test4Engine AZ-104 dumps for free: <https://drive.google.com/open?id=1UnUFwUXL269HeVwD96fr3kvEoHBBXTJ>

We are a leading corporation in this line handling AZ-104 study questions well with passing rate up to 98 and over percent, which is an unreachable goal for others. So our AZ-104 preparation exam enjoys good sales for the excellent quality and reasonable prices in recent years. And we are so sure that we can serve you even better than you can imagine with our AZ-104 learning guide since we are keeping on doing a better job in this career.

Microsoft AZ-104 or the Microsoft Azure Administrator Exam is a certification exam that validates the skills and knowledge of candidates in managing and administering Microsoft Azure services. It is designed for professionals who are responsible for managing cloud resources, implementing security controls, monitoring and optimizing Azure services, and maintaining the overall health of the cloud environment.

AZ-104: Microsoft Azure Administrator Exam Certified Professional salary

The average salary of an AZ-104: Microsoft Azure Administrator Exam Certified Expert in

- United States - 80,000 USD
- Europe - 60,547 EURO
- England - 60,532 POUNDS
- India - 12,10,327 INR

>> AZ-104 Reliable Exam Preparation <<

Microsoft AZ-104 Reliable Exam Sample | Reliable AZ-104 Braindumps Sheet

AZ-104 test guide is an examination material written by many industry experts based on the examination outlines of the calendar year and industry development trends. Its main purpose is to help students who want to obtain the certification of AZ-104 to successfully pass the exam. Compared with other materials available on the market, the main feature of AZ-104 Exam Materials doesn't like other materials simply list knowledge points. According to our statistics on the data so far, the passing rate of the students who have purchased one exam exceeds 99%, which is enough to see that AZ-104 test guide is a high-quality product that can help you to realize your dream.

To prepare for the AZ-104 Certification Exam, candidates are advised to have a good understanding of Azure services and features. They should also have experience in managing and monitoring Azure resources and services. Microsoft offers various training courses and resources that can help candidates prepare for the exam. These resources include online training courses, practice exams, and study guides.

Microsoft Azure Administrator Sample Questions (Q398-Q403):

NEW QUESTION # 398

You have an Azure subscription named Subscription1.

In Subscription1, you create an Azure web app named WebApp1. WebApp1 will access an external service that requires certificate authentication.

You plan to require the use of HTTPS to access WebApp1.

You need to upload certificates to WebApp1.

In which formats should you upload the certificate? To answer, select the appropriate options in the answer area.

NOTE: Each correct selection is worth one point.

Certificate format for HTTPS access:

CER
CRL
CRT
PFX

Certificate format for external service access:

CER
CRL
CRT
PFX

Microsoft

Answer:

Explanation:

Certificate format for HTTPS access:

CER
CRL
CRT
PFX

Certificate format for external service access:

CER
CRL
CRT
PFX

Microsoft

NEW QUESTION # 399

You have an Azure subscription that contains two storage accounts named contoso101 and contoso102.

The subscription contains the virtual machines shown in the following table.

VNet1 has service endpoints configured as shown in the Service endpoints exhibit. (Click the Service endpoints tab.)

Service	Subnet	Status	Locations
Microsoft.AzureActiveDirectory	Subnet1	Succeeded	...
Microsoft.AzureActiveDirectory	Subnet2	Succeeded	...
Microsoft.Storage	Subnet1	Succeeded	...

The Microsoft.Storage service endpoint has the service endpoint policy shown in the Microsoft.Storage exhibit. (Click the Microsoft.Storage tab.)

Create a service endpoint policy

Validation passed

Basics Policy definitions Tags Review + create

Basics

Subscription: Azure Pass - Sponsorship

Resource group: RG1

Region: East US

Name: Policy1

Resources

Microsoft.Storage: contoso101 (Storage account)

Tags

None

For this policy to take effect, you will need to associate it to one or more subnets that have virtual network service endpoints. Please visit a virtual network in East US region and then select the subnets to which you would like to associate this policy.

For each of the following statements, select Yes if the statement is true. Otherwise, select No.

NOTE: Each correct selection is worth one point.

Answer Area

Statements	Yes	No
VM1 can access contoso102.	<input type="radio"/>	<input type="radio"/>
VM2 can access contoso101.	<input type="radio"/>	<input type="radio"/>
VM2 uses a private IP address to access Azure AD.	<input type="radio"/>	<input type="radio"/>

Answer:

Explanation:

Answer Area

Statements	Yes	No
VM1 can access contoso102.	<input type="radio"/>	<input checked="" type="radio"/>
VM2 can access contoso101.	<input type="radio"/>	<input checked="" type="radio"/>
VM2 uses a private IP address to access Azure AD.	<input type="radio"/>	<input checked="" type="radio"/>

Explanation:

Answer Area

Statements	Yes	No
VM1 can access contoso102.	<input checked="" type="radio"/>	<input type="radio"/>
VM2 can access contoso101.	<input type="radio"/>	<input checked="" type="radio"/>
VM2 uses a private IP address to access Microsoft Entra ID.	<input type="radio"/>	<input checked="" type="radio"/>

NEW QUESTION # 400

You have an Azure Load Balancer named LB1.

You assign a user named User1 the roles shown in the following exhibit.

User assignments - LB1

Assignments for the selected user, group, service principal, or managed identity at this scope or inherited to this scope.

Search by assignment name or description

User	Role
User1	delete
User1	create a NAT rule for
User1	assign access to other users for
User1	delete a virtual machine from
User1	modify the load balancing rules in
User1	deploy an Azure Kubernetes Service (AKS) cluster to

Answer:

Explanation:

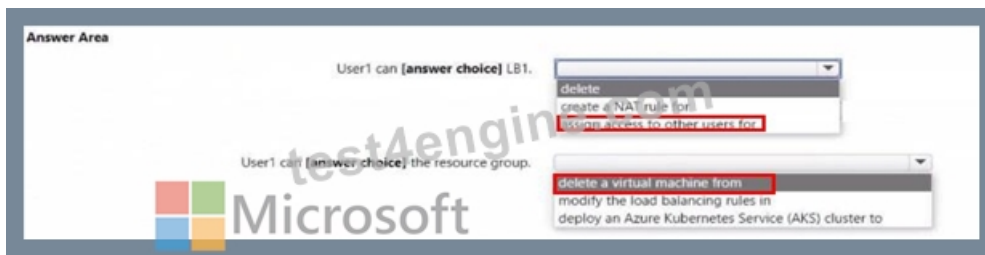

NEW QUESTION # 401

You have an Azure App Service app named WebApp1 that contains two folders named Folder1 and Folder2.

You need to configure a daily backup of WebApp1. The solution must ensure that Folder2 is excluded from the backup.

What should you create first and what should you use to exclude Folder2? To answer, select the appropriate options in the answer area.

NOTE: Each correct selection is worth one point.



Answer:

Explanation:

Answer Area

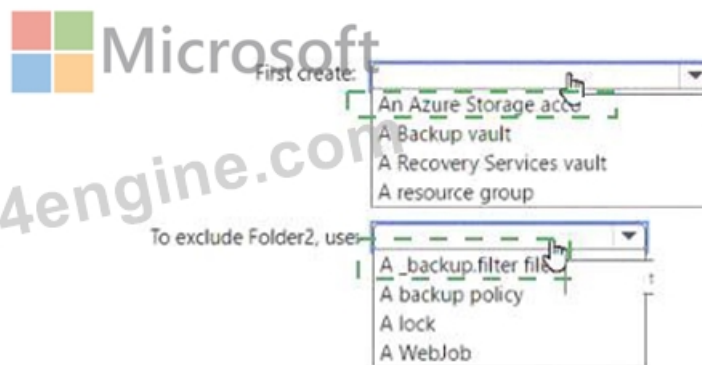

Explanation:

Answer Area



<https://learn.microsoft.com/en-us/azure/app-service/manage-backup?tabs=portal#create-a-custom-backup> In Storage account, select an existing storage account (in the same subscription) or select Create new. Do the same with Container.

<https://learn.microsoft.com/en-us/azure/app-service/manage-backup?tabs=portal#configure-partial-backups>

Partial backups are supported for custom backups (not for automatic backups). Sometimes you don't want to back up everything on

your app. To exclude folders and files from being stored in your future backups, create a `_backup.filter` file in the `%HOME%\site\wwwroot` folder of your app. Specify the list of files and folders you want to exclude in this file.

NEW QUESTION # 402

You have an Azure subscription.

You plan to use Azure Resource Manager templates to deploy 50 Azure virtual machines that will be part of the same availability set.

You need to ensure that as many virtual machines as possible are available if the fabric fails or during servicing.

How should you configure the template? To answer, select the appropriate options in the answer area.

NOTE: Each correct selection is worth one point.

```
"$schema": "https://schema.management.azure.com/schemas/2015-01-01/deploymentTemplate.json",
"contentVersion": "1.0.0.0",
"parameters": {},
"resources": [
  {
    "type": "Microsoft.Compute/availabilitySets",
    "name": "ha",
    "apiVersion": "2017-12-01",
    "location": "eastus",
    "properties": {
      "platformFaultDomainCount": 20,
      "platformUpdateDomainCount": 20
    }
  }
]
```

Microsoft

test4engine.com

Answer:

Explanation:

```
{
  "$schema": "https://schema.management.azure.com/schemas/2015-01-01/deploymentTemplate.json",
  "contentVersion": "1.0.0.0",
  "parameters": {},
  "resources": [
    {
      "type": "Microsoft.Compute/availabilitySets",
      "name": "ha",
      "apiVersion": "2017-12-01",
      "location": "eastus",
      "properties": {
        "platformFaultDomainCount": 20,
        "platformUpdateDomainCount": 20
      }
    }
  ]
}
```

Microsoft

test4engine.com

Reference:

<https://www.itprotoday.com/microsoft-azure/check-if-azure-region-supports-2-or-3-fault-domains-managed-disks>

<https://github.com/Azure/acs-engine/issues/1030>

NEW QUESTION # 403

.....

AZ-104 Reliable Exam Sample: https://www.test4engine.com/AZ-104_exam-latest-braindumps.html

- Test AZ-104 Dumps ☐ AZ-104 Exam Tutorial ☐ Valid Real AZ-104 Exam ☐ Go to website ☒ www.practicevce.com ☒ open and search for ☐ AZ-104 ☐ to download for free ☐ New AZ-104 Exam Format
- AZ-104 Reliable Exam Preparation | Authoritative Microsoft Azure Administrator 100% Free Reliable Exam Sample ☐ Open (www.pdfvce.com) and search for ☐ AZ-104 ☐ to download exam materials for free ☐ AZ-104 Test Vce Free

- 2026 Latest Test4Engine AZ-104 PDF Dumps and AZ-104 Exam Engine Free Share: <https://drive.google.com/open?id=1UnUFWtJXl269HeVwD96fr3kvFoHBBXTJ>