

Pass Guaranteed Microsoft PL-600 Marvelous Training Online



What's more, part of that TestSimulate PL-600 dumps now are free: <https://drive.google.com/open?id=17om2GKInyght6eKaARfL5OZCTCoKqkb7>

Using our products does not take you too much time but you can get a very high rate of return. Our PL-600 quiz guide is of high quality, which mainly reflected in the passing rate. We can promise higher qualification rates for our PL-600 exam question than materials of other institutions. Because our products are compiled by experts from various industries and they are based on the true problems of the past years and the development trend of the industry. What's more, according to the development of the time, we will send the updated materials of PL-600 Test Prep to the customers soon if we update the products. Under the guidance of our study materials, you can gain unexpected knowledge. Finally, you will pass the exam and get a Microsoft certification.

To pass the Microsoft PL-600 exam, candidates need to have a solid understanding of the Power Platform architecture, data modeling, and security concepts. They should also be familiar with the Common Data Service, Power Apps portals, and AI Builder. PL-600 Exam consists of 40-60 multiple-choice questions, and candidates have 150 minutes to complete it. The passing score for the exam is 700 out of 1000.

>> Training PL-600 Online <<

2026 Unparalleled Microsoft PL-600: Training Microsoft Power Platform Solution Architect Online

If you come to our website to choose our PL-600 real exam, you will enjoy humanized service. Firstly, we have chat windows to wipe out your doubts about our PL-600 exam materials. You can ask any question about our study materials. All of our online workers are going through special training. They are familiar with all details of our PL-600 Practice Guide. If you have any question, you can ask them for help and our services are happy to give you guide on the PL-600 learning quiz.

Microsoft PL-600 Certification Exam is designed for professionals who want to demonstrate their expertise in designing and implementing solutions using Microsoft Power Platform. PL-600 exam is intended for solution architects who are responsible for leading the design and implementation of Power Platform solutions in organizations. Microsoft Power Platform Solution Architect certification exam tests the candidate's knowledge in various areas of Power Platform, including Data Modeling, User Experience,

Microsoft Power Platform Solution Architect Sample Questions (Q45-Q50):

NEW QUESTION # 45

Hotspot Question

You are conducting performance testing for a Microsoft Power Platform solution. The solution uses Power Automate cloud flows to query and synchronize data across 10 different tables based on various criteria. You make the following observations:

- Internet speed during testing is fast (500 Mbps).
- There are 50 Dynamics real-time workflows in use.
- There are 63 Dynamics asynchronous workflows in use.
- There are 76 Power Automate cloud flows in use.

You identify the following performance issues:

- Data changes are slow to save.
- Background processes often take hours to complete.

You need to recommend steps to resolve the performance issues.

What should you recommend? To answer, select the appropriate options in the answer area.

NOTE: Each correct selection is worth one point.

Performance issue	Recommendation
Data changes are slow to save.	<div>▼</div> <div>Reduce usage of near real-time workflows. Convert all Dynamics 365 workflows to Power Automate cloud flows. Review and revise filters in cloud flow queries and conditional logic.</div>
Background processes often take hours to complete.	<div>▼</div> <div>Reduce usage of near real-time workflows. Convert all Dynamics 365 workflows to Power Automate cloud flows. Review and revise filters in cloud flow queries and conditional logic.</div>

Answer:

Explanation:

Answer Area

Performance issue	Recommendation
Data changes are slow to save.	<div>▼</div> <div>Reduce usage of near real-time workflows. Convert all Dynamics 365 workflows to Power Automate cloud flows. Review and revise filters in cloud flow queries and conditional logic.</div>
Background processes often take hours to complete.	<div>▼</div> <div>Reduce usage of near real-time workflows. Convert all Dynamics 365 workflows to Power Automate cloud flows. Review and revise filters in cloud flow queries and conditional logic.</div>

Explanation:

Box 1: Reduce usage of near real-time workflows

A real-time workflow can be converted to asynchronous workflow and back to real-time.

Box 2: Review and revise filters in cloud flow queries and conditional logic We need to reduce the runtime. That won't happen if we don't take out complexity or optimize the logic.

Reference:

<https://docs.microsoft.com/en-us/dynamics365/customerengagement/on-premises/developer/create-real-time-workflows>

<https://rajeevpentya.com/2019/12/11/d365-switching-from-workflow-to-microsoft-power-automate-flow/>

NEW QUESTION # 46

You need to provide the IT specialists with design diagrams.

What should you provide?

- A. Entity relationship diagram (ERD)
- **B. Business process modeler (BPM)**
B AI Builder
- C. Dynamics 365 Product Visualize

Answer: B

Explanation:

Scenario: IT specialists want to design Power BI reports. They need to understand the underlying table relationships of the system. Business process modeler (BPM) in Microsoft Dynamics Lifecycle Services (LCS) is a tool that you can use to create, view, and modify repeatable implementations that are based on business process libraries. BPM helps you align your business processes with industry-standard processes that are described by the American Productivity & Quality Center (APQC)

Reference:

<https://docs.microsoft.com/en-us/dynamics365/fin-ops-core/dev-itpro/lifecycle-services/bpm-overview>

NEW QUESTION # 47

A multinational organization uses a single Microsoft Power Platform environment. The instance hosts multiple customizations for different users in different regions.

Users in some regions complain about slow load time of the customizations.

You need to architect a solution based on the main requirement.

What should you recommend? To answer, select the appropriate option in the answer area.

NOTE: Each correct selection is worth one point.

Goal	Suggested solution
Divisions actively collaborate on customers.	Single instance; use Microsoft Azure Traffic Manager where needed Multi-tenant with one Power Platform environment in each region Multiple instances in different regions; Power BI for reporting Single multi-geo instance
Regions have separate customers but use the same functionality and need global reporting.	Multiple instances in different regions with data replication Multi-tenant with one Power Platform environment in each region Multiple instances in different regions; Power BI for reporting Single multi-geo instance
Regions have separate functionality and customers but need global reporting on data.	Single instance; use Microsoft Azure Traffic Manager Multi-tenant with one Power Platform environment in each region Multiple instances in different regions; Power BI for reporting Single multi-geo instance

Answer:

Explanation:

Answer Area	
Goal	Suggested solution
Divisions actively collaborate on customers.	Single instance; use Microsoft Azure Traffic Manager where needed Multi-tenant with one Power Platform environment in each region Multiple instances in different regions; Power BI for reporting Single multi-geo instance
Regions have separate customers but use the same functionality and need global reporting.	Multiple instances in different regions with data replication Multi-tenant with one Power Platform environment in each region Multiple instances in different regions; Power BI for reporting Single multi-geo instance
Regions have separate functionality and customers but need global reporting on data.	Single instance; use Microsoft Azure Traffic Manager Multi-tenant with one Power Platform environment in each region Multiple instances in different regions; Power BI for reporting Single multi-geo instance

NEW QUESTION # 48

You are implementing a Microsoft Power Platform solution for a customer to include data migration from multiple legacy systems. The data includes lead and contact data. The environment includes an assigned security group.

The following issues have occurred during a go-live deployment attempt:

- * Lookup values are not populated when data migration is complete.
- * Data is being added to the contacts table that is not part of the data migration.
- * Various users do not appear in the list of users available for record assignment.

You need to resolve the go-live deployment issues.

How should you resolve the issue? To answer, select the appropriate options in the answer area.

NOTE: Each correct selection is worth one point.

ANSWER AREA



Microsoft

Issue

Lookup values are not populated when data migration is complete.

Data is being added to the contacts table that is not part of the data migration.

Various users do not appear in the list of users available for record assignment.

Solution

Split the import data into smaller import batches.	▼
Import the data by using an application user.	
Split the import data into smaller import batches.	
Disable all Power Automate flows, plug-ins, and workflows.	
Run data migration in a specific order.	
Disable all Power Automate flows, plug-ins, and workflows.	▼
Disable auditing.	
Import the data by using an application user.	
Disable all Power Automate flows, plug-ins, and workflows.	
Split the import data into smaller import batches.	
Add to a security group.	▼
Add to a security group.	
Add a security role.	
Add a Microsoft 365 role.	
Add a field security profile.	

Answer:

Explanation:

Issue	Solution
Lookup values are not populated when data migration is complete.	<div>Split the import data into smaller import batches.</div> <div>Import the data by using an application user.</div> <div>Split the import data into smaller import batches.</div> <div>Disable all Power Automate flows, plug-ins, and workflows.</div> <div>Run data migration in a specific order.</div>
Data is being added to the contacts table that is not part of the data migration.	<div>Disable all Power Automate flows, plug-ins, and workflows.</div> <div>Disable auditing.</div> <div>Import the data by using an application user.</div> <div>Disable all Power Automate flows, plug-ins, and workflows.</div> <div>Split the import data into smaller import batches.</div>
Various users do not appear in the list of users available for record assignment.	<div>Add to a security group.</div> <div>Add to a security group.</div> <div>Add a security role.</div> <div>Add a Microsoft 365 role.</div> <div>Add a field security profile.</div>

NEW QUESTION # 49

You need to recommend a solution to meet user interface requirements.

What should you recommend? To answer, select the appropriate options in the answer area.

NOTE: Each correct selection is worth one point.

Requirement	Solution
Visual representation of gauge readings with minimum and maximum tolerances.	<div>Create and embed a Power BI radial gauge.</div> <div>Create and embed a custom visualization component.</div> <div>Create and embed a standard Power Apps donut chart.</div>
Add visibility to the manufacturing inspection records for onsite technicians.	<div>Configure mobile offline synchronization.</div> <div>Add an inspection order to the work order form</div> <div>Modify the sitemap for Dynamics 365 Field Service.</div>

Answer:

Explanation:

Requirement	Solution
Visual representation of gauge readings with minimum and maximum tolerances.	<div>Create and embed a Power BI radial gauge.</div> <div>Create and embed a custom visualization component.</div> <div>Create and embed a standard Power Apps donut chart.</div>
Add visibility to the manufacturing inspection records for onsite technicians.	<div>Configure mobile offline synchronization.</div> <div>Add an inspection order to the work order form</div> <div>Modify the sitemap for Dynamics 365 Field Service.</div>

Explanation:

Requirement

Visual representation of gauge readings with minimum and maximum tolerances.

Add visibility to the manufacturing inspection records for onsite technicians.

Solution

Create and embed a Power BI radial gauge.
Create and embed a custom visualization component.
Create and embed a standard Power Apps donut chart.

Configure mobile offline synchronization.
Add an inspection order to the work order form
Modify the sitemap for Dynamics 365 Field Service.

Box 1: Create and embed a Power BI radial gauge

A radial gauge chart has a circular arc and shows a single value that measures progress toward a goal or a Key Performance Indicator (KPI). The line (or needle) represents the goal or target value. The shading represents the progress toward that goal. The value inside the arc represents the progress value. Power BI spreads all possible values evenly along the arc, from the minimum (left-most value) to the maximum (right-most value).



In this example, you're a car retailer tracking the sales team's average sales per month. The needle represents a 140 cars sales goal. The minimum possible average sales is 0 and the maximum is 200. The blue shading shows that the team is averaging approximately 120 sales this month.

Box 2: Add an inspection order to the work order form

You can add inspections to work orders in Dynamics 365 Field Service.

Field Service inspections are digital forms that technicians use to quickly and easily answer a list of questions as part of a work order. The list of questions can include safety protocols, pass-and-fail tests for a customer asset, an interview with a customer, or other audits and assessments performed before, during, or after a work order.

Example:

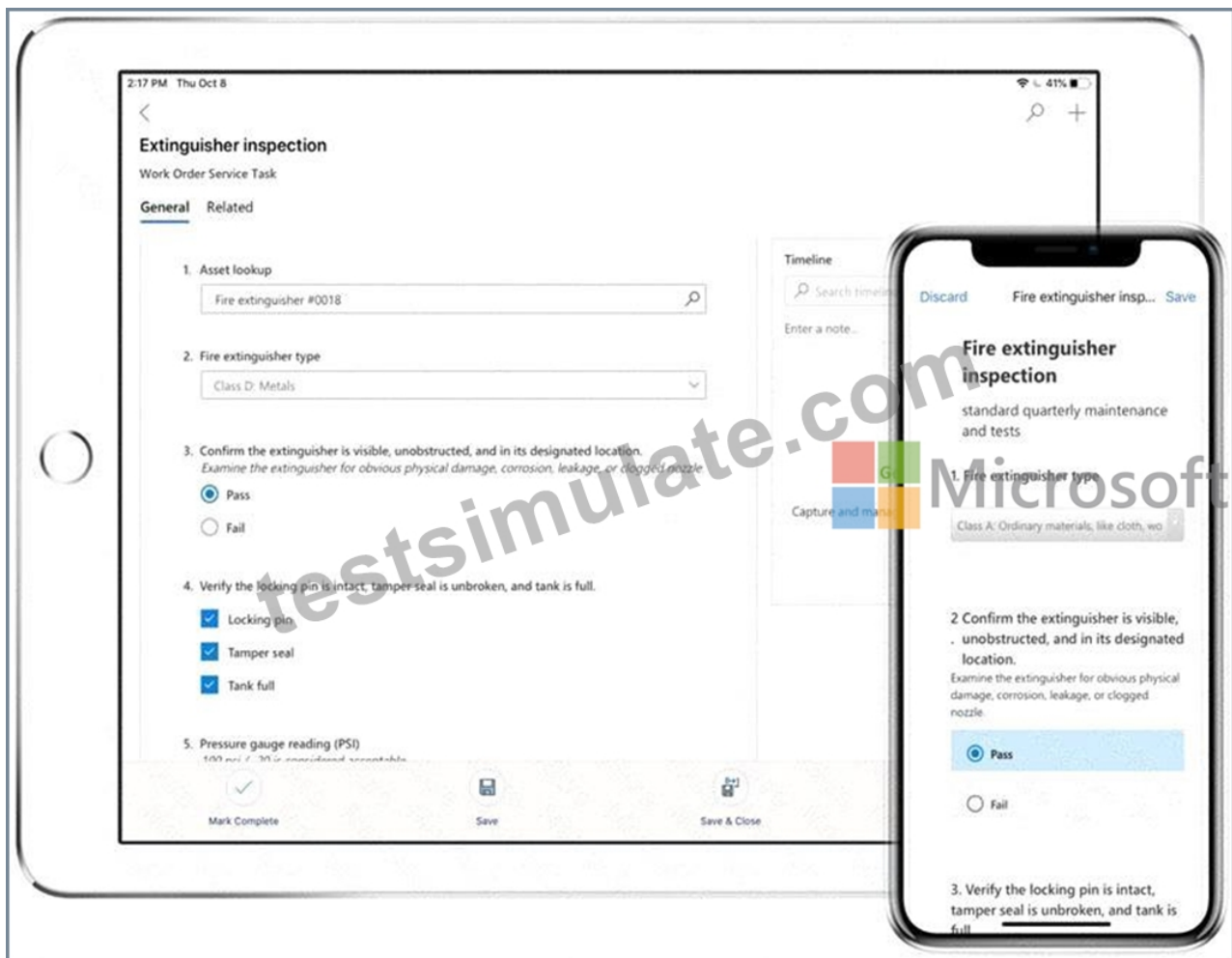

Reference:

<https://docs.microsoft.com/en-us/power-bi/visuals/power-bi-visualization-radial-gauge-charts>

<https://docs.microsoft.com/en-us/dynamics365/field-service/inspections>

Topic 4, VanArsde1, Ltd

Background

VanArsde1, Ltd. builds custom homes. The company has one Azure tenant and uses multiple systems to manage the sales, construction, and warranties of the homes.

The company has three departments: sales, construction, and warranty. Sales, contract, and warranty information is not shared among the departments.

The owner of VanArsde1, Ltd. requires a consolidated system that the company can use to track each home's progress.

Sales

- * Company employees use Microsoft Outlook for all communications.
- * Company employees use Microsoft Word to create sales contracts.
- * Employees in the sales department are frequently in different locations and work different hours from each other.
- * Employees in the sales department use a Contracts team in Microsoft Teams to collaborate.
- * The company uses a third-party marketing tool to update contacts every day.

Current environment

- * Contacts' names must be formatted before they are imported from the third-party marketing tool.
- * The company must retain contracts for five years.
- * The company requires that the sales department display the All Contracts view in Microsoft Teams.
- * All contract information must be stored in the All Contracts view.
- * Contracts must not be lost if a device is lost or stolen.

Issue

- * Employees in the sales department store contracts on their local computers.
- * The construction team receives a copy of a contract only when the sale of a home is complete.

Construction

Current environment

- * Employees in the construction department use Project Online to manage schedules.
- * Employees in the construction department use Microsoft Excel to manage the costs of projects
- * The main supplier of construction materials provides an API to the company. The company uses the API to manage supplies for

projects in near real time.

Requirements

- * Employees in the construction department must be able to demonstrate how their work is performed rather than document their process.
- * The company requires that project schedules be created less than a week after a contract is signed.
- * A field must sum up the costs of the materials.

Issues

- * Employees in the construction department are unable to schedule resources because they are not informed of future projects.
- * Employees in the construction department currently enter basic project information manually for each software application.

Warranty

Current environment

- * Employees in the warranty department use Excel to track project issues and resolutions.
- * The company requires that employees in the warranty department meet with each other in person to discuss their job roles.

Requirements

- * The company requires that warranty claims be resolved in less than a month.
- * The company requires that all claims be entered in the system along with their related issues.
- * If a claim is found to be invalid, the company requires that the claim and its related issues be deleted.

Issue

- * Employees in the warranty department report that they are frequently sent to homes without knowledge of what is in scope for the project.

General

Requirements

- * The new system must use the development and production environments
- * The development environment must be the master of all changes.
- * All table changes must be added to a solution. Changes to the solution must not be allowed to be made in the production environment.
- * Each department must have a custom app. Employees must be able to access only their department's app.
- * All sales, contract, and warranty data must be shared among the departments.
- * The project manager must be solely responsible for creating and owning the deployment plan for projects.
- * All projects must run by using the Agile methodology.
- * The deployment plan must include the environment setup, training plan, rollout strategy, and deployment support.

Issue

The IT manager reports that the deployment plan is not complete.

NEW QUESTION # 50

.....

Relevant PL-600 Answers: <https://www.testsimulate.com/PL-600-study-materials.html>

- Valid PL-600 Exam Vce ☐ Most PL-600 Reliable Questions ☐ PL-600 PDF Question ☐ Open website **【** www.troytecdumps.com **】** and search for ➡ PL-600 ☐ for free download ☐ Certification PL-600 Dump
- Microsoft PL-600 Latest Dumps – Affordable Price and Free Updates ☐ Download ➡ PL-600 ☐ for free by simply searching on ➡ www.pdfvce.com ☐ ☐ Test PL-600 Cram
- Quiz Microsoft - Efficient Training PL-600 Online ☐ Search for [PL-600] and download it for free immediately on ➡ www.examcollectionpass.com ☐ ☐ PL-600 Valid Examcollection
- Effective Microsoft PL-600: Training Microsoft Power Platform Solution Architect Online - Hot Pdfvce Relevant PL-600 Answers ☐ Search for ☐ PL-600 ☐ and download exam materials for free through **【** www.pdfvce.com **】** ☐ PL-600 Actual Dump
- PL-600 New Study Materials ☐ PL-600 Test Quiz ☐ Premium PL-600 Files ☐ Easily obtain ☐ PL-600 ☐ for free download through ➡ www.vce4dumps.com ☐ ☐ Latest PL-600 Test Notes
- PL-600 Valid Examcollection ☐ PL-600 Dumps PDF ☐ PL-600 Actual Dump ☐ Search for 「 PL-600 」 on ➡ www.pdfvce.com ☐ immediately to obtain a free download ☐ Vce PL-600 Test Simulator
- PL-600 Valid Examcollection ☐ PL-600 Actual Dump ☐ Premium PL-600 Files ☐ Immediately open ➡ www.vce4dumps.com ☐ and search for ➡ PL-600 ☐ ☐ ☐ to obtain a free download ☐ PL-600 Valid Examcollection
- Premium PL-600 Files ☐ Reliable PL-600 Exam Book ☐ Reliable PL-600 Exam Book ☐ Easily obtain > PL-600 < for free download through ✓ www.pdfvce.com ☐ ✓ ☐ ☐ PL-600 Dumps Guide
- 2026 Microsoft PL-600 Perfect Training Online ☐ Easily obtain ☐ PL-600 ☐ for free download through **【** www.examcollectionpass.com **】** ☐ Test PL-600 Cram
- PL-600 New Study Materials ☐ PL-600 Reliable Exam Pattern ☐ PL-600 Dumps PDF ☐ Search for ☀ PL-600 ☐ ☀ ☐ and easily obtain a free download on ☐ www.pdfvce.com ☐ ☐ PL-600 PDF Question

- [illegible]

P.S. Free 2025 Microsoft PL-600 dumps are available on Google Drive shared by TestSimulate: <https://drive.google.com/open?id=17om2GKIynygt6eKaARfL5OZCTCoKqkb7>