

# Quiz 2026 Microsoft Latest MB-335 Reliable Braindumps Files



P.S. Free & New MB-335 dumps are available on Google Drive shared by Prep4cram: <https://drive.google.com/open?id=1RWNC5gs6hSzVo8iJdc-7QS7WpUbnMa3I>

You will be feeling be counteracted the effect of tension for our Microsoft MB-335 practice dumps can relieve you of the anxious feelings. Our Microsoft Dynamics 365 Supply Chain Management Functional Consultant Expert practice materials are their masterpiece full of professional knowledge and sophistication to cope with the Microsoft MB-335 Exam. They have sublime devotion to their career just like you, and make progress ceaselessly.

Earning the Microsoft MB-335 certification is an excellent way to demonstrate one's expertise in Dynamics 365 Supply Chain Management. Microsoft Dynamics 365 Supply Chain Management Functional Consultant Expert certification validates the candidate's ability to provide effective supply chain solutions using Dynamics 365. Moreover, holding the MB-335 certification distinguishes an individual in the industry and increases their marketability. Microsoft Dynamics 365 Supply Chain Management Functional Consultant Expert certification also open doors to advanced roles such as Dynamics 365 Supply Chain Management Functional Consultant Expert.

Microsoft MB-335 Certification Exam is a highly sought-after certification for those interested in advancing their career in supply chain management. Microsoft Dynamics 365 Supply Chain Management Functional Consultant Expert certification exam is designed to test the candidate's knowledge and skills in implementing and configuring Microsoft Dynamics 365 Supply Chain Management solutions. Certified professionals with this credential demonstrate their proficiency in managing supply chain operations, including manufacturing, logistics, and inventory.

**>> MB-335 Reliable Braindumps Files <<**

## **MB-335 Latest Test Vce & MB-335 Valid Test Pdf**

MB-335 learning materials are high-quality, because we have a professional team to collect the latest information for the exam. We can ensure you that MB-335 exam braindumps you receive is the latest information we have. Our company is strict with the quality and answers, therefore you just need to use them at ease. We offer you free demo to have a try before buying MB-335 Exam Dumps, so that you can have a better understanding of what you are going to buy. In addition, you can receive the download link

and password within ten minutes, and if you don't, you can contact us, and we will solve that for you.

Microsoft MB-335 certification exam is for Dynamics 365 professionals who plan, implement, and manage supply chain management solutions for businesses. MB-335 exam is aimed at supply chain management professionals who have the expertise to implement Dynamics 365 Supply Chain Management solutions effectively. The MB-335 Certification Exam is part of the requirements needed to become a Dynamics 365 Supply Chain Management Functional Consultant Expert—a sought-after professional in the industry who helps organization optimize their supply chain management processes.

## Microsoft Dynamics 365 Supply Chain Management Functional Consultant Expert Sample Questions (Q120-Q125):

### NEW QUESTION # 120

You need to address the ignition switch issue.

Which three actions should you perform? Each answer presents part of the solution.

NOTE: Each correct selection is worth one point.

- A. Set product readiness to manual.
- B. Change product lifecycle state.
- C. Copy link and products.
- D. Set product readiness to automatic.
- E. Define business impact.

**Answer: A,B,E**

Explanation:

Topic 5, A. Datum Corporation Background

A). Datum Corporation is a golf cart manufacturing and rental company. The company produces golf carts, converts them to assets, and then rents them out over a period of time. The engineering team continuously seeks to create innovative, sustainable golf carts to stay current in the industry.

Although the company no longer creates gas-powered vehicles, some of its models are still in use as rentals.

A). Datum Corporation plans to move from multiple, disconnected systems for each team of employees to a connected platform that uses Dynamics 365 Finance and Dynamics 365 Supply Chain Management.

Current Environment

Employee teams

\* A. Datum Corporation has four key teams of employees:

o Procurement: A team of buyers who source raw materials for the production of the golf carts.

o Engineering: A team of engineering designers who continuously modify and improve the bill of materials (BOM) for the golf carts.

o Production: A team of production employees, including quality assurance (QA), who manages the BOM costs and work on the shop floor to produce the golf carts

o Asset Management: A team that manages the golf cart assets, including maintenance and repairs.

\* The company has strict controls and uses engineering change management within its end-to-end operations.

Golf cart models

\* All new golf carts are rechargeable electric models.

\* The company has three primary golf cart models:

o ModelA is manufactured for commercial customers, such as golf courses. Those golf courses rent ModelA for a fixed period of time.

o ModelA contains subassemblies that are produced by A. Datum Corporation and stored in the warehouse until required for production.

o ModelB is manufactured for consumers and can be rented by vacationers, typically for a weekend.

o ModelB must include turn signals and brake lights to ensure that it is legal to drive on city streets.

o ModelB golf carts are typically stored in a rented parking lot during peak vacation season.

o During the off-season, ModelB is stored in A. Datum Corporation's headquarters warehouse

o ModelT units are gas-powered units that have been discontinued for production, however, existing assets are available for rent.

\* All models are considered low-speed vehicles and must not exceed 25 mph.

\* All golf cart models are owned by A. Datum Corporation. None are owned by commercial customers.

Requirements

Engineering

\* The engineering manager plans to phase out production of the current steel frames and replace them with aluminum frames.

\* Innovation engineers observe an increase in consumer requests for lifted-style golf carts. ModelB will be used to create a prototype of a newer version.

Production

- \* Golf cart frames for all models must be configured as subassemblies.
- \* The engineering team plans for the lift kit shocks and struts to be assembled for the prototype as a single production order for the lift kit finished good. The lift kit will remain at the end of the assembly line for the prototype.
- \* The QA team must conduct a rigorous set of mandatory tests for the ModelB prototype. Only certified QA team members can complete the checklists. The item will not be available for production until the prototype passes testing.
- \* The lithium batteries must be installed by a certified technician during production.
- \* The raw materials used in the prototype model are also sold directly as spare parts.
- \* The controller requires raw material consumption to be posted in the ledger separately for the prototype production orders.
- \* The warehouse manager requires that ModelA subassemblies must have putaway work created for the warehouse workers. All other subassemblies and finished goods will not require warehouse work. The lift kit subassembly must have a new standard cost created o Cost Requirement 1: The costs for existing materials are frozen for a period. The incremental costs must be calculated without impacting current frozen costs, o Cost Requirement 2: The incremental cost for the subassembly must be determined based on the raw material purchased parts before it is available as a price.

Asset management

- \* All electric models can be serviced on a quarterly schedule, which is less frequent than the bimonthly gas- powered models.
- \* The controller requires ModelB to be repped separately from other models, and the location of the assets updated at each peak travel season.
- \* Maintenance technicians run a lean schedule and are fully booked out in advance.

Issues Procurement.

- \* Buyer 1 reports that the master planning process generated planned purchase orders for steel frame subassemblies. Return orders were created for the steel frames, which should not have been ordered.

Production

- \* The production manager reports that the lithium battery installation step is creating a production backup because of two issues:
  - o Issue 1: Technicians who are not certified are assigned to the battery installation step.
  - o Issue 2: One certified technician is always on site at the production facility; the other certified technician is on call for repairs to rentals and is only substitutes for other technicians occasionally for production.

Asset management

- \* A golf course manager reports that multiple ModelT units are frequently slow to start. The golf course manager requests monthly inspections for ModelT units, but the ModelA units can keep their current schedule.
- \* After the ModelT unit issue was addressed, the golf course manager reports that one of the ModelA units stopped charging. The golf course manager requests a priority repair to be scheduled for the next morning.

**NEW QUESTION # 121**

You need to meet the substitution requirements for User4 and User5.

What must you configure? To answer, drag the appropriate configurations to the correct substitution requirements. Each configuration may be used once, more than once, or not at all. You may need to drag the split bar between panes or scroll to view content.

NOTE: Each correct selection is worth one point.

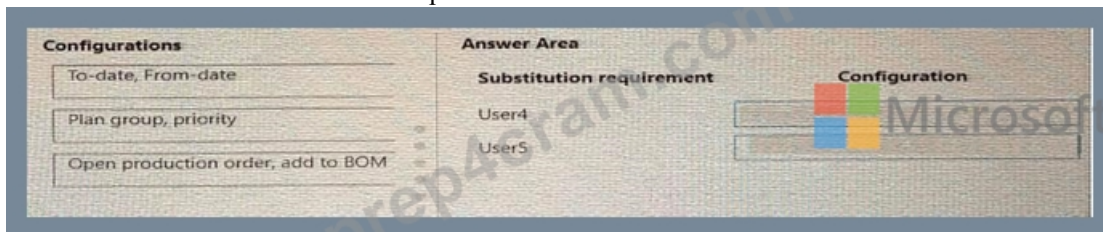

**Answer:**

Explanation:

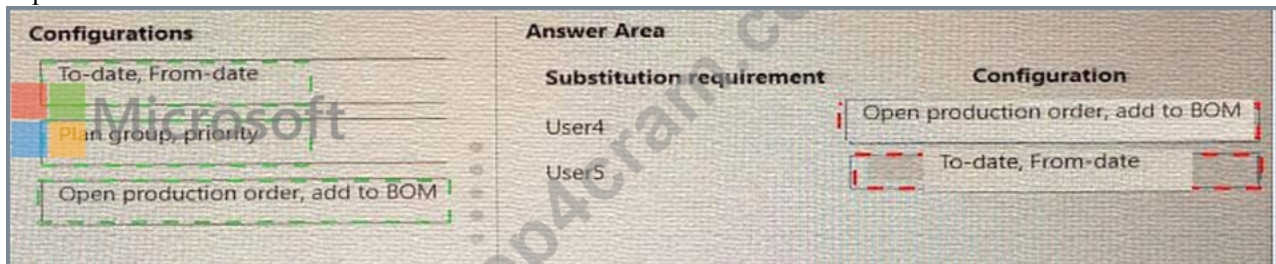

Explanation:

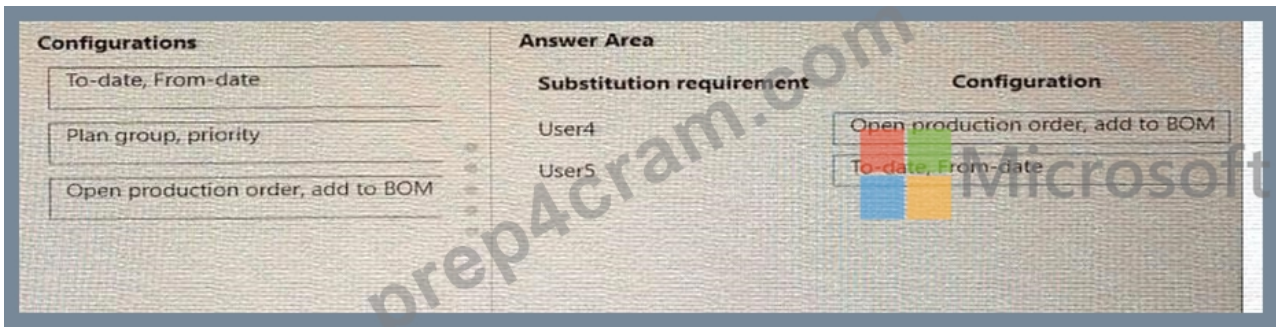

**NEW QUESTION # 122**

A manufacturer sends wiring harnesses to a vendor to be soldered to a connector. You create the subcontracting process in the bill of materials (BOM) and route to account for the items sent to the vendor.

You need to set up a new item model group for the service item.

Which three actions should you perform? To answer, move the appropriate actions from the list of actions to the answer area and arrange them in the correct order.

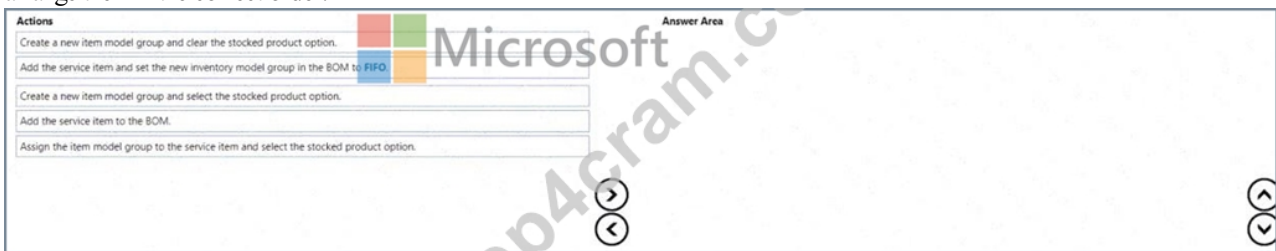

**Answer:**

**Explanation:**

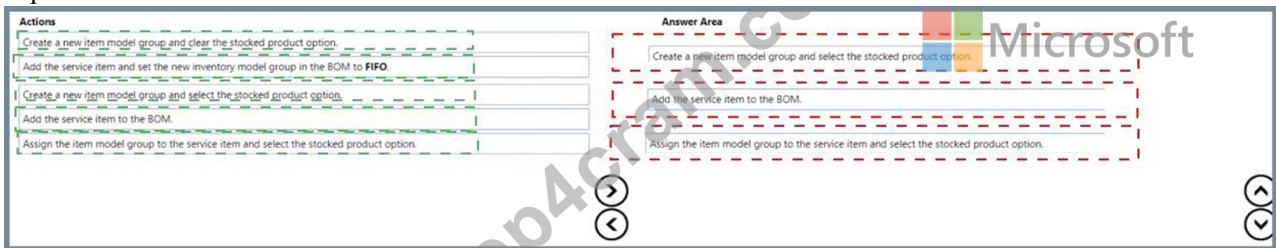

**Explanation:**

A screenshot of a computer AI-generated content may be incorrect.

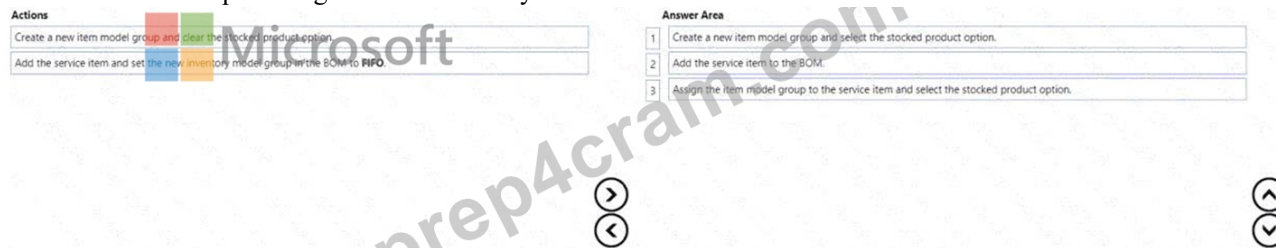

**NEW QUESTION # 123**

A company sells chemicals that require special instructions for disposal and remediation due to toxicity regulatory requirements. The company requires that when a sales order's packing slip is printed for a product that contains a toxic chemical, the instructions must also be printed for inclusion in the shipment.

You need to configure the system to meet the requirements.

Which configurations should you use? To answer, select the appropriate options in the answer area.

NOTE: Each correct selection is worth one point.

Answer Area



Requirement	Configuration
Attach the instructions.	Safety data sheet
Upload the instructions to the system.	Attachments

**Answer:**

Explanation:

Answer Area

Requirement	Configuration
Attach the instructions.	Safety data sheet
Upload the instructions to the system.	Attachments

Explanation:

Answer Area

Requirement	Configuration
Attach the instructions.	Safety data sheet
Upload the instructions to the system.	Attachments

### NEW QUESTION # 124

A company produces paints and assembles bicycle frames.

You must account for paint drying time before assembly operations can begin.

You need to set up the operation to encompass queue times.

Which two options can you use? Each correct answer presents part of the solution.

NOTE: Each correct selection is worth one point.

- A. Enter a value in the queue time before field for the assembly operation.
- B. Build capabilities for each resource related to color.
- C. Enter a value in the queue time after field for the painting operation.
- D. Enter a value in the transit time on the painting operation.
- E. Make a resource group for each size and color and assign that group to the operation.

**Answer: A,C**

Explanation:

\* Queue time is the time that a job waits at a work center before or after the job is processed1. You can use queue time to account for paint drying time before assembly operations can begin. You can specify queue time in minutes, hours, or days on the route operations that are attached to the production order2.

\* To set up the operation to encompass queue times, you should do the following:

\* Enter a value in the queue time after field for the painting operation. This value indicates how long the painted bicycle frames must wait at the painting work center before they can be moved to

\* the next operation<sup>2</sup>. For example, if the paint drying time is 24 hours, you can enter 24 in the queue time after field and select Hours as the unit.

\* Enter a value in the queue time before field for the assembly operation. This value indicates how long the painted bicycle frames must wait at the assembly work center before they can be processed<sup>2</sup>. For example, if there is a delay between the arrival of the frames and the start of the assembly, you can enter a value that reflects this delay in the queue time before field and select the appropriate unit.

\* The other options are not correct, because they do not involve queue times. Building capabilities for each resource related to color would allow you to assign resources based on their color proficiency, but it would not account for paint drying time. Entering a value in the transit time on the painting operation would indicate how long it takes to move the painted bicycle frames from one work center to another, but it would not include the waiting time before or after the movement. Making a resource group for each size and color and assigning that group to the operation would allow you to group resources that have similar characteristics and can be used interchangeably in production, but it would not affect the queue times.

1: Queue times 2: Set up operations scheduling

## NEW QUESTION # 125

.....

**MB-335 Latest Test Vce:** [https://www.prep4cram.com/MB-335\\_exam-questions.html](https://www.prep4cram.com/MB-335_exam-questions.html)

- Free Download MB-335 Reliable Braindumps Files - High-quality MB-335 Latest Test Vce Ensure You a High Passing Rate  Easily obtain  MB-335   for free download through [ [www.vceengine.com](http://www.vceengine.com) ]  MB-335 Latest Exam Simulator
- Free Download MB-335 Reliable Braindumps Files - High-quality MB-335 Latest Test Vce Ensure You a High Passing Rate  Open website  [www.pdfvce.com](http://www.pdfvce.com)  and search for  MB-335   for free download  MB-335 Exam Topics Pdf
- 2026 MB-335 Reliable Braindumps Files - Realistic Microsoft Dynamics 365 Supply Chain Management Functional Consultant Expert Latest Test Vce  The page for free download of  MB-335  on  [www.examcollectionpass.com](http://www.examcollectionpass.com)  will open immediately  Exam MB-335 Format
- Microsoft MB-335 Reliable Braindumps Files - Pass MB-335 in One Time - Microsoft MB-335 Latest Test Vce  Download  MB-335  for free by simply searching on  [www.pdfvce.com](http://www.pdfvce.com)   Exam MB-335 Format
- Exam MB-335 Format  Study MB-335 Tool  Certification MB-335 Dump  Search for  MB-335  and easily obtain a free download on  [www.practicevce.com](http://www.practicevce.com)  MB-335 Latest Exam Experience
- Valid MB-335 Exam Cost  Vce MB-335 Test Simulator  New MB-335 Practice Questions  Go to website  [www.pdfvce.com](http://www.pdfvce.com)   open and search for  « MB-335 »  to download for free  Real MB-335 Exam
- Test MB-335 Topics Pdf  MB-335 Exam Topics Pdf  MB-335 Exam Bible  Enter  [www.verified.dumps.com](http://www.verified.dumps.com)  and search for [ MB-335 ] to download for free  New MB-335 Practice Questions
- MB-335 Exam Bible  Valid MB-335 Exam Cost  Certification MB-335 Dump  Download  【 MB-335 】  for free by simply searching on  [www.pdfvce.com](http://www.pdfvce.com)   Study MB-335 Tool
- Test MB-335 Topics Pdf  Test MB-335 Topics Pdf  Reliable MB-335 Test Book  { [www.pdfdumps.com](http://www.pdfdumps.com) } is best website to obtain  MB-335  for free download  Practice MB-335 Tests
- MB-335 Latest Exam Simulator  Real MB-335 Exam  MB-335 Testking  Search for  【 MB-335 】  and obtain a free download on  [www.pdfvce.com](http://www.pdfvce.com)   MB-335 Testking
- Certification MB-335 Dump  MB-335 Real Dumps  Practice MB-335 Tests  Search for  「 MB-335 」  on  [www.pass4test.com](http://www.pass4test.com)  immediately to obtain a free download  MB-335 Real Dumps
- [elodiemwp463812.fare-blog.com](http://elodiemwp463812.fare-blog.com), [shop.youtubevhaibd.com](http://shop.youtubevhaibd.com), [maedlqn599984.laowaiablog.com](http://maedlqn599984.laowaiablog.com), [jessefpgm041802.wikiannouncement.com](http://jessefpgm041802.wikiannouncement.com), [indexedbookmarks.com](http://indexedbookmarks.com), [directory-fast.com](http://directory-fast.com), [get-social-now.com](http://get-social-now.com), [lilianrczs724761.scrappingwiki.com](http://lilianrczs724761.scrappingwiki.com), [bookmarkpagerank.com](http://bookmarkpagerank.com), [flynnrjod394679.salesmanwiki.com](http://flynnrjod394679.salesmanwiki.com), Disposable vapes

DOWNLOAD the newest Prep4cram MB-335 PDF dumps from Cloud Storage for free: <https://drive.google.com/open?id=1RWNC5gs6hSzVo8iJdc-7QS7WpUbnMa3I>