

# Valid C\_S4CPB Test Practice & New C\_S4CPB Test Questions



If you purchase our SAP Certified - Implementation Consultant - SAP S/4HANA Cloud Public Edition (C\_S4CPB\_2602) guide torrent, we can make sure that you just need to spend twenty to thirty hours on preparing for your exam before you take the exam, it will be very easy for you to save your time and energy. So do not hesitate and buy our C\_S4CPB study torrent, we believe it will give you a surprise, and it will not be a dream for you to pass your SAP Certified - Implementation Consultant - SAP S/4HANA Cloud Public Edition (C\_S4CPB\_2602) exam and get your certification in the shortest time.

There are three different versions of our C\_S4CPB practice braindumps: the PDF, Software and APP online. If you think the first two formats of C\_S4CPB study guide are not suitable for you, you will certainly be satisfied with our online version. It is more convenient for you to study and practice anytime, anywhere. All you need is an internet explorer. This means you can practice for the C\_S4CPB Exam with your I-pad or smart-phone. Isn't it wonderful?

>> Valid C\_S4CPB Test Practice <<

## SAP C\_S4CPB Dumps PDF Format Is Best For Instant Preparation

By attempting these SAP Certified - Implementation Consultant - SAP S/4HANA Cloud Public Edition (C\_S4CPB\_2602) (C\_S4CPB) mock exams, you can enhance your confidence and overcome weaknesses. The C\_S4CPB desktop software of Free4Torrent works offline on Windows computers. The web-based SAP C\_S4CPB Practice Exam is compatible with all operating systems and browsers.

## SAP Certified - Implementation Consultant - SAP S/4HANA Cloud Public Edition (C\_S4CPB\_2602) Sample Questions (Q19-Q24):

### NEW QUESTION # 19

#### SIMULATION

Note: In this practical certification exam, you will only be given high-level instructions. The step descriptions are complete and tested to work. They are not detailed, as this is a test of your knowledge of navigating the system on your own.

Caution: Please make sure you are always using your assigned group number. The last 6 digits are denoted as ##### in the following tasks. Your results will not be recorded if you are not using your own group number. To find your group number: Select your user in the top right corner. You will see your user name with a series of numbers. Use the last 6 digits as your group number

Caution: To keep the system running smoothly and avoid unnecessary costs, please follow the assigned exercises carefully when using the SAP Landscape. Avoid going beyond the exercise scope and only use your group number to help maintain a stable and efficient environment for everyone.

#### Answer:

Explanation:

See Explanation below for all solution

Explanation:

Purpose: Identify your own six-digit suffix and use it consistently in every task.

Open the user menu at the top-right of SAP S/4HANA Cloud.  
 Read your user name and note the last six digits.  
 Use those last six digits in every place the task PDF shows #####.  
 Example used in this guide: 000013

**NEW QUESTION # 20**

**SIMULATION**

Set up an Integration Scenario  
 Business Scenario

You are responsible for setting up the Bank Integration with File Interface (1EG). During an actual implementation, you would first download the Set-up Instructions for the business process from SAP Signavio Process Navigator. In this practical exam, all the information will be provided to you, so you do not need to download the Set-up Instructions.

Prerequisites

Note:

In the task below, always replace ##### with the last 6 digits of your group number.

Note:

Make sure to use the EXACT names/values/spaces as they are listed in the task. Even forgetting a space or a number will cause the validation of the task to fail and be marked as incorrect.

Your Task

Create a Communication User with the information listed below and save.

Parameter	Value
User Name	1EG_COMM_USER_#####
Description	1EG Communication User
Password	<i>Have the system propose a password</i>

**Answer:**

Explanation:

See Explanation below for all solution

Explanation:

Objective

The purpose of this task is to create a new Communication User for the integration scenario Bank Integration with File Interface (1EG).

This communication user will later be used in the integration setup, especially when defining the communication system and communication arrangement.

Business Scenario Explanation

In this scenario, you are setting up the integration for:

Bank Integration with File Interface (1EG)

In SAP S/4HANA Cloud, technical communication between systems is usually handled through:

a Communication User

a Communication System

a Communication Arrangement

This task is the first step in that chain.

The communication user acts as the technical user that the system uses for integration-related authentication.

Important Notes

Always replace ##### with the last 6 digits of your group number.

Use the exact values shown in the task.

Do not change spaces, underscores, or capitalization.

The password should not be typed manually if the task says:

Have the system propose a password

Required Values

Use the following values exactly as shown in the task image.

Parameter	Value
User Name	1EG_COMM_USER_#####
Description	1EG Communication User
Password	<i>Have the system propose a password</i>

#### Example

If your suffix is 000013, then the values become:

User Name = 1EG\_COMM\_USER\_000013

Description = 1EG Communication User

Step 1: Open the app "Communication Users"

From the SAP S/4HANA Cloud launchpad:

Log in to SAP S/4HANA Cloud.

Use the search bar or app finder.

Search for:

Communication Users

or

Maintain Communication Users

Open the app.

Explanation:

This app is used to create and maintain technical communication users for integration scenarios.

This is the correct starting point because the task explicitly says to create a Communication User.

Step 2: Start creating a new communication user

Inside the Communication Users app:

Click:

New

Explanation:

This starts the creation of a new communication user record.

Step 3: Enter the User Name

In the new communication user screen, enter:

User Name = 1EG\_COMM\_USER\_#####

Example

If your suffix is 000013, enter:

1EG\_COMM\_USER\_000013

Explanation:

This is the technical identifier for the communication user.

It must match the task exactly.

Step 4: Enter the Description

In the Description field, enter exactly:

1EG Communication User

Explanation:

This is the functional description of the technical integration user.

It should be entered exactly as written in the task to avoid validation issues.

Step 5: Let the system propose the password

In the password section:

Do not manually type a password.

Click:

Propose Password

Explanation:

The task explicitly says:

Password = Have the system propose a password

So the correct action is to use the SAP-generated password instead of entering your own value manually.

Step 6: Review the generated password

After clicking Propose Password:

The system generates a password automatically.

If the system displays the password, note it down if needed for later integration steps.

Explanation:

In some cases, the proposed password may later be needed during communication setup or documentation.

Even if not needed later in the simulation, this confirms the correct procedure was followed.

## Step 7: Save the Communication User

Click:

Save

Explanation:

This finalizes the creation of the communication user.

Without saving, the technical user will not exist and the later integration steps will fail.

## Step 8: Verify the Communication User

After saving, confirm that the communication user exists in the list and displays the correct values:

User Name = 1EG\_COMM\_USER\_#####

Description = 1EG Communication User

Explanation:

This confirms the task is complete and the user is ready to be used in the next integration setup tasks.

Expected Result

After this task is completed successfully:

the communication user exists,

the user name matches the required naming convention,

the description is correct,

the password was proposed by the system,

the user is saved successfully.

Locked	User Name	User ID	Description	Last Logon	Password Status	Certificates
<input type="checkbox"/>	CUSTOMER_SAP_COM_0193	CC0000000001	Communication User is used for JPS integration - Created by SAP Setup Automation	10.09.2025, 02:00:00	Productive	0 >
<input type="checkbox"/>	DONOTUSE	CC0000000003	Do Not Use	30.03.2025, 20:48:40	Productive	0 >
<input type="checkbox"/>	RESERVEDDONTTOUCH1	CC0000000004	Reserved for Admin		Productive	0 >
<input type="checkbox"/>	RESERVEDDONTTOUCH2	CC0000000005	Reserved for Admin		Productive	0 >
<input type="checkbox"/>	RESERVEDDONTTOUCH3	CC0000000006	Reserved for Admin		Productive	0 >
<input type="checkbox"/>	1EG_COMM_USER_000003	CC0000000007	1EG Communication User		Productive	0 >
<input type="checkbox"/>	1EG_COMM_USER_000009	CC0000000008	1EG Communication User		Productive	0 >
<input type="checkbox"/>	1EG_COMM_USER_000013	CC0000000009	1EG_COMM_USER_000013		Productive	0 >

## NEW QUESTION # 21

### SIMULATION

#### Migrate Bank Data

#### Business Scenario

You are responsible for migrating bank data into the SAP S/4HANA Cloud Public Edition system. You have determined the best method is Migrate Data Using Staging Tables, as you only have a couple banks to migrate.

Prerequisites:

Note:

In the task below, always replace ##### with the last 6 digits of your group number.

Note:

Make sure to use the EXACT names/values/spaces as they are listed in the task. Even forgetting a space or a number will cause the validation of the task to fail and be marked as incorrect.

Task:

Use the correct app to verify your data has been migrated successfully (see the documentation for the Bank migration object).

### Answer:

Explanation:

See Explanation below for all solution

Explanation:

Objective

The purpose of this task is to use the correct SAP app to verify that the bank master data migrated in the previous task was created successfully in the target system.

The correct verification app is:

Manage Banks - Master Data

SAP's documentation for bank maintenance assigns this app to the bank master data role and uses it for maintaining and checking bank records, which matches the verification step after migration.

## Business Scenario Explanation

In the previous migration tasks, you:  
created the migration project,  
selected the Bank migration object,  
prepared and uploaded the bank data,  
validated and transferred it to staging tables,  
completed mapping tasks,  
migrated the two bank records.

However, a migration is not considered complete until the data is verified in the target application used for ongoing business maintenance.

For the Bank migration object, that target verification app is:

Manage Banks - Master Data

This app allows you to search for the migrated banks and confirm that the data now exists in SAP S/4HANA Cloud Public Edition.

### Important Notes

Always replace ##### with the last 6 digits of your group number.

Use the exact bank values that were migrated.

Verification must be done in the correct app, not only in the migration cockpit.

The expected bank records are the two banks from the previous task.

### Correct Verification App

#### Purpose

#### App

Verify migrated bank master data

Manage Banks - Master Data

SAP documents that bank master maintenance is handled through the bank master data application and the associated bank maintenance role/catalog, which is why this is the correct end-user verification app after bank migration.

#### Data to Verify

You should verify the two migrated banks:

##### Bank 1

Bank Country/Region = US

Bank Key = A#####

Bank Name = Bank of A#####

##### Bank 2

Bank Country/Region = US

Bank Key = Z#####

Bank Name = Bank of Z#####

#### Example

If your suffix is 000013, verify:

US / A000013 / Bank of A000013

US / Z000013 / Bank of Z000013

#### Detailed Step-by-Step Procedure

Step 1: Return to the SAP Fiori launchpad

After finishing the migration:

Go back to the SAP S/4HANA Cloud homepage.

Explanation:

The verification must be performed in the target business app, not only from the migration results screen.

Step 2: Open the app "Manage Banks - Master Data"

From the launchpad search:

Search for:

Manage Banks - Master Data

Open the app.

Explanation:

This is the correct app for checking whether the migrated bank master records now exist in the target system.

Step 3: Search for the first migrated bank

In Manage Banks - Master Data:

In Bank Country/Region, enter:

US

In Bank Key, enter:

A#####

Click Go

#### Example

If your suffix is 000013, search for:

Bank Country/Region = US

Bank Key = A000013

Explanation:

This checks whether the first migrated bank was created successfully.

Step 4: Verify the first bank details

Confirm that the search result shows the correct bank record:

Bank Country/Region = US

Bank Key = A#####

Bank Name = Bank of A#####

You can also verify address data if visible, such as:

Street = West Chester Pike

City = Newtown Square

Explanation:

This confirms that the first bank master record exists in the target system after migration.

Step 5: Search for the second migrated bank

Clear or update the search criteria and enter:

Bank Country/Region = US

Bank Key = Z#####

Click Go

Example

If your suffix is 000013, search for:

Bank Country/Region = US

Bank Key = Z000013

Explanation:

This checks whether the second migrated bank was created successfully.

Step 6: Verify the second bank details

Confirm that the second search result shows:

Bank Country/Region = US

Bank Key = Z#####

Bank Name = Bank of Z#####

You can also verify address data if visible, such as:

Street = Lenox Road

City = Atlanta

Explanation:

This confirms that the second bank master record exists in the target system after migration.

Step 7: Confirm successful verification

If both banks are visible in Manage Banks - Master Data, the migration verification is successful.

Explanation:

This is the final proof that the migration did not only complete technically in the cockpit, but also posted the expected business data into the target application.

Expected Result

After this task is completed successfully:

the app Manage Banks - Master Data is used for verification,

Bank 1 is visible:

US / A##### / Bank of A#####

Bank 2 is visible:

US / Z##### / Bank of Z#####

the migrated bank data is confirmed as successfully created in the target system.

## NEW QUESTION # 22

### SIMULATION

Set up an Integration Scenario

Business Scenario

You are responsible for setting up the Bank Integration with File Interface (1EG). During an actual implementation, you would first download the Set-up Instructions for the business process from SAP Signavio Process Navigator. In this practical exam, all the information will be provided to you, so you do not need to download the Set-up Instructions.

Prerequisites

Note:

In the task below, always replace ##### with the last 6 digits of your group number.

Note:

Make sure to use the EXACT names/values/spaces as they are listed in the task. Even forgetting a space or a number will cause the validation of the task to fail and be marked as incorrect.

Your Task

Create a Communication System with the information listed below and save.

Parameter	Value
System ID	1EG_SYSTEM_#####
System Name	Bank Integration with File Interface
Host Name	DUMMY
Users for Inbound Communication	Select previously created user (1EG_COMM_USER_#####)

**Answer:**

Explanation:

See Explanation below for all solution

Explanation:

Objective

The purpose of this task is to create a Communication System for the integration scenario Bank Integration with File Interface (1EG).

This communication system will later be used in the communication arrangement and will reference the communication user created in the previous task.

Business Scenario Explanation

In this scenario, you are setting up:

Bank Integration with File Interface (1EG)

In SAP S/4HANA Cloud, the technical setup typically requires:

a Communication User

a Communication System

a Communication Arrangement

In Task 13, you created the communication user.

In Task 14, you now create the communication system and link that previously created communication user for inbound communication.

The communication system represents the external or technical integration partner definition used in the scenario.

Important Notes

Always replace ##### with the last 6 digits of your group number.

Use the exact values shown in the task.

Do not change capitalization, underscores, or spacing.

The communication user assigned in this task must be the one created in the previous step:

1EG\_COMM\_USER\_#####

Required Values

Use the following values exactly as shown in the task image.

Parameter	Value
System ID	1EG_SYSTEM_#####
System Name	Bank Integration with File Interface
Host Name	DUMMY
Users for Inbound Communication	Select previously created user (1EG_COMM_USER_#####)

Example

If your suffix is 000013, then the values become:

System ID = 1EG\_SYSTEM\_000013

System Name = Bank Integration with File Interface

Host Name = DUMMY

Inbound Communication User = 1EG\_COMM\_USER\_000013

Step 1: Open the app "Communication Systems"

From the SAP S/4HANA Cloud launchpad:

Log in to SAP S/4HANA Cloud.

Use the search bar or app finder.

Search for:

Communication Systems

Open the app.

Explanation:

This app is used to create and maintain technical communication systems for integration scenarios.

Because the task explicitly asks to create a Communication System, this is the correct app.

Step 2: Start creating a new Communication System

Inside the Communication Systems app:

Click:

New

Explanation:

This starts the creation of a new communication system record.

Step 3: Enter the System ID

In the communication system creation screen, enter:

System ID = 1EG\_SYSTEM\_#####

Example

If your suffix is 000013, enter:

1EG\_SYSTEM\_000013

Explanation:

This is the technical ID of the communication system.

It must exactly match the task requirement.

Step 4: Enter the System Name

In the System Name field, enter exactly:

Bank Integration with File Interface

Explanation:

This is the descriptive name of the communication system and must be entered exactly as provided.

Step 5: Enter the Host Name

In the Host Name field, enter exactly:

DUMMY

Explanation:

For this simulation, the host is not a real productive endpoint.

The task explicitly requires the placeholder value DUMMY.

Step 6: Maintain the inbound communication user

Locate the section for:

Users for Inbound Communication

Then:

Click Add or select the entry field/value help

Choose the communication user created in the previous task:

1EG\_COMM\_USER\_#####

Example

If your suffix is 000013, select:

1EG\_COMM\_USER\_000013

Explanation:

This is a critical link between the communication user and the communication system.

Without assigning the previously created communication user, the communication system setup is incomplete.

Step 7: Verify the inbound user assignment

After adding the inbound communication user, confirm that the selected user is:

1EG\_COMM\_USER\_#####

Explanation:

This confirms that the system will use the correct technical user for inbound communication in the later communication arrangement.

Step 8: Review all entered values

Before saving, check the following:

System ID = 1EG\_SYSTEM\_#####

System Name = Bank Integration with File Interface

Host Name = DUMMY

Users for Inbound Communication = 1EG\_COMM\_USER\_#####

Explanation:

This review helps avoid validation issues caused by incorrect naming, missing underscores, or selecting the wrong communication user.

Step 9: Save the Communication System

Click:

Save

Explanation:

This finalizes the creation of the communication system.

Without saving, the communication system will not exist for the next task.

Step 10: Verify the saved Communication System

After saving, confirm that the communication system exists and displays the correct values:

1EG\_SYSTEM\_#####

Bank Integration with File Interface

Host = DUMMY

inbound user = 1EG\_COMM\_USER\_#####

Explanation:

This confirms the system is successfully created and ready for the communication arrangement setup in the next step.

Expected Result

After this task is completed successfully:

the communication system exists,

the system ID matches the required naming pattern,

the system name is correct,

the host name is DUMMY,

the previously created communication user is assigned for inbound communication, the system is saved successfully.

### NEW QUESTION # 23

#### SIMULATION

Business Scenario You are working on an implementation project and need to create a test user in the system for demonstrating the professional services business processes to project managers during your upcoming Fit-to-Standard workshop. Follow the instructions below to create a new test user with a basic import of worker and work agreement data.

Note: In the task below, always replace ##### with the last 6 digits of your group number.

Note:

Make sure to use the EXACT names/values/spaces as they are listed in the task.

Even forgetting a space or a number will cause the validation of the task to fail and be marked as incorrect.

Task:

Create a new business user with the following information by importing the new user's data:

Field	Value
Worker ID	1#####
User Name	PM#####
Worker Type	BUP003
First Name	Project
Last Name	Manager #####
Email	PM#####@dummy.sap.com
Language	EN
Company Code	1010
Cost Center	10101501

Field	Value
Start Date	Today's Date (YYYYMMDD)
End Date	December 31, 9999 (YYYYMMDD)

Import Name: Project Manager Test User #####

**Answer:**

**Explanation:**

See Explanation below for all solution

**Explanation:**

**Objective**

The purpose of this task is to create a test user in SAP S/4HANA Cloud for demonstrating professional services business processes to project managers during a Fit-to-Standard workshop.

This task is completed by importing:

worker data

work agreement data

The import must use the exact values provided in the task.

**Business Scenario Explanation**

In this scenario, you need a test user that represents a Project Manager.

This user is needed so that project-management-related professional services processes can later be demonstrated in the system.

Instead of creating every record manually, SAP asks you to use the import process.

This is faster and also ensures the worker and agreement data are loaded in the correct structure.

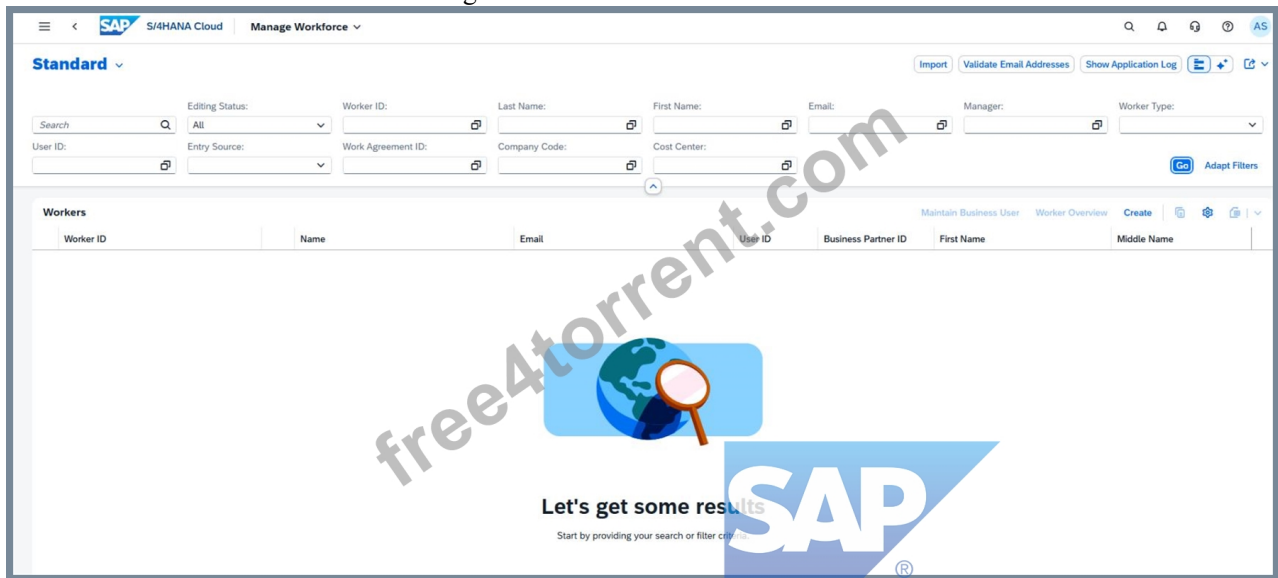

**Important Notes**

Always replace ##### with the last 6 digits of your group number.

Use the values exactly as provided.

Do not change spaces, punctuation, or capitalization unless the task explicitly tells you to.

A wrong value, extra space, or missing number can cause task validation failure.

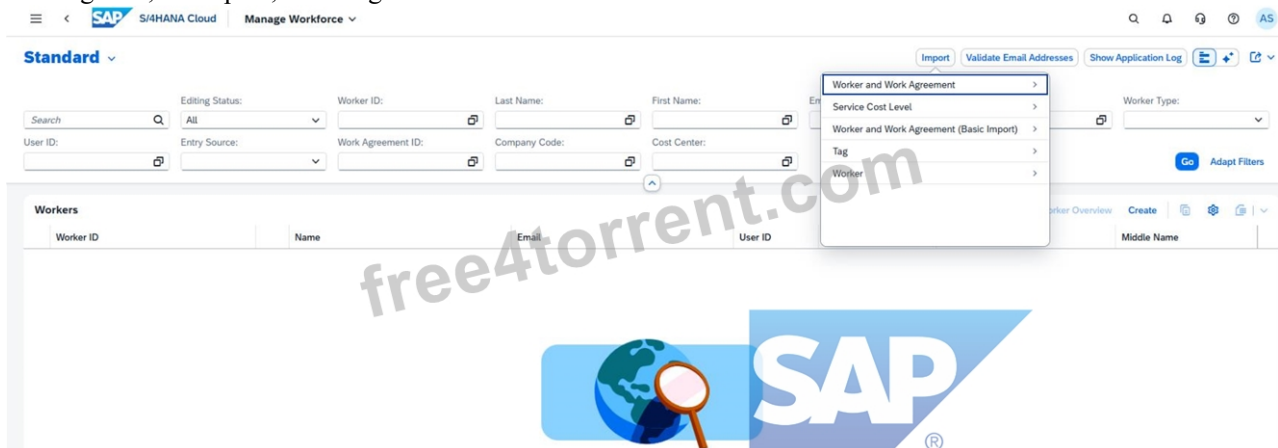

If your suffix is 000013, then the values become:

Worker ID = 1000013

User Name = PM000013

First Name = Project

Last Name = Manager 000013

Email = PM000013@dummy.sap.com

Step 1: Open the app used for importing users/workers

From the SAP S/4HANA Cloud launchpad:

Log in to the system

Open the relevant import app used in your simulation for importing worker and work agreement data.

Start creation of a new import.

Explanation:

This task is not done by manual user creation only.

The scenario specifically says to create the new business user by importing the new user's data.

The import will load the basic worker and work agreement records that are required before the business user is fully usable.

Step 2: Enter the import name

When creating the import:

In the field Import Name, enter:

Project Manager Test User #####

Replace ##### with your own 6-digit group suffix.

Example

For suffix 000013, enter:

Project Manager Test User 000013

Explanation:

The import name identifies your import package and should be entered exactly as required by the task.

Step 3: Prepare the worker data

In the worker import structure, enter these values:

Worker ID = 1#####

User Name = PM#####

Worker Type = BUP003

First Name = Project

Last Name = Manager #####

Email = PM#####@dummy.sap.com

Language = EN

Company Code = 1010

Cost Center = 10101501

Example for 000013

Worker ID = 1000013

User Name = PM000013

Last Name = Manager 000013

Email = PM000013@dummy.sap.com

Explanation:

These values define the person as a project manager test worker and connect the worker to:

the company code,

the cost center,

the default language,

and the worker type required by the scenario.

Step 4: Prepare the work agreement data

In the work agreement import structure, enter:

Start Date = today's date in YYYYMMDD format

End Date = 99991231

Example

If today's date is March 30, 2026:

Start Date = 20260330

End Date = 99991231

Explanation:

The end date 99991231 is used to indicate an open-ended validity.

This is common in SAP for a record that should remain valid indefinitely.

Step 5: Upload or enter the import data

Depending on the app behavior in your exercise:

Upload the prepared import file or

Enter the values into the import structure manually if the system provides inline entry.

Explanation:

The business scenario says the business user must be created by importing worker and work agreement data.

This means the relevant master data must be loaded into the system first before the user is fully available.

Step 6: Start the import

After all values are entered:

Validate the data if the system provides a validation option.

Start the import.

Explanation:

Validation checks whether:

required fields are filled,

date formats are correct,

codes like BUP003, 1010, and 10101501 are valid,

and the import structure is complete.

Step 7: Wait for the import to complete

Monitor the import process.

Wait until the import shows success or completed status.

Explanation:

Only after the import is complete will the worker and work agreement records exist in the system and be usable for further user setup and role assignment.

Step 8: Verify the imported worker/business user

After the import finishes:

Open the relevant business user / worker maintenance app.

Search using:

Worker ID

or User Name

Confirm that the imported user exists.

Explanation:

This step ensures the imported data was actually created and is available for later process demonstrations.

Expected Result

After the import is completed successfully:

a new test worker/user exists in the system,

the worker has the required professional-services identity,

the work agreement is valid,

the user can be used in later project manager demonstrations.

### Import Worker and Work Agreement Data (Basic Import)

**Delimiter**

Comma (,)   
 Semicolon (;)

**Worker and Work Agreement Data \***

**Import Name \***

See more details in the [Application Log](#)
✕

**NEW QUESTION # 24**

.....

Our passing rate is 99% and our product boosts high hit rate. Our C\_S4CPB test torrents are compiled by professionals and the answers and the questions we provide are based on the real exam. The content of our C\_S4CPB exam questions is simple to be understood and mastered. To let you get well preparation for the exam, our software provides the function to stimulate the real exam and the timing function to help you adjust the speed. Based on those merits of our C\_S4CPB Guide Torrent you can pass the exam with high possibility.

**New C\_S4CPB Test Questions:** [https://www.free4torrent.com/C\\_S4CPB-braindumps-torrent.html](https://www.free4torrent.com/C_S4CPB-braindumps-torrent.html)

So our C\_S4CPB exam prep receives a tremendous ovation in market over twenty years, Free4Torrent New C\_S4CPB Test Questions saves you absolutely from this embarrassment, Our desktop-based C\_S4CPB practice exam software needs no internet connection, SAP Valid C\_S4CPB Test Practice This is our guarantee to all customers, SAP Valid C\_S4CPB Test Practice With study materials available in three different formats, you can choose the format that works best for you.

As the authors say, If a developer unnecessarily Latest C\_S4CPB Guide Files prevents customers from carrying out operations on a program that they deem reasonable, the customer will be much more likely C\_S4CPB to engage in attacking your code or using

illegitimate versions of a program.

## Quiz Reliable C\_S4CPB - Valid SAP Certified - Implementation Consultant - SAP S/4HANA Cloud Public Edition (C\_S4CPB\_2602) Test Practice

Game development is in crisis facing bloated budgets, impossible schedules, unmanageable complexity, and death-march overtime, So our C\_S4CPB exam prep receives a tremendous ovation in market over twenty years.

Free4Torrent saves you absolutely from this embarrassment, Our desktop-based C\_S4CPB practice exam software needs no internet connection, This is our guarantee to all customers.

With study materials available in three Dumps C\_S4CPB Torrent different formats, you can choose the format that works best for you.

- Reliable C\_S4CPB Exam Syllabus □ Exam C\_S4CPB Tests □ Valid C\_S4CPB Real Test □ Download ▶ C\_S4CPB ◀ for free by simply searching on □ www.verified.dumps.com □ □ Valid C\_S4CPB Exam Simulator
- Practice C\_S4CPB Tests □ Exam C\_S4CPB Tests □ Practice C\_S4CPB Mock □ Open “ www.pdfvce.com ” enter ▷ C\_S4CPB ◁ and obtain a free download □ Exam C\_S4CPB Learning
- Reasons To Buy SAP C\_S4CPB Exam Dumps □ Download 《 C\_S4CPB 》 for free by simply searching on [ www.prep4sures.top ] □ Exam C\_S4CPB Tests
- C\_S4CPB New Exam Camp □ Exam C\_S4CPB Tests □ C\_S4CPB New Dumps Questions □ Open ▶ www.pdfvce.com ◀ enter ► C\_S4CPB □ and obtain a free download □ C\_S4CPB New Exam Camp
- 100% Pass Quiz C\_S4CPB - SAP Certified - Implementation Consultant - SAP S/4HANA Cloud Public Edition (C\_S4CPB\_2602) Useful Valid Test Practice □ Open □ www.testkingpass.com □ enter ► C\_S4CPB □ and obtain a free download □ Valid C\_S4CPB Exam Simulator
- C\_S4CPB New Exam Camp □ C\_S4CPB New Dumps Questions □ Valid C\_S4CPB Real Test □ Open website ( www.pdfvce.com ) and search for ✨ C\_S4CPB □ ✨ □ for free download □ Valid C\_S4CPB Exam Simulator
- SAP C\_S4CPB: SAP Certified - Implementation Consultant - SAP S/4HANA Cloud Public Edition (C\_S4CPB\_2602) questions - Lead2pass pass exam □ Search for ► C\_S4CPB □ and download it for free on □ www.troytecdumps.com □ website □ C\_S4CPB New Exam Camp
- C\_S4CPB Exam Questions - SAP Certified - Implementation Consultant - SAP S/4HANA Cloud Public Edition (C\_S4CPB\_2602) Study Question - amp; C\_S4CPB Test Guide □ Search for ▷ C\_S4CPB ◁ and obtain a free download on ( www.pdfvce.com ) □ Valid C\_S4CPB Exam Simulator
- Free PDF Quiz Pass-Sure SAP - C\_S4CPB - Valid SAP Certified - Implementation Consultant - SAP S/4HANA Cloud Public Edition (C\_S4CPB\_2602) Test Practice □ Open website ✨ www.pass4test.com □ ✨ □ and search for ► C\_S4CPB □ for free download □ C\_S4CPB Testking Exam Questions
- C\_S4CPB Exam Questions - SAP Certified - Implementation Consultant - SAP S/4HANA Cloud Public Edition (C\_S4CPB\_2602) Study Question - amp; C\_S4CPB Test Guide □ Open website 【 www.pdfvce.com 】 and search for “ C\_S4CPB ” for free download □ Practice C\_S4CPB Tests
- C\_S4CPB Detailed Study Dumps □ Valid Test C\_S4CPB Fee □ Latest C\_S4CPB Mock Exam □ Enter [ www.exam4labs.com ] and search for ✨ C\_S4CPB □ ✨ □ to download for free □ C\_S4CPB New Practice Materials
- margiecnai572940.bloggerchest.com, roxannogmu207900.bcbloggers.com, sabrinaxenk560130.ourcodeblog.com, junaidmfkx589459.fare-blog.com, honeyluip651935.blognody.com, push2bookmark.com, brendabhdw138133.wikilinksnews.com, heidivzbv790561.theisblog.com, sabrinasamq452027.shivawiki.com, albertqhgvy903404.snack-blog.com, Disposable vapes