

EDGE-Expert최신버전인기덤프 - EDGE-Expert최고품 질덤프문제보기

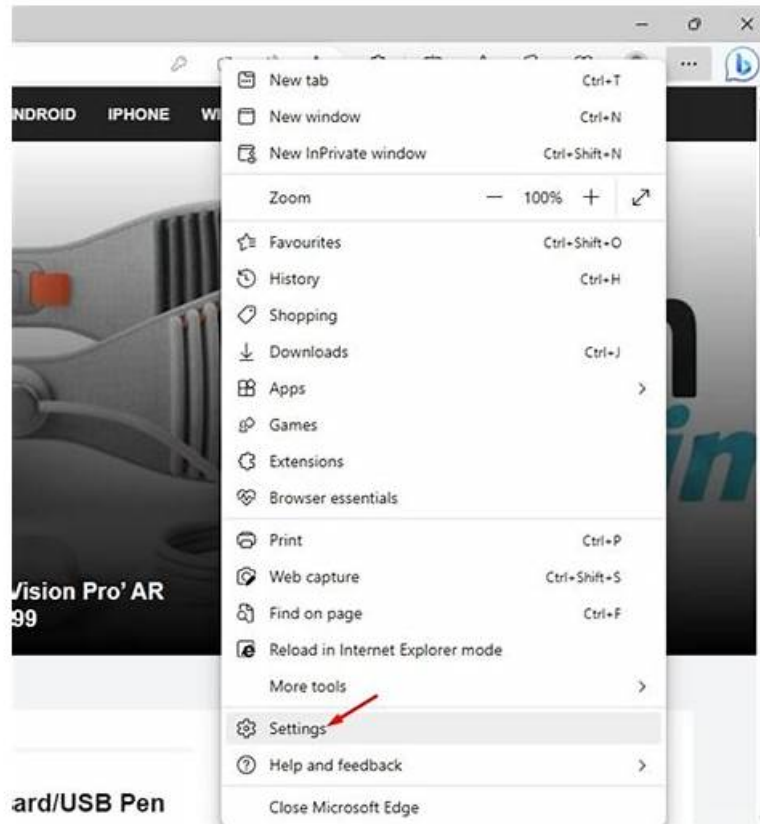

2026 DumpTOP 최신 EDGE-Expert PDF 버전 시험 문제집과 EDGE-Expert 시험 문제 및 답변 무료 공유:
<https://drive.google.com/open?id=1jeLy6mBg09Jk2UbJdh8SrutDe63YaA71>

여러분은EDGE EDGE-Expert인증시험을 패스함으로 IT업계관련 직업을 찾고자하는 분들에게는 아주 큰 가산점이 될수 있으며, 성명한 IT업계사업자와 한걸음 가까와 집니다.

그렇게 많은 IT인증덤프공부자료를 제공하는 사이트중DumpTOP의 인지도가 제일 높은 원인은 무엇일가요?그건 DumpTOP의 제품이 가장 좋다는 것을 의미합니다. DumpTOP에서 제공해드리는 EDGE인증 EDGE-Expert덤프공부 자료는EDGE인증 EDGE-Expert실제시험문제에 초점을 맞추어 시험커버율이 거의 100%입니다. 이 덤프만 공부하시면EDGE인증 EDGE-Expert시험패스에 자신을 느끼게 됩니다.

>> EDGE-Expert최신버전 인기덤프 <<

높은 통과율 EDGE-Expert최신버전 인기덤프 덤프샘플문제

DumpTOP선택으로EDGE EDGE-Expert시험을 패스하도록 도와드리겠습니다. 우선 우리DumpTOP 사이트에서EDGE EDGE-Expert관련자료의 일부 문제와 답 등 샘플을 제공함으로 여러분은 무료로 다운받아 체험해보실 수 있습니다. 체험 후 우리의DumpTOP에 신뢰감을 느끼게 됩니다. DumpTOP에서 제공하는EDGE EDGE-Expert덤프로 시험 준비 하세요. 만약 시험에서 떨어진다면 덤프전액환불을 약속 드립니다.

최신 GBCI EDGE EDGE-Expert 무료샘플문제 (Q73-Q78):

질문 # 73

Which of the following is a required measure?

- A. Lighting controls
- B. Efficient lighting for internal areas

- C. Insulation of roof
- D. Green roof

정답: C

설명:

In EDGE, certain measures are mandatory to ensure a baseline level of resource efficiency, while others are optional depending on the project's goals. The EDGE User Guide specifies mandatory measures for certification: "To achieve EDGE certification, projects must meet minimum requirements, including mandatory measures such as insulation of the roof to reduce heat gain or loss, ensuring a basic level of energy efficiency across all building typologies in climates where thermal performance is relevant" (EDGE User Guide, Section 4.1: Insulation Measures). Option B, insulation of roof, is identified as a required measure in EDGE, particularly in climates where heating or cooling loads are significant, which applies to most regions.

Option A (green roof) is an optional measure, not mandatory: "Green roofs are an optional measure in EDGE, contributing to energy and water savings but not required for certification" (EDGE User Guide, Section 4.5:

Additional Energy Measures). Option C (lighting controls) is also optional, as EDGE allows flexibility in lighting strategies: "Lighting controls, such as occupancy sensors, are optional measures that can enhance energy savings but are not mandatory" (EDGE User Guide, Section 4.4: Lighting Efficiency Measures).

Option D (efficient lighting for internal areas) is encouraged but not required: "Efficient lighting for internal areas (EEM22) is an optional measure, requiring at least 90% of lamps to be efficient, but projects can achieve certification without it if other energy measures meet the 20% savings threshold" (EDGE User Guide, Section 4.4: Lighting Efficiency Measures). The EDGE Certification Protocol reinforces this: "Mandatory measures like roof insulation ensure a minimum standard of energy efficiency, while measures like green roofs, lighting controls, and efficient lighting are optional and contribute to overall savings" (EDGE Certification Protocol, Section 2.2: Certification Requirements). Therefore, insulation of the roof (Option B) is the required measure among the options.

Reference: EDGE User Guide Version 2.1, Section 4.1: Insulation Measures, Section 4.4: Lighting Efficiency Measures, Section 4.5: Additional Energy Measures; EDGE Certification Protocol, Section 2.2: Certification Requirements.

질문 # 74

EDGE methodology is NOT based on which of the following factors?

- A. Building type and occupant use
- B. Climatic conditions of location
- C. Electricity and water bills
- D. Design and specifications

정답: C

설명:

The EDGE methodology is designed to calculate resource savings using standardized inputs that reflect the building's context and design, rather than actual operational data. The EDGE Methodology Report outlines the factors used: "The EDGE methodology is based on climatic conditions of the location, building type and occupant use, and design and specifications. Climatic conditions determine heating and cooling loads, building type and occupant use define usage patterns (e.g., residential vs. hotel), and design and specifications include details like insulation levels, glazing properties, and system efficiencies" (EDGE Methodology Report Version 2.0, Section 2.1: Calculation Approach). Option A (climatic conditions of location), Option B (building type and occupant use), and Option C (design and specifications) are all integral to the methodology. However, Option D (electricity and water bills) is not a factor in EDGE calculations, as the methodology uses predictive modeling, not actual consumption data: "EDGE does not base its calculations on electricity and water bills, as these reflect operational performance rather than design potential. Instead, EDGE uses standardized assumptions about energy and water use based on building type, location, and design inputs" (EDGE User Guide, Section 2.1: EDGE Software Overview). The EDGE Methodology Report further clarifies: "Actual utility bills are not used in EDGE, as the software focuses on predicted savings at the design stage, not post-occupancy performance, except in cases like EDGE Zero Carbon certification where operational data is required" (EDGE Methodology Report Version 2.0, Section 2.2: Data Inputs). Since this question pertains to the general EDGE methodology (not Zero Carbon), electricity and water bills are not a factor. The EDGE User Guide also states: "The methodology relies on theoretical models to estimate resource use, ensuring consistency across projects, rather than variable operational data like utility bills" (EDGE User Guide, Section 2.3: Using the EDGE App). Thus, electricity and water bills (Option D) are not part of the EDGE methodology.

Reference: EDGE Methodology Report Version 2.0, Section 2.1: Calculation Approach, Section 2.2: Data Inputs; EDGE User Guide Version 2.1, Section 2.1: EDGE Software Overview, Section 2.3: Using the EDGE App.

질문 # 75

In a 3-star business hotel near the city center, which of the following elements of the building's water use breakdown is/are likely to consume the most water?

- A. Toilets in lobby area
- **B. Showers in guest rooms**
- C. Laundry
- D. Faucets in guest rooms

정답: B

설명:

Water consumption in hotels varies significantly based on usage patterns, with guest-related activities often dominating the water use breakdown. The EDGE User Guide provides detailed insights into water use in hotels: "In a typical 3-star business hotel, the largest contributor to water consumption is showers in guest rooms, accounting for approximately 40-50% of total water use due to frequent guest showers, especially in urban hotels with high occupancy. Laundry, toilets, and faucets also contribute, but to a lesser extent, with laundry at 15-20%, toilets at 10-15%, and faucets at 5-10%" (EDGE User Guide, Section 5.2: Water Efficiency Measures). Option A, showers in guest rooms, aligns with this breakdown as the element likely to consume the most water. Option B (laundry) is significant but lower than showers: "Laundry in 3-star hotels consumes less water than showers, as laundry is typically centralized and less frequent than daily guest showers" (EDGE Methodology Report Version 2.0, Section 4.2: Water Savings Calculations). Option C (toilets in lobby area) is a minor contributor, as lobby toilets serve fewer users compared to guest rooms: "Toilets in public areas like the lobby have lower usage compared to guest room facilities, contributing only a small fraction of total water use in hotels" (EDGE User Guide, Section 5.2: Water Efficiency Measures).

Option D (faucets in guest rooms) also uses less water than showers: "Faucets in guest rooms, used for handwashing or brushing teeth, have lower flow rates and usage frequency compared to showers, which often run for 5-10 minutes per use" (EDGE Methodology Report Version 2.0, Section 4.2: Water Savings Calculations). The EDGE User Guide further elaborates: "In business hotels, showers dominate water use due to high occupancy and guest behavior, making measures like low-flow shower heads particularly effective for water savings" (EDGE User Guide, Section 5.2: Water Efficiency Measures). The EDGE Methodology Report adds: "For a 3-star hotel with 100 rooms and 70% occupancy, showers can account for 45 liters per guest per day, compared to 15 liters for laundry, 10 liters for toilets, and 5 liters for faucets, based on standard usage assumptions" (EDGE Methodology Report Version 2.0, Section 4.2: Water Savings Calculations).

Thus, showers in guest rooms (Option A) are likely to consume the most water in this context.

Reference:EDGE User Guide Version 2.1, Section 5.2: Water Efficiency Measures; EDGE Methodology Report Version 2.0, Section 4.2: Water Savings Calculations.

질문 # 76

An EDGE Auditor has received initial documentation from a Client which implies that measures not selected on the downloaded PDF can be claimed. What should the Auditor do?

- A. The Auditor should ask for advice from the EDGE Partner and then take action.
- B. As submission documents are correct, the Auditor should ignore the error on PDF.
- **C. Inform the Client to update the EDGE software and prepare a new PDF.**
- D. The Auditor should modify the self-assessment and submit the project for certification.

정답: C

설명:

The EDGE audit process requires that the documentation submitted by the Client accurately reflects the self-assessment in the EDGE software, ensuring consistency and transparency. The EDGE Expert and Auditor Protocols address discrepancies in documentation: "If an EDGE Auditor identifies a discrepancy between the submitted documentation and the self-assessment PDF, such as measures being claimed that were not selected in the EDGE software, the Auditor must inform the Client to update the EDGE software to reflect the correct measures and prepare a new PDF for submission. This ensures that the audit is based on an accurate representation of the project's claims" (EDGE Expert and Auditor Protocols, Section 4.2: Evidence Verification). Option C, inform the Client to update the EDGE software and prepare a new PDF, directly aligns with this protocol, as it corrects the error at the source and ensures the self-assessment matches the claimed measures. Option A (ask for advice from the EDGE Partner) is unnecessary, as the protocol provides clear guidance: "Auditors are expected to follow standard procedures for discrepancies without needing to consult the EDGE Partner, unless the issue involves a policy interpretation beyond the protocols" (EDGE Expert and Auditor Protocols, Section 4.1: Audit Process). Option B (modify the self-assessment and submit) is unethical and prohibited, as Auditors cannot alter the Client's submission: "The Auditor must not modify the Client's self-assessment in the EDGE software, as this compromises the independence of the audit process; the Client is responsible for updating the assessment" (EDGE Certification Protocol, Section 3.2).

Audit Requirements). Option D (ignore the error on PDF) is also incorrect, as ignoring discrepancies violates audit integrity. "All discrepancies between the PDF and submitted documents must be resolved before the audit proceeds, as ignoring errors could lead to incorrect certification outcomes" (EDGE Expert and Auditor Protocols, Section 4.2: Evidence Verification). The EDGE User Guide further reinforces: "The self-assessment PDF must accurately reflect the measures selected in the EDGE software, and any mismatch requires the Client to revise the assessment to ensure a fair and transparent audit" (EDGE User Guide, Section 6.2: Documentation Requirements). Thus, the Auditor should inform the Client to update the software and prepare a new PDF (Option C).

Reference:EDGE Expert and Auditor Protocols, Section 4.2: Evidence Verification, Section 4.1: Audit Process; EDGE Certification Protocol, Section 3.2: Audit Requirements; EDGE User Guide Version 2.1, Section 6.2: Documentation Requirements.

질문 # 77

Which building typology should benefit the most from having a wastewater treatment and recycling system?

- A. Office
- B. School
- C. Hotel
- D. Homes

정답: C

설명:

Wastewater treatment and recycling systems are evaluated in EDGE for their potential to reduce water consumption, a key aspect of green building design. The EDGE User Guide highlights the varying water usage patterns across building typologies: "Hotels typically have high water consumption due to guest rooms, laundry, and amenities like pools, making them ideal candidates for wastewater treatment and recycling systems, which can significantly reduce potable water demand by reusing treated water for non-potable uses such as irrigation and flushing" (EDGE User Guide, Section 5.2: Water Efficiency Measures). In contrast, homes (Option A) and offices (Option D) generally have lower per-capita water use, and schools (Option C) have intermittent occupancy, reducing the overall impact of such systems. The EDGE Methodology Report further supports this, noting: "For hotels, greywater and blackwater recycling can achieve up to 40% water savings due to high occupancy and consistent demand, compared to 20-25% in homes or offices" (EDGE Methodology Report Version 2.0, Section 4.2: Water Savings Calculations). Thus, hotels (Option B) benefit the most from wastewater treatment and recycling systems due to their high water usage and potential for significant savings.

Reference:EDGE User Guide Version 2.1, Section 5.2: Water Efficiency Measures; EDGE Methodology Report Version 2.0, Section 4.2: Water Savings Calculations.

질문 # 78

.....

DumpTOP의EDGE EDGE-Expert 인증시험덤프는 자주 업데이트 되고, 오래 되고 더 이상 사용 하지 않는 문제들은 바로 삭제해버리며 새로운 최신 문제들을 추가 합니다. 이는 응시자가 확실하고도 빠르게EDGE EDGE-Expert덤프를 마스터하고EDGE EDGE-Expert시험을 패스할수 있도록 하는 또 하나의 보장입니다. 매력만점EDGE EDGE-Expert덤프 강력 추천합니다.

EDGE-Expert최고품질 덤프문제보기: <https://www.dumptop.com/EDGE/EDGE-Expert-dump.html>

여러분이 신뢰가 생길수 있도록 EDGE-Expert덤프구매 사이트에 무료샘플을 설치해두었습니다.무료샘플에는 5개 이상의 문제가 있는데 구매하지 않으셔도 공부가 됩니다, 이는 응시자가 확실하고도 빠르게EDGE EDGE-Expert덤프를 마스터하고EDGE EDGE-Expert시험을 패스할수 있도록 하는 또 하나의 보장입니다, EDGE EDGE-Expert최신버전 인기덤프 패스할확율은 아주 낮습니다, IT업계 종사자라면 누구나 EDGE 인증EDGE-Expert시험을 패스하고 싶어하리라고 믿습니다, EDGE인증 EDGE-Expert시험은 IT인증자격증을 취득하는 시험과목입니다.어떻게 하면 난이도가 높아 도전할 자신이 없는 자격증을 한방에 취득할수 있을가요, EDGE EDGE-Expert최신버전 인기덤프 구매후 1년간 덤프가 업데이트될때마다 업데이트된 자료를 무료로 제공해드립니다.

생각해보니 선주가 회수를 보는 것도 별로 좋지 않을 것 같았다, 담채봉은 반사적으로 손을 뻗어 피가 솟구치는 여우의 배를 막았다, 여러분이 신뢰가 생길수 있도록 EDGE-Expert덤프구매 사이트에 무료샘플을 설치해두었습니다. 무료샘플에는 5개이상의 문제가 있는데 구매하지 않으셔도 공부가 됩니다.

시험대비 EDGE-Expert최신버전 인기덤프 덤프 최신 데모문제

이는 응시자가 확실하고도 빠르게EDGE EDGE-Expert덤프를 마스터하고EDGE EDGE-Expert시험을 패스할수 있도록

특 하는 또 하나의 보장입니다, 패스할 확률은 아주 낮습니다, IT업계 종사자라면 누구나 EDGE 인증EDGE-Expert 시험을 패스하고 싶어하리라고 믿습니다.

EDGE인증 EDGE-Expert시험은 IT인증자격증을 취득하는 시험과목입니다.어떻게 하면 난이도가 높아 도전할 자신
이 없는 자격증을 한방에 취득할 수 있을까요?

- [illegible]

그리고 DumpTOP EDGE-Expert 시험 문제집의 전체 버전을 클라우드 저장소에서 다운로드할 수 있습니다:
<https://drive.google.com/open?id=1jeLy6mBg09Jk2UbJdh8SrutDe63YaA71>