

Project-Planning-Design테스트자료 & Project-Planning-Design시험대비덤프데모다운



BONUS!!! KoreaDumps Project-Planning-Design 시험 문제집 전체 버전을 무료로 다운로드하세요:
https://drive.google.com/open?id=1pD8P5fDiuXhFZAstfKG_QMysY2PBXaqc

목표를 이루는 방법은 여러가지가 있는데 어느 방법을 선택하면 가장 빨리 목표를 이룰수 있을가요? NCARB인증 Project-Planning-Design시험을 패스하는 길에는KoreaDumps의NCARB인증 Project-Planning-Design덤프를 공부하는 것이 가장 좋은 방법이라는것을 굳게 약속드립니다. KoreaDumps의NCARB인증 Project-Planning-Design덤프는 시험문제에 초점을 두어 제작된 공부자료이기에NCARB인증 Project-Planning-Design패스를 가장 빠른 시일내에 한방에 할 수 있도록 도와드립니다.

NCARB Project-Planning-Design 시험요강:

| 주제 | 소개 |
|------|---|
| 주제 1 | <ul style="list-style-type: none"> Environmental Conditions & Context: This section of the exam measures skills of architectural designers and covers how to use site analysis information to determine building placement and environmental planning decisions. It emphasizes applying sustainable principles and considering the neighborhood context to guide project design. |
| 주제 2 | <ul style="list-style-type: none"> Codes & Regulations: This section of the exam measures the skills of project architects and focuses on applying zoning laws, environmental rules, and building codes during the planning stage. Candidates are tested on how to integrate multiple regulatory requirements into a project's design effectively. |
| 주제 3 | <ul style="list-style-type: none"> Project Integration of Program & Systems: This section of the exam measures skills of project architects and focuses on integrating decisions about environmental conditions, codes, and building systems into one cohesive project design. It highlights how to configure the building and incorporate both program requirements and contextual conditions in a unified design approach. |
| 주제 4 | <ul style="list-style-type: none"> Building Systems, Materials, & Assemblies: This section of the exam measures skills of architectural designers and covers the understanding of building systems such as mechanical, electrical, and plumbing, along with structural and specialty systems. It also involves selecting appropriate materials and assemblies to align with program needs, budgets, and regulations. |
| 주제 5 | <ul style="list-style-type: none"> Project Costs & Budgeting: This section of the exam measures skills of architectural designers and assesses the ability to evaluate design alternatives based on program goals, perform cost evaluations, and manage cost considerations throughout the design process. |

최신버전 Project-Planning-Design테스트자료 완벽한 덤프

KoreaDumps의NCARB인증 Project-Planning-Design 덤프는 수많은 시험준비 공부자료 중 가장 믿음직합니다. KoreaDumps의 인지도는 업계에 널리 알려져 있습니다. NCARB인증 Project-Planning-Design덤프로NCARB인증 Project-Planning-Design시험을 준비하여 한방에 시험패스한 분이 너무나도 많습니다. NCARB인증 Project-Planning-Design덤프는 실제NCARB인증 Project-Planning-Design시험문제에 초점을 맞추어 제작한 최신버전 덤프로서 시험패스율이 100%에 달합니다.

최신 Architect Registration Examination Project-Planning-Design 무료 샘플 문제 (Q60-Q65):

질문 # 60

Which of the following types of heating system would be appropriate when the design requires a very compact system that has a low initial cost, is easily zoned, and has a quick response to temperature changes?

- A. Forced air
- B. Combination forced air/hydronic
- C. Electric
- D. Hydronic

정답: C

설명:

Comprehensive and Detailed Explanation From Exact Extract:

Electric heating systems are compact, have low initial installation costs, and can be easily zoned with individual controls. They provide rapid response to temperature changes, making them suitable where space is limited and quick control is desired.

Hydronic systems have slower thermal response and require piping infrastructure.

Forced air systems need ductwork and are less compact.

Combination systems increase complexity and cost.

References:

ARE 5.0 PPD - Building Systems and Assemblies, Heating Systems

The Architect's Handbook of Professional Practice, 15th Edition - Mechanical Systems

질문 # 61

When designing a three-story wood-frame home located in a high wind region, the addition of a green roof with a two-foot soil bed would do which one of the following?

- A. Increase the structure's resistance to overturning
- B. Require additional tie-downs
- C. Increase the structure's resistance to racking

정답: B

설명:

Comprehensive and Detailed Explanation From Exact Extract:

Adding a green roof with a two-foot soil bed significantly increases the dead load on the roof and affects the uplift forces caused by high winds. This heavier roof mass necessitates additional structural tie-downs or anchorage to resist wind uplift and prevent overturning or structural failure.

The added weight does not inherently increase resistance to overturning (A) or racking (C); rather, it increases loads that require structural reinforcement.

References:

ARE 5.0 PPD - Building Systems and Assemblies, Structural Loads and Wind Design The Architect's Handbook of Professional Practice, 15th Edition - Wind-Resistant Design

질문 # 62

A new four-story apartment building is being designed on a site that has solid bedrock subsurface conditions. The client requested the lowest cost of installation, highest energy efficiency, the shortest round trip time, and minimized loss of usable building space.

Which elevator type should the architect recommend?

- A. Machine-roomless elevator
- B. Gearless traction elevator
- C. Dual jack hole-less hydraulic elevator
- D. Conventional hydraulic elevator

정답: A

설명:

Comprehensive and Detailed Explanation From Exact Extract:

Given the constraints:

Lowest cost of installation and minimized loss of usable space favor elevators that don't require a separate machine room.

Machine-roomless elevators (D) have compact machinery integrated within the hoistway, reducing space needs and construction costs.

Hydraulic elevators (A, C) require pits and often larger machine rooms, and are less energy efficient and have slower round trip times compared to traction types.

Gearless traction elevators (B) provide excellent speed and efficiency but usually require machine rooms, increasing cost and space.

Thus, machine-roomless elevators balance cost, efficiency, space, and speed best for mid-rise residential buildings.

References:

ARE 5.0 PPD - Building Systems and Assemblies, Vertical Transportation

The Architect's Handbook of Professional Practice, 15th Edition - Elevators and Conveying Systems

질문 # 63

An elementary school requires a renovation, selective demolition, and a major addition in order to accommodate a growing student population. An architectural firm has prepared schematic design plans incorporating the school's increased programmatic needs, including an enlarged library, cafeteria, and gymnasium; a secure courtyard; and additional space for administrative offices and classrooms. The main entrance was relocated in order to improve the traffic and pedestrian flow at the beginning and end of the school day, and additional parking was provided to comply with current zoning requirements.

The existing single-story masonry building was built in 1950. Two small additions were built later: the north addition will be kept and repurposed, but the south addition will be demolished. The building contains asbestos and lead in roof soffits, floor tiles, pipe insulation, and window paint. All existing mechanical systems need to be replaced; new systems have not been selected.

Considerations for the renovation include:

- * The relocated front entrance must be easily recognizable, highly visible, and secure.
- * Interior and exterior materials need to be durable and maintainable in order to withstand frequent student abuse, but also economical due to strict budget limitations.
- * Good indoor air quality and increased energy efficiency are priorities for the selection of mechanical equipment.

After completion, the entire school should look uniform, without a distinctive difference between the existing building and new addition.

Building information:

- * Construction Type is II-B.

The following resources are available for your reference:

- * Existing Plans, including site and floor plans
- * Proposed Plans, including site and floor plans
- * Cost Analysis
- * Zoning Ordinance Excerpts, for off-street parking requirements
- * IBC Excerpts, showing relevant code sections
- * ADA Standards Excerpts, showing relevant sections from the ADA Standards for Accessible Design When the addition is completed, the school will be fully sprinkled per NFPA 13 Standard for the Installation of Sprinkler Systems requirements, with a continuous 24-foot wide fire access lane provided around the building perimeter.

Through a code analysis, the combination of construction type, occupancy, and building area present a compliance problem.

- A. Add firewall to design
- B. Reduce building area
- C. Check frontage area increase

정답: C

설명:

Comprehensive and Detailed Explanation From Exact Extract:

When a building's size and occupancy cause non-compliance with allowable building area or frontage requirements, the architect should first check frontage area increase provisions allowed by the code. The frontage increase can allow a larger building area based on the length of street frontage and fire access, especially when sprinklers and fire lanes are provided.

Adding firewalls (A) is a method to subdivide building area but is typically considered after exploring frontage increases.

Reducing building area (C) is a last resort if other allowances are insufficient.

Therefore, the architect should first verify if frontage area increases resolve the compliance issue.

References:

IBC Chapter 5 - Building Area and Height Limits

NFPA 13 - Sprinkler System Requirements

ARE 5.0 PPD - Codes and Regulations

질문 # 64

The testing center on the second floor requires a private restroom for testing candidates to use. The architect needs to locate a single toilet restroom in the area that will have the least impact on the existing programming.

Click on the area in the plan where the restroom should be located.

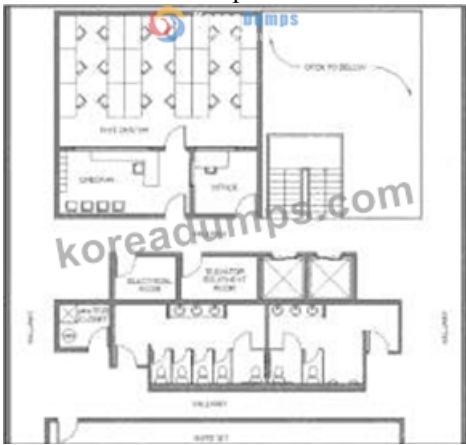

정답:

설명:

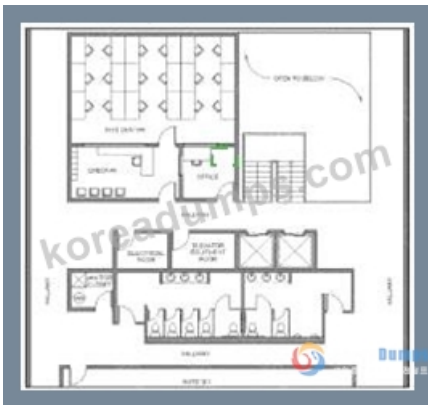

Explanation:

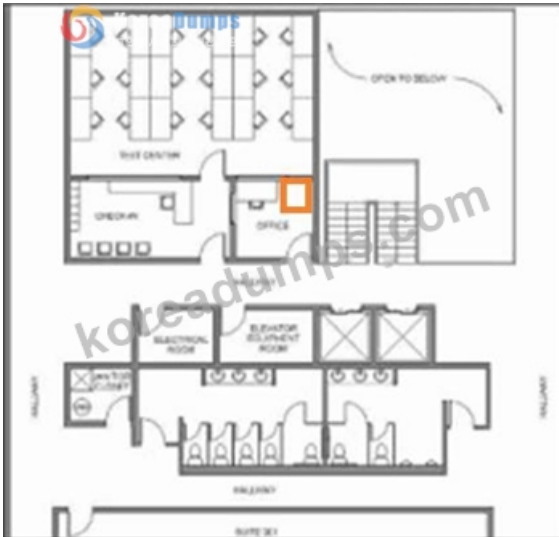

- * Locating the restroom in the existing small office space minimizes disruption to testing center programming and circulation.
- * This space is adjacent to the testing area, providing convenient access for testing candidates while maintaining privacy.
- * Repurposing an existing small room avoids reducing seating capacity or requiring major reconfiguration of the larger testing or hallway areas.
- * The location is near existing plumbing walls (bathrooms and mechanical rooms in the lower part of the plan), which reduces construction complexity and cost.

This approach aligns with NCARB ARE 5.0 Project Planning & Design content emphasizing efficient space utilization, minimal disruption, and adjacency for functional support spaces in program layouts.

질문 # 65

.....

NCARB인증 Project-Planning-Design시험준비중이신 분들은NCARB인증 Project-Planning-Design시험통과가 많이 어렵다는 것을 알고 있을 것입니다. 학교 공부하랴, 회사 다니랴 자격증 공부까지 하려면 너무 많은 정력과 시간이 필요할 것입니다. 그렇다고 자격증 공부를 포기하면 자신의 위치를 찾기가 힘들 것입니다. KoreaDumps 덤프는 IT인증 시험을 대비하여 제작된 것이므로 시험적중율이 높아 다른 시험대비 공부자료보다 많이 유용하기에 IT자격증을 취득하는데 좋은 동반자가 되어드릴 수 있습니다. KoreaDumps 덤프를 사용해 보신 분들의 시험성적을 통계한 결과 시험통과율이 거의 100%에 가깝다는 놀라운 결과를 얻었습니다.

Project-Planning-Design시험대비 덤프 데모 다운 : https://www.koreadumps.com/Project-Planning-Design_exam-braindumps.html

- 100% 유효한 Project-Planning-Design테스트자료 최신덤프 □ ➡ www.passtip.net □에서 검색만 하면 (Project-Planning-Design) 를 무료로 다운로드할 수 있습니다Project-Planning-Design최신 인증 시험정보
- Project-Planning-Design완벽한 덤프문제자료 □ Project-Planning-Design퍼펙트 덤프데모 다운로드 □ Project-Planning-Design최신 인증 시험 기출자료 □ □ www.itdumpskr.com □을(를) 열고 ➡ Project-Planning-Design □를 입력하고 무료 다운로드를 받으십시오Project-Planning-Design최신 인증 시험 공부자료
- Project-Planning-Design시험덤프샘플 □ Project-Planning-Design시험대비 공부문제 □ Project-Planning-Design최신 인증 시험정보 □ 【 Project-Planning-Design 】 를 무료로 다운로드하려면 ➡ www.pass4test.net □웹사이트를 입력하세요Project-Planning-Design덤프공부자료
- Project-Planning-Design테스트자료 100% 합격 보장 가능한 인증 시험자료 □ 무료 다운로드를 위해 지금 ➡ www.itdumpskr.com □에서 □ Project-Planning-Design □ 검색Project-Planning-Design최신 인증 시험 기출자료
- Project-Planning-Design테스트자료 최신버전 시험기출자료 □ (www.itdumpskr.com) 에서 ▶ Project-Planning-Design ◀를 검색하고 무료 다운로드 받기Project-Planning-Design인기자격증 시험 덤프자료
- Project-Planning-Design시험대비 최신버전 덤프자료 □ Project-Planning-Design시험대비 공부문제 □ Project-Planning-Design완벽한 덤프문제자료 □ ▶ Project-Planning-Design ◀를 무료로 다운로드하려면 ➡ www.itdumpskr.com □ □ □ 웹사이트를 입력하세요Project-Planning-Design인기자격증 시험 덤프자료
- Project-Planning-Design테스트자료 100% 합격 보장 가능한 인증 시험자료 □ □ kr.fast2test.com □에서 □ Project-Planning-Design □를 검색하고 무료 다운로드 받기Project-Planning-Design덤프공부자료
- Project-Planning-Design퍼펙트 덤프데모 다운로드 □ Project-Planning-Design최고품질 시험대비자료 □ Project-Planning-Design시험대비 공부문제 □ 무료 다운로드를 위해 지금 ➡ www.itdumpskr.com □에서 ➡ Project-Planning-Design ◀ 검색Project-Planning-Design시험기출문제
- Project-Planning-Design테스트자료 100% 합격 보장 가능한 인증 시험자료 □ □ www.exampassdump.com □에서

✓ Project-Planning-Design ✓ 를 검색하고 무료로 다운로드하세요 Project-Planning-Design 시험대비 덤프데모 문제

- Project-Planning-Design 합격보장 가능 덤프공부 Project-Planning-Design 인기자격증 시험 덤프자료 Project-Planning-Design 덤프 최신버전 지금 www.itdumpskr.com 에서 ➡ Project-Planning-Design 를 검색하고 무료로 다운로드하세요 Project-Planning-Design 덤프 공부문제
- Project-Planning-Design 시험대비 공부문제 Project-Planning-Design 시험기출문제 Project-Planning-Design 덤프 최신버전 오픈 웹 사이트 [www.exampassdump.com] 검색 ✓ Project-Planning-Design ✓ 무료 다운로드 Project-Planning-Design 인기자격증 시험 덤프자료
- tiannaokez761339.izrablog.com, xanderurkn644477.mysticwiki.com, 1001bookmarks.com, active-bookmarks.com, crossbookmark.com, www.fuxinwang.com, katrinakrjt741005.izrablog.com, darrenapho606231.sasugawiki.com, brianspf394345.nizarblog.com, joanqhtd104736.shoutmyblog.com, Disposable vapes

그리고 KoreaDumps Project-Planning-Design 시험 문제집의 전체 버전을 클라우드 저장소에서 다운로드할 수 있습니다: https://drive.google.com/open?id=1pD8P5fDiuXhFZAstfKG_QMysY2PBXaqc