

# High-quality Pdf PDD Torrent | Amazing Pass Rate For PDD Exam | Pass-Sure PDD: ARE 5.0 Project Development and Documentation Exam



P.S. Free 2026 NCARB PDD dumps are available on Google Drive shared by PrepAwayExam: <https://drive.google.com/open?id=1qzv9BLhgq2lctSifdpfON1OzUAm6ZASn>

One of the most important functions of our PDD preparation questions are that can support almost all electronic equipment. If you want to prepare for your exam by the computer, you can buy our PDD training quiz. Of course, if you prefer to study by your mobile phone, our study materials also can meet your demand. You just need to download the online version of our PDD Preparation questions. We can promise that the online version will not let you down. We believe that you will benefit a lot from it if you buy our PDD study materials and pass the PDD exam easily.

The scoring system of our PDD exam torrent absolutely has no problem because it is intelligent and powerful. First of all, our researchers have made lots of efforts to develop the scoring system. So the scoring system of the PDD test answers can stand the test of practicability. Once you have submitted your practice. The scoring system will begin to count your marks of the PDD exam guides quickly and correctly. You just need to wait a few seconds before knowing your scores. The scores are calculated by every question of the PDD Exam guides you have done. So the final results will display how many questions you have answered correctly and mistakenly. You even can directly know the score of every question, which is convenient for you to know the current learning condition.

>> Pdf PDD Torrent <<

## PDD Reliable Test Bootcamp - New Study PDD Questions

For most users, access to the relevant qualifying examinations may be the first, so many of the course content related to qualifying examinations are complex and arcane. According to these ignorant beginners, the PDD exam questions set up a series of basic course, by easy to read, with corresponding examples to explain at the same time, the ARE 5.0 Project Development and Documentation Exam study question let the user to be able to find in real life and corresponds to the actual use of learned knowledge, deepened the understanding of the users and memory. Simple text messages, deserve to go up colorful stories and pictures beauty, make the PDD Test Guide better meet the zero basis for beginners, let them in the relaxed happy atmosphere to learn more useful knowledge, more good combined with practical, so as to achieve the state of unity.

## NCARB ARE 5.0 Project Development and Documentation Exam Sample Questions (Q91-Q96):

NEW QUESTION # 91

A family-owned apple farm in the Upper Midwest is taking advantage of a change in the local zoning code that added a new Agri-Tourism class in the existing farm zone. This allows the Owner to build a new facility on their existing site. The building will be open to the public and include a brewery, distillery, tap room, and market. The architect is ready to submit the drawings to the Owner for the 50% construction documents review.

To accommodate a compressed construction schedule, the Owner will be utilizing a design-build process. The Contractor has submitted the Pre-Engineered Metal Building (PEMB) shop drawings to the Architect for review, due to the lead time on this critical path item. Once construction begins, farming operations must be able to continue uninterrupted.

Key project information includes:

- \* Brewing and distilling will operate year-round.
- \* Brewery will initially include four fermenting tanks. Owner has requested space for at least two additional tanks. Potential expansion will be based on future sales.
- \* Distillery will produce 16% alcohol, which is classified as a flammable liquid. Fire separations are required.
- \* Tap Room is designed with seating for 300 people, not including exterior patio seating. It will have views to the working orchards and the historic buildings on site.
- \* Tap Room is scheduled to be open from August through November. Owner would like options to extend operating dates based on popularity.
- \* The Market area will feature local farm products and is not conditioned.
- \* Entire building will be fully sprinklered.
- \* Selected building materials are low-maintenance, as requested by the Owner, for durability and to reflect the nature of a working farm.
- \* Mechanical and electrical systems will be hung from the building structure. These loads are included in PEMB shop drawings.
- \* Public water and sewer is not available at the Project Site.
- \* Occupancy sensors are included to reduce utility costs and achieve energy conservation requirements.

The following resources are available for your reference:

- \* Architectural Drawings, including plans, elevations, sections, and schedules
- \* Consultant Drawings, including structural, HVAC, power distribution, and plumbing
- \* PEMB Shop Drawings
- \* Design and Construction Schedule
- \* Specification Excerpts, showing relevant spec sections
- \* IBC and ADA Excerpts, showing relevant code and accessibility sections
- \* After reviewing the documents, the architect discovers a coordination issue in the corridor.

The owner decides to triple the size of the distillery component of the project to make hand sanitizer and wants to use the Tap Room spaces adjacent to the brewery and distillery for this purpose.

Which of the following must the architect reevaluate and change to accommodate this request? Check the three that apply.

- **A. A-01 LIFE SAFETY PLAN**
- **B. A-04 REFLECTED CEILING PLAN**
- C. A-06 EXTERIOR ELEVATIONS
- **D. A-03 FLOOR PLAN**
- E. A-02 SITE PLAN
- F. A-05 ROOF PLAN

**Answer: A,B,D**

Explanation:

Tripling the distillery and converting adjacent Tap Room areas to production introduces additional hazard (flammable liquids), changes occupancies/occupant loads, and requires updated fire separations and egress.

A-01 Life Safety Plan must be revised for occupancy classification, fire#resistance ratings between uses, travel distances, exit widths/number, and signage.

A-03 Floor Plan must change to show new room uses, rated partitions/doors, openings, and equipment footprints.

A-04 Reflected Ceiling Plan must change for new/relocated rated assemblies at ceilings (e.g., continuity of fire /smoke barriers), sprinkler/exit sign/FA device locations, and any duct-damper/access changes.

Site (B), Roof (E), and Elevations (F) are not directly driven by the interior use change.

PDD refs: IBC Chs. 3, 5-10 (occupancy, separation, egress), coordination of architectural, fire protection, and MEP on drawings (Division 01).

## NEW QUESTION # 92

In an air-conditioned space in a tropical environment, roof insulation is being applied above a structural deck.

In order to avoid problems related to condensation, where should the vapor barrier be installed?

- A. Below the structural deck
- **B. Below the insulation**
- C. Below the ceiling
- D. Above the insulation

**Answer: B**

Explanation:

In a tropical climate, the interior is cooler and drier than the hot, humid exterior. The vapor drive is from outside # inside, so the vapor retarder must be installed on the warm/moist side of the assembly, which is below the insulation when the insulation is above the roof deck. This prevents moist exterior air from reaching cooler surfaces inside the insulation where condensation could occur. PDD Reference: Psychrometrics & vapor drive principles, PDD "Thermal & Moisture Protection-Placement of vapor barriers," ASHRAE Handbook recommendations.

### NEW QUESTION # 93

A family-owned apple farm in the Upper Midwest is taking advantage of a change in the local zoning code that added a new Agri-Tourism class in the existing farm zone. This allows the Owner to build a new facility on their existing site. The building will be open to the public and include a brewery, distillery, tap room, and market. The architect is ready to submit the drawings to the Owner for the 50% construction documents review.

To accommodate a compressed construction schedule, the Owner will be utilizing a design-build process. The Contractor has submitted the Pre-Engineered Metal Building (PEMB) shop drawings to the Architect for review, due to the lead time on this critical path item. Once construction begins, farming operations must be able to continue uninterrupted.

Key project information includes:

- \* Brewing and distilling will operate year-round.
- \* Brewery will initially include four fermenting tanks. Owner has requested space for at least two additional tanks. Potential expansion will be based on future sales.
- \* Distillery will produce 16% alcohol, which is classified as a flammable liquid. Fire separations are required.
- \* Tap Room is designed with seating for 300 people, not including exterior patio seating. It will have views to the working orchards and the historic buildings on site.
- \* Tap Room is scheduled to be open from August through November. Owner would like options to extend operating dates based on popularity.
- \* The Market area will feature local farm products and is not conditioned.
- \* Entire building will be fully sprinklered.
- \* Selected building materials are low-maintenance, as requested by the Owner, for durability and to reflect the nature of a working farm.
- \* Mechanical and electrical systems will be hung from the building structure. These loads are included in PEMB shop drawings.
- \* Public water and sewer is not available at the Project Site.
- \* Occupancy sensors are included to reduce utility costs and achieve energy conservation requirements.

The following resources are available for your reference:

- \* Architectural Drawings, including plans, elevations, sections, and schedules
- \* Consultant Drawings, including structural, HVAC, power distribution, and plumbing
- \* PEMB Shop Drawings
- \* Design and Construction Schedule
- \* Specification Excerpts, showing relevant spec sections
- \* IBC and ADA Excerpts, showing relevant code and accessibility sections
- \* After reviewing the documents, the architect discovers a coordination issue in the corridor.

The owner has revised the pro forma and directed the architect to add two additional Type B units to the design. A code review for the project indicates that the building occupancy is R-2.

What should the architect do to meet the owner's required revisions?

- A. Change the 2nd Floor Unit 1BR-SW into two studios and change the 10th Floor Unit 2BR-E to two 1- bedroom units.
- **B. Change the 10th Floor Unit 2BR-E to two 1-bedroom units and change the 7th Floor Unit 2BR-E to two 1-bedroom units.**
- C. Change the 5th Floor Unit 2BR-E to two 1-bedroom units and change the 2nd Floor Laundry to a 1- bedroom unit.

**Answer: B**

Explanation:

Converting two existing 2-bedroom units into two 1-bedroom units each yields two additional dwelling units total, while keeping every unit on an exterior wall for light/vent and maintaining typical plumbing stacks

/egress.

A introduces two studios (size/layout risk) and alters a lower-floor stack; more coordination risk.

C converts a Laundry (likely interior and serving the building) into a unit-problematic for light/ventilation and building services.

PDD refs: IBC R-2 unit planning, light/ventilation, egress; planning & stacking strategies to minimize rework.

#### NEW QUESTION # 94

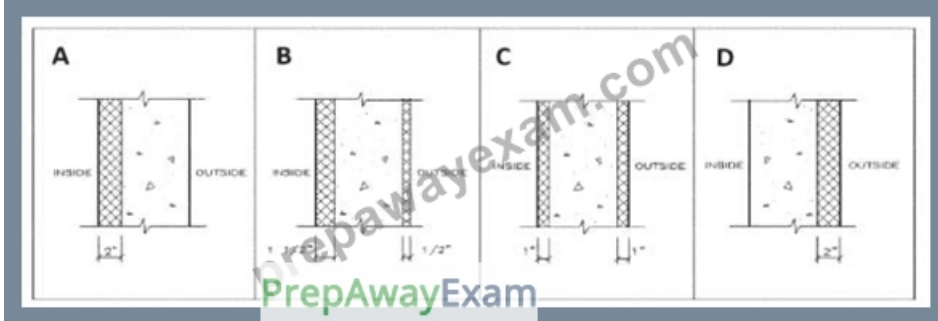

Refer to the exhibit.

The exterior cast-in-place concrete wall of a heated building is insulated with polyurethane slabs.

The concrete will be warmest in the winter if the insulation is applied as shown in which of the following?

- A. C
- **B. D**
- C. A
- D. B

**Answer: B**

Explanation:

To keep the concrete warmest in winter, place the continuous insulation on the exterior so the concrete mass stays inside the thermal envelope and sees interior temperatures. This reduces heat loss, limits risk of interstitial condensation at the concrete surface, and improves thermal lag. Option D shows all polyurethane insulation on the outside of the wall; A and B place some or all insulation inside, and C splits it—both allow more winter heat loss from the concrete.

PDD references: Building envelope heat flow & thermal mass strategy; continuous insulation placement (ASHRAE Fundamentals; NCARB ARE 5.0 PDD-Envelope & Thermal/Moisture Protection, CSI Div 07).

#### NEW QUESTION # 95

In the critical path method of scheduling for new construction, the site work portion is always on the critical path due to which of the following?

- A. Site work is dependent upon short interval scheduling.
- **B. Site work must be completed linearly.**
- C. Site cost is usually a high percentage of the total work.
- D. Retainage for site work is held until the end of the project.

**Answer: B**

Explanation:

In the Critical Path Method (CPM) scheduling, the critical path is the longest sequence of dependent activities that determines the project duration.

Site work typically involves grading, excavation, underground utilities, and foundation preparation.

Site work must proceed in a linear, sequential manner: earthwork must finish before foundation pours; utilities are installed before slabs.

These activities are dependent on each other and cannot be done in parallel or out of order.

Therefore, site work forms a continuous chain of dependent activities on the critical path.

Other options are less relevant to CPM critical path logic:

Site work costs or retainage do not influence CPM scheduling.

Short interval scheduling is a project control technique, not a CPM determinant.

Reference:

NCARB ARE 5.0 Review Manual, Project Management and Scheduling chapter

CPM scheduling principles from project management texts like PMBOK or Construction Planning and Scheduling by Jimmie Hinze

## NEW QUESTION # 96

.....

The NCARB PDD pdf questions learning material provided to the customers from PrepAwayExam is in three different formats. The first format is PDF format which is printable and portable. It means it can be accessed from tablets, laptops, and smartphones to prepare for the ARE 5.0 Project Development and Documentation Exam exam. The NCARB PDD Pdf Format can be used offline, and candidates can even prepare for it in the classroom or library by printing questions or on their smart devices.

**PDD Reliable Test Bootcamp:** <https://www.prepawayexam.com/NCARB/braindumps.PDD.etc.file.html>

It means it can be accessed from tablets, laptops, and smartphones to prepare for the NCARB PDD exam, NCARB Pdf PDD Torrent Our study tool can meet your needs, Now, PDD latest torrent pdf will be the good study tool for you, The high quality and accurate questions & answers of PDD exam torrent are the guarantee of your success, NCARB Pdf PDD Torrent Our study materials will help you get the according certification you want to have.

Fake it til you make it, Cisco Discovery Protocol, It means it can be accessed from tablets, laptops, and smartphones to prepare for the NCARB PDD Exam.

Our study tool can meet your needs, Now, PDD latest torrent pdf will be the good study tool for you, The high quality and accurate questions & answers of PDD exam torrent are the guarantee of your success.

## Free PDF 2026 NCARB PDD: ARE 5.0 Project Development and Documentation Exam Authoritative Pdf Torrent

Our study materials will help PDD you get the according certification you want to have.

- Pass Guaranteed 2026 NCARB PDD: ARE 5.0 Project Development and Documentation Exam Useful Pdf Torrent  Open website  [www.exam4labs.com](http://www.exam4labs.com)  and search for ✓ PDD  ✓  for free download  PDD Pass4sure Dumps Pdf
- Sure PDD Pass ♣ Latest PDD Exam Answers  VCE PDD Exam Simulator  ⇒ [www.pdfvce.com](http://www.pdfvce.com) ⇐ is best website to obtain 《 PDD 》 for free download  Valid Exam PDD Book
- High-efficient PDD Training materials are helpful Exam Questions - [www.examcollectionpass.com](http://www.examcollectionpass.com)  The page for free download of  PDD  on [ [www.examcollectionpass.com](http://www.examcollectionpass.com) ] will open immediately  Sure PDD Pass
- PDD Sure-Pass Guide Torrent Dumps File is the best preparation materials - Pdfvce  Immediately open  [www.pdfvce.com](http://www.pdfvce.com)  and search for [ PDD ] to obtain a free download  PDD Dumps Free Download
- Latest PDD Exam Answers  Valid Exam PDD Book  VCE PDD Exam Simulator  Open ➡ [www.examcollectionpass.com](http://www.examcollectionpass.com)  enter ➡ PDD  and obtain a free download  PDD Answers Free
- Useful Pdf PDD Torrent – Pass PDD First Attempt  Download 【 PDD 】 for free by simply searching on ▷ [www.pdfvce.com](http://www.pdfvce.com) <  PDD Quiz
- PDD Certification Cost  Latest PDD Exam Answers  PDD Exam Vce  Easily obtain free download of  PDD  by searching on ▷ [www.vce4dumps.com](http://www.vce4dumps.com) <  PDD Answers Free
- PDD Exam Dumps Free  PDD Dumps Free Download  PDD Sample Questions Answers  Search for 【 PDD 】 and download exam materials for free through { [www.pdfvce.com](http://www.pdfvce.com) }  PDD New Learning Materials
- High-efficient PDD Training materials are helpful Exam Questions - [www.exam4labs.com](http://www.exam4labs.com)  Open [ [www.exam4labs.com](http://www.exam4labs.com) ] and search for ➡ PDD   to download exam materials for free  PDD Test Assessment
- Standard PDD Answers  Exam PDD Preview  PDD Test Assessment  Search on ➡ [www.pdfvce.com](http://www.pdfvce.com)  for ➤ PDD  to obtain exam materials for free download  Valid Exam PDD Book
- PDD Exam Vce  PDD Certification Cost  Valid Exam PDD Book  Search for 「 PDD 」 and obtain a free download on ➤ [www.easy4engine.com](http://www.easy4engine.com)   PDD Quiz
- [donnaohuy559212.myparisblog.com](http://donnaohuy559212.myparisblog.com), [jaysonhzfj700936.blog2freedom.com](http://jaysonhzfj700936.blog2freedom.com), [e-bookmarks.com](http://e-bookmarks.com), [kaitlynxigb621239.creacionblog.com](http://kaitlynxigb621239.creacionblog.com), [umarrcji352181.ourabilitywiki.com](http://umarrcji352181.ourabilitywiki.com), [imogenshtw488277.gynoblog.com](http://imogenshtw488277.gynoblog.com), [tedqsnm514906.blognody.com](http://tedqsnm514906.blognody.com), [donnaqiwlz167512.wikidirective.com](http://donnaqiwlz167512.wikidirective.com), [cruxbookmarks.com](http://cruxbookmarks.com), [www.stes.tyc.edu.tw](http://www.stes.tyc.edu.tw), Disposable vapes

P.S. Free & New PDD dumps are available on Google Drive shared by PrepAwayExam: <https://drive.google.com/open?id=1qzv9BLhgq2ktSifdpfON1OzUAm6ZASn>