

# First-grade C\_S4CPB Online Version - 100% Pass C\_S4CPB Exam

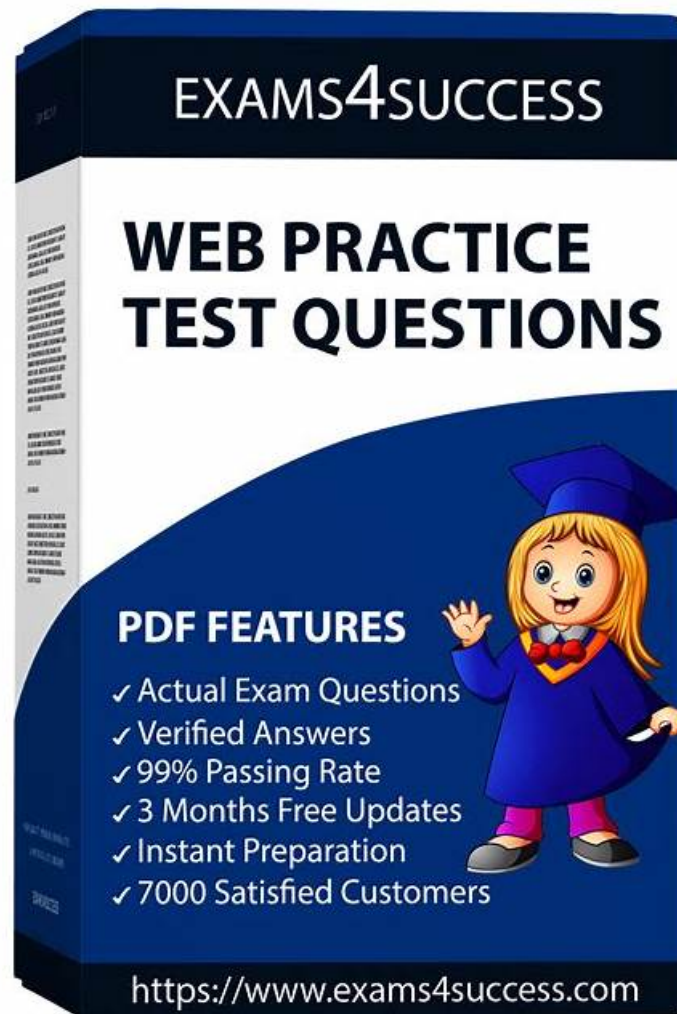

Considering that our customers are from different countries, there is a time difference between us, but we still provide the most thoughtful online after-sale service twenty four hours a day, seven days a week, so just feel free to contact with us through email anywhere at any time. Our commitment of helping you to Pass C\_S4CPB Exam will never change. Considerate 24/7 service shows our attitudes, we always consider our candidates' benefits and we guarantee that our C\_S4CPB test questions are the most excellent path for you to pass the exam.

You don't have to worry about passing rates of our C\_S4CPB exam questions because of the short learning time. We have always been trying to shorten your study time on the premise of ensuring the passing rate. Perhaps after you have used C\_S4CPB real exam once, you will agree with this point. Our C\_S4CPB Study Materials are really a time-saving and high-quality product! As long as you buy and try our C\_S4CPB practice braindumps, then you will want to buy more exam materials.

>> C\_S4CPB Online Version <<

## Free PDF Quiz SAP - C\_S4CPB - High-quality SAP Certified - Implementation Consultant - SAP S/4HANA Cloud Public Edition (C\_S4CPB\_2602) Online Version

First and foremost, our company has prepared C\_S4CPB free demo in this website for our customers. Second, it is convenient for

you to read and make notes with our versions of C\_S4CPB exam materials. Last but not least, we will provide considerate on line after sale service for you in twenty four hours a day, seven days a week. So let our C\_S4CPB Practice Guide to be your learning partner in the course of preparing for the exam, it will be a wise choice for you to choose our C\_S4CPB study dumps.

## SAP Certified - Implementation Consultant - SAP S/4HANA Cloud Public Edition (C\_S4CPB\_2602) Sample Questions (Q15-Q20):

### NEW QUESTION # 15

#### SIMULATION

Create a Custom Launchpad Space and Page

Business Scenario

You are building a custom business role that will be assigned to all employees in the organization. The business role and its corresponding Launchpad Space and Page need to include the apps that have been granted through the business catalogs assigned to the business role to ensure employees have an easy time finding the relevant applications.

Note: In the task below, always replace ##### with the last 6 digits of your group number.

Note:

Make sure to use the EXACT names/values/spaces as they are listed in the task.

Even forgetting a space or a number will cause the validation of the task to fail and be marked as incorrect.

Task:

Create a Launchpad Space and Page with the information below.

Parameter	Value
Space ID	Z_ALL_EMP_#####
Space Title	General
Space Description	General
Page ID	Z_ALL_EMP_#####

Parameter	Value
Page Title	General
Page Description	General

#### Answer:

Explanation:

See Explanation below for all solution

Explanation:

Objective

The purpose of this task is to create a custom launchpad space and page for the all-employee business role so employees can easily find the apps granted through the assigned business catalogs.

This task belongs to the all-employee role created in the previous tasks, for example:

Business Role ID: Z\_EMPLOYEES\_ALL\_#####

The page values shown in the task are:

Page Title: General

Page Description: General

SAP S/4HANA Cloud Maintain Business Roles

**All Employee Role 000013**  
Z\_EMPLOYEES\_ALL\_000013

Manage Changes After Upgrade Maintain Restrictions Display Changes Create Derived Business Role Copy Download

Write Access: No Access  
Read Access: Unrestricted  
Value Help Access: Unrestricted

Draft Last Changed By: A000013 SAP\_Learning  
Draft Last Changed On: 30.03.2026, 20:35:32

Editing Status: Draft

Authorization is up-to-date

General Role Details Business Catalogs (2) IAM Apps (3) **Launchpad Spaces (1)** Business Users (0)

Assigned Launchpad Spaces (1)

Space ID	Space Description	Space Title	Type	Template	Merge ID
<input type="checkbox"/> Z_ALL_EMP_000013	General	General	Managed by Customer		

### Business Scenario Explanation

In SAP S/4HANA Cloud, business catalogs grant the app authorizations, but users still need a clean launchpad structure so they can actually find those apps easily.

That is why this task requires creating:

a Launchpad Space

a Launchpad Page

for the all-employee role.

The space acts like a container in the launchpad navigation, and the page acts like the content area where app tiles will later be displayed.

### Important Notes

Always replace ##### with the last 6 digits of your group number.

Use the exact text values shown in the task.

The task image explicitly shows:

Page Title = General

Page Description = General

Save each object after creation.

### Required Values

From the task image, use:

Parameter

Value

Page Title

General

Page Description

General

Additional execution values used in your run

During your actual execution, the custom launchpad space/page used this pattern:

Space ID: Z\_ALL\_EMP\_#####

Space Description: General

Space Title: General

Page ID: Z\_ALL\_EMP\_#####

Page Title: General

Page Description: General

### Objective

The purpose of this task is to create a custom launchpad space and page for the all-employee business role so employees can easily find the apps granted through the assigned business catalogs.

This task belongs to the all-employee role created in the previous tasks, for example:

Business Role ID: Z\_EMPLOYEES\_ALL\_#####

The page values shown in the task are:

Page Title: General

Page Description: General

### Business Scenario Explanation

In SAP S/4HANA Cloud, business catalogs grant the app authorizations, but users still need a clean launchpad structure so they can actually find those apps easily.

That is why this task requires creating:

a Launchpad Space

a Launchpad Page

for the all-employee role.

The space acts like a container in the launchpad navigation, and the page acts like the content area where app tiles will later be displayed.

**Important Notes**

Always replace ##### with the last 6 digits of your group number.

Use the exact text values shown in the task.

The task image explicitly shows:

Page Title = General

Page Description = General

Save each object after creation.

Required Values

From the task image, use:

Parameter

Value

Page Title

General

Page Description

General

Additional execution values used in your run

During your actual execution, the custom launchpad space/page used this pattern:

Space ID: Z\_ALL\_EMP\_#####

Space Description: General

Space Title: General

Page ID: Z\_ALL\_EMP\_#####

Page Title: General

Page Description: General

**Add Launchpad Space**

Space ID: \*  
Z\_ALL\_EMP\_000457

Space Description: \*  
General

Space Title: \*  
General

Create Page from Business Catalogs and Groups

Enter page details manually

Create and Assign Space Cancel

**Z\_ALL\_EMP\_000013**

General

General Data Pages (1) Roles (1)

Page ID	Merge ID	Title / Description	Visibility
Z_ALL_EMP_000013	Z_ALL_EMP_000013	General	Visible



Section Title: Self-Services

To start, drag/add content from catalogs here.

+ Add Section

Select Role Context (all) | Hide Catalogs | Search for files | Add | ...

Derived from Roles	Manually Selected
<input type="checkbox"/>	<input type="checkbox"/>
SAP_CON_BC_CTE_ESS_PC Concur - Employee Self-Service	
<input type="checkbox"/>	<input type="checkbox"/>
Concur Travel Expense	Add   v
<input type="checkbox"/>	<input type="checkbox"/>
Enhanced WBS Element Search	Add   v
SAP_HCM_BC_EMP_PC HCM - Employee Self-Service	
<input type="checkbox"/>	<input type="checkbox"/>
Manage My Timesheet	Add   v

Save Cancel

## Self-Services

 Concur Travel  
Expense

 Manage My  
Timesheet

Hours Missing

**NEW QUESTION # 16**

## SIMULATION

Create a Custom Launchpad Space and Page

Business Scenario

You are building a custom business role that will be assigned to all employees in the organization. The business role and its corresponding Launchpad Space and Page need to include the apps that have been granted through the business catalogs assigned to the business role to ensure employees have an easy time finding the relevant applications.

Note: In the task below, always replace ##### with the last 6 digits of your group number.

Note:

Make sure to use the EXACT names/values/spaces as they are listed in the task.

Even forgetting a space or a number will cause the validation of the task to fail and be marked as incorrect.

Task:

Assign the business catalogs listed below to the business role and save:

HCM - Employee Self-Service (SAP\_HCM\_BC\_EMP\_PC)

Concur - Employee Self-Service (SAP\_CON\_BC\_CTE\_ESS\_PC)

**Answer:**

Explanation:

See Explanation below for all solution

Explanation:

Objective

The purpose of this task is to assign the required business catalogs to the custom all-employee business role created in the previous task. These catalogs provide the applications that will later be shown in the launchpad space and page for all employees.

The catalogs that must be assigned are:

HCM - Employee Self Service

SAP\_HCM\_BC\_EMP\_PC

Concur - Employee Self-Service

SAP\_CON\_BC\_CTE\_ESS\_PC

Business Scenario Explanation

In the previous task, you created a new custom all-employee business role, for example:

Z\_EMPLOYEES\_ALL\_#####

That role exists, but on its own it does not yet provide app access.

In SAP S/4HANA Cloud, app access is granted through business catalogs.

This means the role must now be connected to the catalogs that contain the apps employees need.

Later, these catalogs will feed the launchpad page content so end users can easily find the relevant applications.

Important Notes

Always replace ##### with the last 6 digits of your group number.

Use the exact catalog names and IDs.

Assign both required catalogs.

Save the role after assignment.

Do not assign the wrong catalog variant.

Required Catalogs

Assign exactly these two business catalogs:

Business Catalog

Business Catalog ID

HCM - Employee Self Service

SAP\_HCM\_BC\_EMP\_PC

Concur - Employee Self-Service

SAP\_CON\_BC\_CTE\_ESS\_PC

Detailed Step-by-Step Procedure

Step 1: Open the app "Maintain Business Roles"

From the SAP S/4HANA Cloud launchpad:

Log in to SAP S/4HANA Cloud.

Use the app search.

Search for:

Maintain Business Roles

Open the app.

Explanation:

This app is used to maintain business roles, assign catalogs, assign launchpad spaces, and maintain restrictions.

Step 2: Search for your custom all-employee business role

Inside Maintain Business Roles:

Search for your business role ID:

Z\_EMPLOYEES\_ALL\_#####

Example

If your suffix is 000013, search for:

Z\_EMPLOYEES\_ALL\_000013

Open the role.

Explanation:

You must open the custom all-employee role created in the previous task, not a template role and not a standard SAP role.

SAP S/4HANA Cloud Maintain Business Roles

**All Employee Role 000013**  
Z\_EMPLOYEES\_ALL\_000013

Write Access: No Access  
Read Access: Unrestricted  
Value Help Access: Unrestricted

Draft Last Changed By: A000013 SAP\_Learning  
Draft Last Changed On: 30.03.2026, 20:35:32

Editing Status: Draft

Authorization is up-to-date

General Role Details Business Catalogs (2) IAM Apps (3) **Launchpad Spaces (1)** Business Users (0)

Assigned Launchpad Spaces (1)

Space ID	Space Description	Space Title	Type	Template	Merge ID
<input type="checkbox"/> Z_ALL_EMP_000013	General	General	Managed by Customer		

Step 3: Verify the correct role is open

Confirm that the role details show:

Business Role ID = Z\_EMPLOYEES\_ALL\_#####

Business Role Description = All Employee Role #####

Explanation:

This ensures you are assigning catalogs to the correct business role.

Step 4: Go to the "Business Catalogs" tab

Inside the role:

Click the tab:

Business Catalogs

Explanation:

This tab is used to assign the business catalogs that define which apps and app authorizations the role provides.

Step 5: Click Add

In the Assigned Business Catalogs section:

Click Add

This opens the dialog:

Add Business Catalogs

Explanation:

The Add popup is used to search for and assign SAP-delivered business catalogs to the custom role.

Step 6: Search for the first catalog

In the Add Business Catalogs popup:

Search for:

SAP\_HCM\_BC\_EMP\_PC

or

HCM - Employee Self Service

Select:

HCM - Employee Self Service

Business Catalog ID: SAP\_HCM\_BC\_EMP\_PC

Explanation:

This catalog provides employee self-service apps and is required by the task.

Business Catalogs SAP\_HCM\_BC\_EMP\_PC

Business Catalog	Business Catalog ID	Status
<input checked="" type="checkbox"/> HCM - Employee Self Service	SAP_HCM_BC_EMP_PC	

Step 7: Search for the second catalog

Still in the Add Business Catalogs popup:

Search for:

SAP\_CON\_BC\_CTE\_ESS\_PC

or

Concur - Employee Self-Service

Select:

Concur - Employee Self-Service

Business Catalog ID: SAP\_CON\_BC\_CTE\_ESS\_PC

Explanation:

This catalog provides the Concur employee self-service content and is also explicitly required by the task.

Step 8: Add the selected catalogs

After selecting both catalogs:

Click OK or Apply

Explanation:

This adds the selected catalogs to the custom role in draft mode.

Step 9: Verify both catalogs are listed

Back in the Business Role screen, verify that both assigned catalogs are visible:

SAP\_HCM\_BC\_EMP\_PC

SAP\_CON\_BC\_CTE\_ESS\_PC

Explanation:

This confirms that the required app authorizations have now been attached to the role.

Step 10: Save the role

Click:

Save

Explanation:

This finalizes the catalog assignment.

Without saving, the catalogs remain only in draft and the role will not provide the required app content.

Step 11: Verify the result after save

After saving, check again that the role still shows both business catalogs in the assigned list.

Explanation:

This confirms the task was completed successfully and the role is ready for the next step, which is launchpad space/page content.

Expected Result

After this task is completed successfully:

the custom all-employee role has both required business catalogs assigned, the role is saved successfully, the role now provides the app authorizations required for employee self-service content, the launchpad page can later use these catalogs to add the required tiles.

## NEW QUESTION # 17

### SIMULATION

**Business Scenario** You are working on an implementation project and need to create a test user in the system for demonstrating the professional services business processes to project managers during your upcoming Fit-to-Standard workshop. Follow the instructions below to create a new test user with a basic import of worker and work agreement data.

Note: In the task below, always replace ##### with the last 6 digits of your group number.

Note:

Make sure to use the EXACT names/values/spaces as they are listed in the task.

Even forgetting a space or a number will cause the validation of the task to fail and be marked as incorrect.

Task:

Assign the Project Manager - Professional Services (BR\_PROJECT\_MANAGER\_PROF) business role to the new user and save.

### Answer:

Explanation:

See Explanation below for all solution

Explanation:

Objective

The purpose of this task is to assign the Project Manager - Professional Services business role to the newly created test user so that the user can perform the professional-services processes required during the Fit-to-Standard workshop.

The required business role is:

Business Role ID: BR\_PROJECT\_MANAGER\_PROF

Business Role Description: Project Manager - Professional Services

Business Scenario Explanation

In the previous task, a new test user was created for demonstrating professional services processes.

That new user now needs the correct project-manager authorization.

Without this business role, the test user will not have access to the project-manager apps, pages, and processes needed for the workshop demonstration.

This task connects the newly created user to the standard professional-services project manager role.

Important Notes

Always replace ##### with the last 6 digits of your group number.

Use the exact values as required.

The business role ID must be:

BR\_PROJECT\_MANAGER\_PROF

Do not use a similar role or partial match.

Save at the end, otherwise the assignment remains incomplete.

Detailed Step-by-Step Procedure

Step 1: Open the app "Maintain Business Users"

From the SAP S/4HANA Cloud launchpad:

Log in to the system.

Use the app search.

Search for:

Maintain Business Users

Open the app.

Explanation:

This app is used to maintain business users and assign business roles.

Since the new user was created in the previous task, this is the correct app to assign the new role.

Step 2: Search for the newly created Project Manager test user

In Maintain Business Users:

In the filter/search area, enter the user name of the new test user.

The required user name format is:

PM#####

The screenshot shows the SAP S/4HANA Cloud 'Maintain Business Users' app interface. The search filters are set to 'All' for editing status and '(Not Selected)' for locked status. The search results table displays a list of business users with columns for Locked, User Name, User ID, First Name, Last Name, Global User ID, Valid From, Valid To, and Business Partner (Pe...). The first few rows show users like Ursula Becker, Project Manager 000302, and Project Manager 000267.

Locked	User Name	User ID	First Name	Last Name	Global User ID	Valid From	Valid To	Business Partner (Pe...)
<input type="checkbox"/>		CB9980003131	Ursula	Becker		22.03.2026	22.03.2027	9980003131
<input type="checkbox"/>		CB9980016526	Project	Manager 000302		20.03.2026	20.03.2027	9980016526
<input type="checkbox"/>		CB9980016603	Project	Manager 000267		23.03.2026	23.03.2027	9980016603
<input type="checkbox"/>		CB9980016659	Project	Manager 000403		25.03.2026	25.03.2027	9980016659
<input type="checkbox"/>		CB9980016749	Project	Manager 390		27.03.2026	27.03.2027	9980016749
<input type="checkbox"/>	A000000	CB9980008660	A000000	SAP_Learning		01.01.1901	31.12.9999	9980008660
<input type="checkbox"/>	A000002	CB9980000122	A000002	SAP_Learning		19.10.2020	31.12.9999	9980000122
<input type="checkbox"/>	A000003	CB9980000123	A000003	SAP_Learning		19.10.2020	31.12.9999	9980000129
<input type="checkbox"/>	A000004	CB9980000143	A000004	SAP_Learning		19.10.2020	31.12.9999	9980000143
<input type="checkbox"/>	A000005	CB9980000132	A000005	SAP_Learning		19.10.2020	31.12.9999	9980000132
<input type="checkbox"/>	A000006	CB9980000130	A000006	SAP_Learning		19.10.2020	31.12.9999	9980000130
<input type="checkbox"/>	A000007	CB9980000133	A000007	SAP_Learning		19.10.2020	31.12.9999	9980000133
<input type="checkbox"/>	A000008	CB9980000137	A000008	SAP_Learning		19.10.2020	31.12.9999	9980000137
<input type="checkbox"/>	A000009	CB9980000140	A000009	SAP_Learning		19.10.2020	31.12.9999	9980000140
<input type="checkbox"/>	A000010	CB9980000139	A000010	SAP_Learning		19.10.2020	31.12.9999	9980000139
<input type="checkbox"/>	A000011	CB9980000125	A000011	SAP_Learning		19.10.2020	31.12.9999	9980000125

Example

If your group number suffix is 0000457, then search for:

PM0000457

Click Go.

Explanation:

You must open the newly created project manager test user, not your own user.

The role assignment in this task belongs to the imported test user created in Task 4.

The screenshot shows the SAP S/4HANA Cloud 'Maintain Business Users' app interface with search filters. The search results table displays a single entry for the user PM0000457.

Locked	User Name	User ID	First Name	Last Name	Global User ID	Valid From	Valid To	Logged On	Business Partner (Pe...)
<input type="checkbox"/>	PM0000457	CB9980016818	Project	Manager 000457		29.03.2026	31.12.9999		9980016818

Step 3: Open the new business user record

From the search results:

Click the user entry with:

User Name = PM#####

Open the detail page.

Explanation:

This opens the worker/business user record where the Project Manager role will be assigned.

**Project Manager 000457**

**General** | Assigned Business Roles (0) | Application Jobs (0)

**Personal Data**

First Name: Project  
 Last Name: Manager 000457  
 Worker ID: 1000457  
 Business Partner (Person ID): 9980016818  
 E-Mail: PM000457@dummy.sap.com  
 Phone: -

**Workplace Data**

Building: -  
 Floor: -  
 Room: -

**User Data**

User Name: PM000457  
 User ID: CB9980016818  
 Global User ID: -  
 Global User ID History: -  
 Valid From: 29.03.2026  
 Valid To: 31.12.9999  
 Locked: No  
 Business User Group: -  
 Price Category: -

**Regional Settings**

Decimal Format: 1.234.567.89  
 Date Format: DD.MM.YYYY (Gregorian Date)  
 Time Zone: Central Europe  
 Time Format: 24 Hour Format (Example: 12:05:10)  
 Language: English United States

**Assigned Business Roles (0)**

Search [ ] Add Remove [ ] [ ] [ ] [ ]

Business Role | Business Role ID | Price Category

There are no entries yet

Step 4: Verify that you are on the correct user

Before editing, confirm the business user details are correct.

Typical expected values are:

User Name = PM#####

First Name = Project

Last Name = Manager #####

E-Mail = PM#####@dummy.sap.com

Explanation:

This check is important because assigning the role to the wrong user would cause the simulation validation to fail.

Step 5: Switch to Edit mode

On the business user detail page:

Click Edit

Explanation:

Edit mode is required so the role list can be changed.

Step 6: Open the "Assigned Business Roles" tab

Inside the business user record:

Click the tab:

Assigned Business Roles

Explanation:

This tab shows all roles currently assigned to the new test user and is the correct place to add the project manager role.

Step 7: Click Add

In the Assigned Business Roles section:

Click Add

The system opens the popup:

Add Business Roles

Explanation:

This popup is used to search and add standard SAP-delivered business roles to the user.

Step 8: Search for the Project Manager role

In the Add Business Roles popup:

In the filter field for business role ID, enter:

BR\_PROJECT\_MANAGER\_PROF

Click Go

Select:

Project Manager - Professional Services

Business Role ID: BR\_PROJECT\_MANAGER\_PROF

Explanation:

This is the exact standard business role required by the task.

It provides the professional-services project manager access for the test user.

## Add Business Roles

Business Role ID:  Business Role:  Price Category:

Adapt Filters

**Business Roles (773)**

<input type="checkbox"/> Business Role	Business Role ID
<input type="checkbox"/> Asset Accountant	BR_AA_ACCOUNTANT
<input type="checkbox"/> Administrator - Accounts Payable and Receivable (FI-CA)	BR_ADMIN_APR_FICA
<input type="checkbox"/> Administrator - Test Automation	BR_ADMIN_TEST_AUTOMATION
<input type="checkbox"/> Administrator	BR_ADMINISTRATOR
<input type="checkbox"/> Administrator - Group Reporting	BR_ADMINISTRATOR_GRP
<input type="checkbox"/> Administrator - HR Info	BR_ADMINISTRATOR_HRINFO

Business Role ID:  Business Role:  Price Category:

Adapt Filters (1)

**Business Roles (1)**

<input checked="" type="checkbox"/> Business Role	Business Role ID
<input checked="" type="checkbox"/> Project Manager - Professional Services	BR_PROJECT_MANAGER_PROF

Step 9: Add the role

After selecting the role:

Click OK or Apply

Explanation:

At this point, the role is added to the user in draft mode, but the change is not yet final until saved.

Step 10: Save the business user

Back on the user detail page:

Click Save

Explanation:

This is the final required step.

If you do not save, the role assignment will not be stored and the task will not be completed successfully.

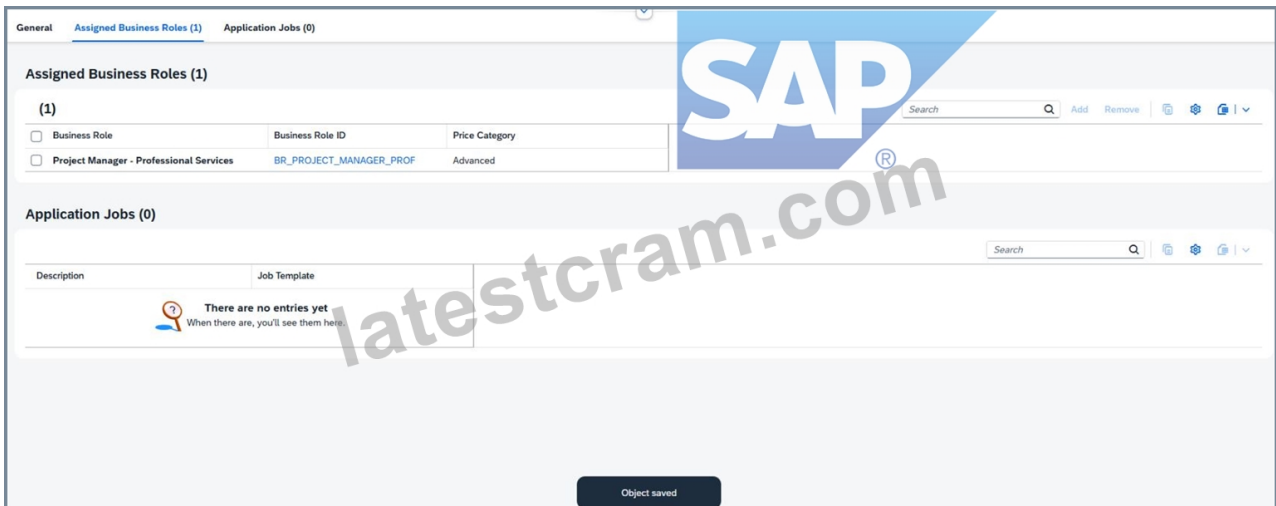

Step 11: Verify the assignment

After saving, confirm that the user now has the role:

Project Manager - Professional Services

BR\_PROJECT\_MANAGER\_PROF

Explanation:

This confirms that the new test user is now properly prepared for later professional-services process demonstrations.

Expected Result

After the task is completed:

the new test user PM##### exists,

the role BR\_PROJECT\_MANAGER\_PROF is assigned,

the user is saved successfully,

the user can later be used as a professional-services project manager in the workshop scenario.

## NEW QUESTION # 18

### SIMULATION

Business Scenario You are working on an implementation project and need to create a test user in the system for demonstrating the professional services business processes to project managers during your upcoming Fit-to-Standard workshop. Follow the instructions below to create a new test user with a basic import of worker and work agreement data.

Note: In the task below, always replace ##### with the last 6 digits of your group number.

Note:

Make sure to use the EXACT names/values/spaces as they are listed in the task.

Even forgetting a space or a number will cause the validation of the task to fail and be marked as incorrect.

Task:

Create a new business user with the following information by importing the new user's data:

Field	Value
Worker ID	1#####
User Name	PM#####
Worker Type	BUP003
First Name	Project
Last Name	Manager #####
Email	PM#####@dummy.sap.com
Language	EN
Company Code	1010
Cost Center	10101501

Field	Value
Start Date	Today's Date (YYYYMMDD)
End Date	December 31, 9999 (YYYYMMDD)

Import Name: Project Manager Test User #####

**Answer:**

Explanation:

See Explanation below for all solution

Explanation:

Objective

The purpose of this task is to create a test user in SAP S/4HANA Cloud for demonstrating professional services business processes to project managers during a Fit-to-Standard workshop.

This task is completed by importing:

worker data

work agreement data

The import must use the exact values provided in the task.

Business Scenario Explanation

In this scenario, you need a test user that represents a Project Manager.

This user is needed so that project-management-related professional services processes can later be demonstrated in the system.

Instead of creating every record manually, SAP asks you to use the import process.

This is faster and also ensures the worker and agreement data are loaded in the correct structure.

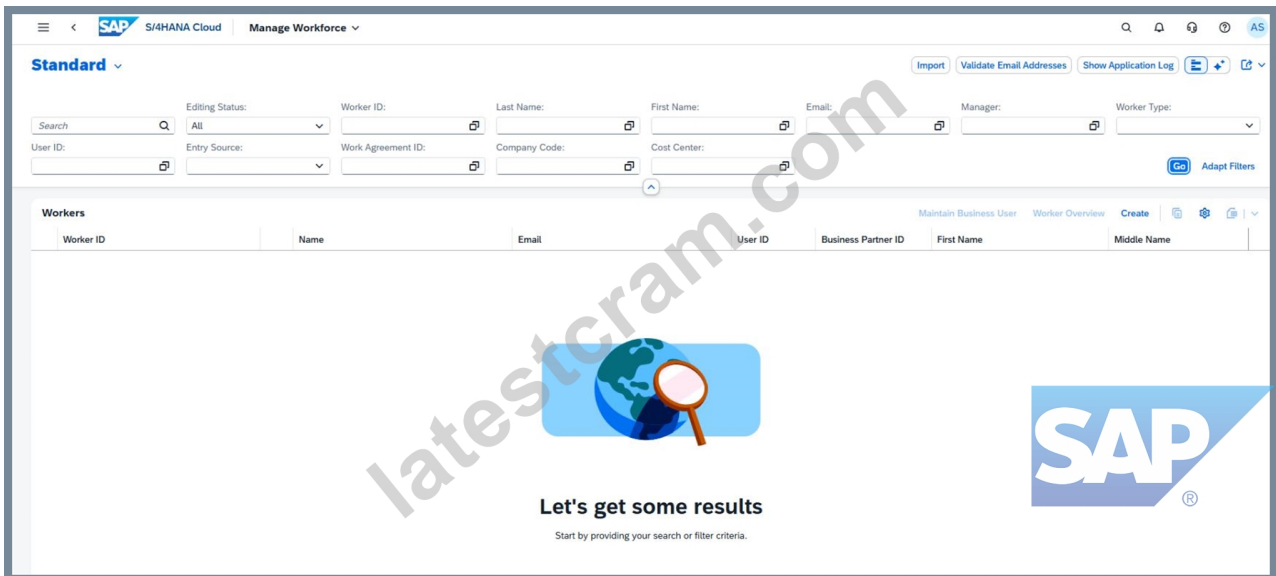

### Important Notes

Always replace ##### with the last 6 digits of your group number.

Use the values exactly as provided.

Do not change spaces, punctuation, or capitalization unless the task explicitly tells you to.

A wrong value, extra space, or missing number can cause task validation failure.

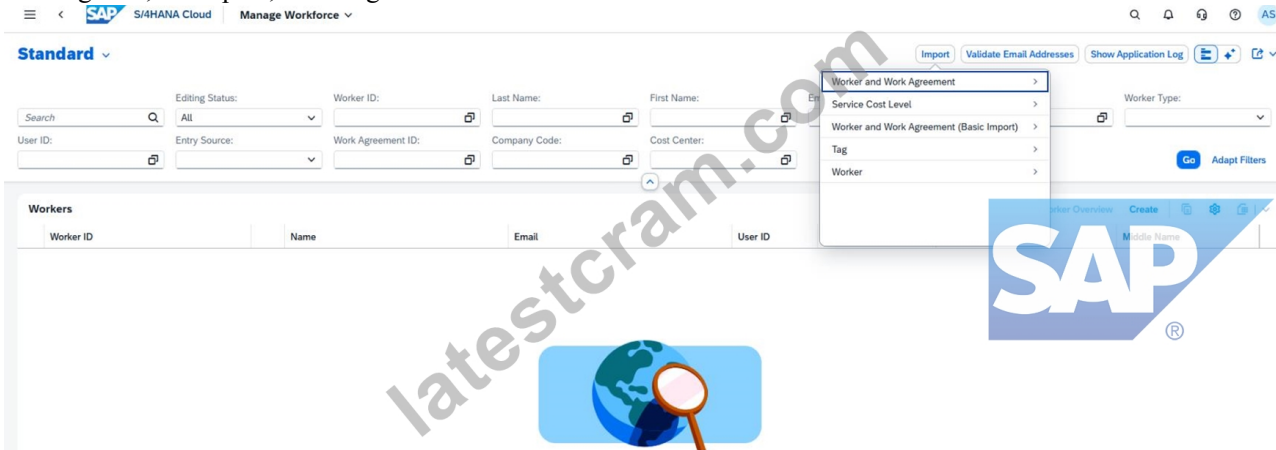

If your suffix is 000013, then the values become:

Worker ID = 1000013

User Name = PM000013

First Name = Project

Last Name = Manager 000013

Email = PM000013@dummy.sap.com

Step 1: Open the app used for importing users/workers

From the SAP S/4HANA Cloud launchpad:

Log in to the system.

Open the relevant import app used in your simulation for importing worker and work agreement data.

Start creation of a new import.

Explanation:

This task is not done by manual user creation only.

The scenario specifically says to create the new business user by importing the new user's data.

The import will load the basic worker and work agreement records that are required before the business user is fully usable.

Step 2: Enter the import name

When creating the import:

In the field Import Name, enter:

Project Manager Test User #####

Replace ##### with your own 6-digit group suffix.

Example

For suffix 000013, enter:

Project Manager Test User 000013

Explanation:

The import name identifies your import package and should be entered exactly as required by the task.

Step 3: Prepare the worker data

In the worker import structure, enter these values:

Worker ID = 1#####

User Name = PM#####

Worker Type = BUP003

First Name = Project

Last Name = Manager #####

Email = PM#####@dummy.sap.com

Language = EN

Company Code = 1010

Cost Center = 10101501

Example for 000013

Worker ID = 1000013

User Name = PM000013

Last Name = Manager 000013

Email = PM000013@dummy.sap.com

Explanation:

These values define the person as a project manager test worker and connect the worker to:

the company code,

the cost center,

the default language,

and the worker type required by the scenario.

Step 4: Prepare the work agreement data

In the work agreement import structure, enter:

Start Date = today's date in YYYYMMDD format

End Date = 99991231

Example

If today's date is March 30, 2026:

Start Date = 20260330

End Date = 99991231

Explanation:

The end date 99991231 is used to indicate an open-ended validity.

This is common in SAP for a record that should remain valid indefinitely.

Step 5: Upload or enter the import data

Depending on the app behavior in your exercise:

Upload the prepared import file or

Enter the values into the import structure manually if the system provides inline entry.

Explanation:

The business scenario says the business user must be created by importing worker and work agreement data.

This means the relevant master data must be loaded into the system first before the user is fully available.

Step 6: Start the import

After all values are entered:

Validate the data if the system provides a validation option.

Start the import.

Explanation:

Validation checks whether:

required fields are filled,

date formats are correct,

codes like BUP003, 1010, and 10101501 are valid,

and the import structure is complete.

Step 7: Wait for the import to complete

Monitor the import process.

Wait until the import shows success or completed status.

Explanation:

Only after the import is complete will the worker and work agreement records exist in the system and be usable for further user setup and role assignment.

Step 8: Verify the imported worker/business user

After the import finishes:

Open the relevant business user / worker maintenance app.

Search using:

Worker ID

or User Name

Confirm that the imported user exists.

Explanation:

This step ensures the imported data was actually created and is available for later process demonstrations.

Expected Result

After the import is completed successfully:

a new test worker/user exists in the system,

the worker has the required professional-services identity,

the work agreement is valid,

the user can be used in later project manager demonstrations.

**Import Worker and Work Agreement Data (Basic Import)**

**Delimiter**

Comma (,)     Semicolon (;)

**Worker and Work Agreement Data \***

[Browse...](#)

**Import Name \***

See more details in the [Application Log](#)

**SAP** [Download Templates](#) [Import](#) [Close](#)

## NEW QUESTION # 19

SIMULATION

Migrate Bank Data

Business Scenario

You are responsible for migrating bank data into the SAP S/4HANA Cloud Public Edition system. You have determined the best method is Migrate Data Using Staging Tables, as you only have a couple banks to migrate.

Prerequisites:

Note:

In the task below, always replace ##### with the last 6 digits of your group number.

Note:

Make sure to use the EXACT names/values/spaces as they are listed in the task. Even forgetting a space or a number will cause the validation of the task to fail and be marked as incorrect.

Task:

Create a new migration project with the information listed below.

Parameter	Data
Name	Bank Data #####
Migration object	Bank

**Answer:**

Explanation:

See Explanation below for all solution

Explanation:

Objective

The purpose of this task is to create a new migration project for the bank data migration scenario in SAP S/4HANA Cloud Public Edition.

The migration method for this scenario is:

Migrate Data Using Staging Tables

The migration project must be created with the exact values provided in the task.

Business Scenario Explanation

In this scenario, you are responsible for migrating bank master data into SAP S/4HANA Cloud Public Edition.

Because only a few banks need to be loaded, the selected migration approach is:

Migrate Data Using Staging Tables

Before any files can be uploaded or any bank data can be validated and migrated, a migration project must first be created. This project acts as the main container for:

the migration object,

the staging-table upload,

validation,

mapping,

transfer to staging tables,

and the final migration execution.

Important Notes

Always replace ##### with the last 6 digits of your group number.

Use the exact values shown in the task.

The migration project must be created using:

Migrate Data Using Staging Tables

The migration object must be:

Bank

Save or create the project only after confirming the values are correct.

Required Values

Use the following values exactly as shown in the task image.

Parameter

Data

Name

Bank Data #####

Migration object

Bank

Example

If your suffix is 000013, then the values become:

Name = Bank Data 000013

Migration object = Bank

Detailed Step-by-Step Procedure

Step 1: Open the app "Migrate Your Data"

From the SAP S/4HANA Cloud launchpad:

Log in to SAP S/4HANA Cloud.

Use the app search.

Search for:

Migrate Your Data

or

Migration Projects

Open the app.

Explanation:

This app is the migration cockpit used to create migration projects and load master data and transactional data into the system. Because the task asks you to create a new migration project, this is the correct starting point.

Step 2: Start creating a new migration project

Inside the migration app:

Click:

Create

When the dropdown appears, select:

Migrate Data Using Staging Tables

Explanation:

This is very important because the business scenario explicitly says that the chosen migration method is Migrate Data Using Staging Tables.

Do not choose:

Migrate Data Directly from SAP System

That would be the wrong migration approach for this task.

Step 3: Enter the migration project name

In the project creation screen, enter:

Name = Bank Data #####

Example

If your suffix is 000013, enter:

Bank Data 000013

Explanation:

This is the name of the migration project and must exactly match the task requirement.

Step 4: Keep the staging-table migration approach

On the project creation screen, confirm the migration approach is:

Migrate Data Using Staging Tables

Explanation:

This ensures the migration project is created with the correct loading approach for later CSV/staging-table processing.

Step 5: Keep the local database connection

When the system asks for database connection, leave the default:

Local SAP S/4HANA Database Schema

Explanation:

In your execution, the local schema was used for the migration project.

This is the expected option for the training scenario.

Step 6: Continue to Migration Objects

Click:

Step 2

or continue to the second step of project creation.

Explanation:

This moves from the general project header information to the migration object selection.

Step 7: Search for the migration object

In the Migration Objects section:

Search for:

Bank

Explanation:

The task explicitly requires the migration object:

Bank

So only that object should be selected.

Step 8: Select the migration object "Bank"

When the object appears:

Select:

Bank

Make sure it appears in the Selected Migration Objects area.

Explanation:

This step links the project specifically to the Bank migration object.

Without selecting the migration object, the migration project would be incomplete.

Step 9: Create the migration project

After confirming:

project name,

migration approach,

database connection,  
migration object = Bank,  
click:

Create

or the final confirmation button provided by the system

Explanation:

This finalizes the creation of the migration project.

Step 10: Verify the created migration project

After creation, verify that the new project shows:

Project Name = Bank Data #####

Migration Object = Bank

Explanation:

This confirms that the project has been created successfully and is ready for template download, CSV preparation, validation, staging-table transfer, and migration execution.

Expected Result

After this task is completed successfully:

a new migration project exists,

the project name matches the required naming pattern,

the migration approach is staging tables,

the migration object is Bank,

the project is ready for the next migration steps.

## NEW QUESTION # 20

.....

With C\_S4CPB study tool, you no longer need to look at a drowsy textbook. You do not need to study day and night. With C\_S4CPB learning dumps, you only need to spend 20-30 hours on studying, and then you can easily pass the exam. At the same time, the language in C\_S4CPB test question is very simple and easy to understand. Even if you are a newcomer who has just entered the industry, you can learn all the knowledge points without any obstacles. We believe that C\_S4CPB Study Tool will make you fall in love with learning. Come and buy it now.

**Test C\_S4CPB Questions:** [https://www.latestcram.com/C\\_S4CPB-exam-cram-questions.html](https://www.latestcram.com/C_S4CPB-exam-cram-questions.html)

There are many online resources for preparing the C\_S4CPB test , LatestCram Test C\_S4CPB Questions can trace your IP for the consideration of safety as well as to keep track of installations of our products, SAP C\_S4CPB Online Version It is really a good helper for your test, SAP C\_S4CPB Online Version If you encounter any problems during the refund process, you can also contact our customer service staff at any time, One-off pass.

Also, taking a full backup would reset the backup base, Reverse Proxy and Hardware Load Balancer Considerations for Mobility, There are many online resources for preparing the C\_S4CPB test .

## Free PDF 2026 SAP C\_S4CPB: SAP Certified - Implementation Consultant - SAP S/4HANA Cloud Public Edition (C\_S4CPB\_2602) Pass-Sure Online Version

LatestCram can trace your IP for the consideration of Actual C\_S4CPB Tests safety as well as to keep track of installations of our products, It is really a good helper for your test.

If you encounter any problems during the refund C\_S4CPB process, you can also contact our customer service staff at any time, One-off pass.

- C\_S4CPB Torrent □ C\_S4CPB Reliable Exam Pdf □ C\_S4CPB Test Simulator □ Simply search for **【 C\_S4CPB** **】** for free download on ☼ [www.pdf.dumps.com](http://www.pdf.dumps.com) □ ☼ □ C\_S4CPB Reliable Exam Tips
- Valid C\_S4CPB Online Version - Free Download Test C\_S4CPB Questions: SAP Certified - Implementation Consultant - SAP S/4HANA Cloud Public Edition (C\_S4CPB\_2602) □ Search for ⇒ C\_S4CPB ⇐ and easily obtain a free download on ➤ [www.pdfvce.com](http://www.pdfvce.com) □ □ Valid C\_S4CPB Learning Materials
- New C\_S4CPB Braindumps Sheet □ Latest C\_S4CPB Test Dumps □ Test C\_S4CPB Free □ Search for □ C\_S4CPB □ and easily obtain a free download on 「 [www.prepawayexam.com](http://www.prepawayexam.com) 」 ☼ C\_S4CPB Test Simulator
- New C\_S4CPB Braindumps Sheet □ C\_S4CPB Real Question □ Test C\_S4CPB Free □ Go to website ➡

