

PDD Free Practice Exams & PDD Dump Collection

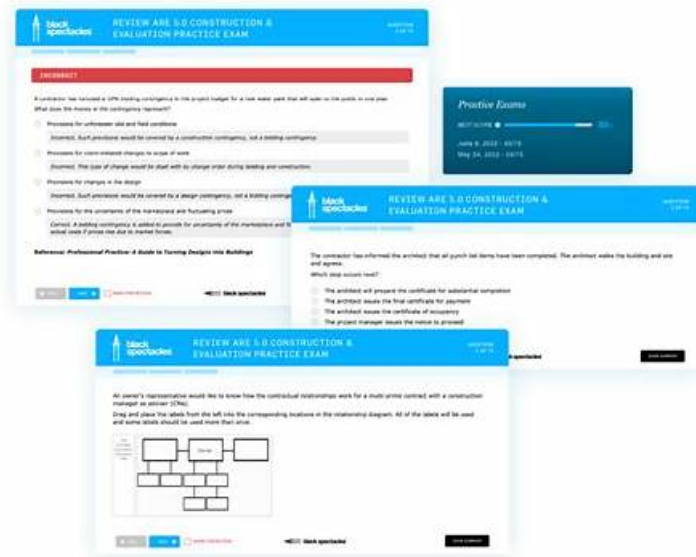

What's more, part of that Prep4sureExam PDD dumps now are free: <https://drive.google.com/open?id=1wyNzOocBRH8dyCMUilnnubBE096wDWsF>

If you are preparing for PDD exam and upset without accurate exam torrent and practice materials, Prep4sureExam guarantees you to pass exam at first attempt absolutely. Our PDD exam torrent is edited by latest official examination knowledge. Once official department change questions we will release new version of PDD Exam Torrent accordingly. We provide one year free update and service warranty for all products. You will have sufficient time to take part in exams.

NCARB PDD Exam Syllabus Topics:

Topic	Details
Topic 1	<ul style="list-style-type: none"> Project Manual & Specifications: This section of the exam measures the skills of Specifications Writers and emphasizes the importance of developing documentation that goes beyond drawings. Candidates must understand how to identify and prioritize elements needed to prepare, maintain, and refine both the project manual and project specifications. It also assesses the ability to align and coordinate these specifications with the construction documents to ensure consistency and accuracy.
Topic 2	<ul style="list-style-type: none"> Codes & Regulations: This section of the exam measures skills of Building Code Specialists and examines how codes and regulations apply at a detailed level during documentation. Candidates are expected to demonstrate knowledge of compliance with the International Building Code (IBC) as well as other specialty regulations, as well as how to interpret and apply these standards to ensure design and documentation meet legal and safety requirements.
Topic 3	<ul style="list-style-type: none"> Construction Documentation: This section of the exam measures skills of Project Architects and addresses the creation and management of project documentation. Candidates are expected to demonstrate knowledge of documenting building design and site features, preparing detailed architectural drawings, and applying industry standards to produce a coordinated set of construction documents. The section also includes understanding how project changes impact documentation and how to communicate these updates effectively to both the design team and the client.:

Topic 4	<ul style="list-style-type: none"> • Integration of Building Materials & Systems: This section of the exam measures the skills of Architectural Designers and focuses on the ability to resolve and integrate various building systems into cohesive project goals. It covers analyzing architectural systems and technologies, determining the size of structural, mechanical, electrical, and plumbing systems, and incorporating specialty systems such as acoustics, lighting, security, and communications. It also evaluates the ability to detail how multiple building systems work together and to coordinate across disciplines to achieve a unified design.
Topic 5	<ul style="list-style-type: none"> • Construction Cost: This section of the exam measures the skills of Construction Managers and focuses on the financial side of project execution. It evaluates the ability to analyze construction cost estimates to confirm that they align with project design intent and budgetary constraints. Although this is the smallest section, it is critical for ensuring projects remain feasible and economically viable.

>> PDD Free Practice Exams <<

In How Many Ways You Can Prepare Through Prep4sureExam NCARB PDD Exam Questions?

At the beginning of the launch of our PDD exam torrent, they made a splash in the market. We have three versions which are the sources that bring prestige to our company. Our PDF version of ARE 5.0 Project Development and Documentation Exam prepare torrent is suitable for reading and printing requests. You can review and practice with it clearly just like using a processional book. It can satisfy the fundamental demands of candidates with concise layout and illegible outline. The second one of PDD Test Braindumps is software versions which are usable to windows system only with simulation test system for you to practice in daily life. The last one is app version of PDD exam torrent suitable for different kinds of electronic products.

NCARB ARE 5.0 Project Development and Documentation Exam Sample Questions (Q73-Q78):

NEW QUESTION # 73

Refer to the exhibit.

What is an accurate description of the air distribution system shown?

- A. The system is inefficient in summer months.
- **B. Supply air is delivered at a low velocity.**
- C. The system prohibits individual comfort control.
- D. Ducted supply and return air is utilized.

Answer: B

Explanation:

The diagram shows a displacement ventilation system. In this system:

Cool supply air (about 65°F) is introduced at floor level at low velocity through floor diffusers.

Warm air rises as it picks up heat from occupants/equipment and stratifies near the ceiling, where it is returned or exhausted.

This creates a stratification layer with cooler, cleaner air in the occupied zone and warmer air above.

This is efficient for comfort, air quality, and energy use in spaces #12 ft high.

Why not other options:

A: This system uses a plenum return, not ducted supply and return for both.

C: It is efficient in summer since it uses warmer supply air and reduced fan energy.

D: Individual comfort control is possible via diffuser location/adjustment.

PDD Reference: ARE 5.0 PDD "Mechanical Systems-Air distribution types," ASHRAE Fundamentals, displacement ventilation diagrams.

NEW QUESTION # 74

Refer to the exhibit.

An architect is developing an electrical diagram to show equipment configuration and flow of electricity for a residential project. The project is integrating on-site wind generation where the utility company does not allow net metering.

Which diagram meets the project requirements?

- A. Diagram A
- **B. Diagram C**
- C. Diagram B

Answer: B

NEW QUESTION # 75

Refer to the exhibit.

An architect reviews the construction manager's construction estimate for a typical precast wall system with aluminum storefront windows.

Click on the component in the axonometric detail that is missing from the system estimate.

Answer:

Explanation:

Explanation:

1. Reviewing the Construction Estimate

The listed components are:

- * Architectural Precast Panels - exterior cladding
- * Aluminum Storefront Windows - glazing system
- * Prefinished Metal Sill Flashing - weatherproofing at sill
- * Sealant - for joints between components

No line item appears for thermal insulation.

2. Identifying the Missing Element in the Axonometric Detail

Looking at the drawing:

- * The detail shows precast concrete panel cladding outside.
- * A storefront frame and glazing in the opening.
- * There is a hatched layer behind the precast in the stud cavity area - this represents continuous insulation.
- * The insulation is a required component for the wall to meet energy code R-value/U-factor requirements (per IECC or ASHRAE 90.1).

3. Why This is Critical

- * Insulation is essential for thermal performance, occupant comfort, and energy efficiency.
- * Omitting it from the estimate could cause:
 - * Noncompliance with code.
 - * Incomplete cost budgeting.
 - * Change orders during construction.
- * In ARE 5.0 PDD, architects must check that all components of an assembly are represented in the cost estimate.

4. References

- * NCARB ARE 5.0 Handbook - PDD Content Area 3: Integration of Building Materials & Systems
- * Architectural Graphic Standards - Precast wall sections with insulation
- * Building Construction Illustrated (Ching) - Continuous insulation in wall assemblies
- * Energy Code References: IECC Table C402.1.3 for minimum continuous insulation requirements in exterior walls

NEW QUESTION # 76

What is the most destructive factor affecting the durability of mortar joints?

- **A. Expansion of moisture by freezing**
- B. Efflorescence
- C. Wind loading
- D. Location of control joints

Answer: A

Explanation:

The most destructive factor for mortar joints is freeze-thaw cycling: absorbed moisture expands upon freezing (~9% volume increase), creating internal stresses that crack mortar and spall joints.

A: Wind loading affects wall stability, not directly mortar joint durability.
B: Control joints manage thermal/movement cracks but aren't the main durability factor.
C: Efflorescence is cosmetic and less destructive than freeze-thaw action.
PDD Reference: Masonry durability-Moisture management; ASTM C270 Mortar Specs; ARE 5.0 PDD
"Building envelope durability in cold climates."

NEW QUESTION # 77

□ An architect is designing a school building that features a flat roof with a low parapet wall in a wet climate region. The client wants to minimize maintenance requirements and focus on keeping water from the walls.
What parapet coping detail would be most appropriate for the architect to select for this project?

- A. B
- **B. C**
- C. A

Answer: B

Explanation:

Understanding the Problem

The question addresses parapet coping design in a wet climate with a focus on:

- * Minimizing maintenance
- * Preventing water from running down the face of the wall

Parapet copings protect the top of the parapet wall from water penetration and are designed to shed water away from the wall below.

Analysis of the Options

A). Flat Coping

- * A flat coping (Option A) has no slope and allows water to pool on the surface.
- * This pooling increases the likelihood of infiltration and material deterioration over time.
- * In wet climates, this is poor practice because standing water leads to freeze-thaw damage, staining, and faster degradation.
- * Maintenance needs are higher.

B). Single-Slope Coping

- * This coping (Option B) has a slope toward one side, which improves drainage.
- * However, if sloped toward the inside of the parapet, it increases roof drainage load and risk of water penetration at roof/wall junction.
- * If sloped toward the outside, water can run down the wall face, which the client specifically wants to avoid.
- * This design might also stain exterior wall finishes over time.

C). Double-Slope (Pitched) Coping with Drip Edges

- * This coping (Option C) is pitched toward both sides, with drip edges to break water runoff before it reaches the wall face.
- * Water is shed away efficiently, and drip grooves prevent capillary action that would pull water back toward the wall.
- * This is best practice in wet climates and greatly reduces maintenance by preventing staining and wall saturation.
- * Recommended by NRCA (National Roofing Contractors Association) and referenced in Architectural Graphic Standards for parapet detailing.

NCARB ARE 5.0 PDD Reference:

- * Content Area: Integration of Building Materials & Systems - Building Envelope Detailing
- * Source Materials:
 - * Architectural Graphic Standards - Parapet Cap/Coping Details
 - * Building Construction Illustrated by Francis D.K. Ching - Water Management & Flashing
 - * NRCA Roofing Manual - Best Practices for Roof Edge & Parapet Design
- * Key Principle: Parapet copings in wet climates should always slope to shed water away, incorporate overhangs with drips, and prevent water from cascading down the building face.

NEW QUESTION # 78

.....

When preparing to take the ARE 5.0 Project Development and Documentation Exam (PDD) exam dumps, knowing where to start can be a little frustrating, but with Prep4sureExam NCARB PDD practice questions, you will feel fully prepared. Using our NCARB PDD practice test software, you can prepare for the increased difficulty on NCARB PDD Exam day. Plus, we have various question types and difficulty levels so that you can tailor your ARE 5.0 Project Development and Documentation Exam (PDD) exam

PDD Dump Collection: <https://www.prep4sureexam.com/PDD-dumps-torrent.html>

- What's more, part of that Prep4sureExam PDD dumps now are free: <https://drive.google.com/open?id=1wyNzOocBRH8dyCMUilnubBE096wDWsF>

What's more, part of that Prep4sureExam PDD dumps now are free: <https://drive.google.com/open?id=1wyNzOocBRH8dyCMUilnubBE096wDWsF>