

Exam PL-600 Labs & PL-600 Exam PDF

***PL-600* Solution Architect**
2024 Latest Exam Questions

405 Pages

**Multiple Choice
Questions/Answers
With Clear Explanation**

**Get
Update
For Free**

You Pass I Reward!

BTW, DOWNLOAD part of Exams4sures PL-600 dumps from Cloud Storage: <https://drive.google.com/open?id=1HrJnVxzo2EbSof5t4YiX7lyozo3O7PRF>

Whatever exam you choose to take, Exams4sures training dumps will be very helpful to you. Because all questions in the Actual PL-600 Test are included in Exams4sures practice test dumps which provide you with the adequate explanation that let you understand these questions well. As long as you master these questions and answers, you will sail through the exam you want to attend.

There is a way to clear your PL-600 certification exam without finding the best source of help. As an applicant for the Microsoft Power Platform Solution Architect (PL-600) exam, you need actual Microsoft PL-600 exam questions to know how you can score well and attempt it successfully. You can visit Exams4sures to get the best quality PL-600 Practice Test material for the PL-600 exam.

>> Exam PL-600 Labs <<

PL-600 Exam PDF | New PL-600 Test Pattern

By imparting the knowledge of the PL-600 exam to those ardent exam candidates who are eager to succeed like you, they treat it as responsibility to offer help. So please prepare to get striking progress if you can get our PL-600 Study Guide with following steps for your information. With our PL-600 learning materials for 20 to 30 hours, we can claim that you will be confident to go to write your PL-600 exam and pass it.

Microsoft Power Platform Solution Architect Sample Questions (Q78-Q83):

NEW QUESTION # 78

An automobile parts manufacturer wants to replace an existing system with a Microsoft Power Platform solution. The company has been experiencing undesired data changes in their current system. The cause of the changes is due to the relationships that are set up between tables in the database that the system uses.

The new solution must meet the following requirements:

- * Track vehicle manufacturers and models.
- * Display a list of all models that a manufacturer produces.
- * Ensure that each vehicle model can be associated to only one manufacturer.
- * Delete all associated models when a user deletes a manufacturer.

* Automatically populate information from the manufacturer when creating a new model from the model list on the manufacturer page.

You need to recommend table relationships to meet the business requirements.

Which relationship settings should you recommend? To answer, select the appropriate options in the answer area.

NOTE: Each correct selection is worth one point.

Answer Area

Business requirement
The system must delete all associated models when a user deletes a manufacturer.

The system must auto-populate information from the manufacturer when creating a new model from the model list on the manufacturer page.

Relationship
Use a parental 1:N relationship between manufacturer and model.
Use a parental 1:N relationship between manufacturer and model.
Use a referential 1:N relationship between manufacturer and model.
Use field mappings in 1:N relationship between manufacturer and model.
Use an N:N relationship between manufacturer and model.

Use field mappings in 1:N relationship between manufacturer and model.
Use a parental 1:N relationship between manufacturer and model.
Use a referential 1:N relationship between manufacturer and model.
Use field mappings in 1:N relationship between manufacturer and model.
Use an N:N relationship between manufacturer and model.

Answer:

Explanation:
Answer Area

Business requirement
The system must delete all associated models when a user deletes a manufacturer.

The system must auto-populate information from the manufacturer when creating a new model from the model list on the manufacturer page.

Relationship
Use a parental 1:N relationship between manufacturer and model.
Use a parental 1:N relationship between manufacturer and model.
Use a referential 1:N relationship between manufacturer and model.
Use field mappings in 1:N relationship between manufacturer and model.
Use an N:N relationship between manufacturer and model.

Use field mappings in 1:N relationship between manufacturer and model.
Use a parental 1:N relationship between manufacturer and model.
Use a referential 1:N relationship between manufacturer and model.
Use field mappings in 1:N relationship between manufacturer and model.
Use an N:N relationship between manufacturer and model.

Explanation:

Business requirement	Relationship
The system must delete all associated models when a user deletes a manufacturer.	Use a parental 1:N relationship between manufacturer and model.
The system must auto-populate information from the manufacturer when creating a new model from the model list on the manufacturer page.	Use field mappings in 1:N relationship between manufacturer and model.

NEW QUESTION # 79

You are designing the data model for a school. The school wants to track students' enrollments in courses.

The system must meet the following requirements:

Track the courses in which each student is enrolled.

Track the students that are enrolled in each course.

Track dates when each student enrolled in each course and the person who approved the enrollment.

Allow users to create a report that details which students are enrolled in which courses.

You need to recommend a data model that will fit the school's requirements.

Which logical model should you recommend?

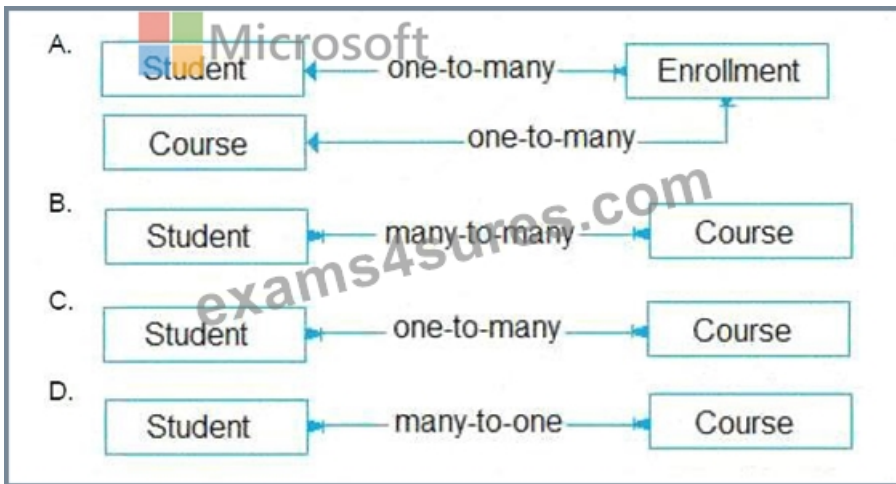

- A. Option B
- B. Option C
- **C. Option A**
- D. Option D

Answer: C

Explanation:

Need a relationship table.

N:N (Many-to-Many): A table relationship that depends on a special Relationship table, sometimes called an Intersect table, so that many rows of one table can be related to many rows of another table.

When viewing rows of either table in a N:N relationship you can see a list of any rows of the other table that are related to it.

Reference:

<https://docs.microsoft.com/en-us/powerapps/maker/data-platform/create-edit-entity-relationships>

NEW QUESTION # 80

You need to recommend a solution to meet user interface requirements.

What should you recommend? To answer, select the appropriate options in the answer area.

NOTE: Each correct selection is worth one point.

Requirement	Solution
Visual representation of gauge readings with minimum and maximum tolerances.	<ul style="list-style-type: none"> Create and embed a Power BI radial gauge. Create and embed a custom visualization component. Create and embed a standard Power Apps donut chart.
Add visibility to the manufacturing inspection records for onsite technicians.	<ul style="list-style-type: none"> Configure mobile offline synchronization. Add an inspection order to the work order form Modify the sitemap for Dynamics 365 Field Service.

Answer:

Explanation:

Requirement	Solution
Visual representation of gauge readings with minimum and maximum tolerances.	<ul style="list-style-type: none"> Create and embed a Power BI radial gauge. Create and embed a custom visualization component. Create and embed a standard Power Apps donut chart.
Add visibility to the manufacturing inspection records for onsite technicians.	<ul style="list-style-type: none"> Configure mobile offline synchronization. Add an inspection order to the work order form Modify the sitemap for Dynamics 365 Field Service.

Explanation

Requirement	Solution
Visual representation of gauge readings with minimum and maximum tolerances.	<ul style="list-style-type: none"> Create and embed a Power BI radial gauge. Create and embed a custom visualization component. Create and embed a standard Power Apps donut chart.
Add visibility to the manufacturing inspection records for onsite technicians.	<ul style="list-style-type: none"> Configure mobile offline synchronization. Add an inspection order to the work order form Modify the sitemap for Dynamics 365 Field Service.

Box 1: Create and embed a Power Bi radial gauge

A radial gauge chart has a circular arc and shows a single value that measures progress toward a goal or a Key Performance Indicator (KPI). The line (or needle) represents the goal or target value. The shading represents the progress toward that goal. The value inside the arc represents the progress value. Power BI spreads all possible values evenly along the arc, from the minimum (left-most value) to the maximum (right-most value).



In this example, you're a car retailer tracking the sales team's average sales per month. The needle represents a 140 cars sales goal. The minimum possible average sales is 0 and the maximum is 200. The blue shading shows that the team is averaging approximately 120 sales this month.

Box 2: Add an inspection order to the work order form

You can add inspections to work orders in Dynamics 365 Field Service.

Field Service inspections are digital forms that technicians use to quickly and easily answer a list of questions as part of a work order. The list of questions can include safety protocols, pass-and-fail tests for a customer asset, an interview with a customer, or other audits and assessments performed before, during, or after a work order.

Example:

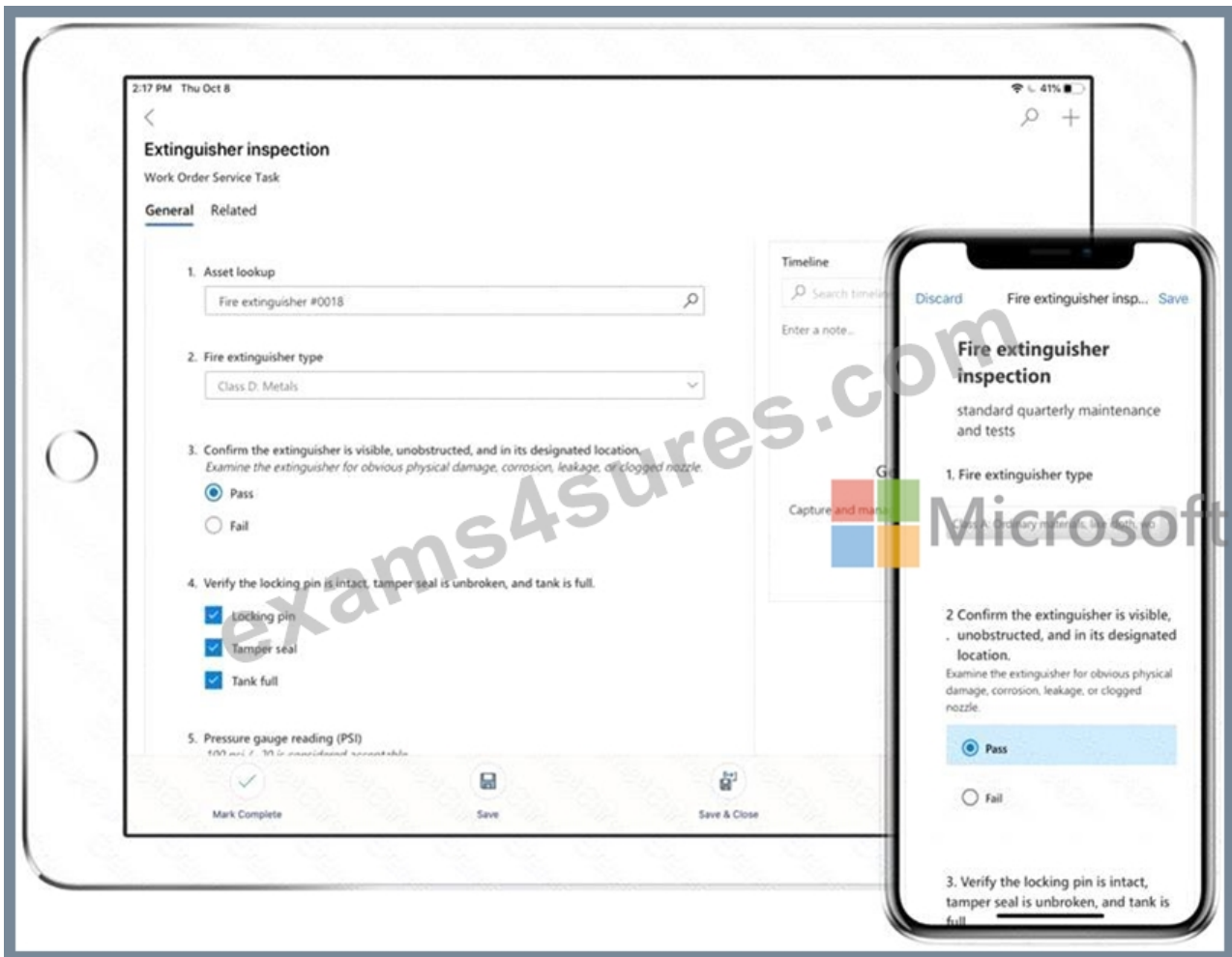

Reference:

<https://docs.microsoft.com/en-us/power-bi/visuals/power-bi-visualization-radial-gauge-charts>

<https://docs.microsoft.com/en-us/dynamics365/field-service/inspections>

NEW QUESTION # 81

You are designing a data model for a Microsoft Power Platform solution.

The data model must meet the following requirements:

- * When an account is assigned to a new salesperson, all opportunities that are associated with the account must be assigned to the new salesperson.
- * When a salesperson assigns a lead to another salesperson, all phone call activities related to the lead must be assigned to the new salesperson.

You need to recommend cascading strategies for the data model.

Which cascading strategy should you recommend? To answer, drag the appropriate cascading strategies to the correct requirements. Each cascading strategy may be used once, more than once, or not at all. You may need to drag the split bar between panes or scroll to view content NOTE: Each correct selection is worth one point.

Cascading strategies	Requirement	Cascading strategy
<input type="text" value="Cascade All"/> <input type="text" value="Cascade Active"/> <input type="text" value="Cascade User Owned"/> <input type="text" value="Cascade None"/>	<p>When an account is assigned to a new salesperson, all opportunities that are associated with the account must be assigned to the new salesperson.</p> <p>When a salesperson assigns a lead to another salesperson, all phone call activities related to the lead must be assigned to the new salesperson.</p>	<input type="text"/> <input type="text"/>

Answer:

Explanation:

Cascading strategies

- Cascade All
- Cascade Active
- Cascade User Owned
- Cascade None

Requirement

When an account is assigned to a new salesperson, all opportunities that are associated with the account must be assigned to the new salesperson.

When a salesperson assigns a lead to another salesperson, all phone call activities related to the lead must be assigned to the new salesperson.

Cascading strategy

- Cascade All
- Cascade User Owned

Explanation

Cascading strategies

- Cascade All
- Cascade Active
- Cascade User Owned
- Cascade None

Requirement

When an account is assigned to a new salesperson, all opportunities that are associated with the account must be assigned to the new salesperson.

When a salesperson assigns a lead to another salesperson, all phone call activities related to the lead must be assigned to the new salesperson.

Cascading strategy

- Cascade All
- Cascade User Owned

NEW QUESTION # 82

You are a Microsoft Power Platform architect gathering solution requirements for a customer. Management uses three different systems to locate asset inventory and contract details.

Management must view inventory with the ability to select assets and view additional details. Sales representatives have issues locating assets based on specific features in a timely manner when working with customers.

You need to prioritize the requirements.

Which priority should you use? To answer, select the appropriate options in the answer area.

NOTE: Each correct selection is worth one point.

Requirement

Enable sales representatives to locate assets in less time.

Priority

- Non-functional
- Time Consumer
- Non-functional
- Functional
- Quick Win

Requirement

Enable management to view inventory and asset details.

Priority

- Functional
- Big Investment
- Non-functional
- Budget
- Functional

Answer:

Explanation:

Answer Area

Requirement

Enable sales representatives to locate assets in less time.

Priority

- Non-functional
- Time Consumer
- Non-functional
- Functional
- Quick Win

Requirement

Enable management to view inventory and asset details.

Priority

- Functional
- Big Investment
- Non-functional
- Budget
- Functional

Explanation:

Answer Area

Requirement

Enable sales representatives to locate assets in less time.

Priority

- Non-functional
- Functional

Requirement

Enable management to view inventory and asset details.

Priority

- Functional

