

C-S4CPB-2602시험대비공부자료최신덤프무료샘플



Pass4Test를 검색을 통해 클릭하게된 지금 이 순간 IT인증자격증취득SAP C-S4CPB-2602시험은 더는 힘든 일이 아닙니다. 다른 분들이SAP C-S4CPB-2602시험준비로 수없는 고민을 할때 고객님의 저희 SAP C-S4CPB-2602덤프로 제일 빠른 시일내에 시험을 패스하여 자격증을 손에 넣을수 있습니다.

요즘 같은 인재가 많아지는 사회에도 많은 업계에서는 아직도 관련인재가 부족하다고 합니다.이업계에서도 이러한 상황입니다.SAP C-S4CPB-2602시험은 IT인증을 받을 수 있는 좋은 시험입니다. 그리고Pass4Test는SAP C-S4CPB-2602덤프를 제공하는 사이트입니다.

>> C-S4CPB-2602시험대비 공부자료 <<

C-S4CPB-2602높은 통과율 덤프공부문제, C-S4CPB-2602높은 통과율 덤프 데모문제

Pass4Test는SAP C-S4CPB-2602시험을 패스할 수 있는 아주 좋은 사이트입니다. Pass4Test은 아주 알맞게 최고의 SAP C-S4CPB-2602시험문제와 답 내용을 만들어 냅니다. 덤프는 기존의 시험문제와 답과 시험문제분석 등입니다. Pass4Test에서 제공하는SAP C-S4CPB-2602시험자료의 문제와 답은 실제시험의 문제와 답과 아주 비슷합니다.

최신 SAP Certified Associate C-S4CPB-2602 무료샘플문제 (Q11-Q16):

질문 # 11

SIMULATION

Create a Custom Launchpad Space and Page

Business Scenario

You are building a custom business role that will be assigned to all employees in the organization. The business role and its corresponding Launchpad Space and Page need to include the apps that have been granted through the business catalogs assigned to the business role to ensure employees have an easy time finding the relevant applications.

Note: In the task below, always replace ##### with the last 6 digits of your group number.

Note:

Make sure to use the EXACT names/values/spaces as they are listed in the task.

Even forgetting a space or a number will cause the validation of the task to fail and be marked as incorrect.

Task:

Assign the business catalogs listed below to the business role and save:

HCM - Employee Self-Service (SAP_HCM_BC_EMP_PC)

Concur - Employee Self-Service (SAP_CON_BC_CTE_ESS_PC)

정답 :

설명:

See Explanation below for all solution

Explanation:

Objective

The purpose of this task is to assign the required business catalogs to the custom all-employee business role created in the previous task. These catalogs provide the applications that will later be shown in the launchpad space and page for all employees.

The catalogs that must be assigned are:

HCM - Employee Self-Service

SAP_HCM_BC_EMP_PC

Concur - Employee Self-Service

SAP_CON_BC_CTE_ESS_PC

Business Scenario Explanation

In the previous task, you created a new custom all-employee business role, for example:

Z_EMPLOYEES_ALL_#####

That role exists, but on its own it does not yet provide app access.

In SAP S/4HANA Cloud, app access is granted through business catalogs.

This means the role must now be connected to the catalogs that contain the apps employees need.

Later, these catalogs will feed the launchpad page content so end users can easily find the relevant applications.

Important Notes

Always replace ##### with the last 6 digits of your group number.

Use the exact catalog names and IDs.

Assign both required catalogs.

Save the role after assignment.

Do not assign the wrong catalog variant.

Required Catalogs

Assign exactly these two business catalogs:

Business Catalog

Business Catalog ID

HCM - Employee Self-Service

SAP_HCM_BC_EMP_PC

Concur - Employee Self-Service

SAP_CON_BC_CTE_ESS_PC

Detailed Step-by-Step Procedure

Step 1: Open the app "Maintain Business Roles"

From the SAP S/4HANA Cloud launchpad:

Log in to SAP S/4HANA Cloud.

Use the app search.

Search for:

Maintain Business Roles

Open the app.

Explanation:

This app is used to maintain business roles, assign catalogs, assign launchpad spaces, and maintain restrictions.

Step 2: Search for your custom all-employee business role

Inside Maintain Business Roles:

Search for your business role ID:
Z_EMPLOYEES_ALL_#####

Example

If your suffix is 000013, search for:
Z_EMPLOYEES_ALL_000013

Open the role.

Explanation:

You must open the custom all-employee role created in the previous task, not a template role and not a standard SAP role.

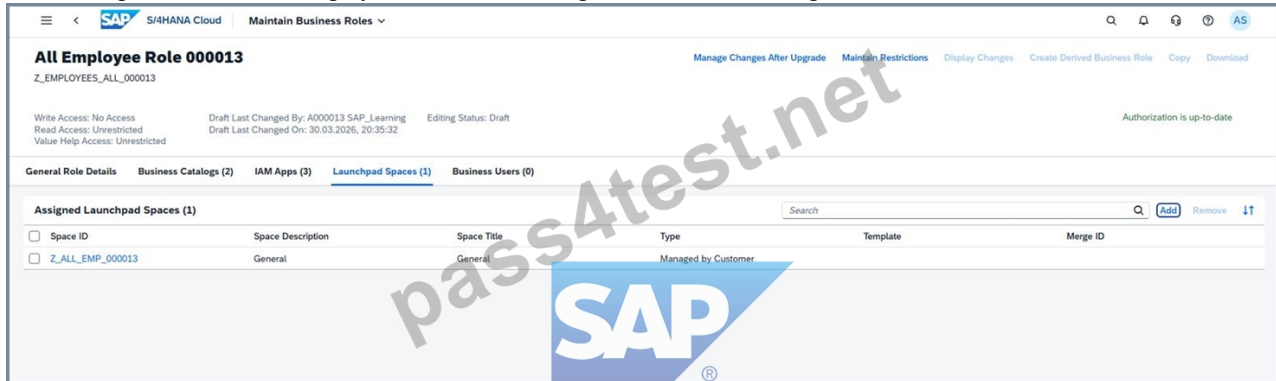

Step 3: Verify the correct role is open

Confirm that the role details show:

Business Role ID = Z_EMPLOYEES_ALL_#####

Business Role Description = All Employee Role #####

Explanation:

This ensures you are assigning catalogs to the correct business role.

Step 4: Go to the "Business Catalogs" tab

Inside the role:

Click the tab:

Business Catalogs

Explanation:

This tab is used to assign the business catalogs that define which apps and app authorizations the role provides.

Step 5: Click Add

In the Assigned Business Catalogs section:

Click Add

This opens the dialog:

Add Business Catalogs

Explanation:

The Add popup is used to search for and assign SAP-delivered business catalogs to the custom role.

Step 6: Search for the first catalog

In the Add Business Catalogs popup:

Search for:

SAP_HCM_BC_EMP_PC

or

HCM - Employee Self Service

Select:

HCM - Employee Self Service

Business Catalog ID: SAP_HCM_BC_EMP_PC

Explanation:

This catalog provides employee self-service apps and is required by the task.

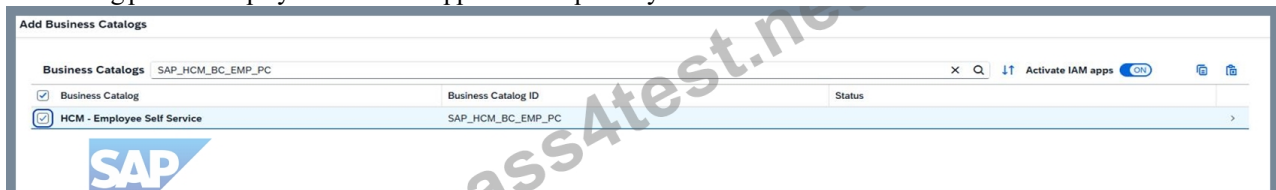

Step 7: Search for the second catalog

Still in the Add Business Catalogs popup:

Search for:

SAP_CON_BC_CTE_ESS_PC

or

Concur - Employee Self-Service

Select:

Concur - Employee Self-Service

Business Catalog ID: SAP_CON_BC_CTE_ESS_PC

Explanation:

This catalog provides the Concur employee self-service content and is also explicitly required by the task.

Step 8: Add the selected catalogs

After selecting both catalogs:

Click OK or Apply

Explanation:

This adds the selected catalogs to the custom role in draft mode.

Step 9: Verify both catalogs are listed

Back in the Business Role screen, verify that both assigned catalogs are visible:

SAP_HCM_BC_EMP_PC

SAP_CON_BC_CTE_ESS_PC

Explanation:

This confirms that the required app authorizations have now been attached to the role.

Step 10: Save the role

Click:

Save

Explanation:

This finalizes the catalog assignment.

Without saving, the catalogs remain only in draft and the role will not provide the required app content.

Step 11: Verify the result after save

After saving, check again that the role still shows both business catalogs in the assigned list.

Explanation:

This confirms the task was completed successfully and the role is ready for the next step, which is launchpad space/page content.

Expected Result

After this task is completed successfully:

the custom all-employee role has both required business catalogs assigned, the role is saved successfully, the role now provides the app authorizations required for employee self-service content, the launchpad page can later use these catalogs to add the required tiles.

질문 # 12

SIMULATION

Create a Custom Business Role with Restrictions

Business Scenario:

You are building a custom business role with restrictions to ensure the end users assigned the role have only the minimum level of access necessary to complete their core job tasks. The end users are project managers based in the United States. They should only be able to create projects, edit projects, and access projects that are occurring in the United States. They should not be able to staff any resources outside of the United States. Write, Read, and Value Help access should be restricted to only the United States for all relevant fields.

Prerequisites:

Note: In the task below, always replace ##### with the last 6 digits of your group number.

Note: Make sure to use the EXACT names/values/spaces as they are listed in the task. Even forgetting a space or a number will cause the validation of the task to fail and be marked as incorrect.

Task:

Use the template for the business role Project Manager - Professional Services (SAP_BR_PROJECT_MANAGER_PROF) to create a new business role with the following information:

Parameter	Value
New Business Role ID	BR_PROJECT_MANAGER_PROF_US_#####
New Business Role Description	Project Manager - Professional Services - US - #####
Option for Launchpad Spaces	Create and Assign Spaces Based on Space Templates
New Space ID	ZBR_PROJECT_MANAGER_PROF_US_#####
Activate IAM Apps	Yes (check the box)

정답 :

설명 :

See Explanation below for all solution

Explanation:

Objective

The purpose of this task is to create a custom business role for project managers in the United States by using the standard SAP template role Project Manager - Professional Services and then restricting the role so users only have the minimum access needed for their job.

The template role used is:

Template Business Role ID: SAP_BR_PROJECT_MANAGER_PROF

Template Business Role Description: Project Manager - Professional Services The new custom role must be created with exact values defined in the task.

Business Scenario Explanation

In this simulation, you are building a restricted custom role for project managers who work only in the United States.

The goal is to ensure that these end users:

can create and edit projects,

can access only projects occurring in the United States,

cannot work with projects or staffing outside the US,

have only the minimum level of authorization needed.

This is done in two major parts:

Create a new custom business role from the standard SAP template

Restrict the role values so only US-related data is allowed

Important Notes

Always replace ##### with the last 6 digits of your group number.

Every value must be entered exactly as shown.

Even one missing space or incorrect character can cause the simulation validation to fail.

You must also create and assign a launchpad space as part of the custom role creation.

Required Values for Role Creation

Use the following values exactly as shown in the task image.

Parameter

Value

New Business Role ID

BR_PROJECT_MANAGER_PROF_US_#####

New Business Role Description

Project Manager - Professional Services - US - #####

Option for Launchpad Spaces

Create and Assign Spaces Based on Space Templates

New Space ID

ZBR_PROJECT_MANAGER_PROF_US_#####

Activate IAM Apps

Yes (check the box)

Example

If your suffix is 000457, the values become:

BR_PROJECT_MANAGER_PROF_US_000457

Project Manager - Professional Services - US - 000457

ZBR_PROJECT_MANAGER_PROF_US_000457

Detailed Step-by-Step Procedure

Part 1: Open the standard template role

Step 1: Open the app "Maintain Business Roles"

From the SAP S/4HANA Cloud launchpad:

Log in to SAP S/4HANA Cloud.

Use the app search.

Search for:

Maintain Business Roles

Open the app.

Explanation:

This app is used to maintain standard and custom business roles.

Because this task requires creating a custom role from an existing template, this is the correct starting app.

Business Role ID	Business Role Description	Leading Business Role	User Assignment Count	Business Catalog Assignment Count	Price Category	Business Catalog Deprecation Count	Fiori Launchpad Space Assignment Count	Business R
BR_AA_ACCOUNTANT	Asset Accountant		329	15	Advanced	0	1	
BR_ADMIN_APR_FICA	Administrator - Accounts Payable and Receivable (FI-CA)		36	78	Advanced	0	1	
BR_ADMIN_TEST_AUTOMATION	Administrator - Test Automation		28	1	Advanced	0	1	
BR_ADMINISTRATOR	Administrator		521	81	Advanced	0	5	
BR_ADMINISTRATOR_GRP	Administrator - Group Reporting		32	8	Advanced	0	1	
BR_ADMINISTRATOR_HRINFO	Administrator - HR Info		346	7	Advanced	0	2	
BR_ANALYTICS_SPECIALIST	Analytics Specialist		25	14	Advanced	0	2	
BR_AP_ACCOUNTANT	Accounts Payable Accountant		1362	70	Advanced	0	1	
BR_AP_MANAGER	Accounts Payable Manager		82	15	Advanced	0	1	
BR_APR_ACCOUNTANT_FICA	Accounts Payable and Receivable Accountant (FI-CA)		80	168	Advanced	0	1	
BR_APR_MANAGER_FICA	Accounts Payable and Receivable Manager (FI-CA)		42	23	Advanced	0	1	
BR_AR_ACCOUNTANT	Accounts Receivable Accountant		334	2	Advanced	0	1	
BR_AR_MANAGER	Accounts Receivable Manager		42	14	Advanced	0	1	
BR_BILLING_CLERK	Billing Clerk		874	67	Core	0	1	
BR_BOM_ENG_CUST_ORDER	BOM Engineer - Customer Order		18	1	Core	0	1	
BR_BOM_ENGINEER	BOM Engineer		23	18	Core	0	1	

Step 2: Search for the template role

Inside Maintain Business Roles:

In the search/filter area, search for:

SAP_BR_PROJECT_MANAGER_PROF

or

Project Manager - Professional Services

Open the standard SAP template role.

Explanation:

You must start from the standard template role because the task explicitly says to use the template for:

Project Manager - Professional Services

SAP_BR_PROJECT_MANAGER_PROF

Create Business Role from Template

Business role templates delivered by SAP are intentionally broad and meant for testing. Before productive use, business roles based on business role templates must be customized and restricted to actual company roles to comply with the principle of least privilege.

Template: *

SAP_BR_PROJECT_MANAGER_PROF



New Business Role ID: *

BR_PROJECT_MANAGER_PROF_US_000457

New Business Role Description:

Project Manager - Professional Services - US - 000457

Option for Launchpad Spaces:

Use Space Templates as Predefined Spaces

Activate IAM Apps

Part 2: Create the custom role from the template

Step 3: Click "Create Derived Business Role"

On the template role page:

Click:

Create Derived Business Role

Explanation:

This function creates a customer-specific copy based on the standard SAP business role template.

It preserves the delivered role content but allows you to define your own role ID, description, restrictions, and launchpad space.

Step 4: Enter the custom role information

In the creation popup, enter the values exactly as follows:

Template = SAP_BR_PROJECT_MANAGER_PROF

New Business Role ID = BR_PROJECT_MANAGER_PROF_US_#####

New Business Role Description = Project Manager - Professional Services - US - ##### Option for Launchpad Spaces = Create and Assign Spaces Based on Space Templates New Space ID = ZBR_PROJECT_MANAGER_PROF_US_##### Activate

IAM Apps = checked Explanation:

These values define the new custom project manager role that will later be restricted to US-only access.

The space option is important because the task expects the role to include its own launchpad space.

Create Business Role from Template

Business role templates delivered by SAP are intentionally broad and meant for testing. Before productive use, business roles based on business role templates must be customized and restricted to actual company roles to comply with the principle of least privilege.

Template: *

SAP_BR_PROJECT_MANAGER_PROF



New Business Role ID: *

BR_PROJECT_MANAGER_PROF_US_000457

New Business Role Description:

Project Manager - Professional Services - US - 000457

Option for Launchpad Spaces:

Create and Assign Spaces Based on Space Templates

New Space ID: *

ZBR_PROJECT_MANAGER_PROF_US_000457

Activate IAM Apps

OK

Cancel

Step 5: Confirm creation

Click OK

Explanation:

SAP now creates the custom role derived from the template and assigns the new launchpad space at the same time.

Part 3: Verify the newly created custom role

Step 6: Review the new custom role

After creation, SAP opens the new custom role.

Verify:

Business Role ID = BR_PROJECT_MANAGER_PROF_US #####

Business Role Description = Project Manager - Professional Services - US - ##### Business Role Template ID =

SAP_BR_PROJECT_MANAGER_PROF Explanation:

This confirms the derived role was created correctly from the right SAP template.

Part 4: Maintain role restrictions

Step 7: Open "Maintain Restrictions"

On the custom role page:

Click:

Maintain Restrictions

Explanation:

This is the most important part of the task.

You are not only creating a role - you are also limiting the role so it only allows US-related values.

Step 8: Understand the rule for restriction maintenance

The PDF/task logic is:

Fields explicitly listed in the restriction table → keep them Restricted and enter the required values All other fields not listed in the task table → set them to Not Maintained Explanation:

This is essential.

If extra fields remain restricted or blank, the role may not validate correctly.

The safest approach is:

only maintain the required fields,

mark all unrelated fields as Not Maintained.

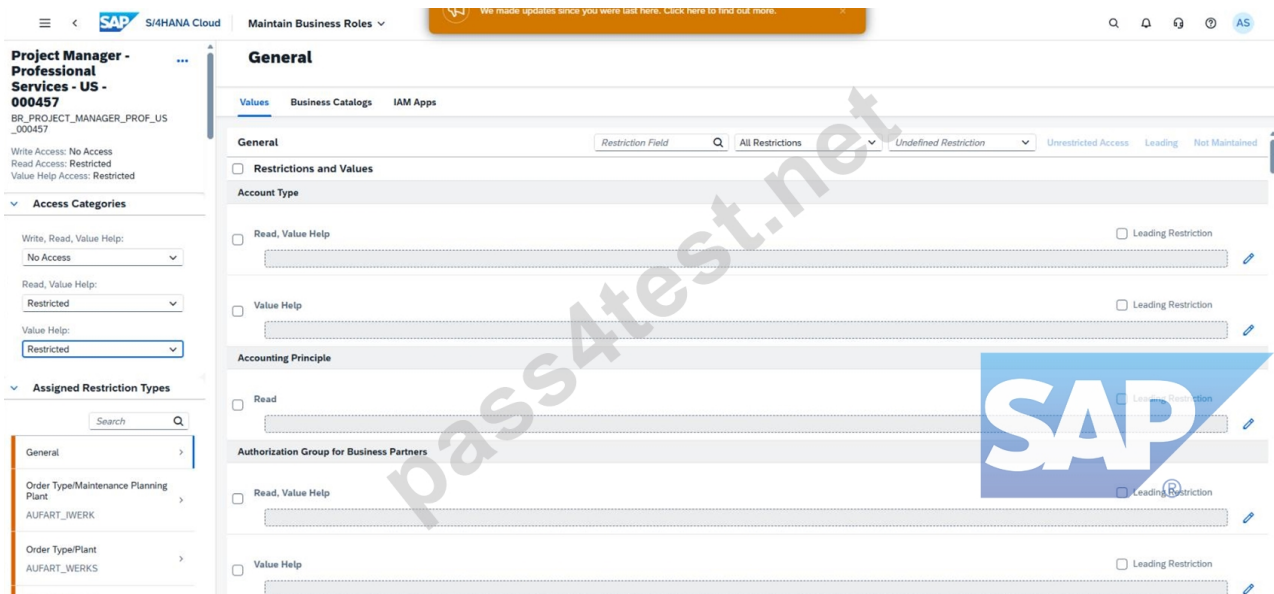

Part 5: Enter the required US restrictions

From your exercise run, the maintained values included restrictions such as:

Keep these kinds of fields restricted with US/1710 values where required Examples from your run:

Bank Country/Region Key

Read, Value Help = US

Value Help = US

Company Code

use 1710 only where the task table explicitly requires it

Purchasing Organization

use 1710 where required

Valuation Area

use 1710 where required

Explanation:

These are the exact business restrictions that make the role usable only for the intended geography and business scope.

Step 9: Set unrelated restriction fields to "Not Maintained"

For every field not included in the task's restriction list, choose:

Not Maintained

Examples from your screenshots included fields like:

Accounting Principle

Authorization Group for Business Partners

Billing Type

These should be Not Maintained unless they are explicitly listed in the task's required restriction table.

Explanation:

This removes unnecessary access and matches the task wording that all other fields should be set to Not Maintained.

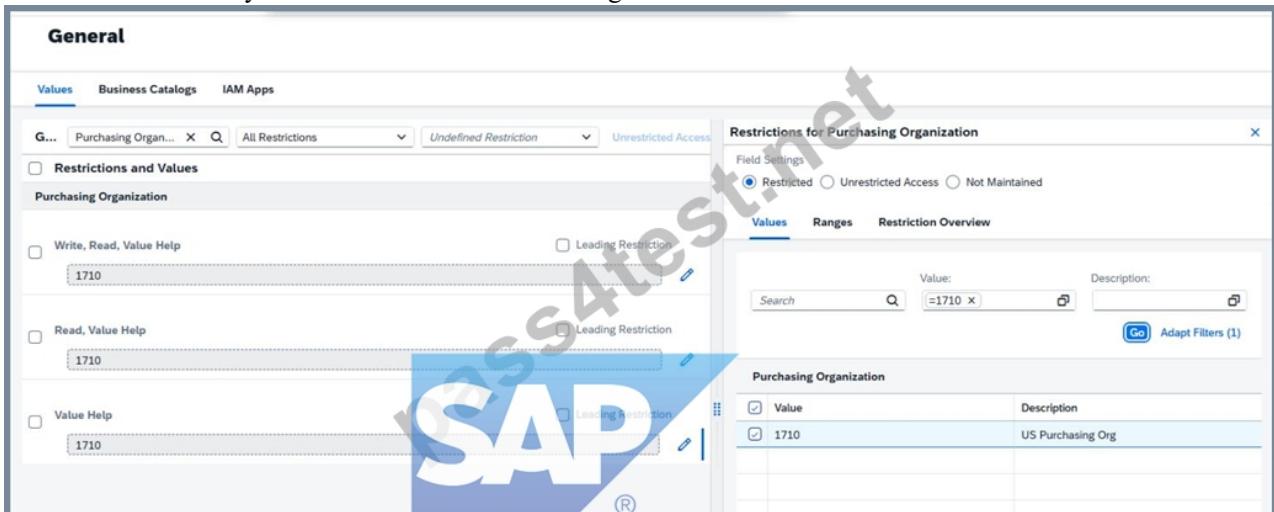

Step 10: Save the restrictions

After all required values are entered and unrelated fields are marked Not Maintained:

Click Save

Explanation:

This saves the restriction profile of the role.

If you do not save here, the role will remain incomplete or in draft.

Part 6: Verify launchpad space and page creation

Step 11: Go to Launchpad Spaces

In the custom role:

Open the tab:

Launchpad Spaces

Verify that the assigned space exists:

ZBR_PROJECT_MANAGER_PROF_US_#####

Explanation:

Because you selected Create and Assign Spaces Based on Space Templates, SAP should have created and assigned the launchpad space automatically.

Step 12: Verify the created space

Open the assigned space and confirm:

the custom space exists,

it is customer-managed,

the pages are assigned correctly.

Explanation:

This proves that the new business role has its own launchpad structure as required by the task.

Expected Result

After this task is completed successfully:

a new custom role exists based on SAP_BR_PROJECT_MANAGER_PROF,

the role uses the exact required ID and description,

the role has a custom launchpad space,

IAM apps are activated,

restrictions are maintained for US-only access,

all irrelevant fields are set to Not Maintained,

the role is saved successfully.

질문 # 13

SIMULATION

Set up an Integration Scenario

Business Scenario

You are responsible for setting up the Bank Integration with File Interface (1EG). During an actual implementation, you would first download the Set-up Instructions for the business process from SAP Signavio Process Navigator. In this practical exam, all the information will be provided to you, so you do not need to download the Set-up Instructions.

Prerequisites

Note:

In the task below, always replace ##### with the last 6 digits of your group number.

Note:

Make sure to use the EXACT names/values/spaces as they are listed in the task. Even forgetting a space or a number will cause the validation of the task to fail and be marked as incorrect.

Your Task

Create a Communication User with the information listed below and save.

Parameter	Value
User Name	1EG_COMM_USER_#####
Description	1EG Communication User
Password	Have the system propose a password

정답:

설명:

See Explanation below for all solution

Explanation:

Objective

The purpose of this task is to create a new Communication User for the integration scenario Bank Integration with File Interface

(1EG).

This communication user will later be used in the integration setup, especially when defining the communication system and communication arrangement.

Business Scenario Explanation

In this scenario, you are setting up the integration for:

Bank Integration with File Interface (1EG)

In SAP S/4HANA Cloud, technical communication between systems is usually handled through:

a Communication User

a Communication System

a Communication Arrangement

This task is the first step in that chain.

The communication user acts as the technical user that the system uses for integration-related authentication.

Important Notes

Always replace ##### with the last 6 digits of your group number.

Use the exact values shown in the task.

Do not change spaces, underscores, or capitalization.

The password should not be typed manually if the task says:

Have the system propose a password

Required Values

Use the following values exactly as shown in the task image.

Parameter	Value
User Name	1EG_COMM_USER_#####
Description	1EG Communication User
Password	Have the system propose a password

Example

If your suffix is 000013, then the values become:

User Name = 1EG_COMM_USER_000013

Description = 1EG Communication User

Step 1: Open the app "Communication Users"

From the SAP S/4HANA Cloud launchpad:

Log in to SAP S/4HANA Cloud.

Use the search bar or app finder.

Search for:

Communication Users

or

Maintain Communication Users

Open the app.

Explanation:

This app is used to create and maintain technical communication users for integration scenarios.

This is the correct starting point because the task explicitly says to create a Communication User.

Step 2: Start creating a new communication user

Inside the Communication Users app:

Click:

New

Explanation:

This starts the creation of a new communication user record.

Step 3: Enter the User Name

In the new communication user screen, enter:

User Name = 1EG_COMM_USER_#####

Example

If your suffix is 000013, enter:

1EG_COMM_USER_000013

Explanation:

This is the technical identifier for the communication user.

It must match the task exactly.

Step 4: Enter the Description

In the Description field, enter exactly:

1EG Communication User

Explanation:

This is the functional description of the technical integration user.
It should be entered exactly as written in the task to avoid validation issues.

Step 5: Let the system propose the password

In the password section:

Do not manually type a password.

Click:

Propose Password

Explanation:

The task explicitly says:

Password = Have the system propose a password

So the correct action is to use the SAP-generated password instead of entering your own value manually.

Step 6: Review the generated password

After clicking Propose Password:

The system generates a password automatically.

If the system displays the password, note it down if needed for later integration steps.

Explanation:

In some cases, the proposed password may later be needed during communication setup or documentation.

Even if not needed later in the simulation, this confirms the correct procedure was followed.

Step 7: Save the Communication User

Click:

Save

Explanation:

This finalizes the creation of the communication user.

Without saving, the technical user will not exist and the later integration steps will fail.

Step 8: Verify the Communication User

After saving, confirm that the communication user exists in the list and displays the correct values:

User Name = 1EG_COMM_USER_#####

Description = 1EG Communication User

Explanation:

This confirms the task is complete and the user is ready to be used in the next integration setup tasks.

Expected Result

After this task is completed successfully:

the communication user exists,

the user name matches the required naming convention,

the description is correct,

the password was proposed by the system,

the user is saved successfully.

Locked	User Name	User ID	Description	Last Logon	Password Status	Certificates
<input type="checkbox"/>	CUSTOMER_SAP_COM_0193	CC0000000001	Communication User is used for IPS Integration - Created by SAP Setup Automation	10.09.2025, 02:00:00	Productive	0 >
<input type="checkbox"/>	DONOTUSE	CC0000000003	Do Not Use	30.03.2026, 20:48:40	Productive	0 >
<input type="checkbox"/>	RESERVEDDONTTOUCH1	CC0000000004	Reserved for Admin		Productive	0 >
<input type="checkbox"/>	RESERVEDDONTTOUCH2	CC0000000005	Reserved for Admin		Productive	0 >
<input type="checkbox"/>	RESERVEDDONTTOUCH3	CC0000000006	Reserved for Admin		Productive	0 >
<input type="checkbox"/>	1EG_COMM_USER_000003	CC0000000007	1EG Communication User		Productive	0 >
<input type="checkbox"/>	1EG_COMM_USER_000009	CC0000000008	1EG Communication User		Productive	0 >
<input type="checkbox"/>	1EG_COMM_USER_000013	CC0000000009	1EG_COMM_USER_000013		Productive	0 >

질문 # 14

SIMULATION

Create a Custom Launchpad Space and Page

Business Scenario

You are building a custom business role that will be assigned to all employees in the organization. The business role and its corresponding Launchpad Space and Page need to include the apps that have been granted through the business catalogs assigned to the business role to ensure employees have an easy time finding the relevant applications.

Note: In the task below, always replace ##### with the last 6 digits of your group number.

Note:

Make sure to use the EXACT names/values/spaces as they are listed in the task.

Even forgetting a space or a number will cause the validation of the task to fail and be marked as incorrect.

Task

Create a new business role (not from a template) with the information below.

Parameter	Value
Business Role ID	Z_EMPLOYEES_ALL_#####
Business Role Description	All Employee Role #####
Access Categories	Unrestricted for all categories

정답:

설명:

See Explanation below for all solution

Explanation:

Task 8: Create a New Business Role (Not from a Template)

Objective

The purpose of this task is to create a new custom business role for all employees in the organization. This role is intended to become the base role that will later be connected to the required business catalogs, launchpad space, and page so that employees can easily access the relevant apps.

This task explicitly says:

create a new business role

not from a template

use the exact values provided in the task

Business Scenario Explanation

You are building a role for all employees in the organization.

Unlike the earlier project-manager role, this one is not derived from a standard SAP template.

The purpose of this role is to provide a shared employee-level launchpad structure.

Later, the role will be used to:

assign business catalogs,

create a launchpad space,

create a launchpad page,

place apps on the page for employee self-service access.

In this step, the focus is only on creating the new business role with the correct identification and access category settings.

Important Notes

Always replace ##### with the last 6 digits of your group number.

Use the values exactly as shown.

Do not create this role from a template.

The access categories must be set exactly as required:

Unrestricted for all categories

Save the role at the end.

Required Values

Use the following values exactly as shown in the task screenshot

Parameter	Value
Business Role ID	Z_EMPLOYEES_ALL_#####
Business Role Description	All Employee Role #####
Access Categories	Unrestricted for all categories

Step 1: Open the app "Maintain Business Roles"

From the SAP S/4HANA Cloud launchpad:

Log in to SAP S/4HANA Cloud.

Use the app search.

Search for:

Maintain Business Roles

Open the app.

Explanation:

This app is used to create, maintain, copy, derive, and restrict business roles.

Since this task requires creating a brand new custom role, this is the correct place to start.

Step 2: Start creating a new business role

Inside Maintain Business Roles:

Click New

Explanation:

This task explicitly says to create a role not from a template.

So you must use New, not:

Create From Template

Create Derived Business Role

Copy

Using New creates a completely customer-defined business role.

Step 3: Enter the business role ID

In the new business role creation screen:

In Business Role ID, enter:

Z_EMPLOYEES_ALL_#####

Example

For suffix 000013:

Z_EMPLOYEES_ALL_000013

Explanation:

This is the technical identifier of the new business role.

It must match the task exactly for validation to succeed.

Step 4: Enter the business role description

In Business Role Description, enter:

All Employee Role #####

Example

For suffix 000013:

All Employee Role 000013

Explanation:

This is the readable description shown in SAP and should exactly match the exercise requirement.

Step 5: Set access categories

In the Access Categories section, set all categories to:

Write, Read, Value Help = Unrestricted

Read, Value Help = Unrestricted

Value Help = Unrestricted

Explanation:

The task explicitly says:

Access Categories: Unrestricted for all categories

So all three category dropdowns must be left or set to Unrestricted.

This means:

the role is not restricted by country, company code, or other field-level limitation in this step, this role is intended to be broadly reusable for all employees.

Step 6: Review the role before saving

Before saving, verify:

Business Role ID is correct

Business Role Description is correct

all 3 access category values are Unrestricted

Explanation:

This avoids common mistakes such as:

wrong suffix,

extra spaces,

restricted instead of unrestricted values,

creating from template accidentally.

Step 7: Save the role

Click:

Save

Explanation:

This finalizes the new business role.

Without saving, the role remains only in draft and is not actually created.

Step 8: Verify the role after save

After saving, confirm that the role is displayed with:

Business Role ID = Z_EMPLOYEES_ALL_#####
 Business Role Description = All Employee Role #####
 Write Access / Read Access / Value Help Access = Unrestricted

Explanation:

This is the confirmation that the role was created successfully and matches the task requirement.

Expected Result

After the task is completed successfully:

a new custom business role exists,
 it was created not from a template,
 the role ID and description match the required values,
 all access categories are Unrestricted,
 the role is saved and available for the next steps.

질문 # 15

SIMULATION

Business Scenario You are working on an implementation project and need to create a test user in the system for demonstrating the professional services business processes to project managers during your upcoming Fit-to-Standard workshop. Follow the instructions below to create a new test user with a basic import of worker and work agreement data.

Note: In the task below, always replace ##### with the last 6 digits of your group number.

Note:

Make sure to use the EXACT names/values/spaces as they are listed in the task.

Even forgetting a space or a number will cause the validation of the task to fail and be marked as incorrect.

Task:

Create a new business user with the following information by importing the new user's data:

Field	Value
Worker ID	1#####
User Name	PM#####
Worker Type	BUPO03
First Name	Project
Last Name	Manager #####
Email	PM#####@dummy.sap.com
Language	EN
Company Code	1010
Cost Center	10101501

Field	Value
Start Date	Today's Date (YYYYMMDD)
End Date	December 31, 9999 (YYYYMMDD)

Import Name: Project Manager Test User #####

정답:

설명:

See Explanation below for all solution

Explanation:

Objective

The purpose of this task is to create a test user in SAP S/4HANA Cloud for demonstrating professional services business processes to project managers during a Fit-to-Standard workshop.

This task is completed by importing:

worker data

work agreement data

The import must use the exact values provided in the task.

Business Scenario Explanation

In this scenario, you need a test user that represents a Project Manager.

This user is needed so that project-management-related professional services processes can later be demonstrated in the system.

Instead of creating every record manually, SAP asks you to use the import process.

This is faster and also ensures the worker and agreement data are loaded in the correct structure.

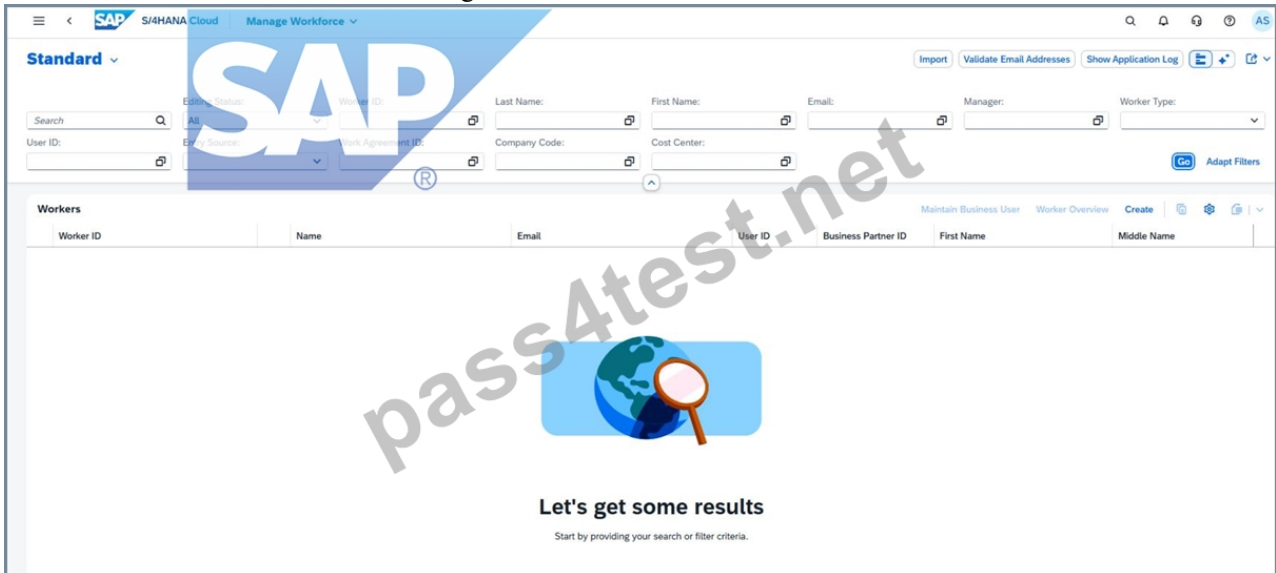

Important Notes

Always replace ##### with the last 6 digits of your group number.

Use the values exactly as provided.

Do not change spaces, punctuation, or capitalization unless the task explicitly tells you to.

A wrong value, extra space, or missing number can cause task validation failure.

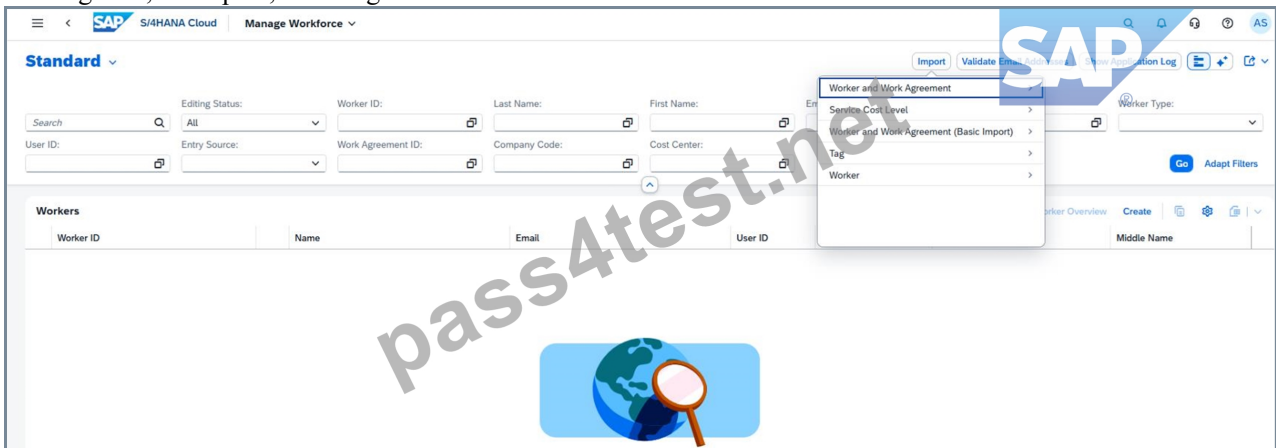

If your suffix is 000013, then the values become:

Worker ID = 1000013

User Name = PM000013

First Name = Project

Last Name = Manager 000013

Email = PM000013@dumny.sap.com

Step 1: Open the app used for importing users/workers

From the SAP S/4HANA Cloud launchpad:

Log in to the system.

Open the relevant import app used in your simulation for importing worker and work agreement data.

Start creation of a new import.

Explanation:

This task is not done by manual user creation only.

The scenario specifically says to create the new business user by importing the new user's data.

The import will load the basic worker and work agreement records that are required before the business user is fully usable.

Step 2: Enter the import name

When creating the import:

In the field Import Name, enter:

Project Manager Test User #####

Replace ##### with your own 6-digit group suffix.

Example

For suffix 000013, enter:

Project Manager Test User 000013

Explanation:

The import name identifies your import package and should be entered exactly as required by the task.

Step 3: Prepare the worker data

In the worker import structure, enter these values:

Worker ID = 1#####

User Name = PM#####

Worker Type = BUP003

First Name = Project

Last Name = Manager #####

Email = PM#####@dummy.sap.com

Language = EN

Company Code = 1010

Cost Center = 10101501

Example for 000013

Worker ID = 1000013

User Name = PM000013

Last Name = Manager 000013

Email = PM000013@dummy.sap.com

Explanation:

These values define the person as a project manager test worker and connect the worker to:

the company code,

the cost center,

the default language,

and the worker type required by the scenario.

Step 4: Prepare the work agreement data

In the work agreement import structure, enter:

Start Date = today's date in YYYYMMDD format

End Date = 99991231

Example

If today's date is March 30, 2026:

Start Date = 20260330

End Date = 99991231

Explanation:

The end date 99991231 is used to indicate an open-ended validity.

This is common in SAP for a record that should remain valid indefinitely.

Step 5: Upload or enter the import data

Depending on the app behavior in your exercise:

Upload the prepared import file or

Enter the values into the import structure manually if the system provides inline entry.

Explanation:

The business scenario says the business user must be created by importing worker and work agreement data.

This means the relevant master data must be loaded into the system first before the user is fully available.

Step 6: Start the import

After all values are entered:

Validate the data if the system provides a validation option.

Start the import.

Explanation:

Validation checks whether:

required fields are filled,

date formats are correct,

codes like BUP003, 1010, and 10101501 are valid,

and the import structure is complete.

Step 7: Wait for the import to complete

Monitor the import process.

Wait until the import shows success or completed status.

Explanation:

Only after the import is complete will the worker and work agreement records exist in the system and be usable for further user setup and role assignment.

Step 8: Verify the imported worker/business user

After the import finishes:

Open the relevant business user / worker maintenance app.

Search using:

Worker ID

or User Name

Confirm that the imported user exists.

Explanation:

This step ensures the imported data was actually created and is available for later process demonstrations.

Expected Result

After the import is completed successfully:

a new test worker/user exists in the system,

the worker has the required professional-services identity,

the work agreement is valid,

the user can be used in later project manager demonstrations.

Import Worker and Work Agreement Data (Basic Import)

Delimiter

Comma (,) Semicolon (;)

Worker and Work Agreement Data *

Import Name *

✔ See more details in the [Application Log](#) ✕

질문 # 16

.....

최근 더욱 많은 분들이 SAP 인증 C-S4CPB-2602 시험에 도전해보려고 합니다. Pass4Test에서는 여러분의 시간과 돈을 절약해드리기 위하여 저렴한 가격에 최고의 품질을 지닌 퍼펙트한 SAP 인증 C-S4CPB-2602 시험덤프를 제공해드

러 고객님의 시험준비에 편안함을 선물해드립니다. Pass4Test제품을 한번 믿어보세요.

C-S4CPB-2602높은 통과율 덤프공부문제 : <https://www.pass4test.net/C-S4CPB-2602.html>

C-S4CPB-2602시험을 패스하여 자격증을 취득하려는 분은 저희 사이트에서 출시한 SAP Certified - Implementation Consultant - SAP S/4HANA Cloud Public Edition (C_S4CPB_2602)덤프의 문제와 답만 잘 기억하시면 한방에 SAP Certified - Implementation Consultant - SAP S/4HANA Cloud Public Edition (C_S4CPB_2602) 시험패스 할수 있습니다, Pass4Test의SAP인증 C-S4CPB-2602덤프는 100% 패스보장 가능한 덤프자료입니다.한번만 믿어주시고Pass4Test제품으로 가면 시험패스는 식은 죽 먹기처럼 간단합니다, Pass4Test는 여러분께SAP C-S4CPB-2602시험패스의 편리를 드릴 수 있다고 굳게 믿고 있습니다, Pass4Test의 SAP인증 C-S4CPB-2602덤프를 선택하시면 고객님의게서 원하시는 시험접수를 받아 자격증을 쉽게 취득할수 있습니다, Pass4Test에서 제공해드리는SAP 인증 C-S4CPB-2602시험 대비 덤프는 덤프제공사이트에서 가장 최신버전이어서 시험패스는 한방에 갑니다.

그 흔들림 없는 눈빛에 계획는 저도 모르게 긴장감이 밀려들었다, 분명 너 상처받을 거야, C-S4CPB-2602시험을 패스하여 자격증을 취득하려는 분은 저희 사이트에서 출시한 SAP Certified - Implementation Consultant - SAP S/4HANA Cloud Public Edition (C_S4CPB_2602)덤프의 문제와 답만 잘 기억하시면 한방에 SAP Certified - Implementation Consultant - SAP S/4HANA Cloud Public Edition (C_S4CPB_2602) 시험패스 할수 있습니다.

시험패스 가능한 C-S4CPB-2602시험대비 공부자료 최신버전 덤프샘플문제 다운 받기

Pass4Test의SAP인증 C-S4CPB-2602덤프는 100% 패스보장 가능한 덤프자료입니다.한번만 믿어주시고Pass4Test제품으로 가면 시험패스는 식은 죽 먹기처럼 간단합니다, Pass4Test는 여러분께SAP C-S4CPB-2602시험패스의 편리를 드릴 수 있다고 굳게 믿고 있습니다.

Pass4Test의 SAP인증 C-S4CPB-2602덤프를 선택하시면 고객님의게서 원하시는 시험접수를 받아 자격증을 쉽게 취득할수 있습니다, Pass4Test에서 제공해드리는SAP 인증 C-S4CPB-2602시험대비 덤프는 덤프제공사이트에서 가장 최신버전이어서 시험패스는 한방에 갑니다.

- 높은 통과율 C-S4CPB-2602시험대비 공부자료 공부자료 □ “www.koreadumps.com”에서 《 C-S4CPB-2602 》를 검색하고 무료로 다운로드하세요C-S4CPB-2602최신 업데이트버전 덤프문제공부
- C-S4CPB-2602시험대비 공부자료 덤프공부자료 □ ☀ www.itdumpskr.com □☀□에서▶ C-S4CPB-2602 □를 검색하고 무료 다운로드 받기C-S4CPB-2602최신 덤프자료
- 높은 적응율을 자랑하는 C-S4CPB-2602시험대비 공부자료 덤프샘플문제 □ 《 www.koreadumps.com 》을 (를) 열고☀ C-S4CPB-2602 □☀□를 검색하여 시험 자료를 무료로 다운로드하십시오C-S4CPB-2602시험패스 가능 공부자료
- C-S4CPB-2602최신버전 시험덤프자료 * C-S4CPB-2602덤프최신버전 □ C-S4CPB-2602학습자료 □ ▶ www.itdumpskr.com ◀웹사이트를 열고 (C-S4CPB-2602) 를 검색하여 무료 다운로드C-S4CPB-2602인기자격증 덤프자료
- C-S4CPB-2602완벽한 덤프문제자료 □ C-S4CPB-2602학습자료 □ C-S4CPB-2602시험패스보장덤프 □ 검색만 하면▶ www.dumptop.com □□□에서□ C-S4CPB-2602 □무료 다운로드C-S4CPB-2602덤프최신버전
- C-S4CPB-2602학습자료 □ C-S4CPB-2602시험대비 덤프공부문제 □ C-S4CPB-2602시험패스 가능 공부자료 □ ✓ www.itdumpskr.com □✓□에서 검색만 하면▶ C-S4CPB-2602 ◀를 무료로 다운로드할 수 있습니다C-S4CPB-2602최신 덤프자료
- C-S4CPB-2602시험대비 덤프공부문제 □ C-S4CPB-2602최신 업데이트 시험덤프문제 □ C-S4CPB-2602완벽한 덤프문제자료 □ 검색만 하면✓ www.koreadumps.com □✓□에서“C-S4CPB-2602 ”무료 다운로드C-S4CPB-2602최신버전 덤프공부
- C-S4CPB-2602 시험공부, SAP Certified - Implementation Consultant - SAP S/4HANA Cloud Public Edition (C_S4CPB_2602) - C-S4CPB-2602 VCE버전자료 □ [www.itdumpskr.com]웹사이트에서{ C-S4CPB-2602 }를 열고 검색하여 무료 다운로드C-S4CPB-2602예상문제
- C-S4CPB-2602예상문제 □ C-S4CPB-2602최고품질 덤프샘플문제 다운 □ C-S4CPB-2602예상문제 □ 오픈 웹 사이트{ www.koreadumps.com }검색▶ C-S4CPB-2602 □무료 다운로드C-S4CPB-2602 100% 시험패스 덤프문제
- C-S4CPB-2602최신 업데이트 시험덤프문제 □ C-S4CPB-2602완벽한 덤프문제자료 □ C-S4CPB-2602최신 버전 인기 덤프자료 x ▶ www.itdumpskr.com □□□의 무료 다운로드▶ C-S4CPB-2602 ◀페이지가 지금 열립니다 C-S4CPB-2602시험패스 가능 덤프문제
- C-S4CPB-2602시험패스 가능 덤프문제 □ C-S4CPB-2602학습자료 □ C-S4CPB-2602학습자료 □ > C-S4CPB-2602 □를 무료로 다운로드하려면▶ www.pass4test.net □웹사이트를 입력하세요C-S4CPB-2602최신 업데이트 시험덤프문제
- tessllha009264.blogozz.com, tiannacpuu016347.blogthisbiz.com, elainesxhu208218.dreamyblogs.com, esocialmall.com, zaynabemmn931188.elbloglibre.com, pennycdrq165452.mdkblog.com, nellagww710771.blogsumer.com,

wildbookmarks.com, tomasbwx462813.bloggactivo.com, bookmark-media.com, Disposable vapes