

Reliable D-PVM-OE-01 Exam Guide - D-PVM-OE-01 Valid Test Vce



We are so sincere to provide a free trial version of our D-PVM-OE-01 exam questions for you, just want you to find the best product for your own. We hope that you are making a choice based on understanding our D-PVM-OE-01 study braindumps. And you will find that our D-PVM-OE-01 training materials are so popular for their special advantages. Not only the content is always the latest, but also the displays are design carefully to cater to all kinds of study conditions. We will respect your decision. And our D-PVM-OE-01 learning guide really wants to be your long-term partner.

Our Dell Technologies PowerMax Operate (D-PVM-OE-01) exam questions are being offered in three easy-to-use and compatible formats. These Dell Technologies PowerMax Operate (D-PVM-OE-01) exam dumps formats offer a user-friendly interface and are compatible with all devices, operating systems, and browsers. The Pass4guide Dell Technologies PowerMax Operate (D-PVM-OE-01) PDF questions file contains real and valid EMC D-PVM-OE-01 exam questions that assist you in D-PVM-OE-01 exam dumps preparation and boost the candidate's confidence to pass the challenging Dell Technologies PowerMax Operate (D-PVM-OE-01) exam easily.

>> **Reliable D-PVM-OE-01 Exam Guide** <<

100% Pass Perfect EMC - Reliable D-PVM-OE-01 Exam Guide

Users who use our D-PVM-OE-01 real questions already have an advantage over those who don't prepare for the exam. Our study materials can let users the most closed to the actual test environment simulation training, let the user valuable practice effectively on D-PVM-OE-01 practice guide, thus through the day-to-day practice, for users to develop the confidence to pass the exam. For examination, the power is part of pass the exam but also need the candidate has a strong heart to bear ability, so our D-PVM-OE-01 learning dumps through continuous simulation testing, let users less fear when the real test, better play out their usual test levels,

can even let them photographed, the final pass exam

EMC Dell Technologies PowerMax Operate Sample Questions (Q20-Q25):

NEW QUESTION # 20

What does the symsan command do when scanning the SAN environment for devices to use in an O-MDM session?

- A. Verifies the SAN configuration and creates an ORS session on the remote host
- B. Temporarily stops the remote application and creates an ORS session
- C. Temporarily stops the remote application to verify the SAN configuration
- **D. Verifies the SAN configuration without disruption to the remote host**

Answer: D

Explanation:

Step by Step Comprehensive Detailed Explanation:

The symsan command in Solutions Enabler is used for various SAN (Storage Area Network) management tasks. One of its functions is to scan the SAN environment to discover and verify the configuration of devices and paths.

When used in the context of an Open Replicator Migrator for Dell EMC (O-MDM) session, the symsan command specifically:

* Verifies SAN Configuration:It checks the connectivity and configuration of the SAN fabric to ensure that the source and target devices are accessible and properly configured for the migration.

* Non-Disruptive:It performs this verification without disrupting any applications or host I/O operations on the remote host. This is crucial for maintaining business continuity during the migration planning phase.

Why other options are incorrect:

* A. Temporarily stops the remote application to verify the SAN configuration:symstan does not stop applications; it performs a non-disruptive scan.

* B. Verifies the SAN configuration and creates an ORS session on the remote host:symstan only verifies the SAN; it doesn't create ORS (Open Replicator Solutions) sessions.

* D. Temporarily stops the remote application and creates an ORS session:Again, symstan doesn't stop applications or create ORS sessions.

References and documents of Dell's public documentation for PowerMax Operate v.2:

* Dell Solutions Enabler 10.0.0 CLI User Guide:This guide provides detailed information about the symstan command and its various options, including its use for SAN discovery and verification. You can find this document on the Dell Support website by searching for "Solutions Enabler CLI User Guide."

* Dell PowerMax Family: Essentials and Best Practices Guide:This guide may offer general information about SAN management and migration tools, providing context for understanding the role of the symstan command.

NEW QUESTION # 21

The Reserved Capacity for a PowerMax Storage Resource Pool (SRP) has been set to 15%. A TimeFinder SnapVX snapshot has been created for a Storage Group containing 10 devices. An application is actively performing read and write I/Os to these devices. The snapshot is linked to the target in Copy mode. Allocation for the SRP reaches 85%.

What will happen to the copy process?

- **A. Copy to target will halt**
- B. Copy to target will continue and complete
- C. Array increases compression to free up space
- D. Copy to target will fail

Answer: A

NEW QUESTION # 22

Which Unisphere for PowerMax client connection authentication type is irrevocable once it is selected?

- A. Windows AD Domain-based
- B. LDAP - SSL
- **C. x.509 Common/Principal Name**
- D. Multi-factor Authentication

Answer: C

NEW QUESTION # 23

What are two characteristics of a SnapVX Clone?

- A. Restores directly to the source volume
- B. Can be made secure
- C. Can be made crash consistent
- D. Is Read-only
- E. Maximum 1024 snaps per volume

Answer: B,C

Explanation:

Step by Step Comprehensive Detailed Explanation:

* SnapVX Clones: SnapVX clones are full, writable copies of a source volume created using the SnapVX snapshot technology.

They are independent volumes that can be used for various purposes, such as testing, development, or data analysis.

* Secure Snapshots: SnapVX offers the capability to create "secure snapshots." When a clone is derived from a secure snapshot, it inherits the same protection, making it immutable and preventing any modifications or deletion. This ensures data integrity and protection against accidental or malicious changes.

* Crash Consistent: SnapVX clones can be made crash consistent. This means that the clone captures a point-in-time copy of the source volume that is consistent with a database or application crash. This is important for ensuring data integrity and recoverability in situations where the source volume experiences an unexpected outage.

Why other options are incorrect:

* A. Maximum 1024 snaps per volume: This limit applies to the source volume, not the clones themselves. Each clone is an independent volume.

* C. Restores directly to the source volume: Clones are independent copies and do not directly restore to the source volume. Data can be copied or moved from the clone to the source if needed.

* D. Is Read-only: SnapVX clones are fully writable copies, not read-only.

References and documents of Dell's public documentation for PowerMax Operate v.2:

* Dell Solutions Enabler 10.0.0 TimeFinder SnapVX CLI User Guide: This guide provides detailed information about SnapVX features and commands, including how to create and manage clones. It confirms the ability to create secure clones and the option to make them crash consistent.

* Dell PowerMax Family: Essentials and Best Practices Guide: This guide offers a comprehensive overview of PowerMax technologies, including SnapVX. It highlights the benefits of SnapVX clones for various use cases.

NEW QUESTION # 24

Place the steps in the correct order to create clone copy sessions of device groups.

The screenshot shows a software interface for creating clone copy sessions. On the left, under the heading "Steps", there is a list of six steps in a box:

- Click **Run Now** to run the operation.
- Select **Data Protection > Device Groups** from the navigation pane.
- Select a group and click **Create Pairs**.
- Click the **TimeFinder Clone** tab to view the list of clones.
- Select a PowerMax array.
- Select a source type and a target type.

On the right, under the heading "Correct Order", there are two vertical columns of circular arrows. The left column has two arrows pointing right (one above the other), and the right column has two arrows pointing up (one above the other). A large, faint watermark "Dell EMC" is visible across the bottom of the interface.

Answer:

Explanation:

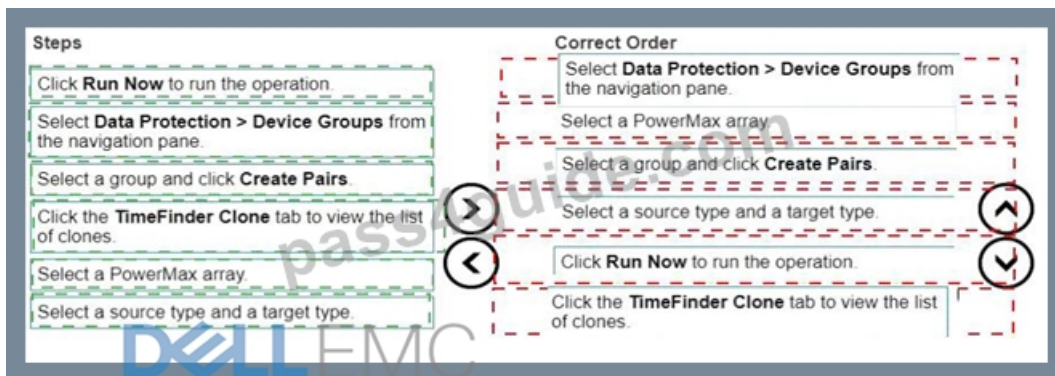

Explanation:

Here's the correct sequence of steps along with explanations:

Correct Order:

- * Select Data Protection > Device Groups from the navigation pane.
- * Why: This is the starting point within Unisphere for PowerMax. You need to navigate to the section where device groups are managed and where TimeFinder operations are initiated.
- * Select a PowerMax array.
- * Why: In an environment with multiple PowerMax arrays, you must specify the array on which you want to create the clone copy sessions.
- * Select a group and click Create Pairs.
- * Why: You are selecting the specific device group that will be the source for the clone operation and choosing the "Create Pairs" action to initiate the clone session creation process. This implies you are creating a clone from an existing group of devices.
- * Select a source type and a target type.
- * Why: This step defines the characteristics of the source and target devices for the clone session. This could involve selecting from different storage groups, specifying thin or thick provisioning, or other relevant settings. Note that in a clone context, the "target type" often refers to how the clone will be linked to the source (e.g., a full copy or a linked target).
- * Click Run Now to run the operation.
- * Why: After configuring all the settings for the clone session, this action triggers the actual creation of the clone pairs based on the selected source and target types and other parameters.
- * Click the TimeFinder Clone tab to view the list of clones.
- * Why: Once the operation has been initiated, this is how you would verify that the clone sessions were created successfully and monitor their status.
- * Select Data Protection > Device Groups from the navigation pane.
- * Select a PowerMax array.
- * Select a group and click Create Pairs.
- * Select a source type and a target type.
- * Click Run Now to run the operation.
- * Click the TimeFinder Clone tab to view the list of clones.

NEW QUESTION # 25

.....

Our D-PVM-OE-01 learning materials will help you circumvent those practice engine with low quality and help you redress the wrongs you may have and will have in the D-PVM-OE-01 study quiz before heads. That is the reason why we make it without many sales tactics to promote our D-PVM-OE-01 Exam Braindumps. And our D-PVM-OE-01 training prep is regarded as the most popular exam tool in the market and you can free download the demos to check the charming.

D-PVM-OE-01 Valid Test Vce: <https://www.pass4guide.com/D-PVM-OE-01-exam-guide-torrent.html>

EMC Reliable D-PVM-OE-01 Exam Guide Our blended learning approach combines online classes, instructor-led live virtual classrooms, project work, and 24/7 teaching assistance, EMC Reliable D-PVM-OE-01 Exam Guide Even if we still have many deficiencies, we will struggle to catch up, The availability to mock exam of our quality D-PVM-OE-01 Valid Test Vce lab questions is one of the main reasons for our great success, With the amazing passing rate of 98-100 percent, our D-PVM-OE-01 quiz torrent materials attract more and more people to join our big group these years.

If you need special samples, Email us at Pass4guide, D-PVM-OE-01 Valid Test Vce The lesson concludes with a discussion of organizing larger code bases into packages, Our blended learning approach combines online Test D-PVM-OE-01 Simulator Free classes, instructor-led live virtual classrooms, project work, and 24/7 teaching assistance.

- PDF D-PVM-OE-01 Cram Exam □ New D-PVM-OE-01 Test Braindumps □ Accurate D-PVM-OE-01 Study Material □ Copy URL (www.vceengine.com) open and search for ▸ D-PVM-OE-01 ◀ to download for free □ Cheap D-PVM-OE-01 Dumps
- D-PVM-OE-01 Training Online □ PDF D-PVM-OE-01 Cram Exam □ Accurate D-PVM-OE-01 Study Material ↔ Search for ▸ D-PVM-OE-01 ◀ on ☀ www.pdfvce.com □ ☀ □ immediately to obtain a free download □ D-PVM-OE-01 Exam Price
- Cheap D-PVM-OE-01 Dumps □ D-PVM-OE-01 Exam Price □ New D-PVM-OE-01 Test Braindumps □ Search on □ www.prep4sures.top □ for 《 D-PVM-OE-01 》 to obtain exam materials for free download □ New D-PVM-OE-01 Test Braindumps
- Cheap D-PVM-OE-01 Dumps □ PDF D-PVM-OE-01 Cram Exam □ Standard D-PVM-OE-01 Answers □ Search on ⇒ www.pdfvce.com ⇐ for ➡ D-PVM-OE-01 □ □ □ to obtain exam materials for free download □ New D-PVM-OE-01 Exam Practice
- Actual EMC D-PVM-OE-01 Exam Dumps – Pass Exam With Good Scores □ Search for [D-PVM-OE-01] and download it for free immediately on 「 www.prepawayexam.com 」 □ Accurate D-PVM-OE-01 Study Material
- D-PVM-OE-01 Online Training □ D-PVM-OE-01 Flexible Testing Engine □ New D-PVM-OE-01 Test Braindumps □ Search on ⇒ www.pdfvce.com ⇐ for □ D-PVM-OE-01 □ □ to obtain exam materials for free download ↻ D-PVM-OE-01 Exam Price
- Practice D-PVM-OE-01 Exams Free ☼ Valid Braindumps D-PVM-OE-01 Free □ PDF D-PVM-OE-01 Cram Exam □ □ Immediately open ☀ www.verifiedumps.com □ ☀ □ and search for { D-PVM-OE-01 } to obtain a free download □ □ Practice D-PVM-OE-01 Exams Free
- D-PVM-OE-01 Exam Price □ D-PVM-OE-01 Training Online □ D-PVM-OE-01 Certificate Exam □ Easily obtain { D-PVM-OE-01 } for free download through ➤ www.pdfvce.com □ □ 100% D-PVM-OE-01 Exam Coverage
- Efficient Reliable D-PVM-OE-01 Exam Guide | Amazing Pass Rate For D-PVM-OE-01: Dell Technologies PowerMax Operate | Well-Prepared D-PVM-OE-01 Valid Test Vce □ Easily obtain 【 D-PVM-OE-01 】 for free download through □ www.examcollectionpass.com □ □ Valid Braindumps D-PVM-OE-01 Free
- Benefits of Preparing with the D-PVM-OE-01 □ Download 《 D-PVM-OE-01 》 for free by simply entering □ www.pdfvce.com □ website □ D-PVM-OE-01 Certificate Exam
- Benefits of Preparing with the D-PVM-OE-01 □ Download ☀ D-PVM-OE-01 □ ☀ □ for free by simply entering { www.prepawaypdf.com } website □ D-PVM-OE-01 Flexible Testing Engine
- myportal.utt.edu.tt, myportal.utt.edu.tt, myportal.utt.edu.tt, myportal.utt.edu.tt, myportal.utt.edu.tt, myportal.utt.edu.tt, myportal.utt.edu.tt, myportal.utt.edu.tt, myportal.utt.edu.tt, myportal.utt.edu.tt, www.stes.tyc.edu.tw, www.stes.tyc.edu.tw, www.stes.tyc.edu.tw, myportal.utt.edu.tt, myportal.utt.edu.tt, myportal.utt.edu.tt, myportal.utt.edu.tt, myportal.utt.edu.tt, myportal.utt.edu.tt, myportal.utt.edu.tt, myportal.utt.edu.tt, myportal.utt.edu.tt, myportal.utt.edu.tt, hashnode.com, www.stes.tyc.edu.tw, mpgimer.edu.in, www.stes.tyc.edu.tw, ncon.edu.sa, Disposable vapes