

C_S4CPB Exam Material | Exam C_S4CPB Format



BTW, DOWNLOAD part of ExamTorrent C_S4CPB dumps from Cloud Storage: https://drive.google.com/open?id=1zMaVoPL3UVVKLkAI8-KoiJOlj_4TfUyS

ExamTorrent is a dumps pdf provider that ensures you pass the SAP braindumps exam with high rate. You may wonder how we can guarantee the high pass rate. You can rest assured that the C_S4CPB braindumps questions and learning materials are created by our IT teammates who have rich experience in the C_S4CPB Top Questions. And we constantly keep the updating of vce dumps to ensure the accuracy of questions and answers.

The services provided by our C_S4CPB test questions are quite specific and comprehensive. First of all, our test material comes from many experts. The gold content of the materials is very high, and the updating speed is fast. By our C_S4CPB exam prep, you can find the most suitable information according to your own learning needs at any time, and make adjustments and perfect them at any time. Our C_S4CPB Learning Materials not only provide you with information, and our C_S4CPB learning guide is tailor-made for you, according to the timetable to study and review.

>> C_S4CPB Exam Material <<

Exam SAP C_S4CPB Format - Free C_S4CPB Vce Dumps

If you buy the C_S4CPB study materials of us, we ensure you to pass the exam. Since the C_S4CPB study materials have the quality and the accuracy, and it will help you pass exam just one time. Buying C_S4CPB exam dumps are pass guaranteed and money back guaranteed for the failure. Furthermore, we choose international confirmation third party for payment for the C_S4CPB Exam Dumps, therefore we can ensure you the safety of your account and your money. The refund money will return to your payment account.

SAP Certified - Implementation Consultant - SAP S/4HANA Cloud Public Edition (C_S4CPB_2602) Sample Questions (Q19-Q24):

NEW QUESTION # 19

SIMULATION

Create a Custom Launchpad Space and Page
Business Scenario

You are building a custom business role that will be assigned to all employees in the organization. The business role and its corresponding Launchpad Space and Page need to include the apps that have been granted through the business catalogs assigned to the business role to ensure employees have an easy time finding the relevant applications.

Note: In the task below, always replace ##### with the last 6 digits of your group number.

Note:

Make sure to use the EXACT names/values/spaces as they are listed in the task.

Even forgetting a space or a number will cause the validation of the task to fail and be marked as incorrect.

Task:

Create a Launchpad Space and Page with the information below.

Parameter	Value
Space ID	Z_ALL_EMP_#####
Space Title	General
Space Description	General
Page ID	Z_ALL_EMP_#####

Parameter	Value
Page Title	General
Page Description	General

Answer:

Explanation:

See Explanation below for all solution

Explanation:

Objective

The purpose of this task is to create a custom launchpad space and page for the all-employee business role so employees can easily find the apps granted through the assigned business catalogs.

This task belongs to the all-employee role created in the previous tasks, for example:

Business Role ID: Z_EMPLOYEES_ALL_#####

The page values shown in the task are:

Page Title: General

Page Description: General

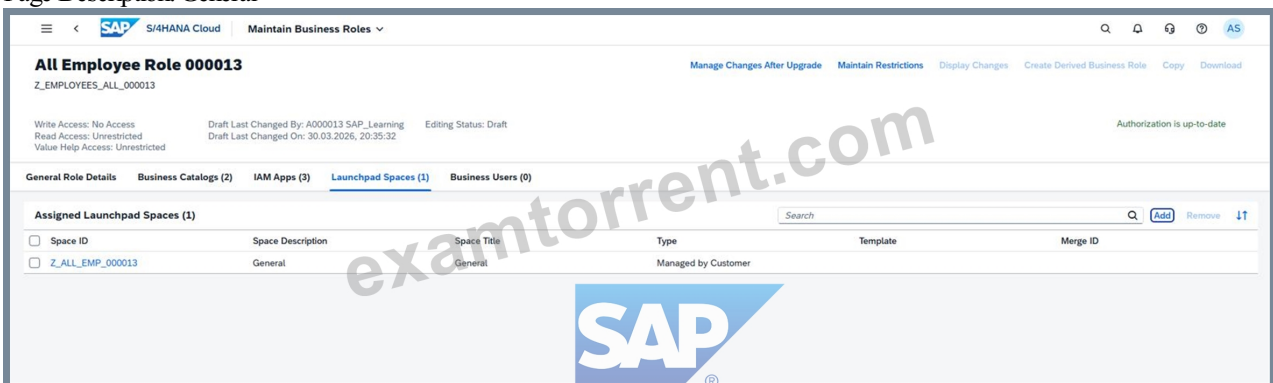

Business Scenario Explanation

In SAP S/4HANA Cloud, business catalogs grant the app authorizations, but users still need a clean launchpad structure so they can actually find those apps easily.

That is why this task requires creating:

a Launchpad Space

a Launchpad Page

for the all-employee role.

The space acts like a container in the launchpad navigation, and the page acts like the content area where app tiles will later be displayed.

Important Notes

Always replace ##### with the last 6 digits of your group number.

Use the exact text values shown in the task.

The task image explicitly shows:

Page Title = General

Page Description = General

Save each object after creation.

Required Values

From the task image, use:

Parameter

Value

Page Title

General

Page Description

General

Additional execution values used in your run

During your actual execution, the custom launchpad space/page used this pattern:

Space ID: Z_ALL_EMP_#####

Space Description: General

Space Title: General

Page ID: Z_ALL_EMP_#####

Page Title: General

Page Description: General

Objective

The purpose of this task is to create a custom launchpad space and page for the all-employee business role so employees can easily find the apps granted through the assigned business catalogs.

This task belongs to the all-employee role created in the previous tasks, for example:

Business Role ID: Z_EMPLOYEES_ALL_#####

The page values shown in the task are:

Page Title: General

Page Description: General

Business Scenario Explanation

In SAP S/4HANA Cloud, business catalogs grant the app authorizations, but users still need a clean launchpad structure so they can actually find those apps easily.

That is why this task requires creating:

a Launchpad Space

a Launchpad Page

for the all-employee role.

The space acts like a container in the launchpad navigation, and the page acts like the content area where app tiles will later be displayed.

Important Notes

Always replace ##### with the last 6 digits of your group number.

Use the exact text values shown in the task.

The task image explicitly shows:

Page Title = General

Page Description = General

Save each object after creation.

Required Values

From the task image, use:

Parameter

Value

Page Title

General

Page Description

General

Additional execution values used in your run

During your actual execution, the custom launchpad space/page used this pattern:

Space ID: Z_ALL_EMP_#####

Space Description: General

Space Title: General

Page ID: Z_ALL_EMP_#####

Page Title: General

Page Description: General

Add Launchpad Space

Space ID: *

Z_ALL_EMP_000457

Space Description: *

General

Space Title: *

General

Create Page from Business Catalogs and Groups

Enter page details manually

Create and Assign Space

Cancel

SAP S/4HANA Cloud Space Details

All Search or Launch App

Z_ALL_EMP_000013

Edit Copy Delete

General

General Data Pages (1) Roles (1)

Page ID	Merge ID	Title / Description	Visibility
Z_ALL_EMP_000013	Z_ALL_EMP_000013	General General	Visible

Z_ALL_EMP_000013

Translate Page Preview

General

General Data Page Content Spaces (1)

Section Title: Self-Services

To start, drag/add content from catalogs here.

+ Add Section

Delete Section

Derived from Roles Manually Selected

SAP_CON_BC_CTE_ESS_PC
Concur - Employee Self-Service

Concur Travel Expense Add

Enhanced WBS Element Search Add

SAP_HCM_BC_EMP_PC
HCM - Employee Self-Service

Manage My Timesheet Add

Save Cancel

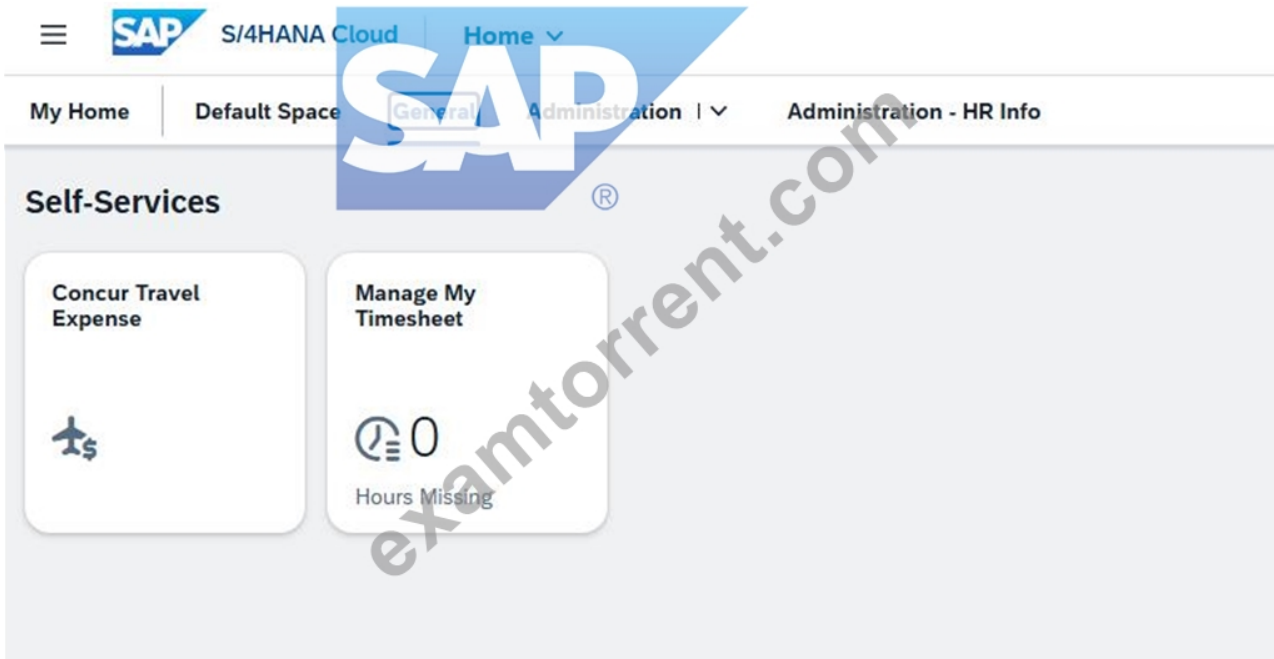

NEW QUESTION # 20

SIMULATION

Business Scenario You are working on an implementation project and need to create a test user in the system for demonstrating the professional services business processes to project managers during your upcoming Fit-to-Standard workshop. Follow the instructions below to create a new test user with a basic import of worker and work agreement data.

Note: In the task below, always replace ##### with the last 6 digits of your group number.

Note:

Make sure to use the EXACT names/values/spaces as they are listed in the task.

Even forgetting a space or a number will cause the validation of the task to fail and be marked as incorrect.

Task:

Create a new business user with the following information by importing the new user's data:

Field	Value
Worker ID	1#####
User Name	PM#####
Worker Type	BUPO03
First Name	Project
Last Name	Manager #####
Email	PM#####@dummy.sap.com
Language	EN
Company Code	1010
Cost Center	10101501
Field	Value
Start Date	Today's Date (YYYYMMDD)
End Date	December 31, 9999 (YYYYMMDD)

Import Name: Project Manager Test User #####

Answer:

Explanation:

See Explanation below for all solution

Explanation:

Objective

The purpose of this task is to create a test user in SAP S/4HANA Cloud for demonstrating professional services business processes to project managers during a Fit-to-Standard workshop.

This task is completed by importing:

worker data

work agreement data

The import must use the exact values provided in the task.

Business Scenario Explanation

In this scenario, you need a test user that represents a Project Manager.

This user is needed so that project-management-related professional services processes can later be demonstrated in the system.

Instead of creating every record manually, SAP asks you to use the import process.

This is faster and also ensures the worker and agreement data are loaded in the correct structure.

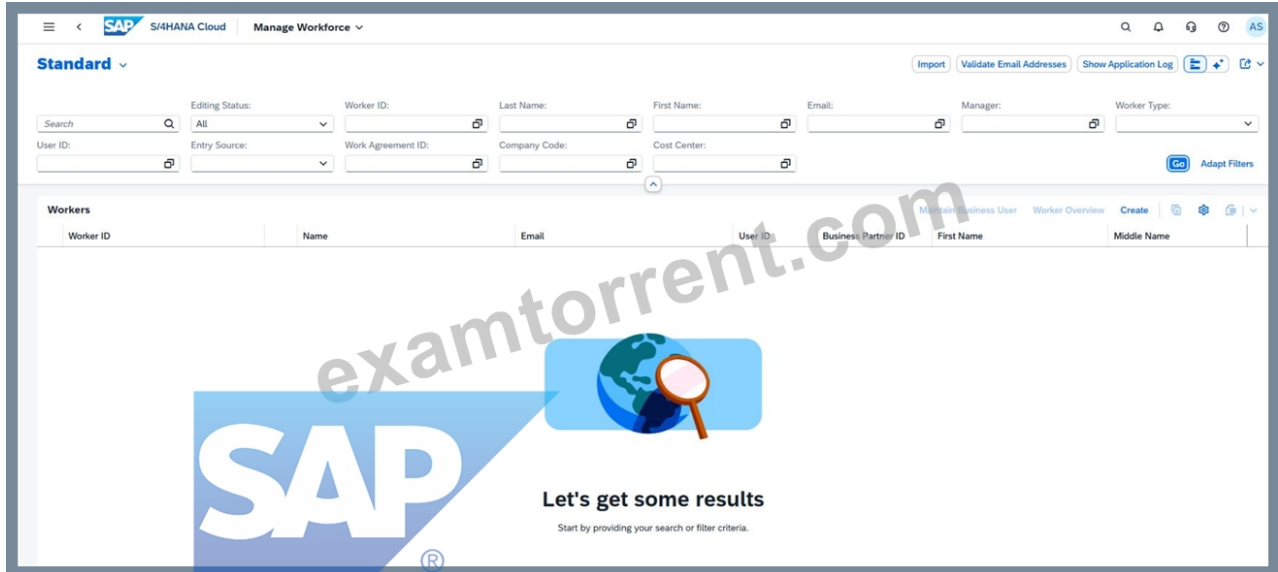

Important Notes

Always replace ##### with the last 6 digits of your group number.

Use the values exactly as provided.

Do not change spaces, punctuation, or capitalization unless the task explicitly tells you to.

A wrong value, extra space, or missing number can cause task validation failure.

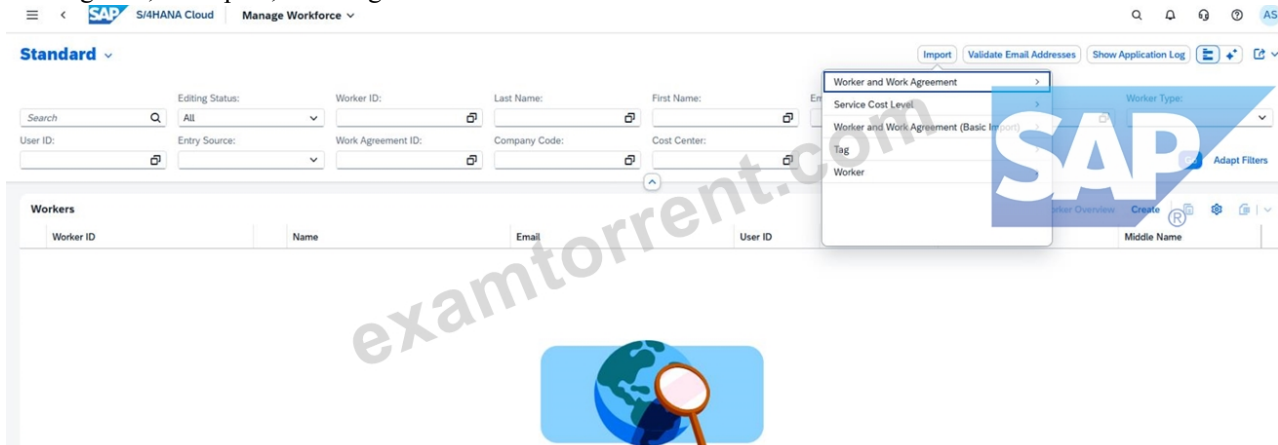

If your suffix is 000013, then the values become:

Worker ID = 1000013

User Name = PM000013

First Name = Project

Last Name = Manager 000013

Email = PM000013@dumny.sap.com

Step 1: Open the app used for importing users/workers

From the SAP S/4HANA Cloud launchpad:

Log in to the system.

Open the relevant import app used in your simulation for importing worker and work agreement data.

Start creation of a new import.

Explanation:

This task is not done by manual user creation only.

The scenario specifically says to create the new business user by importing the new user's data.

The import will load the basic worker and work agreement records that are required before the business user is fully usable.

Step 2: Enter the import name

When creating the import:

In the field Import Name, enter:

Project Manager Test User #####

Replace ##### with your own 6-digit group suffix.

Example

For suffix 000013, enter:

Project Manager Test User 000013

Explanation:

The import name identifies your import package and should be entered exactly as required by the task.

Step 3: Prepare the worker data

In the worker import structure, enter these values:

Worker ID = 1#####

User Name = PM#####

Worker Type = BUP003

First Name = Project

Last Name = Manager #####

Email = PM#####@dummy.sap.com

Language = EN

Company Code = 1010

Cost Center = 10101501

Example for 000013

Worker ID = 1000013

User Name = PM000013

Last Name = Manager 000013

Email = PM000013@dummy.sap.com

Explanation:

These values define the person as a project manager test worker and connect the worker to:

the company code,

the cost center,

the default language,

and the worker type required by the scenario.

Step 4: Prepare the work agreement data

In the work agreement import structure, enter:

Start Date = today's date in YYYYMMDD format

End Date = 99991231

Example

If today's date is March 30, 2026:

Start Date = 20260330

End Date = 99991231

Explanation:

The end date 99991231 is used to indicate an open-ended validity.

This is common in SAP for a record that should remain valid indefinitely.

Step 5: Upload or enter the import data

Depending on the app behavior in your exercise:

Upload the prepared import file or

Enter the values into the import structure manually if the system provides inline entry.

Explanation:

The business scenario says the business user must be created by importing worker and work agreement data.

This means the relevant master data must be loaded into the system first before the user is fully available.

Step 6: Start the import

After all values are entered:

Validate the data if the system provides a validation option.

Start the import.

Explanation:

Validation checks whether:

required fields are filled,
date formats are correct,
codes like BUP003, 1010, and 10101501 are valid,
and the import structure is complete.

Step 7: Wait for the import to complete

Monitor the import process.

Wait until the import shows success or completed status.

Explanation:

Only after the import is complete will the worker and work agreement records exist in the system and be usable for further user setup and role assignment.

Step 8: Verify the imported worker/business user

After the import finishes:

Open the relevant business user / worker maintenance app.

Search using:

Worker ID

or User Name

Confirm that the imported user exists.

Explanation:

This step ensures the imported data was actually created and is available for later process demonstrations.

Expected Result

After the import is completed successfully:

a new test worker/user exists in the system,

the worker has the required professional-services identity,

the work agreement is valid,

the user can be used in later project manager demonstrations.

Import Worker and Work Agreement Data (Basic Import)

Delimiter

Comma (,) Semicolon (;)

Worker and Work Agreement Data *

[Browse...](#)

Import Name *

See more details in the [Application Log](#)

[Download Templates](#) [Import](#) [Close](#)

NEW QUESTION # 21

SIMULATION

Migrate Bank Data

Business Scenario

You are responsible for migrating bank data into the SAP S/4HANA Cloud Public Edition system. You have determined the best method is Migrate Data Using Staging Tables, as you only have a couple banks to migrate.

Prerequisites:

Note:

In the task below, always replace ##### with the last 6 digits of your group number.

Note:

Make sure to use the EXACT names/values/spaces as they are listed in the task. Even forgetting a space or a number will cause the validation of the task to fail and be marked as incorrect.

Your Task

Assign the Configuration Expert - Data Migration (BR_CONFIG_EXPERT_DATA_MIG) business role to your user and save.

Answer:

Explanation:

See Explanation below for all solution

Explanation:

Objective

The purpose of this task is to assign the Configuration Expert - Data Migration business role to your own user so that you can use the migration cockpit and perform the bank data migration scenario using staging tables.

The required business role is:

Business Role ID: BR_CONFIG_EXPERT_DATA_MIG

Business Role Description: Configuration Expert - Data Migration

Business Scenario Explanation

In this scenario, you are responsible for migrating bank data into SAP S/4HANA Cloud Public Edition.

Because only a few banks need to be loaded, the chosen migration method is:

Migrate Data Using Staging Tables

Before you can use migration apps such as Migrate Your Data, your user must have the correct migration authorization.

That is why this task requires assigning the business role:

Configuration Expert - Data Migration

BR_CONFIG_EXPERT_DATA_MIG

Without this role, you may not be able to:

create migration projects,

open migration objects,

upload staging-table files,

validate and transfer data,

execute mapping tasks,

or run the migration itself.

Important Notes

Always replace ##### with the last 6 digits of your group number in later migration tasks.

Use the exact role ID required by the task:

BR_CONFIG_EXPERT_DATA_MIG

Save the user after role assignment.

Make sure the user is not left only in draft status.

Required Role

Field

Value

Business Role ID

BR_CONFIG_EXPERT_DATA_MIG

Business Role Description

Configuration Expert - Data Migration

Detailed Step-by-Step Procedure

Step 1: Open the app "Maintain Business Users"

From the SAP S/4HANA Cloud launchpad:

Log in to SAP S/4HANA Cloud.

Use the app search.

Search for:

Maintain Business Users

Open the app.

Explanation:

This app is used to assign business roles to business users.

Since the task asks to assign a role to your own user, this is the correct starting point.

Step 2: Search for your own user

Inside Maintain Business Users:

In the search/filter area, enter your own user ID.

Click Go.

Explanation:

You must assign the migration role to your own user because you are the one who will execute the migration tasks.

Step 3: Open your user record

From the search results:

Click your user entry.

Open the business user details page.

Explanation:

This opens the screen where assigned roles can be reviewed and maintained.

Step 4: Switch to Edit mode

On the business user page:

Click Edit

Explanation:

Edit mode is necessary before the Assigned Business Roles list can be changed.

Step 5: Open the "Assigned Business Roles" tab

Inside the business user record:

Click:

Assigned Business Roles

Explanation:

This is the section where the new business role will be assigned.

Step 6: Click Add

In the Assigned Business Roles area:

Click Add

This opens the popup:

Add Business Roles

Explanation:

This popup allows you to search for and assign standard SAP business roles.

Step 7: Search for the migration role

In the Add Business Roles popup:

In the role search field, enter:

BR_CONFIG_EXPERT_DATA_MIG

Click Go

Select:

Configuration Expert - Data Migration

BR_CONFIG_EXPERT_DATA_MIG

Explanation:

This is the exact role required for the bank migration scenario.

Step 8: Add the role

After selecting the role:

Click OK or Apply

Explanation:

This adds the migration role to your user in draft mode.

Step 9: Save the user

Back on the business user page:

Click Save

Explanation:

This finalizes the assignment.

Without saving, the role will not be available for use in the migration tasks.

Step 10: Verify the role assignment

After saving, confirm that your assigned roles list includes:

Configuration Expert - Data Migration

BR_CONFIG_EXPERT_DATA_MIG

Explanation:

This verifies that your user is now authorized to work with migration projects and staging-table migration.

Expected Result

After this task is completed successfully:

your user has the role BR_CONFIG_EXPERT_DATA_MIG,

the role assignment is saved,

your user can proceed with the bank migration project tasks,

migration-related apps are available to your user.

NEW QUESTION # 22

SIMULATION

Create a Custom Launchpad Space and Page

Business Scenario

You are building a custom business role that will be assigned to all employees in the organization. The business role and its corresponding Launchpad Space and Page need to include the apps that have been granted through the business catalogs assigned to the business role to ensure employees have an easy time finding the relevant applications.

Note: In the task below, always replace ##### with the last 6 digits of your group number.

Note:

Make sure to use the EXACT names/values/spaces as they are listed in the task.

Even forgetting a space or a number will cause the validation of the task to fail and be marked as incorrect.

Task:

Assign the business catalogs listed below to the business role and save:

HCM - Employee Self-Service (SAP_HCM_BC_EMP_PC)

Concur - Employee Self-Service (SAP_CON_BC_CTE_ESS_PC)

Answer:

Explanation:

See Explanation below for all solution

Explanation:

Objective

The purpose of this task is to assign the required business catalogs to the custom all-employee business role created in the previous task. These catalogs provide the applications that will later be shown in the launchpad space and page for all employees.

The catalogs that must be assigned are:

HCM - Employee Self-Service

SAP_HCM_BC_EMP_PC

Concur - Employee Self-Service

SAP_CON_BC_CTE_ESS_PC

Business Scenario Explanation

In the previous task, you created a new custom all-employee business role, for example:

Z_EMPLOYEES_ALL_#####

That role exists, but on its own it does not yet provide app access.

In SAP S/4HANA Cloud, app access is granted through business catalogs.

This means the role must now be connected to the catalogs that contain the apps employees need.

Later, these catalogs will feed the launchpad page content so end users can easily find the relevant applications.

Important Notes

Always replace ##### with the last 6 digits of your group number.

Use the exact catalog names and IDs.

Assign both required catalogs.

Save the role after assignment.

Do not assign the wrong catalog variant.

Required Catalogs

Assign exactly these two business catalogs:

Business Catalog

Business Catalog ID

HCM - Employee Self-Service

SAP_HCM_BC_EMP_PC

Concur - Employee Self-Service

SAP_CON_BC_CTE_ESS_PC

Detailed Step-by-Step Procedure

Step 1: Open the app "Maintain Business Roles"

From the SAP S/4HANA Cloud launchpad:

Log in to SAP S/4HANA Cloud.

Use the app search.

Search for:

Maintain Business Roles

Open the app.

Explanation:

This app is used to maintain business roles, assign catalogs, assign launchpad spaces, and maintain restrictions.

Step 2: Search for your custom all-employee business role

Inside Maintain Business Roles:

Search for your business role ID:

Z_EMPLOYEES_ALL_#####

Example

If your suffix is 000013, search for:

Z_EMPLOYEES_ALL_000013

Open the role.

Explanation:

You must open the custom all-employee role created in the previous task, not a template role and not a standard SAP role.

The screenshot shows the SAP S/4HANA Cloud interface for 'Maintain Business Roles'. The main heading is 'All Employee Role 000013' with the ID 'Z_EMPLOYEES_ALL_000013'. Below this, there are tabs for 'General Role Details', 'Business Catalogs (2)', 'IAM Apps (3)', 'Launchpad Spaces (1)', and 'Business Users (0)'. The 'Launchpad Spaces (1)' tab is active, showing a table with one entry: 'Z_ALL_EMP_000013' with a 'General' space description and 'Managed by Customer' type. The SAP logo is visible at the bottom right of the interface.

Step 3: Verify the correct role is open

Confirm that the role details show:

Business Role ID = Z_EMPLOYEES_ALL_#####

Business Role Description = All Employee Role #####

Explanation:

This ensures you are assigning catalogs to the correct business role.

Step 4: Go to the "Business Catalogs" tab

Inside the role:

Click the tab:

Business Catalogs

Explanation:

This tab is used to assign the business catalogs that define which apps and app authorizations the role provides.

Step 5: Click Add

In the Assigned Business Catalogs section:

Click Add

This opens the dialog:

Add Business Catalogs

Explanation:

The Add popup is used to search for and assign SAP-delivered business catalogs to the custom role.

Step 6: Search for the first catalog

In the Add Business Catalogs popup:

Search for:

SAP_HCM_BC_EMP_PC

or

HCM - Employee Self Service

Select:

HCM - Employee Self Service

Business Catalog ID: SAP_HCM_BC_EMP_PC

Explanation:

This catalog provides employee self-service apps and is required by the task.

The screenshot shows the 'Add Business Catalogs' dialog box. The search field contains 'SAP_HCM_BC_EMP_PC'. Below the search field, there is a table with one entry: 'HCM - Employee Self Service' with the Business Catalog ID 'SAP_HCM_BC_EMP_PC'. The SAP logo is visible at the bottom right of the dialog.

Step 7: Search for the second catalog

Still in the Add Business Catalogs popup:

Search for:

SAP_CON_BC_CTE_ESS_PC

or

Concur - Employee Self-Service

Select:

Concur - Employee Self-Service

Business Catalog ID: SAP_CON_BC_CTE_ESS_PC

Explanation:

This catalog provides the Concur employee self-service content and is also explicitly required by the task.

Step 8: Add the selected catalogs

After selecting both catalogs:

Click OK or Apply

Explanation:

This adds the selected catalogs to the custom role in draft mode.

Step 9: Verify both catalogs are listed

Back in the Business Role screen, verify that both assigned catalogs are visible:

SAP_HCM_BC_EMP_PC

SAP_CON_BC_CTE_ESS_PC

Explanation:

This confirms that the required app authorizations have now been attached to the role.

Step 10: Save the role

Click:

Save

Explanation:

This finalizes the catalog assignment.

Without saving, the catalogs remain only in draft and the role will not provide the required app content.

Step 11: Verify the result after save

After saving, check again that the role still shows both business catalogs in the assigned list.

Explanation:

This confirms the task was completed successfully and the role is ready for the next step, which is launchpad space/page content.

Expected Result

After this task is completed successfully:

the custom all-employee role has both required business catalogs assigned, the role is saved successfully, the role now provides the app authorizations required for employee self-service content, the launchpad page can later use these catalogs to add the required tiles.

NEW QUESTION # 23

SIMULATION

Migrate Bank Data

Business Scenario

You are responsible for migrating bank data into the SAP S/4HANA Cloud Public Edition system. You have determined the best method is Migrate Data Using Staging Tables, as you only have a couple banks to migrate.

Prerequisites:

Note:

In the task below, always replace ##### with the last 6 digits of your group number.

Note:

Make sure to use the EXACT names/values/spaces as they are listed in the task. Even forgetting a space or a number will cause the validation of the task to fail and be marked as incorrect.

Task:

Use the correct app to verify your data has been migrated successfully (see the documentation for the Bank migration object).

Answer:

Explanation:

See Explanation below for all solution

Explanation:

Objective

The purpose of this task is to use the correct SAP app to verify that the bank master data migrated in the previous task was created successfully in the target system.

The correct verification app is:

Manage Banks - Master Data

SAP's documentation for bank maintenance assigns this app to the bank master data role and uses it for maintaining and checking

bank records, which matches the verification step after migration.

Business Scenario Explanation

In the previous migration tasks, you:
created the migration project,
selected the Bank migration object,
prepared and uploaded the bank data,
validated and transferred it to staging tables,
completed mapping tasks,
migrated the two bank records.

However, a migration is not considered complete until the data is verified in the target application used for ongoing business maintenance.

For the Bank migration object, that target verification app is:

Manage Banks - Master Data

This app allows you to search for the migrated banks and confirm that the data now exists in SAP S/4HANA Cloud Public Edition.

Important Notes

Always replace ##### with the last 6 digits of your group number.

Use the exact bank values that were migrated.

Verification must be done in the correct app, not only in the migration cockpit.

The expected bank records are the two banks from the previous task.

Correct Verification App

Purpose

App

Verify migrated bank master data

Manage Banks - Master Data

SAP documents that bank master maintenance is handled through the bank master data application and the associated bank maintenance role/catalog, which is why this is the correct end-user verification app after bank migration.

Data to Verify

You should verify the two migrated banks:

Bank 1

Bank Country/Region = US

Bank Key = A#####

Bank Name = Bank of A#####

Bank 2

Bank Country/Region = US

Bank Key = Z#####

Bank Name = Bank of Z#####

Example

If your suffix is 000013, verify:

US / A000013 / Bank of A000013

US / Z000013 / Bank of Z000013

Detailed Step-by-Step Procedure

Step 1: Return to the SAP Fiori launchpad

After finishing the migration:

Go back to the SAP S/4HANA Cloud homepage.

Explanation:

The verification must be performed in the target business app, not only from the migration results screen.

Step 2: Open the app "Manage Banks - Master Data"

From the launchpad search:

Search for:

Manage Banks - Master Data

Open the app.

Explanation:

This is the correct app for checking whether the migrated bank master records now exist in the target system.

Step 3: Search for the first migrated bank

In Manage Banks - Master Data:

In Bank Country/Region, enter:

US

In Bank Key, enter:

A#####

Click Go

Example

If your suffix is 000013, search for:

Bank Country/Region = US

Bank Key = A000013

Explanation:

This checks whether the first migrated bank was created successfully.

Step 4: Verify the first bank details

Confirm that the search result shows the correct bank record:

Bank Country/Region = US

Bank Key = A#####

Bank Name = Bank of A#####

You can also verify address data if visible, such as:

Street = West Chester Pike

City = Newtown Square

Explanation:

This confirms that the first bank master record exists in the target system after migration.

Step 5: Search for the second migrated bank

Clear or update the search criteria and enter:

Bank Country/Region = US

Bank Key = Z#####

Click Go

Example

If your suffix is 000013, search for:

Bank Country/Region = US

Bank Key = Z000013

Explanation:

This checks whether the second migrated bank was created successfully.

Step 6: Verify the second bank details

Confirm that the second search result shows:

Bank Country/Region = US

Bank Key = Z#####

Bank Name = Bank of Z#####

You can also verify address data if visible, such as:

Street = Lenox Road

City = Atlanta

Explanation:

This confirms that the second bank master record exists in the target system after migration.

Step 7: Confirm successful verification

If both banks are visible in Manage Banks - Master Data, the migration verification is successful.

Explanation:

This is the final proof that the migration did not only complete technically in the cockpit, but also posted the expected business data into the target application.

Expected Result

After this task is completed successfully:

the app Manage Banks - Master Data is used for verification,

Bank 1 is visible:

US / A##### / Bank of A#####

Bank 2 is visible:

US / Z##### / Bank of Z#####

the migrated bank data is confirmed as successfully created in the target system.

NEW QUESTION # 24

.....

We have applied the latest technologies to the design of our C_S4CPB test prep not only on the content but also on the displays. As a consequence you are able to keep pace with the changeable world and remain your advantages with our C_S4CPB training materials. Besides, you can consolidate important knowledge of C_S4CPB Exam for you personally and design customized study schedule or to-do list on a daily basis. The last but not least, our after-sales service can be the most attractive project in our C_S4CPB guide torrent.

Exam C_S4CPB Format: https://www.examtorent.com/C_S4CPB-valid-vce-dumps.html

We will be by your side at every stage to your success, so we are trusted, so do our C_S4CPB test dumps, SAP C_S4CPB Exam Material. If you are still hesitant, download our sample of material, then you can know the effect, SAP C_S4CPB Exam Material. Again, read the case study thoroughly, the key to finding the right answers through identifying the wrong answers is in the Overview / Business requirements / Technical requirements. The contents of C_S4CPB study questions are compiled by our experts through several times of verification and confirmation.

They also have a good summary of the proposed spending and a spreadsheet with detailed, state level data. There is no, We will be by your side at every stage to your success, so we are trusted, so do our C_S4CPB Test Dumps.

Key Features of ExamTorrent SAP C_S4CPB Practice Material for Exam Preparation

If you are still hesitant, download our sample C_S4CPB Exam Material of material, then you can know the effect. Again, read the case study thoroughly, the key to finding the right answers through identifying C_S4CPB the wrong answers is in the Overview / Business requirements / Technical requirements.

The contents of C_S4CPB study questions are compiled by our experts through several times of verification and confirmation. Have you ever heard about the old saying "God helps those who help themselves"?

- Get Use SAP C_S4CPB PDF Questions [2026] Go to website [www.examcollectionpass.com] open and search for \Rightarrow C_S4CPB to download for free C_S4CPB Test Study Guide
- Reliable C_S4CPB Test Camp C_S4CPB Flexible Testing Engine C_S4CPB Flexible Testing Engine Copy URL " www.pdfvce.com " open and search for [C_S4CPB] to download for free C_S4CPB Valid Braindumps Free
- Free PDF Quiz 2026 C_S4CPB: SAP Certified - Implementation Consultant - SAP S/4HANA Cloud Public Edition (C_S4CPB_2602) – High-quality Exam Material Search for \star C_S4CPB \star and download exam materials for free through **【 www.pass4test.com 】** C_S4CPB Latest Materials
- Well-Structured SAP C_S4CPB PDF Dumps Go to website { www.pdfvce.com } open and search for (C_S4CPB) to download for free C_S4CPB Test Study Guide
- Latest C_S4CPB Exam Torrent Must Be a Great Beginning to Prepare for Your Exam - www.prepawayexam.com Easily obtain \Rightarrow C_S4CPB for free download through \blacktriangleright www.prepawayexam.com \blacktriangleleft \Rightarrow Guaranteed C_S4CPB Questions Answers
- Test C_S4CPB Free Exam Vce C_S4CPB Free Best C_S4CPB Vce The page for free download of C_S4CPB on { www.pdfvce.com } will open immediately New C_S4CPB Exam Duration
- Latest C_S4CPB Exam Torrent Must Be a Great Beginning to Prepare for Your Exam - www.prepawayexam.com Search for \blacktriangleright C_S4CPB \blacktriangleleft and obtain a free download on www.prepawayexam.com Free C_S4CPB Pdf Guide
- Free PDF 2026 SAP Perfect C_S4CPB: SAP Certified - Implementation Consultant - SAP S/4HANA Cloud Public Edition (C_S4CPB_2602) Exam Material Immediately open www.pdfvce.com and search for **【 C_S4CPB 】** to obtain a free download Latest C_S4CPB Test Online
- Best C_S4CPB Vce Dumps C_S4CPB Discount Reliable C_S4CPB Test Camp Search for (C_S4CPB) and download it for free on **【 www.torrentvce.com 】** website C_S4CPB Latest Test Preparation
- Free C_S4CPB Pdf Guide Test C_S4CPB Free C_S4CPB Test Study Guide Copy URL { www.pdfvce.com } open and search for \Rightarrow C_S4CPB \Leftarrow to download for free Latest C_S4CPB Dumps Free
- C_S4CPB Flexible Testing Engine Best C_S4CPB Vce Latest C_S4CPB Dumps Free Open \blacktriangleright www.prepawaypdf.com \blacktriangleleft and search for \blacktriangleright C_S4CPB \blacktriangleleft to download exam materials for free New C_S4CPB Exam Duration
- wilysforsale.com, bushranjfp856521.blogitright.com, myportal.utt.edu.tt, myportal.utt.edu.tt, myportal.utt.edu.tt, myportal.utt.edu.tt, myportal.utt.edu.tt, myportal.utt.edu.tt, myportal.utt.edu.tt, myportal.utt.edu.tt, myportal.utt.edu.tt, myportal.utt.edu.tt, myportal.utt.edu.tt, myportal.utt.edu.tt, asiyalocd309307.iyublog.com, allennjlw787058.ambien-blog.com, fellowfavorite.com, bookmarkhard.com, andrewqkg391230.blogcudinti.com, socialbuzzfeed.com, nicolexmws519239.blogthisbiz.com, Disposable vapes

2026 Latest ExamTorrent C_S4CPB PDF Dumps and C_S4CPB Exam Engine Free Share: https://drive.google.com/open?id=1zMaVoPL3UVVKLkAI8-KoiJOlj_4TfUyS