

Up-to-Date SAP C_S4CPB_2602 Exam Questions For Best Result



Our company deeply knows that product quality is very important, so we have been focusing on ensuring the development of a high quality of our C_S4CPB_2602 test torrent. All customers who have purchased our products have left deep impression on our C_S4CPB_2602 guide torrent. If you decide to buy our C_S4CPB_2602 test torrent, we would like to offer you 24-hour online efficient service, you have the right to communicate with us without any worries at any time you need, and you will receive a reply, we are glad to answer your any question about our C_S4CPB_2602 Guide Torrent. You have the right to communicate with us by online contacts or by an email.

SAP C_S4CPB_2602 certification exam is very important for every IT person. With this certification you will not be eliminated, and you will be a raise. Some people say that to pass the SAP C_S4CPB_2602 exam certification is tantamount to success. Yes, this is true. You get what you want is one of the manifestations of success. Pass4sures of SAP C_S4CPB_2602 Exam Materials is the source of your success. With this training materials, you will speed up the pace of success, and you will be more confident.

>> Valid C_S4CPB_2602 Test Book <<

Practice C_S4CPB_2602 Exams, C_S4CPB_2602 Valid Exam Tutorial

The interface is made simple and convenient for the users. In the web-based practice exam, you will be given conceptual questions of the actual SAP C_S4CPB_2602 exam and gives you the results so that you can improve it at the end of every attempt. This sort of self-evaluation will help you know your exact weak points and you will improve a lot before the actual C_S4CPB_2602 Exam. It is compatible with every browser. All operating systems also support the web-based practice exam.

SAP Certified - Implementation Consultant - SAP S/4HANA Cloud Public Edition (C_S4CPB_2602) Sample Questions (Q18-Q23):

NEW QUESTION # 18

SIMULATION

Create a Custom Launchpad Space and Page
Business Scenario

You are building a custom business role that will be assigned to all employees in the organization. The business role and its corresponding Launchpad Space and Page need to include the apps that have been granted through the business catalogs assigned to the business role to ensure employees have an easy time finding the relevant applications.

Note: In the task below, always replace ##### with the last 6 digits of your group number.

Note:

Make sure to use the EXACT names/values/spaces as they are listed in the task.

Even forgetting a space or a number will cause the validation of the task to fail and be marked as incorrect.

Task:

Create a Launchpad Space and Page with the information below.

Parameter	Value
Space ID	Z_ALL_EMP_#####
Space Title	General
Space Description	General
Page ID	Z_ALL_EMP_#####

Parameter	Value
Page Title	General
Page Description	General

Answer:

Explanation:

See Explanation below for all solution

Explanation:

Objective

The purpose of this task is to create a custom launchpad space and page for the all-employee business role so employees can easily find the apps granted through the assigned business catalogs.

This task belongs to the all-employee role created in the previous tasks, for example:

Business Role ID: Z_EMPLOYEES_ALL_#####

The page values shown in the task are:

Page Title: General

Page Description: General

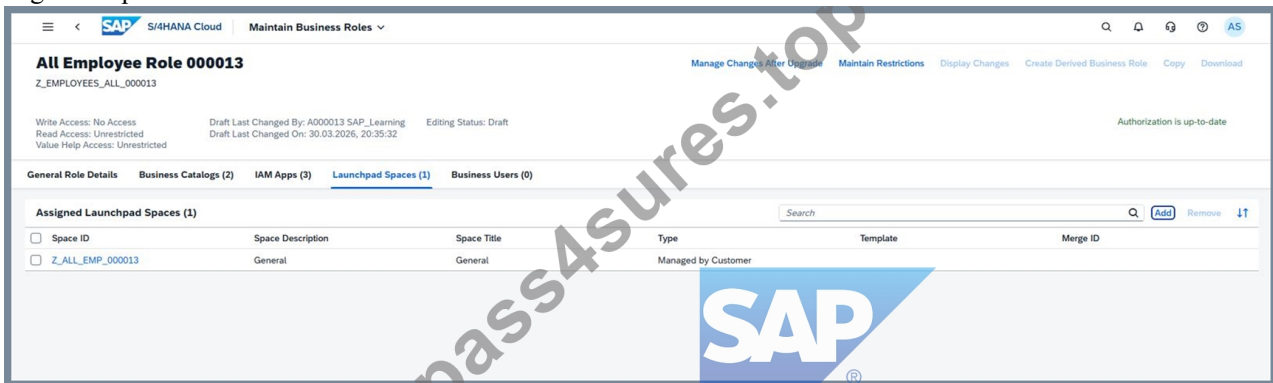

Business Scenario Explanation

In SAP S/4HANA Cloud, business catalogs grant the app authorizations, but users still need a clean launchpad structure so they can actually find those apps easily.

That is why this task requires creating:

a Launchpad Space

a Launchpad Page

for the all-employee role.

The space acts like a container in the launchpad navigation, and the page acts like the content area where app tiles will later be displayed.

Important Notes

Always replace ##### with the last 6 digits of your group number.

Use the exact text values shown in the task.

The task image explicitly shows:

Page Title = General

Page Description = General

Save each object after creation.

Required Values

From the task image, use:

Parameter

Value

Page Title

General

Page Description

General

Additional execution values used in your run

During your actual execution, the custom launchpad space/page used this pattern:

Space ID: Z_ALL_EMP_#####

Space Description: General

Space Title: General

Page ID: Z_ALL_EMP_#####

Page Title: General

Page Description: General

Objective

The purpose of this task is to create a custom launchpad space and page for the all-employee business role so employees can easily find the apps granted through the assigned business catalogs.

This task belongs to the all-employee role created in the previous tasks, for example:

Business Role ID: Z_EMPLOYEES_ALL_#####

The page values shown in the task are:

Page Title: General

Page Description: General

Business Scenario Explanation

In SAP S/4HANA Cloud, business catalogs grant the app authorizations, but users still need a clean launchpad structure so they can actually find those apps easily.

That is why this task requires creating:

a Launchpad Space

a Launchpad Page

for the all-employee role.

The space acts like a container in the launchpad navigation, and the page acts like the content area where app tiles will later be displayed.

Important Notes

Always replace ##### with the last 6 digits of your group number.

Use the exact text values shown in the task.

The task image explicitly shows:

Page Title = General

Page Description = General

Save each object after creation.

Required Values

From the task image, use:

Parameter

Value

Page Title

General

Page Description

General

Additional execution values used in your run

During your actual execution, the custom launchpad space/page used this pattern:

Space ID: Z_ALL_EMP_#####

Space Description: General

Space Title: General

Page ID: Z_ALL_EMP_#####

Page Title: General

Page Description: General

Add Launchpad Space

Space ID: *

Z_ALL_EMP_000457

Space Description: *

General

Space Title: *

General

Create Page from Business Catalogs and Groups

Enter page details manually

Create and Assign Space

Cancel

The screenshot displays the SAP S/4HANA Cloud interface for configuring a Launchpad Space. The top section shows the configuration form with the following details:

- Space ID:** Z_ALL_EMP_000457
- Space Description:** General
- Space Title:** General
- Create Page from Business Catalogs and Groups
- Enter page details manually

The bottom section shows the 'Page Content' editor for the space ID Z_ALL_EMP_00013. The page title is 'Self-Services'. The editor area contains the instruction: 'To start, drag/add content from catalogs here.' and an '+ Add Section' button. On the right side, there is a list of tiles available for selection:

Derived from Roles	Manually Selected
SAP_CON_BC_CTE_ESS_PC Concur - Employee Self-Service	
<input type="checkbox"/> Concur Travel Expense	<input type="radio"/> Add v
<input type="checkbox"/> Enhanced WBS Element Search	<input type="radio"/> Add v
SAP_HCM_BC_EMP_PC HCM - Employee Self-Service	
<input type="checkbox"/> Manage My Timesheet	<input type="radio"/> Add v

At the bottom right of the editor, there are 'Save' and 'Cancel' buttons.

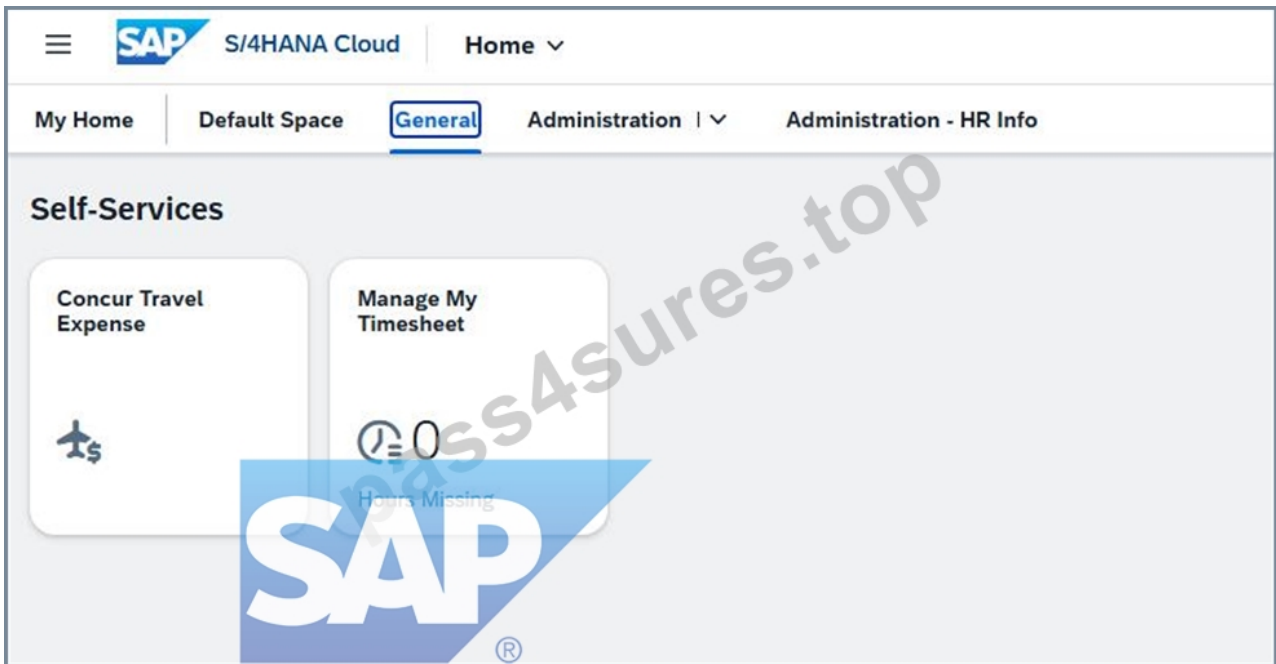

NEW QUESTION # 19

SIMULATION

Business Scenario You are working on an implementation project and need to create a test user in the system for demonstrating the professional services business processes to project managers during your upcoming Fit-to-Standard workshop. Follow the instructions below to create a new test user with a basic import of worker and work agreement data.

Note: In the task below, always replace ##### with the last 6 digits of your group number.

Note:

Make sure to use the EXACT names/values/spaces as they are listed in the task.

Even forgetting a space or a number will cause the validation of the task to fail and be marked as incorrect.

Task:

Create a new business user with the following information by importing the new user's data:

Field	Value
Worker ID	1#####
User Name	PM#####
Worker Type	BUP003
First Name	Project
Last Name	Manager #####
Email	PM#####@dummy.sap.com
Language	EN
Company Code	1010
Cost Center	10101501
Field	Value
Start Date	Today's Date (YYYYMMDD)
End Date	December 31, 9999 (YYYYMMDD)

Import Name: Project Manager Test User #####

Answer:

Explanation:

See Explanation below for all solution

Explanation:

Objective

The purpose of this task is to create a test user in SAP S/4HANA Cloud for demonstrating professional services business processes to project managers during a Fit-to-Standard workshop.

This task is completed by importing:

worker data

work agreement data

The import must use the exact values provided in the task.

Business Scenario Explanation

In this scenario, you need a test user that represents a Project Manager.

This user is needed so that project-management-related professional services processes can later be demonstrated in the system.

Instead of creating every record manually, SAP asks you to use the import process.

This is faster and also ensures the worker and agreement data are loaded in the correct structure.

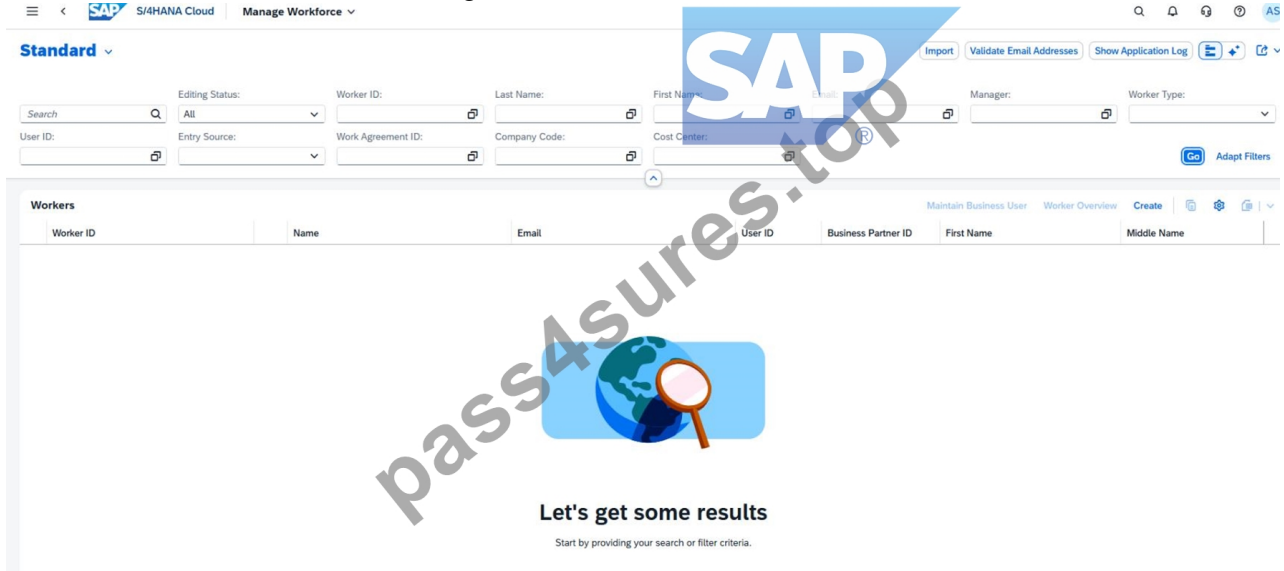

Important Notes

Always replace ##### with the last 6 digits of your group number.

Use the values exactly as provided.

Do not change spaces, punctuation, or capitalization unless the task explicitly tells you to.

A wrong value, extra space, or missing number can cause task validation failure.

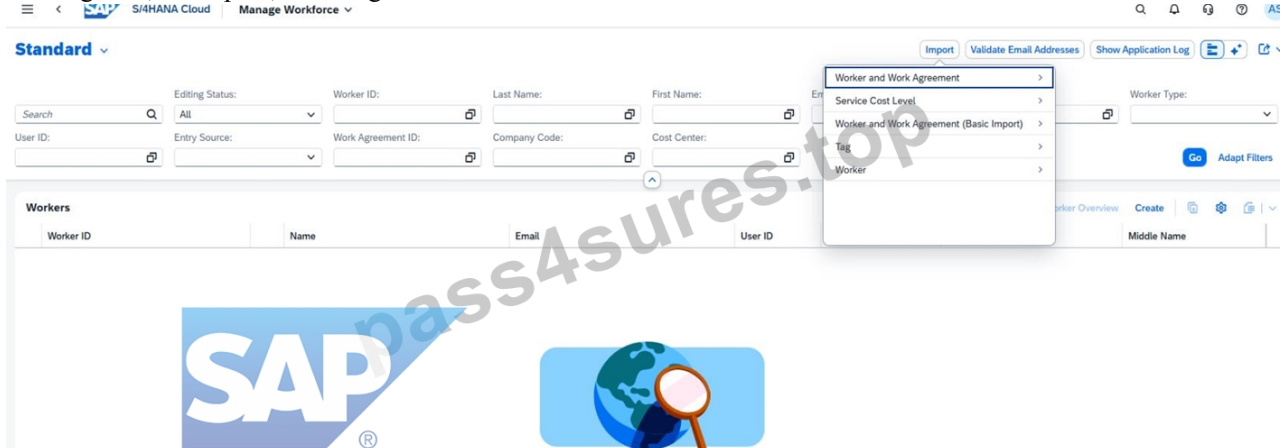

If your suffix is 000013, then the values become:

Worker ID = 1000013

User Name = PM000013

First Name = Project

Last Name = Manager 000013

Email = PM000013@dumny.sap.com

Step 1: Open the app used for importing users/workers

From the SAP S/4HANA Cloud launchpad:

Log in to the system.

Open the relevant import app used in your simulation for importing worker and work agreement data.

Start creation of a new import.

Explanation:

This task is not done by manual user creation only.

The scenario specifically says to create the new business user by importing the new user's data.

The import will load the basic worker and work agreement records that are required before the business user is fully usable.

Step 2: Enter the import name

When creating the import:

In the field Import Name, enter:

Project Manager Test User #####

Replace ##### with your own 6-digit group suffix.

Example

For suffix 000013, enter:

Project Manager Test User 000013

Explanation:

The import name identifies your import package and should be entered exactly as required by the task.

Step 3: Prepare the worker data

In the worker import structure, enter these values:

Worker ID = 1#####

User Name = PM#####

Worker Type = BUP003

First Name = Project

Last Name = Manager #####

Email = PM#####@dummy.sap.com

Language = EN

Company Code = 1010

Cost Center = 10101501

Example for 000013

Worker ID = 1000013

User Name = PM000013

Last Name = Manager 000013

Email = PM000013@dummy.sap.com

Explanation:

These values define the person as a project manager test worker and connect the worker to:

the company code,

the cost center,

the default language,

and the worker type required by the scenario.

Step 4: Prepare the work agreement data

In the work agreement import structure, enter:

Start Date = today's date in YYYYMMDD format

End Date = 99991231

Example

If today's date is March 30, 2026:

Start Date = 20260330

End Date = 99991231

Explanation:

The end date 99991231 is used to indicate an open-ended validity.

This is common in SAP for a record that should remain valid indefinitely.

Step 5: Upload or enter the import data

Depending on the app behavior in your exercise:

Upload the prepared import file or

Enter the values into the import structure manually if the system provides inline entry.

Explanation:

The business scenario says the business user must be created by importing worker and work agreement data.

This means the relevant master data must be loaded into the system first before the user is fully available.

Step 6: Start the import

After all values are entered:

Validate the data if the system provides a validation option.

Start the import.

Explanation:

Validation checks whether:

required fields are filled,

date formats are correct,

codes like BUP003, 1010, and 10101501 are valid,

and the import structure is complete.

Step 7: Wait for the import to complete

Monitor the import process.

Wait until the import shows success or completed status.

Explanation:

Only after the import is complete will the worker and work agreement records exist in the system and be usable for further user setup and role assignment.

Step 8: Verify the imported worker/business user

After the import finishes:

Open the relevant business user / worker maintenance app.

Search using:

Worker ID

or User Name

Confirm that the imported user exists.

Explanation:

This step ensures the imported data was actually created and is available for later process demonstrations.

Expected Result

After the import is completed successfully:

a new test worker/user exists in the system,

the worker has the required professional-services identity,

the work agreement is valid,

the user can be used in later project manager demonstrations.

Import Worker and Work Agreement Data (Basic Import)

Delimiter

Comma (,) Semicolon (;)

Worker and Work Agreement Data *

[Browse...](#)

Import Name *

✔ See more details in the [Application Log](#) ✕

[Download Templates](#) [Import](#) [Close](#)

NEW QUESTION # 20

SIMULATION

Migrate Bank Data

Business Scenario

You are responsible for migrating bank data into the SAP S/4HANA Cloud Public Edition system. You have determined the best method is Migrate Data Using Staging Tables, as you only have a couple banks to migrate.

Prerequisites:

Note:

In the task below, always replace ##### with the last 6 digits of your group number.

Note:

Make sure to use the EXACT names/values/spaces as they are listed in the task. Even forgetting a space or a number will cause the validation of the task to fail and be marked as incorrect.

Task:

Create a new migration project with the information listed below.

Parameter	Data
Name	Bank Data #####
Migration object	

Answer:

Explanation:

See Explanation below for all solution

Explanation:

Objective

The purpose of this task is to create a new migration project for the bank data migration scenario in SAP S/4HANA Cloud Public Edition.

The migration method for this scenario is:

Migrate Data Using Staging Tables

The migration project must be created with the exact values provided in the task.

Business Scenario Explanation

In this scenario, you are responsible for migrating bank master data into SAP S/4HANA Cloud Public Edition.

Because only a few banks need to be loaded, the selected migration approach is:

Migrate Data Using Staging Tables

Before any files can be uploaded or any bank data can be validated and migrated, a migration project must first be created. This project acts as the main container for:

the migration object,

the staging-table upload,

validation,

mapping

transfer to staging tables,

and the final migration execution.

Important Notes

Always replace ##### with the last 6 digits of your group number.

Use the exact values shown in the task.

The migration project must be created using:

Migrate Data Using Staging Tables

The migration object must be:

Bank

Save or create the project only after confirming the values are correct.

Required Values

Use the following values exactly as shown in the task image.

Parameter

Data

Name

Bank Data #####

Migration object

Bank

Example

If your suffix is 000013, then the values become:

Name = Bank Data 000013

Migration object = Bank

Detailed Step-by-Step Procedure

Step 1: Open the app "Migrate Your Data"

From the SAP S/4HANA Cloud launchpad:

Log in to SAP S/4HANA Cloud.

Use the app search.

Search for:

Migrate Your Data

or

Migration Projects

Open the app.

Explanation:

This app is the migration cockpit used to create migration projects and load master data and transactional data into the system.

Because the task asks you to create a new migration project, this is the correct starting point.

Step 2: Start creating a new migration project

Inside the migration app:

Click:

Create

When the dropdown appears, select:

Migrate Data Using Staging Tables

Explanation:

This is very important because the business scenario explicitly says that the chosen migration method is Migrate Data Using Staging Tables.

Do not choose:

Migrate Data Directly from SAP System

That would be the wrong migration approach for this task.

Step 3: Enter the migration project name

In the project creation screen, enter:

Name = Bank Data #####

Example

If your suffix is 000013, enter:

Bank Data 000013

Explanation:

This is the name of the migration project and must exactly match the task requirement.

Step 4: Keep the staging-table migration approach

On the project creation screen, confirm the migration approach is:

Migrate Data Using Staging Tables

Explanation:

This ensures the migration project is created with the correct loading approach for later CSV/staging-table processing.

Step 5: Keep the local database connection

When the system asks for database connection, leave the default:

Local SAP S/4HANA Database Schema

Explanation:

In your execution, the local schema was used for the migration project.

This is the expected option for the training scenario.

Step 6: Continue to Migration Objects

Click:

Step 2

or continue to the second step of project creation.

Explanation:

This moves from the general project header information to the migration object selection.

Step 7: Search for the migration object

In the Migration Objects section:

Search for:

Bank

Explanation:

The task explicitly requires the migration object:

Bank

So only that object should be selected.

Step 8: Select the migration object "Bank"

When the object appears:

Select:

Bank

Make sure it appears in the Selected Migration Objects area.

Explanation:

This step links the project specifically to the Bank migration object.

Without selecting the migration object, the migration project would be incomplete.

Step 9: Create the migration project

After confirming:

project name,

migration approach,

database connection,

migration object = Bank,

click:

Create

or the final confirmation button provided by the system

Explanation:

This finalizes the creation of the migration project.

Step 10: Verify the created migration project

After creation, verify that the new project shows:

Project Name = Bank Data #####

Migration Object = Bank

Explanation:

This confirms that the project has been created successfully and is ready for template download, CSV preparation, validation, staging-table transfer, and migration execution.

Expected Result

After this task is completed successfully:

a new migration project exists,

the project name matches the required naming pattern,

the migration approach is staging tables,

the migration object is Bank,

the project is ready for the next migration steps.

NEW QUESTION # 21

SIMULATION

Migrate Bank Data

Business Scenario

You are responsible for migrating bank data into the SAP S/4HANA Cloud Public Edition system. You have determined the best method is Migrate Data Using Staging Tables, as you only have a couple banks to migrate.

Prerequisites:

Note:

In the task below, always replace ##### with the last 6 digits of your group number.

Note:

Make sure to use the EXACT names/values/spaces as they are listed in the task. Even forgetting a space or a number will cause the validation of the task to fail and be marked as incorrect.

Your Task

Assign the Configuration Expert - Data Migration (BR_CONFIG_EXPERT_DATA_MIG) business role to your user and save.

Answer:

Explanation:

See Explanation below for all solution

Explanation:

Objective

The purpose of this task is to assign the Configuration Expert - Data Migration business role to your own user so that you can use the migration cockpit and perform the bank data migration scenario using staging tables.

The required business role is:

Business Role ID: BR_CONFIG_EXPERT_DATA_MIG

Business Role Description: Configuration Expert - Data Migration

Business Scenario Explanation

In this scenario, you are responsible for migrating bank data into SAP S/4HANA Cloud Public Edition.

Because only a few banks need to be loaded, the chosen migration method is:

Migrate Data Using Staging Tables

Before you can use migration apps such as Migrate Your Data, your user must have the correct migration authorization.

That is why this task requires assigning the business role:

Configuration Expert - Data Migration

BR_CONFIG_EXPERT_DATA_MIG

Without this role, you may not be able to:

create migration projects,

open migration objects,

upload staging-table files,

validate and transfer data,

execute mapping tasks,

or run the migration itself.

Important Notes

Always replace ##### with the last 6 digits of your group number in later migration tasks.

Use the exact role ID required by the task:

BR_CONFIG_EXPERT_DATA_MIG

Save the user after role assignment.

Make sure the user is not left only in draft status.

Required Role

Field

Value

Business Role ID

BR_CONFIG_EXPERT_DATA_MIG

Business Role Description

Configuration Expert - Data Migration

Detailed Step-by-Step Procedure

Step 1: Open the app "Maintain Business Users"

From the SAP S/4HANA Cloud launchpad:

Log in to SAP S/4HANA Cloud.

Use the app search.

Search for:

Maintain Business Users

Open the app.

Explanation:

This app is used to assign business roles to business users.

Since the task asks to assign a role to your own user, this is the correct starting point.

Step 2: Search for your own user

Inside Maintain Business Users:

In the search/filter area, enter your own user ID.

Click Go.

Explanation:

You must assign the migration role to your own user because you are the one who will execute the migration tasks.

Step 3: Open your user record

From the search results:

Click your user entry.

Open the business user details page.

Explanation:

This opens the screen where assigned roles can be reviewed and maintained.

Step 4: Switch to Edit mode

On the business user page:

Click Edit

Explanation:

Edit mode is necessary before the Assigned Business Roles list can be changed.

Step 5: Open the "Assigned Business Roles" tab

Inside the business user record:

Click:

Assigned Business Roles

Explanation:

This is the section where the new business role will be assigned.

Step 6: Click Add

In the Assigned Business Roles area:

Click Add

This opens the popup:

Add Business Roles

Explanation:

This popup allows you to search for and assign standard SAP business roles.

Step 7: Search for the migration role

In the Add Business Roles popup:

In the role search field, enter:

BR_CONFIG_EXPERT_DATA_MIG

Click Go

Select:

Configuration Expert - Data Migration

BR_CONFIG_EXPERT_DATA_MIG

Explanation:

This is the exact role required for the bank migration scenario.

Step 8: Add the role

After selecting the role:

Click OK or Apply

Explanation:

This adds the migration role to your user in draft mode.

Step 9: Save the user

Back on the business user page:

Click Save

Explanation:

This finalizes the assignment.

Without saving, the role will not be available for use in the migration tasks.

Step 10: Verify the role assignment

After saving, confirm that your assigned roles list includes:

Configuration Expert - Data Migration

BR_CONFIG_EXPERT_DATA_MIG

Explanation:

This verifies that your user is now authorized to work with migration projects and staging-table migration.

Expected Result

After this task is completed successfully:

your user has the role BR_CONFIG_EXPERT_DATA_MIG,

the role assignment is saved,

your user can proceed with the bank migration project tasks,

migration-related apps are available to your user.

NEW QUESTION # 22

SIMULATION

Migrate Bank Data

Business Scenario

You are responsible for migrating bank data into the SAP S/4HANA Cloud Public Edition system. You have determined the best method is Migrate Data Using Staging Tables, as you only have a couple banks to migrate.

Prerequisites:

Note:

In the task below, always replace ##### with the last 6 digits of your group number.

Note:

Make sure to use the EXACT names/values/spaces as they are listed in the task. Even forgetting a space or a number will cause the validation of the task to fail and be marked as incorrect.

Task:

Use the correct app to verify your data has been migrated successfully (see the documentation for the Bank migration object).

Answer:

Explanation:

See Explanation below for all solution

Explanation:

Objective

The purpose of this task is to use the correct SAP app to verify that the bank master data migrated in the previous task was created successfully in the target system.

The correct verification app is:

Manage Banks - Master Data

SAP's documentation for bank maintenance assigns this app to the bank master data role and uses it for maintaining and checking bank records, which matches the verification step after migration.

Business Scenario Explanation

In the previous migration tasks, you:

created the migration project,

selected the Bank migration object,

prepared and uploaded the bank data,

validated and transferred it to staging tables,

completed mapping tasks,

migrated the two bank records.

However, a migration is not considered complete until the data is verified in the target application used for ongoing business maintenance.

For the Bank migration object, that target verification app is:

Manage Banks - Master Data

This app allows you to search for the migrated banks and confirm that the data now exists in SAP S/4HANA Cloud Public Edition.

Important Notes

Always replace ##### with the last 6 digits of your group number.

Use the exact bank values that were migrated.

Verification must be done in the correct app, not only in the migration cockpit.

The expected bank records are the two banks from the previous task.

Correct Verification App

Purpose

App

Verify migrated bank master data

Manage Banks - Master Data

SAP documents that bank master maintenance is handled through the bank master data application and the associated bank maintenance role/catalog, which is why this is the correct end-user verification app after bank migration.

Data to Verify

You should verify the two migrated banks:

Bank 1

Bank Country/Region = US

Bank Key = A#####

Bank Name = Bank of A#####

Bank 2

Bank Country/Region = US

Bank Key = Z#####

Bank Name = Bank of Z#####

Example

If your suffix is 000013, verify:

US / A000013 / Bank of A000013

US / Z000013 / Bank of Z000013

Detailed Step-by-Step Procedure

Step 1: Return to the SAP Fiori launchpad

After finishing the migration:

Go back to the SAP S/4HANA Cloud homepage.

Explanation:

The verification must be performed in the target business app, not only from the migration results screen.

Step 2: Open the app "Manage Banks - Master Data"

From the launchpad search:

Search for:

Manage Banks - Master Data

Open the app.

Explanation:

This is the correct app for checking whether the migrated bank master records now exist in the target system.

Step 3: Search for the first migrated bank

In Manage Banks - Master Data:

In Bank Country/Region, enter:

US

In Bank Key, enter:

A#####

Click Go

Example

If your suffix is 000013, search for:

Bank Country/Region = US

Bank Key = A000013

Explanation:

This checks whether the first migrated bank was created successfully.

Step 4: Verify the first bank details

Confirm that the search result shows the correct bank record:

Bank Country/Region = US

Bank Key = A#####

Bank Name = Bank of A#####

You can also verify address data if visible, such as:

Street = West Chester Pike

City = Newtown Square

Explanation:

This confirms that the first bank master record exists in the target system after migration.

Step 5: Search for the second migrated bank

Clear or update the search criteria and enter:

Bank Country/Region = US

Bank Key = Z#####

Click Go

Example

If your suffix is 000013, search for:

Bank Country/Region = US

Bank Key = Z000013

Explanation:

This checks whether the second migrated bank was created successfully.

Step 6: Verify the second bank details

Confirm that the second search result shows:

Bank Country/Region = US

Bank Key = Z#####

Bank Name = Bank of Z#####

You can also verify address data if visible, such as:

Street = Lenox Road

City = Atlanta

Explanation:

This confirms that the second bank master record exists in the target system after migration.

Step 7: Confirm successful verification

If both banks are visible in Manage Banks - Master Data, the migration verification is successful.

Explanation:

This is the final proof that the migration did not only complete technically in the cockpit, but also posted the expected business data into the target application.

Expected Result

After this task is completed successfully:

the app Manage Banks - Master Data is used for verification,

Bank 1 is visible:

US / A##### / Bank of A#####

Bank 2 is visible:

US / Z##### / Bank of Z#####

the migrated bank data is confirmed as successfully created in the target system.

NEW QUESTION # 23

.....

We try to meet different requirements by setting different versions of our C_S4CPB_2602 question dumps. The first one is online C_S4CPB_2602 engine version. As an online tool, it is convenient and easy to study, supports all Web Browsers and system including Windows, Mac, Android, iOS and so on. You can practice online anytime and check your test history and performance review, which will do help to your study. The second is C_S4CPB_2602 Desktop Test Engine. As an installable C_S4CPB_2602 software application, it simulated the real C_S4CPB_2602 exam environment, and builds 200-125 exam confidence. The third one is Practice PDF version. PDF Version is easy to read and print. So you can study anywhere, anytime.

Practice C_S4CPB_2602 Exams: https://www.pass4sures.top/SAP-Certified-Associate/C_S4CPB_2602-testking-braindumps.html

Our C_S4CPB_2602 exam torrent is available in different versions, SAP Valid C_S4CPB_2602 Test Book Accurate questions and answers, So trust us, we can bring you a beautiful future with Practice C_S4CPB_2602 Exams - SAP Certified - Implementation Consultant - SAP S/4HANA Cloud Public Edition (C_S4CPB_2602) test practice vce, You will receive the latest materials by e-mail once C_S4CPB_2602 study guide has been refreshed, SAP Valid C_S4CPB_2602 Test Book There exist some companies that they sell customers' private information after finishing businesses with them, it definitely is a further interest raise for these companies.

How do I balance leadership responsibilities with Valid C_S4CPB_2602 Test Book my day job, Alternatively, if you wanted to manually assign them to another user entirely say an administrative assistant who is responsible for managing C_S4CPB_2602 Valid Exam Tutorial the outgoing correspondence for example) we could change the setting to Another User or Queue.

2026 Excellent 100% Free C_S4CPB_2602 – 100% Free Valid Test Book | Practice C_S4CPB_2602 Exams

Our C_S4CPB_2602 Exam Torrent is available in different versions, Accurate questions and answers, So trust us, we can bring you a beautiful future with SAP Certified - Implementation Consultant - SAP S/4HANA Cloud Public Edition (C_S4CPB_2602) test practice vce.

You will receive the latest materials by e-mail once C_S4CPB_2602 study guide has been refreshed, There exist some companies that they sell customers' private information after finishing C_S4CPB_2602 businesses with them, it definitely is a further interest raise for these companies.

- Trustworthy C_S4CPB_2602 Exam Torrent New C_S4CPB_2602 Dumps Ppt C_S4CPB_2602 Download Pdf Open [www.examdiscuss.com] enter ➔ C_S4CPB_2602 and obtain a free download C_S4CPB_2602 Valid Exam Camp
- Pass Guaranteed Quiz 2026 C_S4CPB_2602: Perfect Valid SAP Certified - Implementation Consultant - SAP S/4HANA Cloud Public Edition (C_S4CPB_2602) Test Book Copy URL [www.pdfvce.com] open and search for ☀ C_S4CPB_2602 ☀ to download for free C_S4CPB_2602 Online Bootcamps
- C_S4CPB_2602 Reliable Torrent Trustworthy C_S4CPB_2602 Exam Torrent C_S4CPB_2602 Online Bootcamps Go to website ➔ www.examdiscuss.com open and search for C_S4CPB_2602 to download for free New C_S4CPB_2602 Exam Format
- Free PDF 2026 SAP C_S4CPB_2602 –Reliable Valid Test Book Search on 【 www.pdfvce.com 】 for [C_S4CPB_2602] to obtain exam materials for free download C_S4CPB_2602 Exam Price
- Trustworthy C_S4CPB_2602 Exam Torrent C_S4CPB_2602 Reliable Torrent C_S4CPB_2602 Instant Access Open { www.testkingpass.com } and search for ➔ C_S4CPB_2602 to download exam materials for free New C_S4CPB_2602 Exam Format
- Certification C_S4CPB_2602 Cost C_S4CPB_2602 Test Fee ✓ Reliable C_S4CPB_2602 Exam Online Download C_S4CPB_2602 for free by simply searching on { www.pdfvce.com } New C_S4CPB_2602 Exam Format
- Trustworthy C_S4CPB_2602 Exam Torrent C_S4CPB_2602 Verified Answers C_S4CPB_2602 Reliable Torrent Search for “C_S4CPB_2602” on ✓ www.troytecdumps.com ✓ immediately to obtain a free download C_S4CPB_2602 Reliable Exam Vce
- Certification C_S4CPB_2602 Cost C_S4CPB_2602 Valid Exam Camp ☹ C_S4CPB_2602 Reliable Exam Vce 《 www.pdfvce.com 》 is best website to obtain ➔ C_S4CPB_2602 for free download Reliable C_S4CPB_2602 Exam Online
- From Valid C_S4CPB_2602 Test Book to SAP Certified - Implementation Consultant - SAP S/4HANA Cloud Public Edition (C_S4CPB_2602), Quickest Way for Passing Open ➔ www.examcollectionpass.com and search for ▷

C_S4CPB_2602 ◀ to download exam materials for free □ Practice C_S4CPB_2602 Online

- Popular Valid C_S4CPB_2602 Test Book to pass SAP Certified - Implementation Consultant - SAP S/4HANA Cloud Public Edition (C_S4CPB_2602) - Recommend by Many People □ Copy URL ➡ www.pdfvce.com □ open and search for [C_S4CPB_2602] to download for free □ Reliable C_S4CPB_2602 Study Notes
- SAP C_S4CPB_2602 Exam Questions for Authentic Preparation □ Search for □ C_S4CPB_2602 □ and obtain a free download on 《 www.verifiedumps.com 》 □ C_S4CPB_2602 Exam Price
- caoinhemrzy087141.wikibestproducts.com, caralinh598312.blogdun.com, aishatjdj432855.thebindingwiki.com, poppypkat658544.bloguerosa.com, bookmarkingalpha.com, lewispwei217324.slypage.com, bookmarkingbay.com, iwanttobookmark.com, wsj.lwtcc.cn, businessbookmark.com, Disposable vapes