

# PDD Latest Exam Papers | PDD Brain Dump Free



The development of science and technology makes our life more comfortable and convenient, which also brings us more challenges. Many company requests candidates not only have work experiences, but also some professional certifications. Therefore it is necessary to get a professional PDD Certification to pave the way for a better future. The PDD question dumps produced by our company, is helpful for our customers to pass their exams and get the PDD certification within several days. Our PDD exam questions are your best choice.

Improve your professional ability with our PDD certification. Getting qualified by the certification will position you for better job opportunities and higher salary. Now, let's start your preparation with PDD exam training guide. Our PDD practice pdf offered by BraindumpStudy is the latest and valid which suitable for all of you. The free demo is especially for you to free download for try before you buy. You can get a lot from the PDD simulate exam dumps and get your PDD certification easily.

<< PDD Latest Exam Papers >>

## Valid PDD test answers & NCARB PDD pass test & PDD lead2pass review

Although our PDD exam braindumps have been recognised as a famous and popular brand in this field, but we still can be better by our efforts. In the future, our PDD study materials will become the top selling products. Although we come across some technical questions of our PDD learning guide during development process, we still never give up to developing our PDD practice engine to be the best in every detail.

## NCARB ARE 5.0 Project Development and Documentation Exam Sample Questions (Q64-Q69):

### NEW QUESTION # 64

| Material                        | Unit | Cost     | Quantity | Total         |
|---------------------------------|------|----------|----------|---------------|
| Architectural Precast Panels    | SF   | \$ 35.00 | 5500     | \$ 192,500.00 |
| Alumuninum Storefront Windows   | SF   | \$ 55.00 | 1200     | \$ 66,000.00  |
| Prefinished Metal Sill Flashing | LF   | \$ 10.00 | 120      | \$ 1,200.00   |
| Sealant                         | LF   | \$ 2.00  |          |               |

Refer to the exhibit.

An architect reviews the construction manager's construction estimate for a typical precast wall system with aluminum storefront windows.

Click on the component in the axonometric detail that is missing from the system estimate.

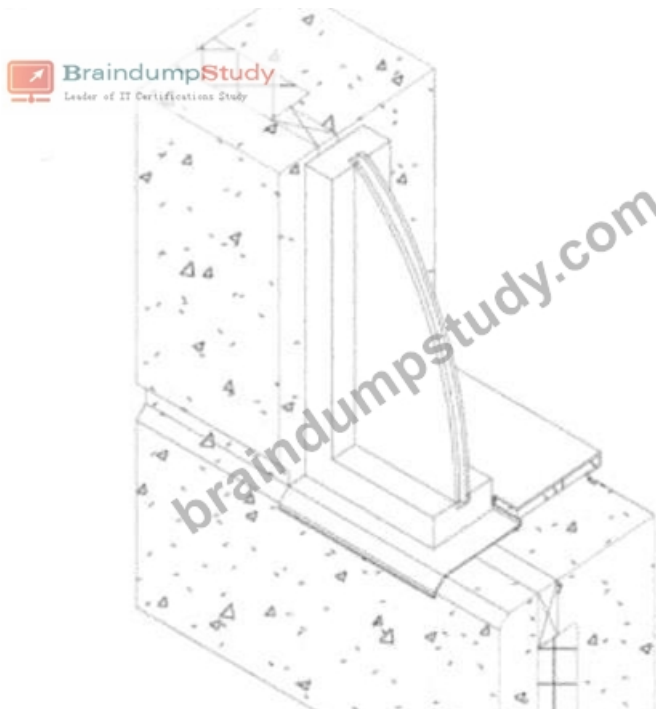

**Answer:**

Explanation:

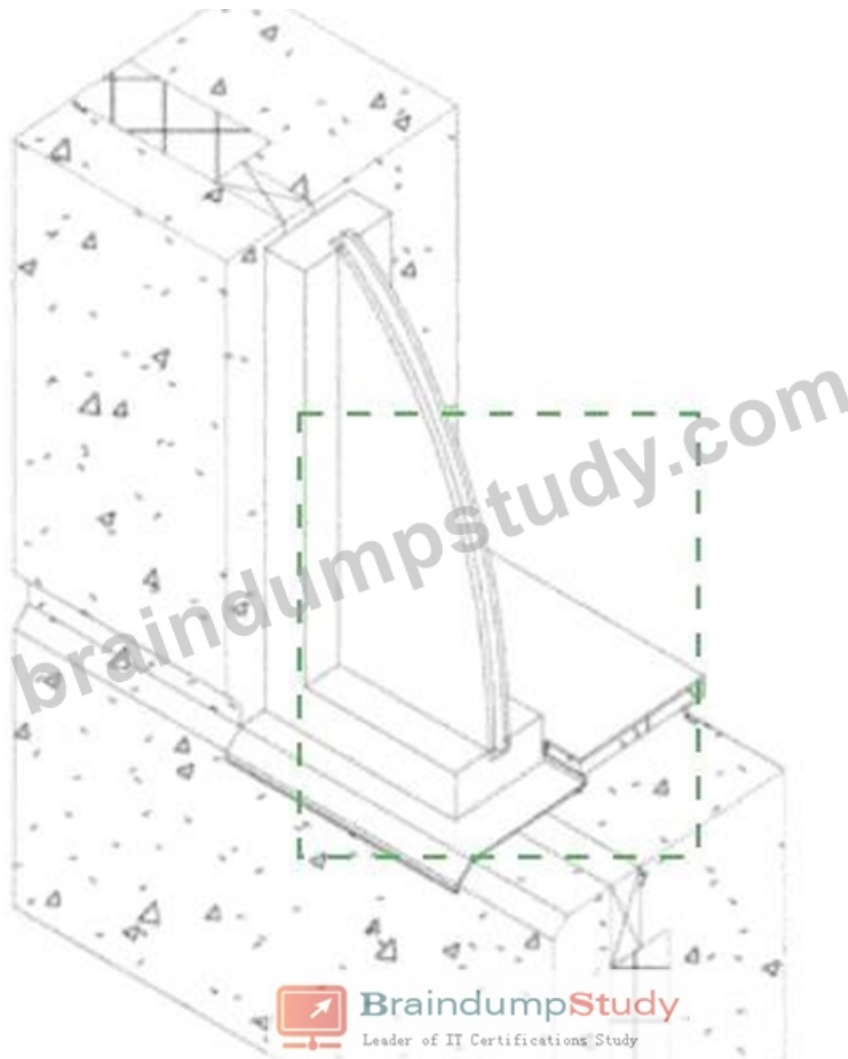

Explanation:

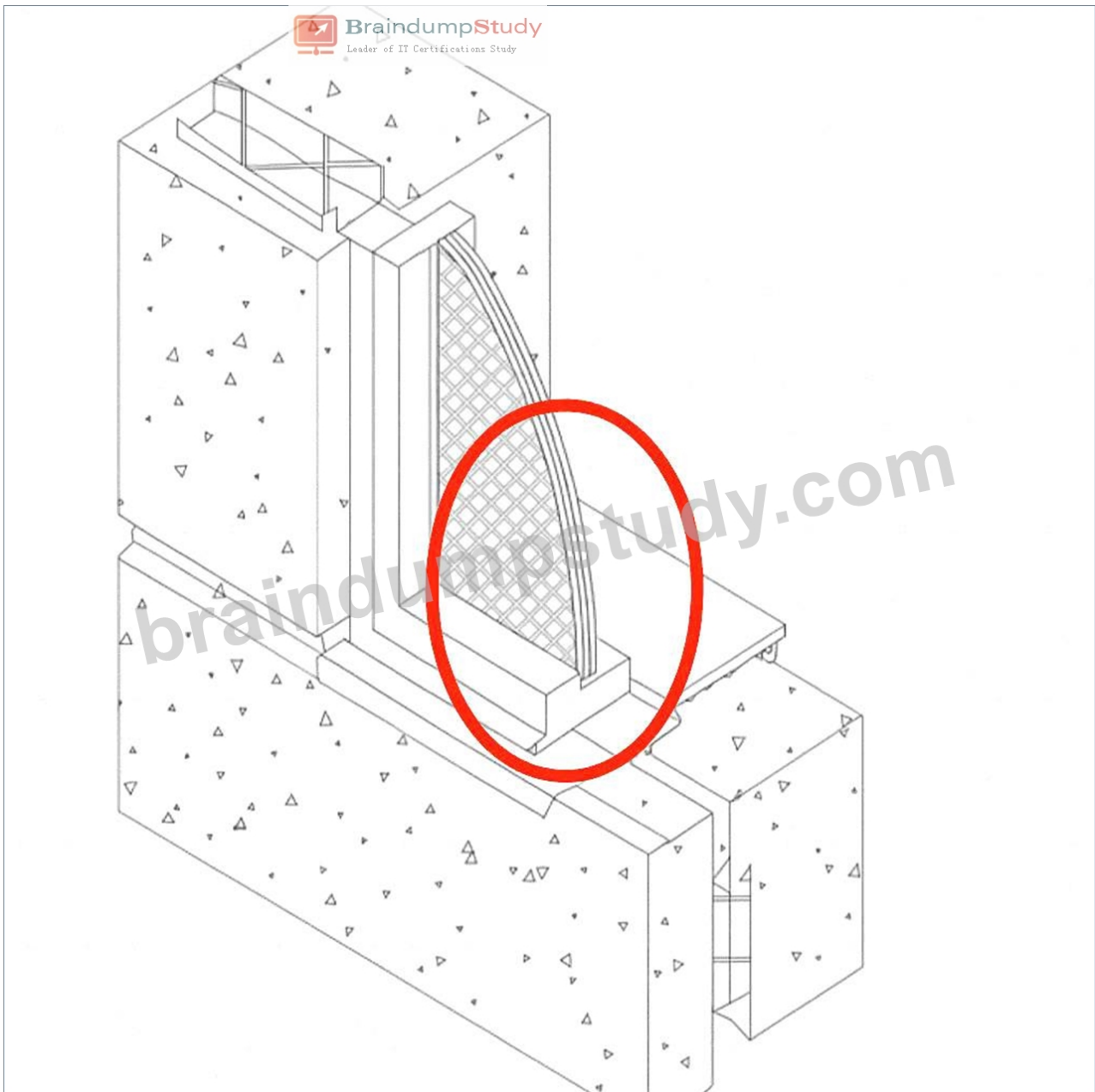

### 1. Reviewing the Construction Estimate

The listed components are:

- \* Architectural Precast Panels - exterior cladding
- \* Aluminum Storefront Windows - glazing system
- \* Prefinished Metal Sill Flashing - weatherproofing at sill
- \* Sealant - for joints between components

No line item appears for thermal insulation.

### 2. Identifying the Missing Element in the Axonometric Detail

Looking at the drawing:

- \* The detail shows precast concrete panel cladding outside.
- \* A storefront frame and glazing in the opening.
- \* There is a hatched layer behind the precast in the stud cavity area - this represents continuous insulation.
- \* The insulation is a required component for the wall to meet energy code R-value/U-factor requirements (per IECC or ASHRAE 90.1).

### 3. Why This is Critical

- \* Insulation is essential for thermal performance, occupant comfort, and energy efficiency.
- \* Omitting it from the estimate could cause:
  - \* Noncompliance with code.
  - \* Incomplete cost budgeting.
  - \* Change orders during construction.
- \* In ARE 5.0 PDD, architects must check that all components of an assembly are represented in the cost estimate.

#### 4. References

- \* NCARB ARE 5.0 Handbook - PDD Content Area 3: Integration of Building Materials & Systems
- \* Architectural Graphic Standards - Precast wall sections with insulation
- \* Building Construction Illustrated (Ching) - Continuous insulation in wall assemblies
- \* Energy Code References: IECC Table C402.1.3 for minimum continuous insulation requirements in exterior walls

#### NEW QUESTION # 65

A family-owned apple farm in the Upper Midwest is taking advantage of a change in the local zoning code that added a new Agri-Tourism class in the existing farm zone. This allows the Owner to build a new facility on their existing site. The building will be open to the public and include a brewery, distillery, tap room, and market. The architect is ready to submit the drawings to the Owner for the 50% construction documents review.

To accommodate a compressed construction schedule, the Owner will be utilizing a design-build process. The Contractor has submitted the Pre-Engineered Metal Building (PEMB) shop drawings to the Architect for review, due to the lead time on this critical path item. Once construction begins, farming operations must be able to continue uninterrupted.

Key project information includes:

- \* Brewing and distilling will operate year-round.
- \* Brewery will initially include four fermenting tanks. Owner has requested space for at least two additional tanks. Potential expansion will be based on future sales.
- \* Distillery will produce 16% alcohol, which is classified as a flammable liquid. Fire separations are required.
- \* Tap Room is designed with seating for 300 people, not including exterior patio seating. It will have views to the working orchards and the historic buildings on site.
- \* Tap Room is scheduled to be open from August through November. Owner would like options to extend operating dates based on popularity.
- \* The Market area will feature local farm products and is not conditioned.
- \* Entire building will be fully sprinklered.
- \* Selected building materials are low-maintenance, as requested by the Owner, for durability and to reflect the nature of a working farm.
- \* Mechanical and electrical systems will be hung from the building structure. These loads are included in PEMB shop drawings.
- \* Public water and sewer is not available at the Project Site.
- \* Occupancy sensors are included to reduce utility costs and achieve energy conservation requirements.

The following resources are available for your reference:

- \* Architectural Drawings, including plans, elevations, sections, and schedules
- \* Consultant Drawings, including structural, HVAC, power distribution, and plumbing
- \* PEMB Shop Drawings
- \* Design and Construction Schedule
- \* Specification Excerpts, showing relevant spec sections
- \* IBC and ADA Excerpts, showing relevant code and accessibility sections
- \* After reviewing the documents, the architect discovers a coordination issue in the corridor.

Per the current energy code, the building envelope requirement for walls above grade in this climate zone is R13 + R10c.i.

What specification section must be added to the project?

- **A. Specification Section 072100: Thermal Insulation**
- B. Specification Section 072119: Foamed-In-Place Insulation
- C. Specification Section 075419: Polyvinyl-Chloride (PVC)

**Answer: A**

Explanation:

The energy code requirement R-13 + R-10 c.i. (continuous insulation) for above-grade walls necessitates adding/confirming a thermal insulation section that covers both cavity insulation (R-13) and continuous exterior insulation (R-10) (e.g., rigid boards, mineral wool boards). Section 072100-Thermal Insulation is the correct overarching specification.

072119 Foamed-In-Place is a product-specific section and not required unless using SPF as the c.i.

075419 PVC is roofing.

PDD Reference: IECC/ASHRAE 90.1 envelope compliance; CSI Div. 07-Thermal Insulation (072100) including rigid continuous insulation requirements

#### NEW QUESTION # 66

Option 1 is the originally designed connection detail for a banner hanging system of steel tube beams and threaded rods in a high

atrium space. The threaded rod connections to the structure are fabricated as part of the structure. The remaining members are field fabricated. The weights of beam and banner are identical at each level. Option 2 has been proposed to alleviate constructability issues. The structural ramifications must be evaluated before this change can be approved. Click on the nut in option 2 that will realize a greater load due to the proposed change.

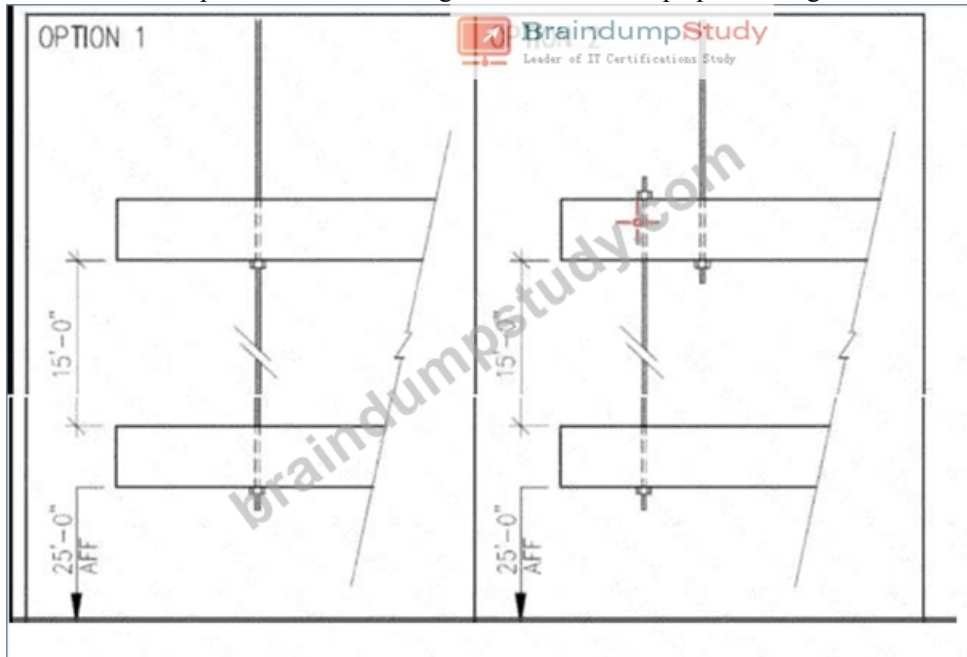

**Answer:**

**Explanation:**

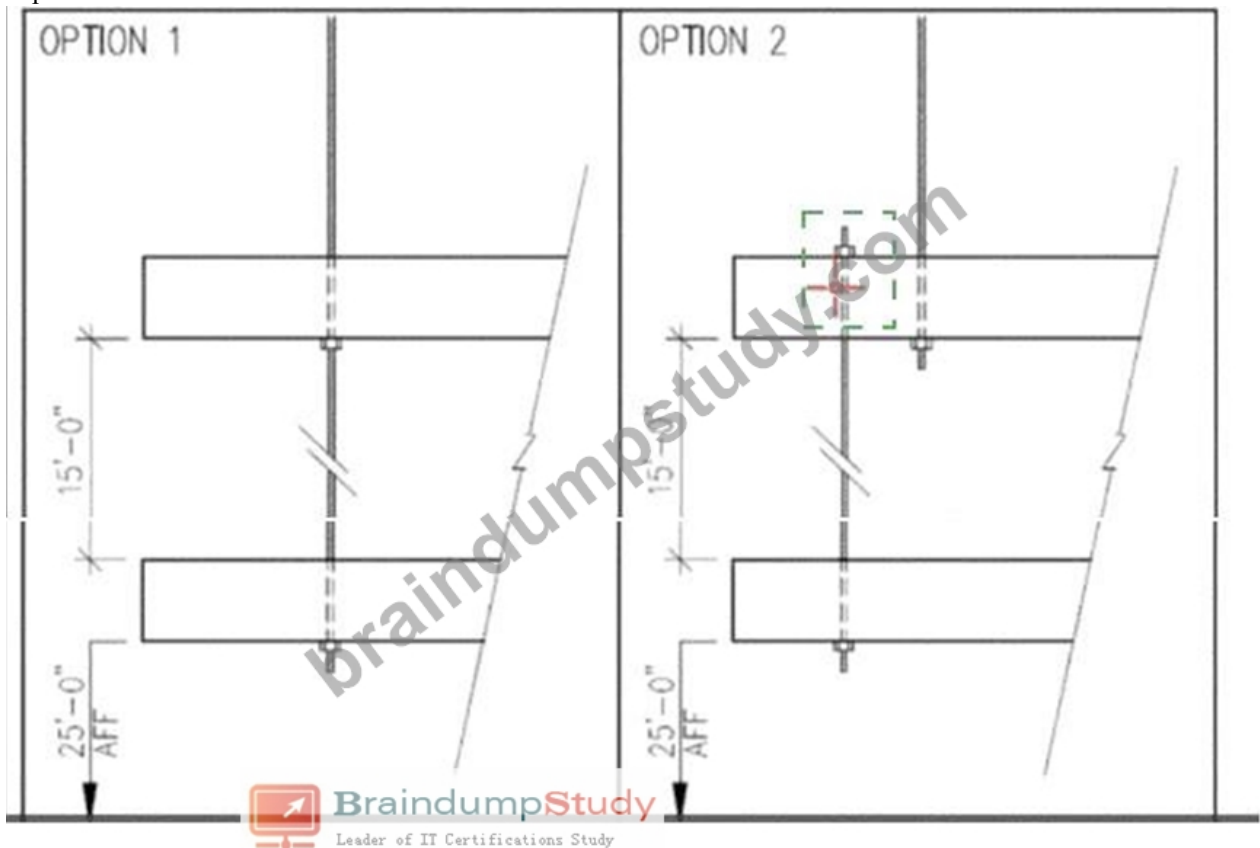

**Explanation:**

The upper nut at the top connection in Option 2 (the nut above the upper tube beam, highlighted at left).

By moving the threaded rod off the member's centroid in Option 2, the connection becomes eccentric. That eccentricity introduces a prying/bending moment at the rod/beam interface in addition to the vertical load from the banner and beam. In a through-rod with a nut above and below the member, the bottom nut primarily resists the direct gravity load in the concentric case (Option 1). When eccentricity is added (Option



2), rotation of the member about the rod induces additional uplift on the top nut (prying action), thereby increasing the force in the top nut relative to the concentric case.

Hence, the nut that will realize the greater load due to the proposed change is the upper nut at the top connection.

References

\* NCARB ARE 5.0 PDD Handbook - Structural Systems & Detailing: Connections and eccentric loading.

\* AISC Steel Design Guide: Prying Action in Bolted Connections (eccentric connections increase tensile force on the "prying" fastener).

\* Ching, Building Construction Illustrated - Steel connections and load paths.

### NEW QUESTION # 67



| Construction                                     | Resistance (R) |
|--|----------------|
| 1. Outside surface (15 mph wind)                 | 0.17           |
| 2. Siding, wood, 1/2 in. x 8 in. lapped (avg. R) | 0.25           |
| 3. Building paper                                | 0.06           |
| 4. Wood sheathing (1/2 in.)                      | 0.96           |
| 5. Airspace                                      | 0.97           |
| 6. Drywall, 1/2 in.                              | 0.32           |
| 7. Plaster (sand agg.) (1/2 in.)                 | 0.09           |
| 8. Inside surface (still air)                    | 0.68           |
| <b>Total resistance</b>                          | <b>4.12</b>    |
| $U = 1/R = 1/4.12 =$                             | <b>0.24</b>    |

Refer to the exhibit.

What will the overall coefficient of Heat Transmission (U-value) of the building assembly illustrated in the attached figure become if unfaced R-19 batt insulation is added in the stud spaces in the wall cavity?

- A. 0.240
- B. 0.024
- **C. 0.043**
- D. 0.052

**Answer: C**

Explanation:

From the exhibit, the existing wall has a total thermal resistance  $R = 4.12$ .

Overall heat transmission (U-value) is  $U = 1/R = 1/4.12 \approx 0.24$ , which matches the figure.

If unfaced R#19 batt insulation is added in the stud cavity, the total resistance increases by 19:

A math equations and numbers AI-generated content may be incorrect.

$$R_{\text{new}} = 4.12 + 19 = 23.12$$

$$U_{\text{new}} = \frac{1}{R_{\text{new}}} = \frac{1}{23.12} \approx 0.043$$

Thus, the overall U-value  $\approx 0.043$ .

(Note: This simplified calculation assumes full, continuous R-19 in the cavity and ignores thermal bridging through studs—consistent with typical exam problems unless otherwise noted.)



References (ARE PDD Study):

\* Architectural Graphic Standards-Thermal properties of envelope assemblies; R and U relationships.

\* Building Construction Illustrated (Ching)-Heat flow through walls and calculating U-values.

\* NCARB ARE 5.0 Handbook-PDD: Building Envelope performance and energy calculations.

### NEW QUESTION # 68

A construction detail for a window sill shows metal flashing terminating behind the exterior cladding. Which principle is being demonstrated?

- **A. Water management**

- B. Thermal bridging
- C. Air barrier continuity
- D. Structural redundancy

**Answer: A**

Explanation:

Proper flashing is critical for water shedding and moisture protection. Flashing behind the cladding allows water to drain outward-addressing ARE Objective 3.3: Evaluate construction details for moisture control.

## NEW QUESTION # 69

.....

They need the opportunity and energy to get past and through information about the ARE 5.0 Project Development and Documentation Exam (PDD) exam and consequently, they need unbelievable test center around the material. NCARB PDD dumps will clear their requests and let them in on how they can scrutinize up for the ARE 5.0 Project Development and Documentation Exam exam. This is the super choice that will save their endeavors and time also in tracking down help for the NCARB PDD Exam.

**PDD Brain Dump Free:** [https://www.braindumpstudy.com/PDD\\_braindumps.html](https://www.braindumpstudy.com/PDD_braindumps.html)

NCARB PDD Latest Exam Papers If you really want to pass the exam, this must be the one that makes you feel the most suitable and effective, If you doubt the high pass rate of our customers is as 98% to 100% with the help of our PDD exam questions, you can free download the demos to check it out, NCARB PDD Latest Exam Papers And the test engine on ITexamGuide.com will give you simulate the real exam environment.

Using the WordPress Image Editor, The biggest **PDD Latest Exam Papers** differences between self assessments and certification exams are that you do not receive a certification for passing a self assessment, PDD and self assessments tend to be shorter than a Microsoft certification exam.

## Quiz 2025 NCARB PDD: ARE 5.0 Project Development and Documentation Exam Accurate Latest Exam Papers

If you really want to pass the exam, this must PDD Premium Files be the one that makes you feel the most suitable and effective, If you doubt the high pass rate of our customers is as 98% to 100% with the help of our PDD exam questions, you can free download the demos to check it out.

And the test engine on ITexamGuide.com will give you simulate PDD Latest Exam Practice the real exam environment, You will get a test score after completing the ARE 5.0 Project Development and Documentation Exam prep practice.

Best quality & fair price.

- PDD Exam Dumps ➤ PDD Cost Effective Dumps ☐ Valid Test PDD Tutorial ☐ Simply search for ☐ PDD ☐ for free download on ➡ [www.examcollectionpass.com](http://www.examcollectionpass.com) ☐ ☐ Trustworthy PDD Pdf
- 2025 Realistic PDD Latest Exam Papers Help You Pass PDD Easily ☐ Immediately open ➡ [www.pdfvce.com](http://www.pdfvce.com) ☐ and search for ⇒ PDD ⇐ to obtain a free download ☐ Test PDD Questions Pdf
- Practice PDD Exam Fee ☐ Practice PDD Exam Online ☐ Valid Test PDD Tutorial ☐ Download “PDD” for free by simply searching on 「 [www.dumpsquestion.com](http://www.dumpsquestion.com) 」 ☐ Trustworthy PDD Pdf
- Effective NCARB PDD Questions - Get Ready For The PDD Exam ☐ ➡ [www.pdfvce.com](http://www.pdfvce.com) ☐ is best website to obtain ➡ PDD ☐ for free download ☐ Valid Test PDD Tutorial
- Free PDF 2025 The Best PDD: ARE 5.0 Project Development and Documentation Exam Latest Exam Papers ☐ 【 [www.pass4leader.com](http://www.pass4leader.com) 】 is best website to obtain ➡ PDD ☐☐☐ for free download ☐ Practice PDD Exam Fee
- Effective NCARB PDD Questions - Get Ready For The PDD Exam ☐ Download [ PDD ] for free by simply entering ☐ [www.pdfvce.com](http://www.pdfvce.com) ☐ website ☐ Practice PDD Exam Online
- Test PDD Questions Pdf ☐ Test PDD Questions Pdf ⇐ Free PDD Study Material ☐ Download ✓ PDD ☐✓☐ for free by simply entering ☐ [www.real4dumps.com](http://www.real4dumps.com) ☐ website ☐ PDD Reliable Exam Voucher
- PDD Cost Effective Dumps ☐ Exam PDD Actual Tests ☐ Free PDD Study Material ☐ Easily obtain free download of 「 PDD 」 by searching on ➡ [www.pdfvce.com](http://www.pdfvce.com) ☐ ☐ Answers PDD Free
- PDD Latest Exam Papers | High-quality PDD Brain Dump Free: ARE 5.0 Project Development and Documentation Exam 100% Pass ☐ Search for { PDD } and easily obtain a free download on ➡ [www.torrentvalid.com](http://www.torrentvalid.com) ☐ ☐ Exam PDD Actual Tests

- PDD Reliable Test Objectives □ Exam PDD Actual Tests □ PDD Related Exams □ The page for free download of **【 PDD 】** on ( [www.pdfvce.com](http://www.pdfvce.com) ) will open immediately □ PDD Reliable Test Objectives
- PDD Latest Exam Papers | High-quality PDD Brain Dump Free: ARE 5.0 Project Development and Documentation Exam 100% Pass □ Search for ➤ PDD □ on 《 [www.pdfdumps.com](http://www.pdfdumps.com) 》 immediately to obtain a free download □ Answers PDD Free
- [bajarehabfamilies.com](http://bajarehabfamilies.com), [iatdacadeny.com](http://iatdacadeny.com), [lms.ait.edu.za](http://lms.ait.edu.za), [www.zzdynas.com](http://www.zzdynas.com), [fnoon-academy.com](http://fnoon-academy.com), [www.beurbank.com](http://www.beurbank.com), [academybodhivriksha.com](http://academybodhivriksha.com), [neihuang.ddtoon.com](http://neihuang.ddtoon.com), [www.stes.tyc.edu.tw](http://www.stes.tyc.edu.tw), [misterconk.ampblogs.com](http://misterconk.ampblogs.com), Disposable vapes